PUBLIC NOTICE



**US Army Corps
of Engineers**®
New England District
696 Virginia Road
Concord, MA 01742-2751

Comment Period Begins: September 23, 2014
Comment Period Ends: October 23, 2014
File Number: 2014-01503
In Reply Refer To: Michael Hicks
Phone: (978) 318-8157
E-mail: michael.c.hicks@usace.army.mil

The District Engineer has received a permit application to conduct work in waters of the United States from City of Lebanon at 51 North Park Street, Lebanon, New Hampshire 03766. This work is proposed in wetlands at Lebanon Municipal Airport, 55 Airpark Road, Lebanon, New Hampshire 03766. The site coordinates are: Latitude 43° 37' 45.94" N and Longitude 72° 17' 53.481" W.

The purpose of the proposed work is to remove obstructions, to improve safety and to meet Federal Aviation Administration (FAA) requirements at the airport. The proposed work involves the direct impact to 16,713 square feet of wetlands to construct a service road, install hazard beacons and replace a drainage structure. In addition, the applicant proposes secondary impacts totalling 8.0 acres to remove trees in forested uplands near intermittent stream channels and to convert 6.49 acres of forested wetland to scrub shrub and emergent wetland for the purpose of removing existing obstructions to navigable airspace. The work and mitigation is shown on the attached plans entitled "LEBANON AIRPORT OBSTRUCTION REMOVAL NAC-2014-01503" on Pages 1 through 14 and dated "September 8, 2014".

In developing plans for the Lebanon Airport Obstruction Removal project, the applicant considered ways to avoid and minimize impacts to Waters of the United States, including wetlands. Steps to avoid and minimize impacts that were implemented were the use of a minimal impact articulated concrete block system versus traditional culverts at stream crossing locations for the service road and negotiations with the FAA to only remove above-the-ground obstructions which significantly reduced environmental impacts. Mitigation for the unavoidable impacts is proposed and consists of the preservation of a 34-acre parcel of land in the City of Lebanon to protect vernal pools and other wildlife habitat.

AUTHORITY

Permits are required pursuant to:

- Section 10 of the Rivers and Harbors Act of 1899
- Section 404 of the Clean Water Act
- Section 103 of the Marine Protection, Research and Sanctuaries Act.

The decision whether to issue a permit will be based on an evaluation of the probable impact of the proposed activity on the public interest. That decision will reflect the national concern for both protection and utilization of important resources. The benefit which may reasonably accrue from the proposal must be balanced against its reasonably foreseeable detriments. All factors which may be relevant to the proposal will be considered, including the cumulative effects thereof; among those are: conservation, economics, aesthetics, general environmental concerns, wetlands, cultural value, fish and wildlife values, flood hazards, flood plain value, land use, navigation, shoreline erosion and accretion, recreation, water supply and conservation, water quality, energy needs, safety, food production and, in general, the needs and welfare of the people.

The Corps of Engineers is soliciting comments from the public; Federal, state, and local agencies and officials; Indian Tribes; and other interested parties in order to consider and evaluate the impacts of this proposed activity. Any comments received will be considered by the Corps of Engineers to determine whether to issue, modify, condition or deny a permit for this proposal. To make this decision, comments are used to assess impacts on endangered species, historic properties, water quality, general environmental effects, and the other public interest factors listed above. Comments are used in the preparation of an Environmental Assessment and/or an Environmental Impact Statement pursuant to the National Environmental Policy Act. Comments are also used to determine the need for a public hearing and to determine the overall public interest of the proposed activity.

Where the activity involves the discharge of dredged or fill material into waters of the United States or the transportation of dredged material for the purpose of disposing it in ocean waters, the evaluation of the impact of the activity in the public interest will also include application of the guidelines promulgated by the Administrator, U.S Environmental Protection Agency, under authority of Section 404(b) of the Clean Water Act, and/or Section 103 of the Marine Protection Research and Sanctuaries Act of 1972, as amended.

NATIONAL HISTORIC PRESERVATION ACT

Based on his initial review, the District Engineer has determined that little likelihood exists for the proposed work to impinge upon properties with cultural or Native American significance, or listed in, or eligible for listing in, the National Register of Historic Places. Therefore, no further consideration of the requirements of Section 106 of the National Historic Preservation Act of 1966, as amended, is necessary. This determination is based upon one or more of the following:

- a. The permit area has been extensively modified by previous work.
- b. The permit area has been recently created.
- c. The proposed activity is of limited nature and scope.
- d. Review of the latest published version of the National Register shows that no presence of registered properties listed as being eligible for inclusion therein are in the permit area or general vicinity.
- e. Coordination with the State Historic Preservation Officer and/or Tribal Historic Preservation Officer(s)

The following authorizations have been applied for, or have been, or will be obtained:

- Permit, License or Assent from State.
- Permit from Local Wetland Agency or Conservation Commission.
- Water Quality Certification in accordance with Section 401 of the Clean Water Act.

In order to properly evaluate the proposal, we are seeking public comment. Anyone wishing to comment is encouraged to do so. Comments should be submitted in writing by the above date. If you have any questions, please contact Michael Hicks at (978) 318-8157, (800) 343-4789 or (800) 362-4367, if calling from within Massachusetts.

Any person may request, in writing, within the comment period specified in this notice, that a public hearing be held to consider the application. Requests for a public hearing shall specifically state the reasons for holding a public hearing. The Corps holds public hearings for the purpose of obtaining public comments when that is the best means for understanding a wide variety of concerns from a diverse segment of the public.

CENAE-R
FILE NO. NAE-2014-01503

The initial determinations made herein will be reviewed in light of facts submitted in response to this notice. All comments will be considered a matter of public record. Copies of letters of objection will be forwarded to the applicant who will normally be requested to contact objectors directly in an effort to reach an understanding.

THIS NOTICE IS NOT AN AUTHORIZATION TO DO ANY WORK.

119
Frank J. DelGiudice
Chief, Permits and Enforcement Branch
Regulatory Division

If you would prefer not to continue receiving Public Notices by email, please contact Ms. Tina Chaisson at (978) 318-8058 or e-mail her at bettina.m.chaisson@usace.army.mil. You may also check here () and return this portion of the Public Notice to: Bettina Chaisson, Regulatory Division, U.S. Army Corps of Engineers, 696 Virginia Road, Concord, MA 01742-2751.

NAME: _____
ADDRESS: _____
PHONE: _____

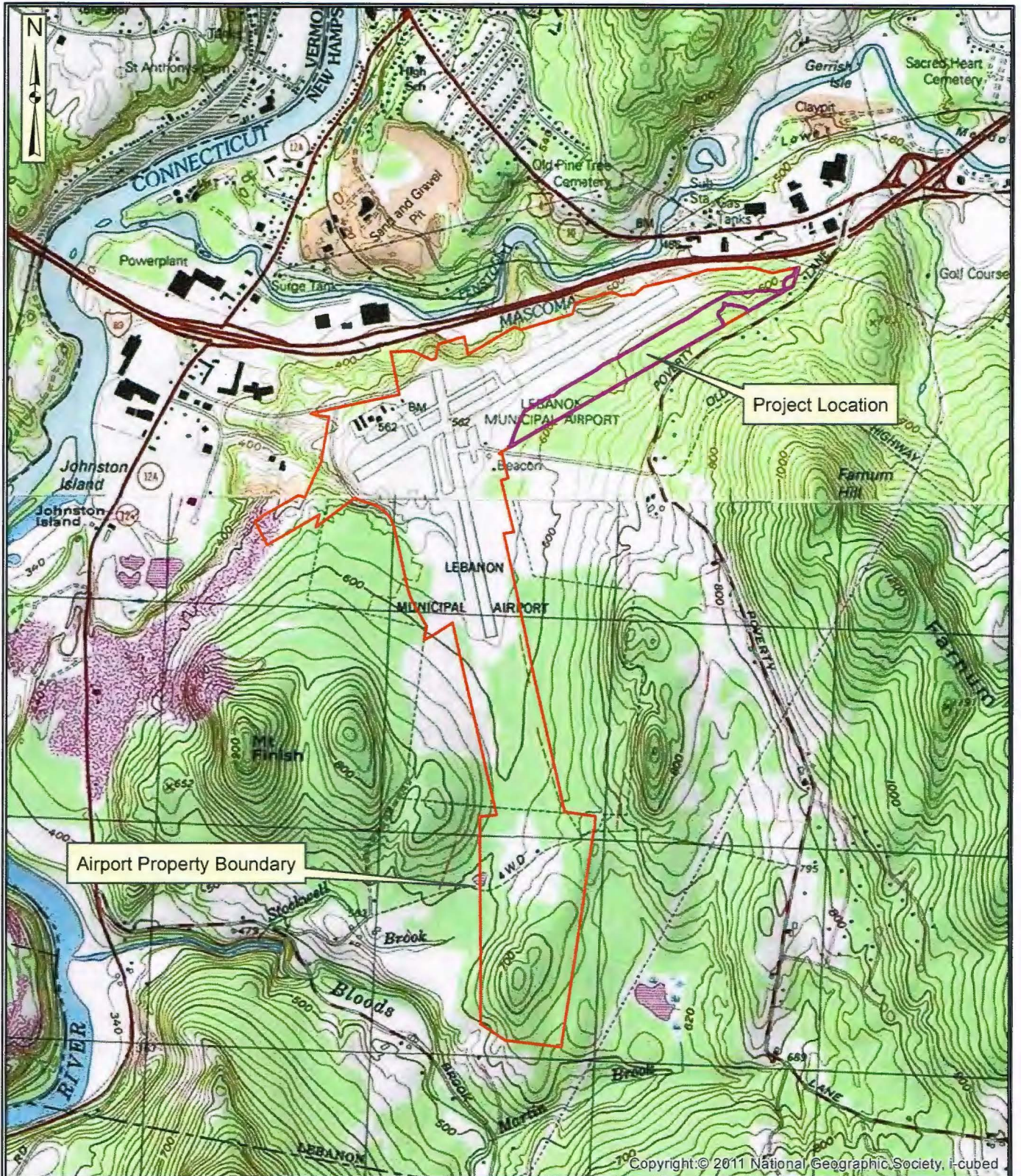

K:\Lebanon Municipal Airport\11-16695_08 Lebanon Airport Tree Clearing\Draw\GIS\Weiland Permit Figures\Figure 1 Location

Airport Property Boundary

Project Location

LEBANON AIRPORT
 OBSTRUCTION REMOVAL
 NAC-2014-01503
 SEPTEMBER 8, 2014
 PAGE 1 OF 14

LEBANON MUNICIPAL AIRPORT
 LEBANON, NH
OBSTRUCTION REMOVAL

LOCATION MAP

SCALE: 1:24,000	DATE: MARCH 2014	FIGURE: 1
--------------------	---------------------	--------------



Copyright © 2011 National Geographic Society, i-cubed

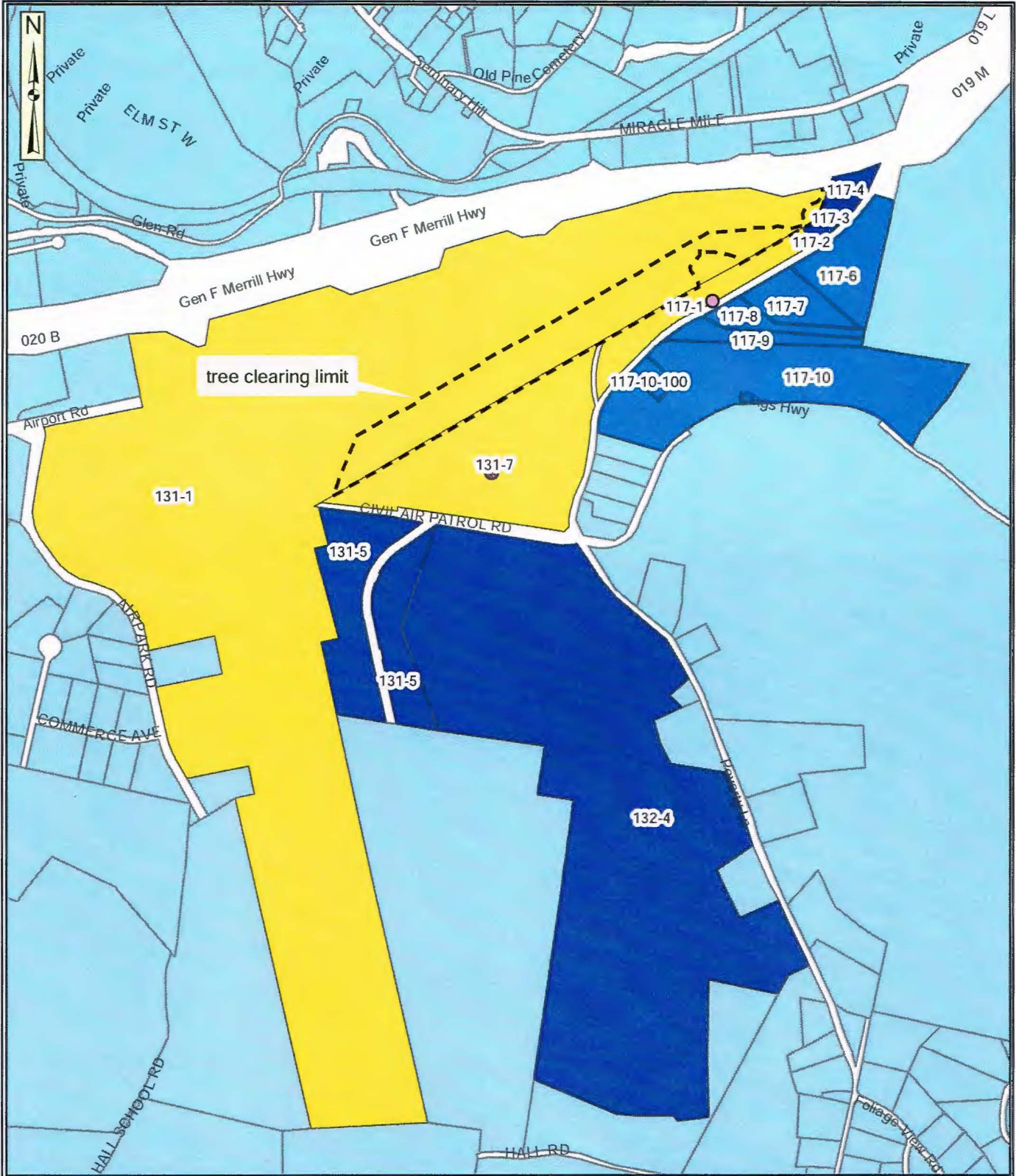

- Lebanon parcels
- Abutter
- Affected Parcel

LEBANON AIRPORT
 OBSTRUCTION REMOVAL
 NAC-2014-01503
 SEPTEMBER 8, 2014
 PAGE 2 OF 14



Proposed Hazard Beacon

LEBANON MUNICIPAL AIRPORT
 LEBANON, NH
 OBSTRUCTION REMOVAL

TAX MAP

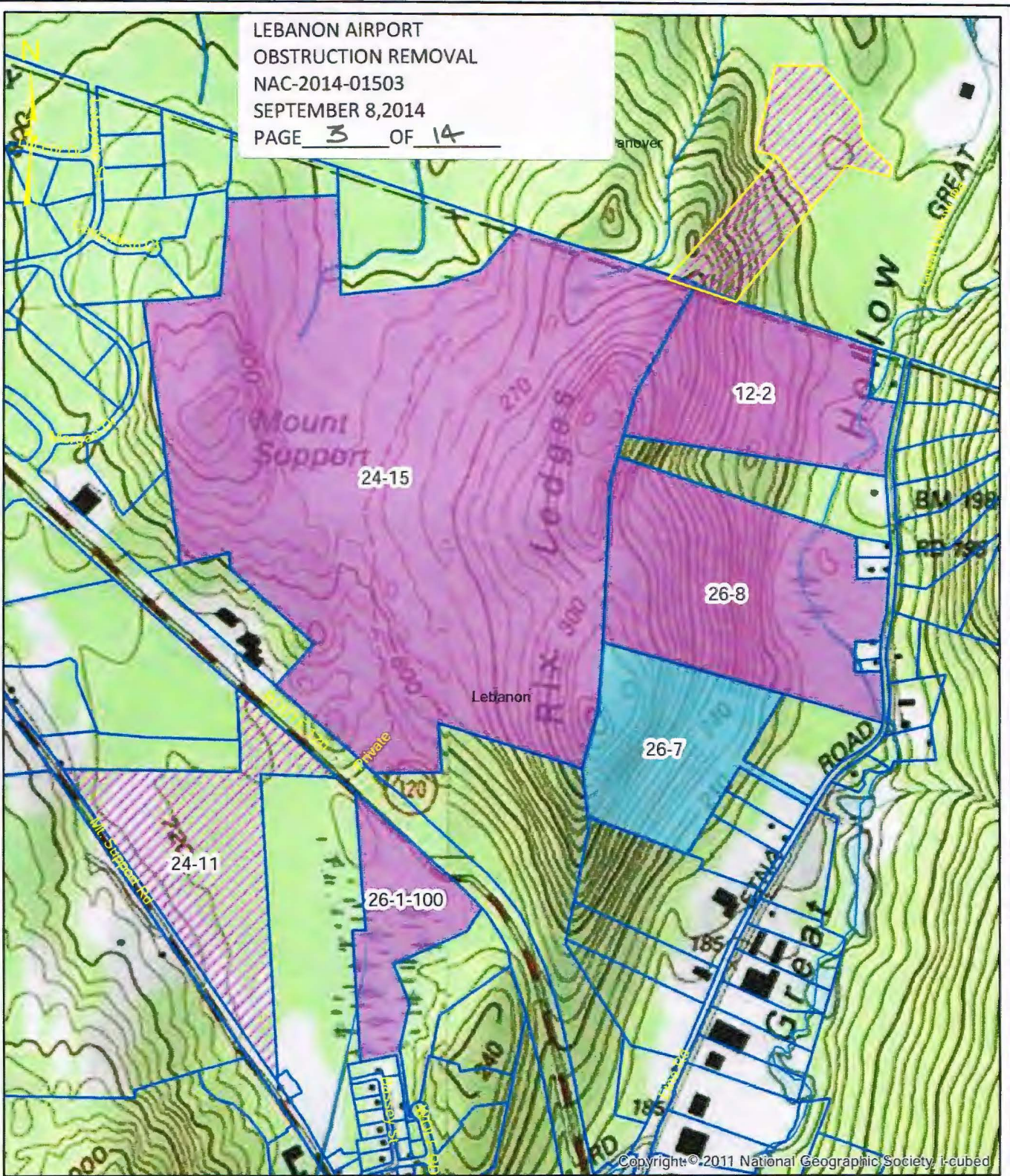
SCALE: 1:14,000	DATE: JUNE 2014	FIGURE: 2
--------------------	--------------------	--------------



-  Conserved
-  Partially Conserved or Development Restricted
-  Parcel to be Preserved for Mitigation

LEBANON MUNICIPAL AIRPORT
 LEBANON, NH

POTENTIAL CONSERVATION LAND

SCALE:	DATE:	FIGURE:
1:12,000	MAY 2014	4

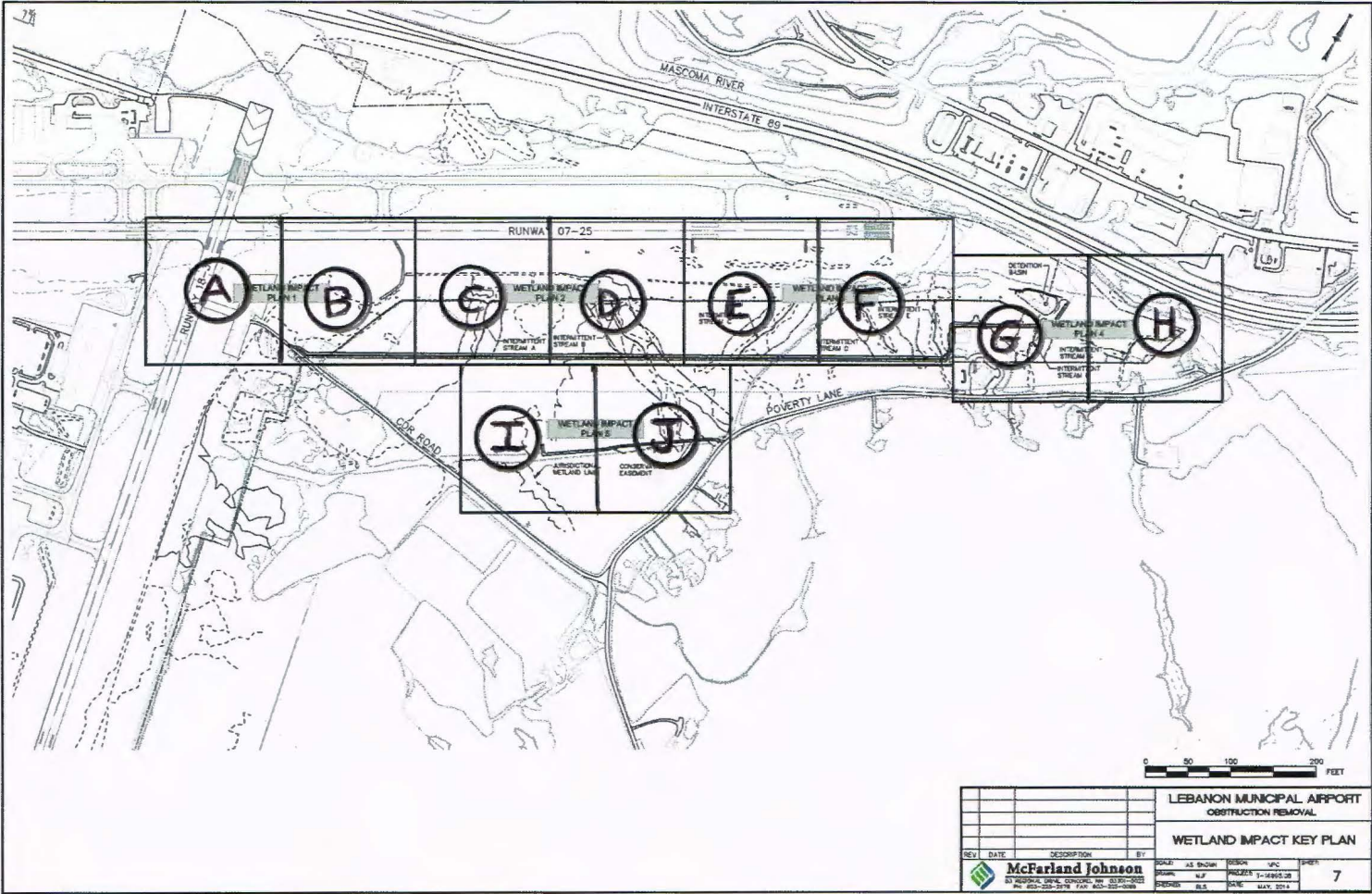

			LEBANON MUNICIPAL AIRPORT OBSTRUCTION REMOVAL		
			WETLAND IMPACT KEY PLAN		
REV	DATE	DESCRIPTION	BY	SCALE	SHEET
				AS SHOWN	7
				DATE	

LEBANON AIRPORT
 OBSTRUCTION REMOVAL
 NAC-2014-01503
 SEPTEMBER 8, 2014
 PAGE 4 OF 14

K:\Lebanon Municipal Airport\1-15335.08 Lebanon Airport Tree Clearing\Draw\Drawings\Wetland Impacts Permit\Wetland Impacts.dwg, 5/15/2014 4:05:51 PM

PROPOSED WETLAND IMPACTS

	Temporary	Permanent	Conversion (no dredge or fill)	TOTAL
DIRECT IMPACTS				
Access for Beacon Installation (emergent and forested wetlands)		1004		1004
Road construction / fence (forested wetlands)		15,642		15,642
Drainage structure installation (emergent wetlands)	54	13		67
Wetland Tree Clearing (Veg Type Conversion)			137,004	137,004
Wetland Tree Clearing within 100' of streams			145,700	145,700
TOTAL WETLAND IMPACTS (SQUARE FEET)	54	16,659	282,704	299,417
TOTAL WETLAND IMPACTS (ACRES)		0.38	6.49	6.87
SECONDARY IMPACTS				
Upland land clearing within 100' of streams		348,998		348,998
TOTAL SECONDARY IMPACTS (SQUARE FEET)		348,998		348,998
TOTAL SECONDARY IMPACTS (ACRES)		8.01		8.01



RU

JURISDICTIONAL
WETLAND LIMIT

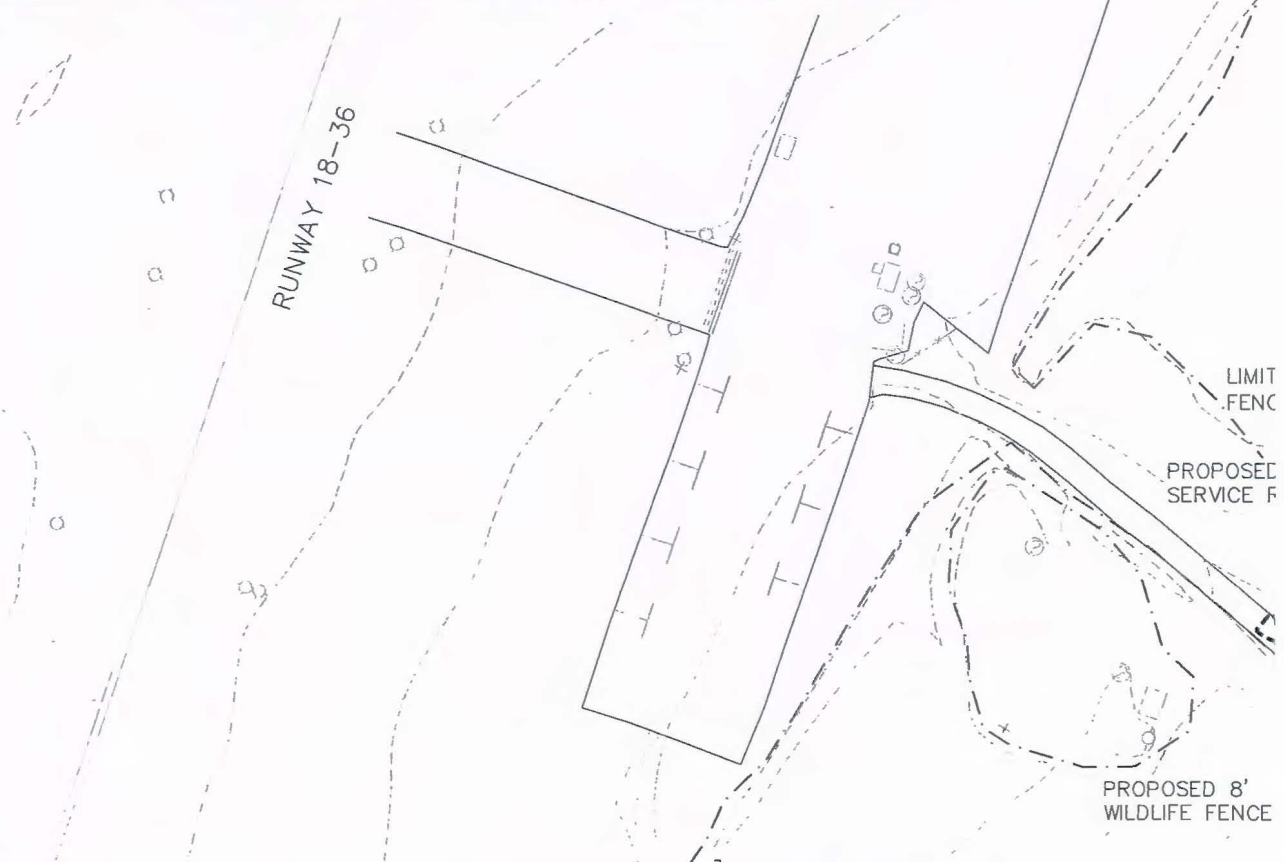

LEGEND

- WETLAND CONVERSION (TREE CLEARING)
- PERMANENT WETLAND IMPACT
- WETLAND CONVERSION (TREE CLEARING) WITHIN 100' OF STREAMS
- UPLAND TREE CLEARING WITHIN 100' OF STREAMS
- TEMPORARY IMPACT

**LEBANON AIRPORT
OBSTRUCTION REMOVAL
NAC-2014-01503
SEPTEMBER 8, 2014
PAGE 5 OF 14**

INWAY 07-25

B

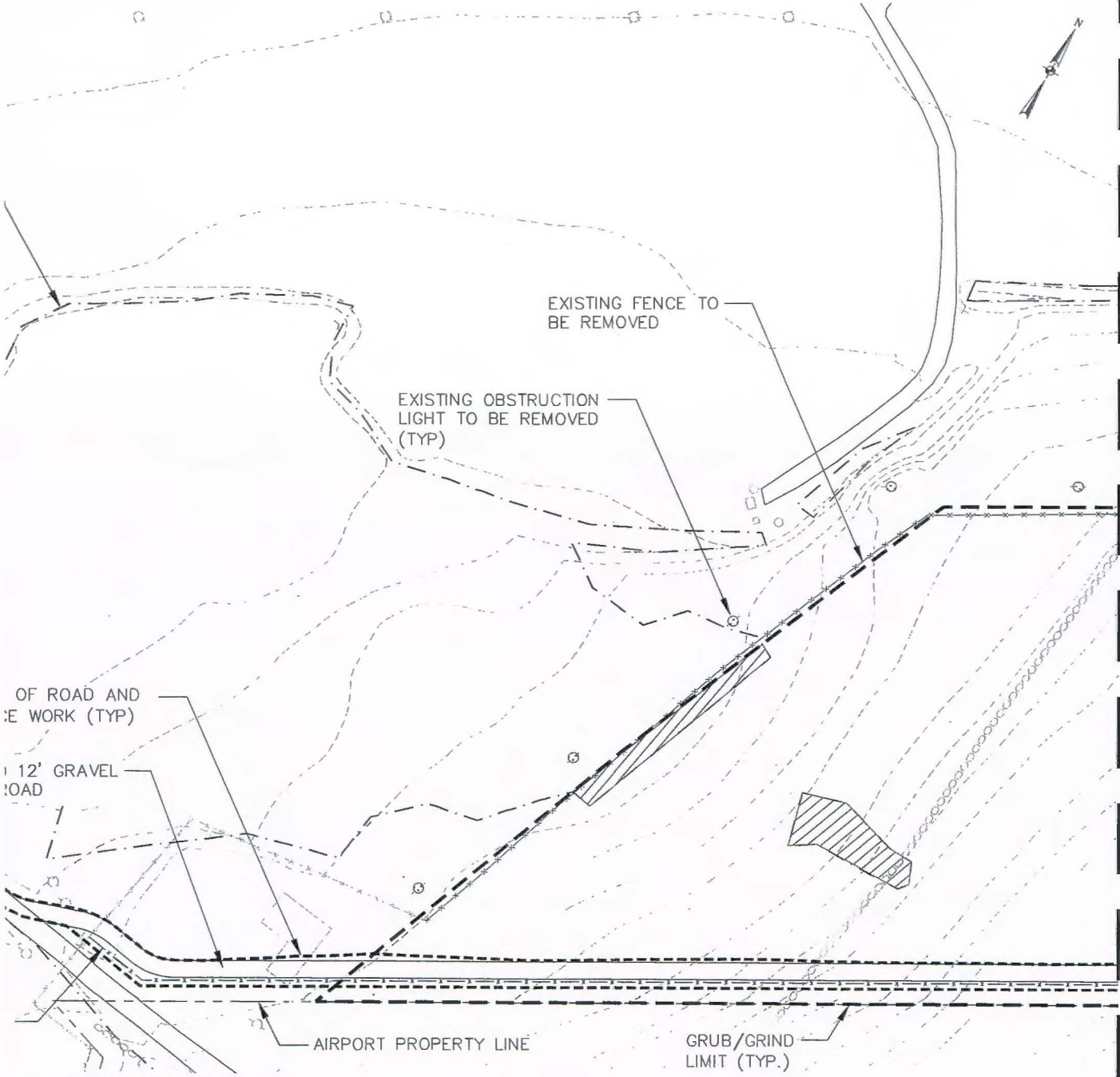

OF ROAD AND
SIDE WORK (TYP)

12' GRAVEL
ROAD

EXISTING FENCE TO
BE REMOVED

EXISTING OBSTRUCTION
LIGHT TO BE REMOVED
(TYP)

AIRPORT PROPERTY LINE

GRUB/GRIND
LIMIT (TYP.)

MATCH TO WETLAND IMPACT PLAN 2

LEBANON AIRPORT
OBSTRUCTION REMOVAL
NAC-2014-01503
SEPTEMBER 8, 2014
PAGE 6 OF 14

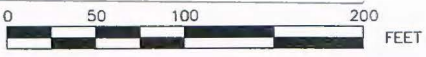

REV	DATE	DESCRIPTION	BY

McFarland Johnson
53 REGIONAL DRIVE, CONCORD, NH 03301-5022
PH: 603-225-2978 FAX: 603-225-0095

LEBANON MUNICIPAL AIRPORT OBSTRUCTION REMOVAL			
WETLAND IMPACT PLAN 1			
SCALE: AS SHOWN	DESIGN: VPC	SHEET: 8	
DRAWN: MJF	PROJECT: T-16995.08		
CHECKED: BLS	DATE: MAY, 2014		

K:\Lebanon Municipal Airport\1-16395.06 Lebanon Airport Tree Clearing\Drawings\Wetland Impacts Permit\Wetland Impacts.dwg, 5/15/2014 4:04:06 PM



RUNWAY

MATCH TO WETLAND IMPACT PLAN 1

EXISTING OBSTRUCTION
LIGHT TO BE REMOVED
(TYP)

JURISDICT
WETLAND

EXISTING FENCE TO
BE REMOVED





INTERMITTENT
STREAM A

100' BUFFER FROM
STREAM CENTERLINE

PROPOSED 8'
WILDLIFE FENCE

AIRPORT
PROPERTY LINE

LEGEND

-  WETLAND CONVERSION (TREE CLEARING)
-  PERMANENT WETLAND IMPACT
-  WETLAND CONVERSION (TREE CLEARING)
WITHIN 100' OF STREAMS
-  UPLAND TREE CLEARING
WITHIN 100' OF STREAMS
-  TEMPORARY IMPACT

LEBANON AIRPORT
 OBSTRUCTION REMOVAL
 NAC-2014-01503
 SEPTEMBER 8, 2014
 PAGE 7 OF 14

07-25

D

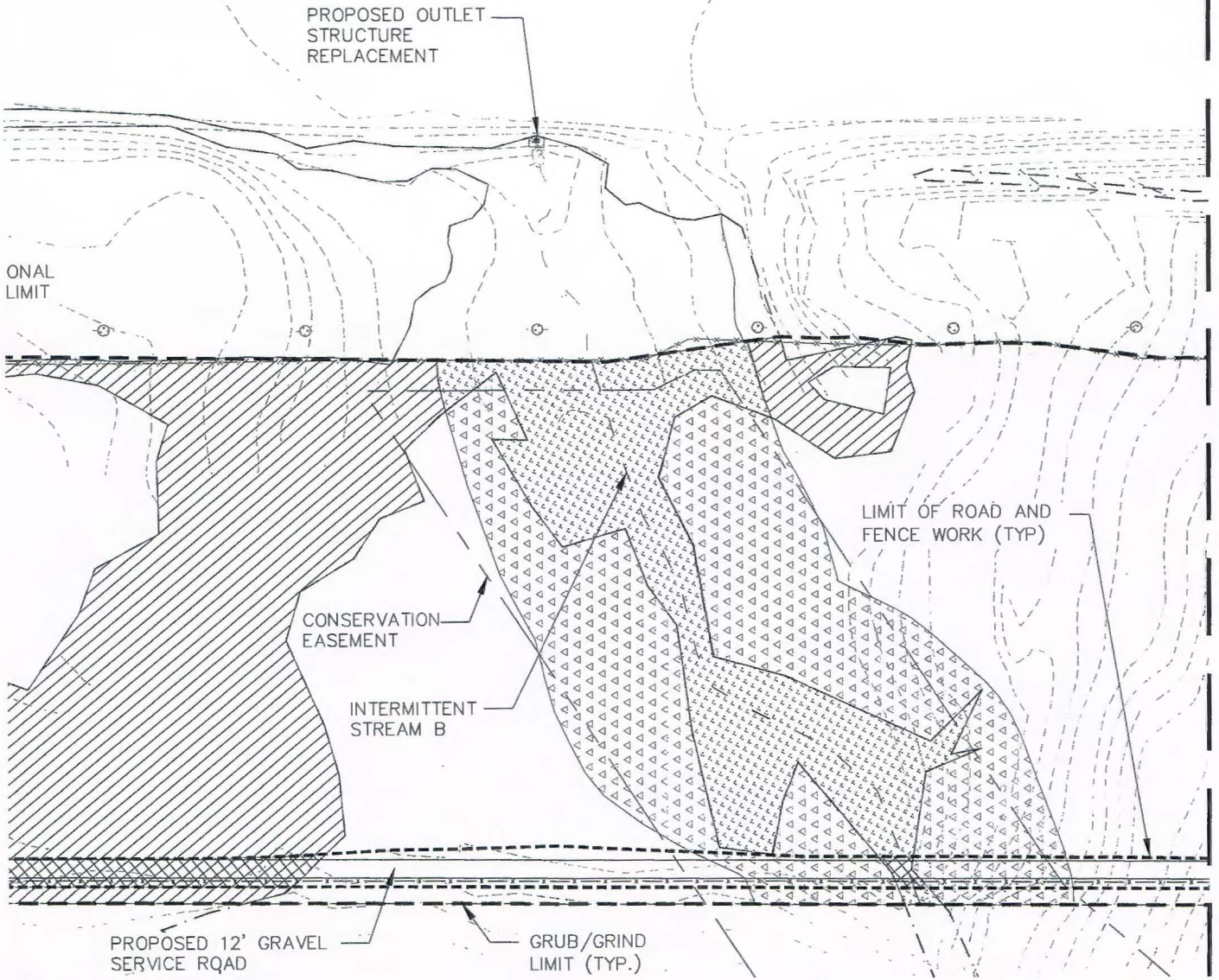

MATCH TO WETLAND IMPACT PLAN 3

LEBANON AIRPORT
 OBSTRUCTION REMOVAL
 NAC-2014-01503
 SEPTEMBER 8, 2014
 PAGE 8 OF 14



REV	DATE	DESCRIPTION	BY

McFarland Johnson
 53 REGIONAL DRIVE, CONCORD, NH 03301-5022
 PH: 603-225-2978 FAX: 603-225-0055

LEBANON MUNICIPAL AIRPORT
 OBSTRUCTION REMOVAL

WETLAND IMPACT PLAN 2

SCALE: AS SHOWN	DESIGN: VPC	SHEET: 9
DRAWN: MJF	PROJECT: T-16995.08	
CHECKED: BLS	DATE: MAY, 2014	

K:\Lebanon Municipal Airport\1-1999\08 Lebanon Airport Tree Clearing\Drawings\Wetland Impacts Permit\Wetland Impacts.dwg, 5/25/2014 4:04:20 PM

MATCH TO WETLAND IMPACT PLAN 2

RUNWAY 07-25

(E)

JURISDICTIONAL WETLAND LIMIT

EXISTING OBSTRUCTION LIGHT TO BE REMOVED (TYP)





EXISTING FENCE TO BE REMOVED

INTERMITTENT STREAM C

100' BUFFER (FROM STREAM CENTERLINE)

AIRPORT PROPERTY

LEGEND

-  WETLAND CONVERSION (TREE CLEARING)
-  PERMANENT WETLAND IMPACT
-  WETLAND CONVERSION (TREE CLEARING) WITHIN 100' OF STREAMS
-  UPLAND TREE CLEARING WITHIN 100' OF STREAMS
-  TEMPORARY IMPACT

LEBANON AIRPORT
 OBSTRUCTION REMOVAL
 NAC-2014-01503
 SEPTEMBER 8, 2014
 PAGE 9 OF 14

MATCH TO WETLAND IMPACT PLAN 4

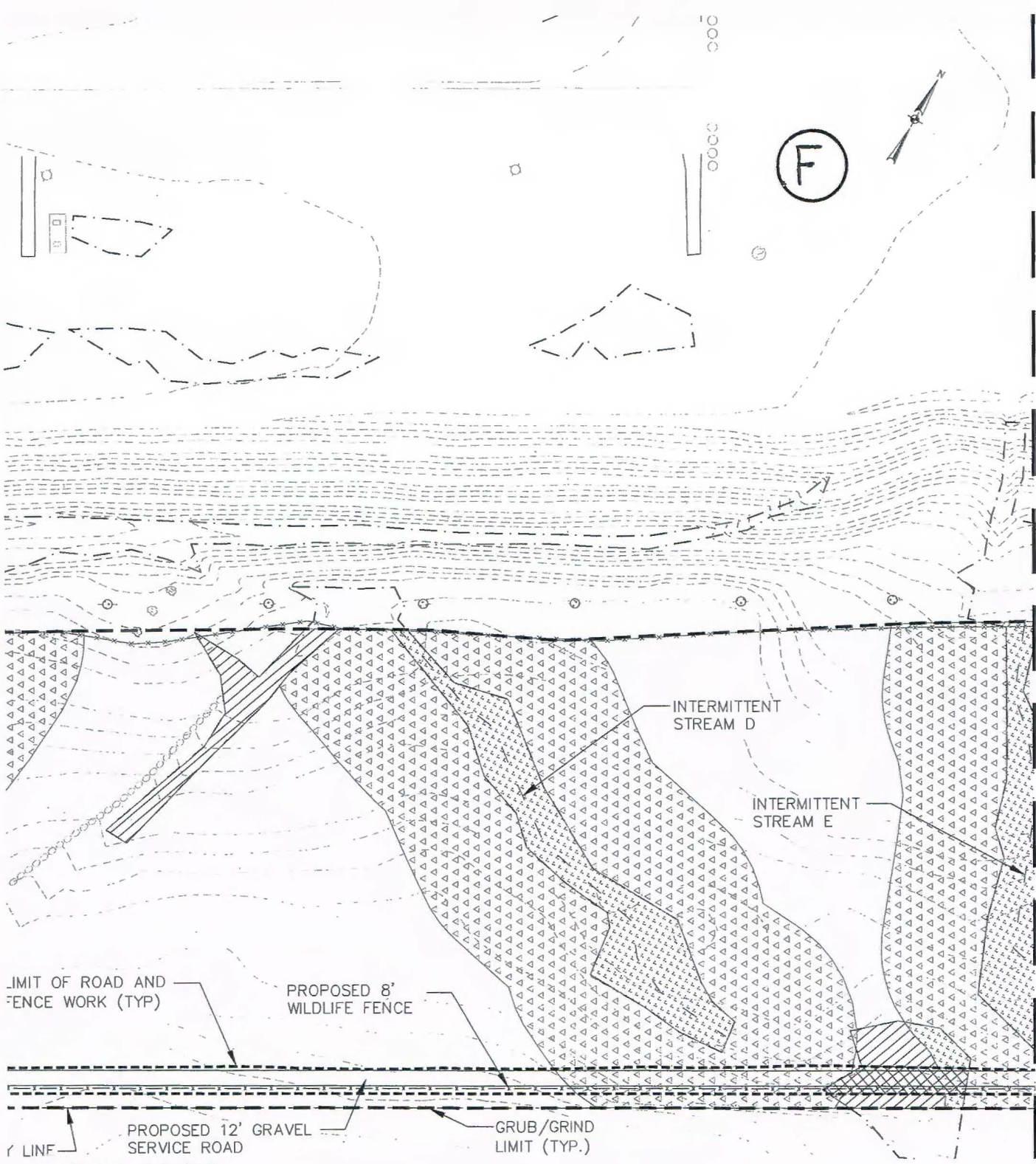

LIMIT OF ROAD AND FENCE WORK (TYP)

PROPOSED 8' WILDLIFE FENCE

INTERMITTENT STREAM D

INTERMITTENT STREAM E

LINE

PROPOSED 12' GRAVEL SERVICE ROAD

GRUB/GRIND LIMIT (TYP.)

LEBANON AIRPORT
 OBSTRUCTION REMOVAL
 NAC-2014-01503
 SEPTEMBER 8, 2014
 PAGE 10 OF 14



REV	DATE	DESCRIPTION	BY

McFarland Johnson
 53 REGIONAL DRIVE, CONCORD, NH 03301-5022
 PH: 603-225-2978 FAX: 603-225-0095

LEBANON MUNICIPAL AIRPORT
 OBSTRUCTION REMOVAL

WETLAND IMPACT PLAN 3



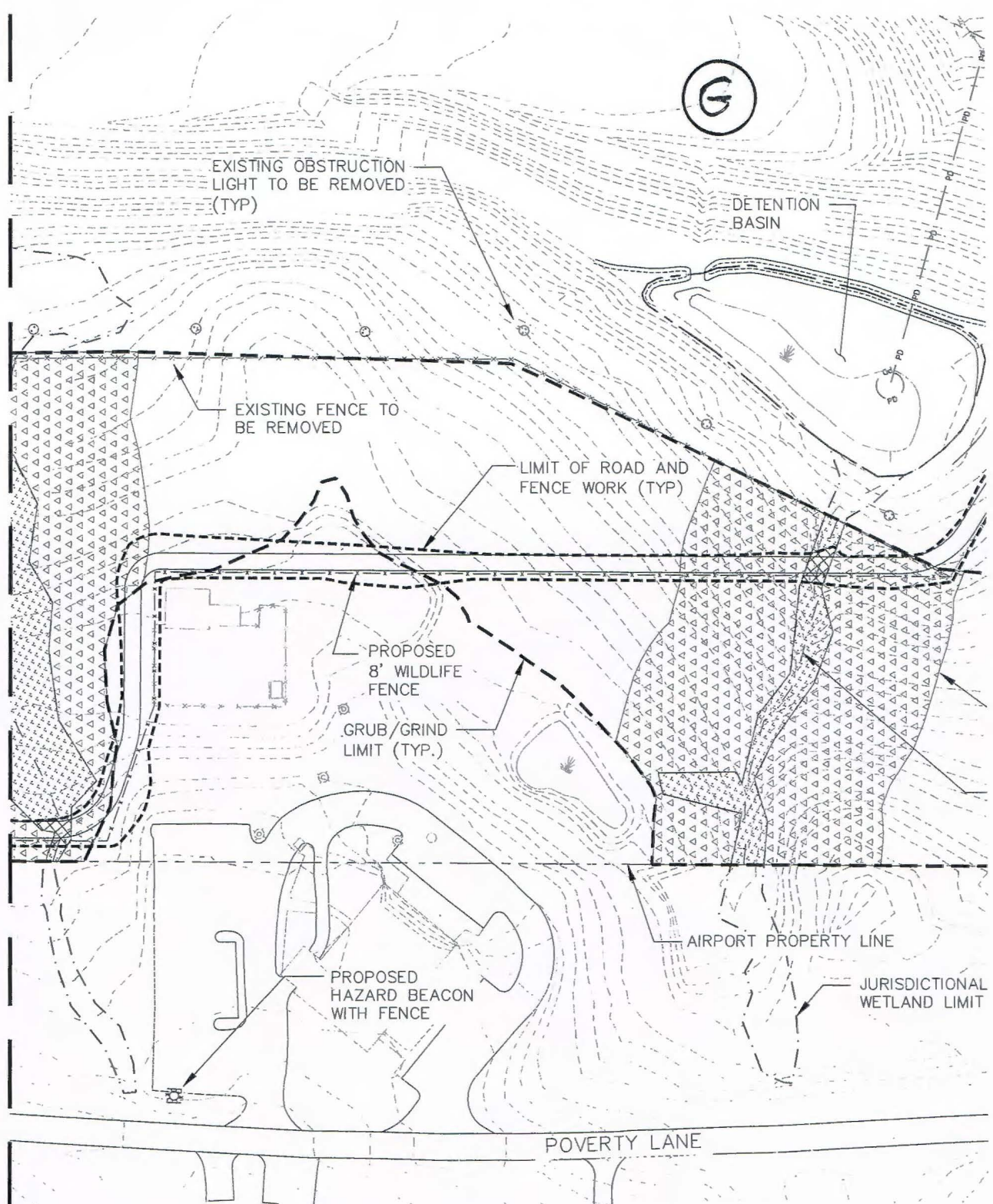

SCALE: AS SHOWN	DESIGN: VPC
DRAWN: MJF	PROJECT: T-16995.08
CHECKED: BLS	DATE: MAY, 2014

SHEET:
10

MATCH TO WETLAND IMPACT PLAN 3



LEGEND

-  WETLAND CONVERSION (TREE CLEARING)
-  PERMANENT WETLAND IMPACT
-  WETLAND CONVERSION (TREE CLEARING) WITHIN 100' OF STREAMS
-  UPLAND TREE CLEARING WITHIN 100' OF STREAMS
-  TEMPORARY IMPACT

LEBANON AIRPORT
 OBSTRUCTION REMOVAL
 NAC-2014-01503
 SEPTEMBER 8, 2014
 PAGE 11 OF 14

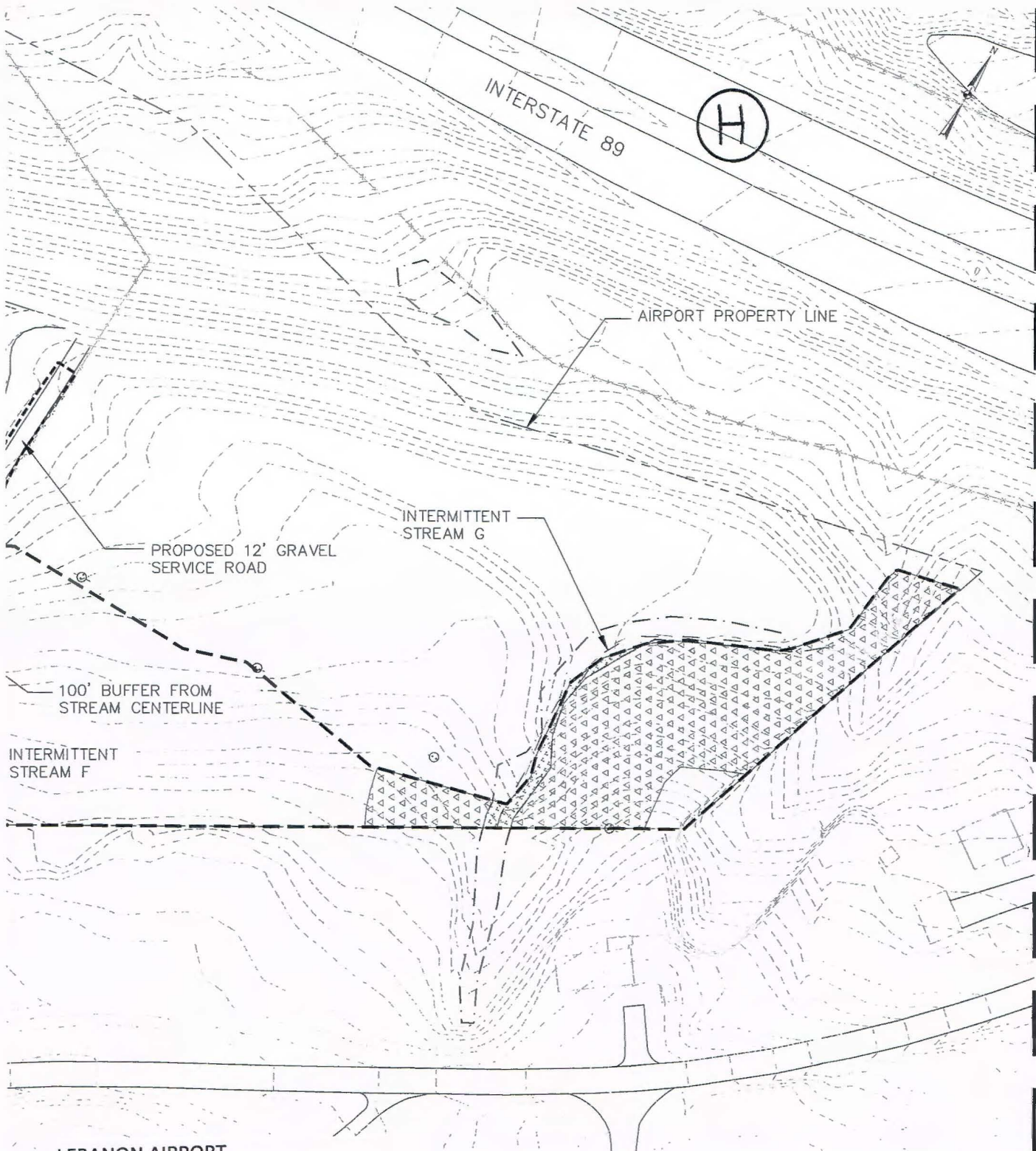

MATCH TO WETLAND IMPACT PLAN 5

LEBANON AIRPORT
 OBSTRUCTION REMOVAL
 NAC-2014-01503
 SEPTEMBER 8, 2014
 PAGE 12 OF 14

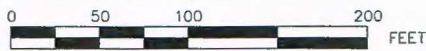

				LEBANON MUNICIPAL AIRPORT OBSTRUCTION REMOVAL				
				WETLAND IMPACT PLAN 4				
REV	DATE	DESCRIPTION	BY	SCALE:	AS SHOWN	DESIGN:	VPC	SHEET:
				DRAWN:	MJF	PROJECT:	T-16995.08	11
				CHECKED:	BLS	DATE:	MAY, 2014	





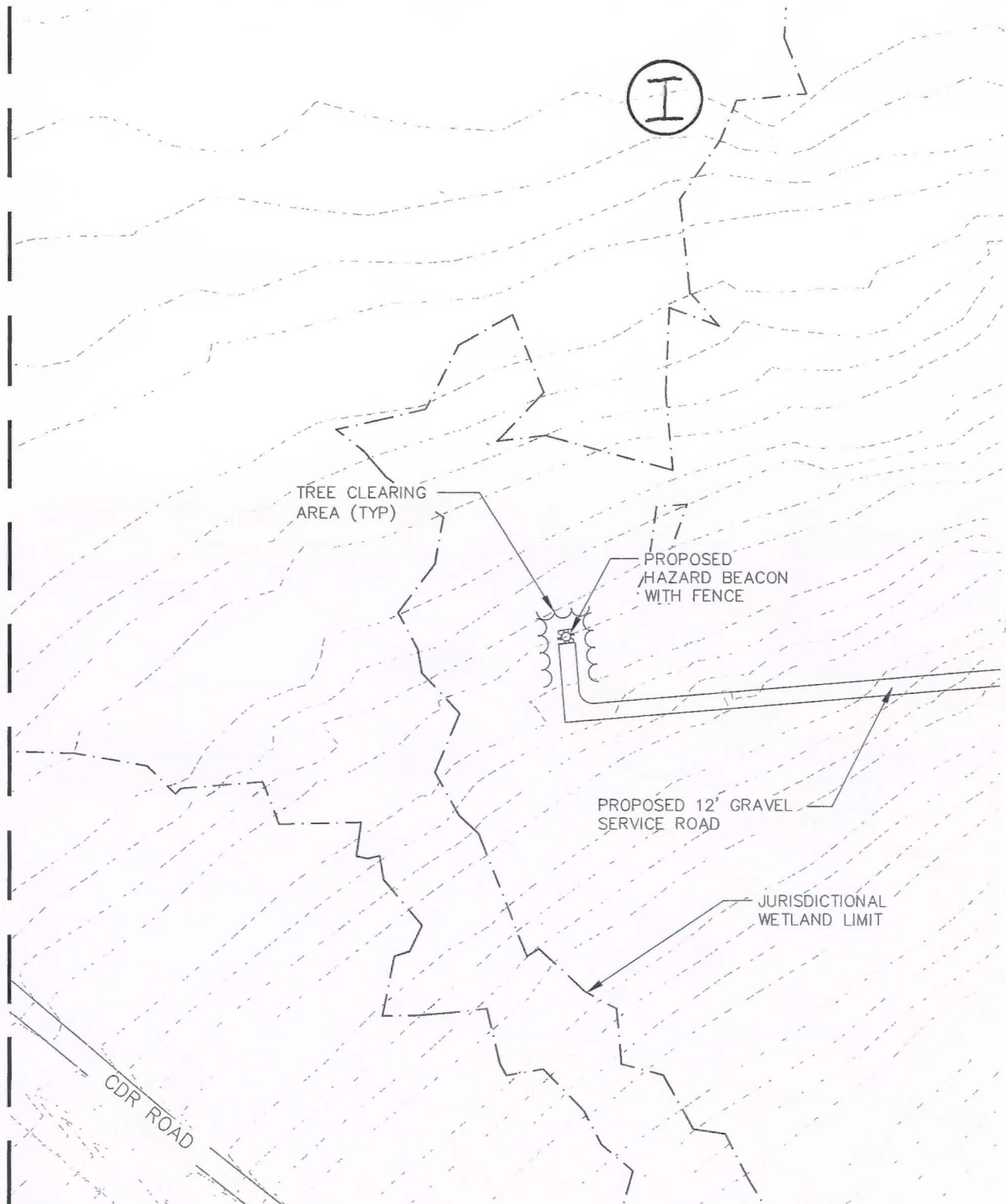

McFarland Johnson
 53 REGIONAL DRIVE, CONCORD, NH 03301-5022
 PH: 603-225-2978 FAX: 603-225-0095

K:\Lebanon Municipal Airport 1-18\13\15.06 Lebanon Airport Tree Clearing\Draw\Drawings\Wetland Impacts Permit\Wetland Impacts.dwg, 5/25/2014 4:04:50 PM

MATCH TO WETLAND IMPACT PLAN 4



LEGEND

-  WETLAND CONVERSION (TREE CLEARING)
-  PERMANENT WETLAND IMPACT
-  WETLAND CONVERSION (TREE CLEARING) WITHIN 100' OF STREAMS
-  UPLAND TREE CLEARING WITHIN 100' OF STREAMS
-  TEMPORARY IMPACT

LEBANON AIRPORT
 OBSTRUCTION REMOVAL
 NAC-2014-01503
 SEPTEMBER 8, 2014
 PAGE 13 OF 14

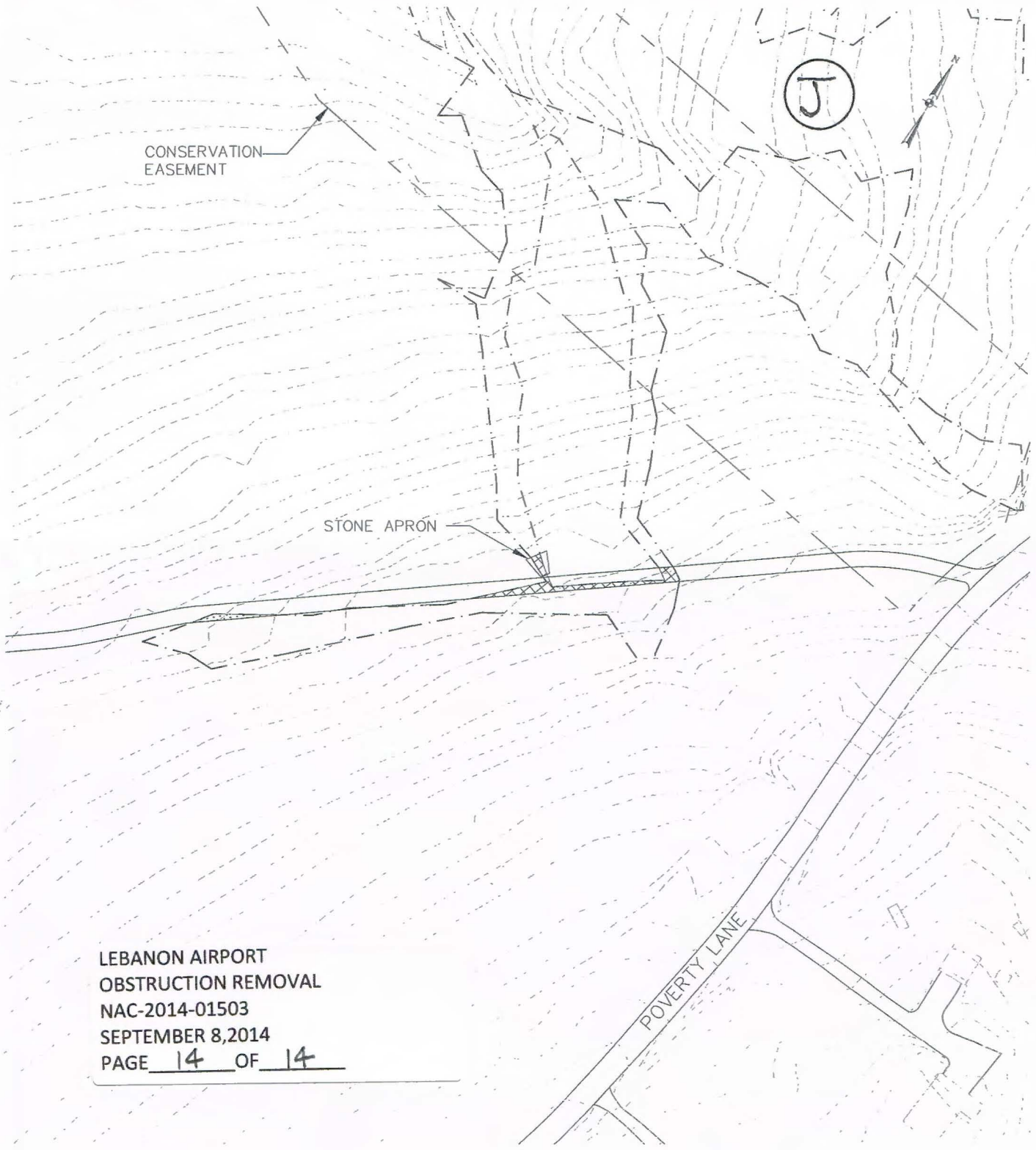

LEBANON AIRPORT
 OBSTRUCTION REMOVAL
 NAC-2014-01503
 SEPTEMBER 8, 2014
 PAGE 14 OF 14



				LEBANON MUNICIPAL AIRPORT OBSTRUCTION REMOVAL					
				WETLAND IMPACT PLAN 5					
REV	DATE	DESCRIPTION	BY	SCALE:	AS SHOWN	DESIGN:	VRC	SHEET:	12
				DRAWN:	MJF	PROJECT:	T-16995.08		
				CHECKED:	BLS	DATE:	MAY, 2014		



McFarland Johnson
 53 REGIONAL DRIVE, CONCORD, NH 03301-5022
 PH: 603-225-2978 FAX: 603-225-0095