



PUBLIC NOTICE

**US Army Corps
of Engineers®**
New England District
Maine Project Office
675 Western Avenue #3
Manchester, Maine 04351

Date: NOV 12, 2013
Comment Period Ends: DEC 12, 2013
File Number: NAE-2012-02578
In Reply Refer To: Jay L. Clement
Or by e-mail: jay.l.clement@usace.army.mil

The District Engineer has received a permit application from the applicant below to **conduct work in waters of the United States** as described below. The Corps is soliciting comments on both the project itself and the range of issues to be addressed in the environmental documentation.

APPLICANT: MAINE DEPT. OF TRANSPORTATION, 16 STATE HOUSE STATION, AUGUSTA, MAINE 04333

ACTIVITY: Place permanent and temporary fill below the ordinary high water line of Whetstone Brook and in adjacent freshwater wetlands at Brownville, Maine in order to replace the existing deteriorated Route 11 bridge. The project will result in approximately 10,350 s.f. of temporary stream bed impact; 3,440 s.f. of permanent stream bed impact; 4,440 s.f. of temporary wetland impact; and 1,025 s.f. of permanent wetland impact.

WATERWAY AND LOCATION OF THE PROPOSED WORK: Whetstone Brook and its adjacent freshwater wetlands; Brownville, Maine. This project is located on the USGS BROWNVILLE JUNCTION quadrangle sheet at Latitude 45.3262611° N; Longitude -69.0450244° W

AUTHORITY

Permits are required pursuant to:

- Section 10 of the Rivers and Harbors Act of 1899
 Section 404 of the Clean Water Act
 Section 103 of the Marine Protection, Research and Sanctuaries Act).

The decision whether to issue a permit will be based on an evaluation of the probable impact of the proposed activity on the public interest. That decision will reflect the national concern for both protection and utilization of important resources. The benefit which may reasonably accrue from the proposal must be balanced against its reasonably foreseeable detriments. All factors which may be relevant to the proposal will be considered, including the cumulative effects thereof; among those are: conservation, economics, aesthetics, general environmental concerns, wetlands, cultural value, fish and wildlife values, flood hazards, flood plain value, land use, navigation, shoreline erosion and accretion, recreation, water supply and conservation, water quality, energy needs, safety, food production and, in general, the needs and welfare of the people.

The Corps of Engineers is soliciting comments from the public; federal, state, and local agencies and officials; Indian Tribes; and other interested parties in order to consider and evaluate the impacts of this proposed activity. Any comments received will be considered by the Corps of Engineers to determine whether to issue, modify, condition or deny a permit for this proposal. To make this decision, comments are used to assess impacts on endangered species, historic properties, water quality, general environmental effects, and the other

public interest factors listed above. Comments are used in the preparation of an Environmental Assessment and/or an Environmental Impact Statement pursuant to the National Environmental Policy Act. Comments are also used to determine the need for a public hearing and to determine the overall public interest of the proposed activity.

Where the activity involves the discharge of dredged or fill material into waters of the United States or the transportation of dredged material for the purpose of disposing it in ocean waters, the evaluation of the impact of the activity in the public interest will also include application of the guidelines promulgated by the Administrator, U.S Environmental Protection Agency, under authority of Section 404(b) of the Clean Water Act, and/or Section 103 of the Marine Protection Research and Sanctuaries Act of 1972 as amended.

SECTION 106 COORDINATION

The Federal Highway Administration ("FHWA") has initiated consultation with the Maine Historic Preservation Commission and Maine's Indian Tribes pursuant to Section 106 of the National Historic Preservation Act of 1966 as amended. This consultation is on-going. Although FHWA has taken the lead in this consultation, the District Engineer is hereby requesting that the appropriate state and Tribal agencies also provide comments to the Corps regarding the presence of and potential impacts to properties listed in, or eligible for listing in, the National Register of Historic Places. FHWA and the Corps will continue consultation as necessary to fulfil requirements under the Historic Preservation Act as part of the permit review process.

ESSENTIAL FISH HABITAT ("EFH")

This work may impact EFH for Atlantic salmon. This habitat consists of stream bottom composed of silt, sand, gravel, and stones. Impact to this species is expected to be minimal with appropriate erosion control measures, in stream work windows, and other best management practices. Therefore, the District Engineer has made a preliminary determination that the site-specific adverse effect will be minimal. Further consultation with the federal resource agencies regarding EFH conservation recommendations is being conducted and will be concluded prior to the final decision. Similarly, consultation will be initiated regarding the presence of salmon as they are a federally listed endangered species.

ENDANGERED SPECIES ACT CONSULTATION

FHWA has initiated formal consultation with the US Fish & Wildlife Service pursuant to Section 7 of the Endangered Species Act regarding the presence of Atlantic salmon and Atlantic salmon critical habitat. It is the opinion of FHWA and the Service that the proposed work may adversely affect but is not likely to jeopardize the continued existence of Atlantic salmon or result in the destruction or adverse modification of designated Atlantic salmon critical habitat. Although FHWA has taken the lead in this consultation, the District Engineer is hereby requesting that the appropriate federal agency also provide comments to the Corps regarding the presence of and potential impacts to listed species or critical habitat.

The following authorizations have been applied for, or have been, or will be obtained:

- Permit, License or Assent from State.
- Permit from Local Wetland Agency or Conservation Commission.
- Water Quality Certification in accordance with Section 401 of the Clean Water Act.

In order to properly evaluate the proposal, we are seeking public comment. Anyone wishing to comment is encouraged to do so. **Comments should be submitted in writing by the above date.** If you have any questions, please contact Jay Clement at 207-623-8367 at our Manchester, Maine Project Office.

Any person may request, in writing, within the comment period specified in this notice, that a public hearing be held to consider the application. Requests for a public hearing shall specifically state the reasons for holding a public hearing. The Corps holds public hearings for the purpose of obtaining public comments when that is the best means for understanding a wide variety of concerns from a diverse segment of the public.

The initial determinations made herein will be reviewed in light of facts submitted in response to this notice. All comments will be considered a matter of public record. Copies of letters of objection will be forwarded to the applicant who will normally be requested to contact objectors directly in an effort to reach an understanding.

For more information on the New England District Corps of Engineers programs, visit our website at <http://www.nae.usace.army.mil>.

THIS NOTICE IS NOT AN AUTHORIZATION TO DO ANY WORK.

Frank J. Del Giudice
Chief, Permits and Enforcement Branch
Regulatory Division

If you would prefer not to continue receiving Public Notices, please contact Ms. Tina Chaisson at (978) 318-8058 or e-mail her at bettina.m.chaisson@usace.army.mil. You may also check here () and return this portion of the Public Notice to: Bettina Chaisson, Regulatory Division, U.S. Army Corps of Engineers, 696 Virginia Road, Concord, MA 01742-2751.

NAME: _____
ADDRESS: _____

45.333° N

45.333° N

45.3° N

45.3° N

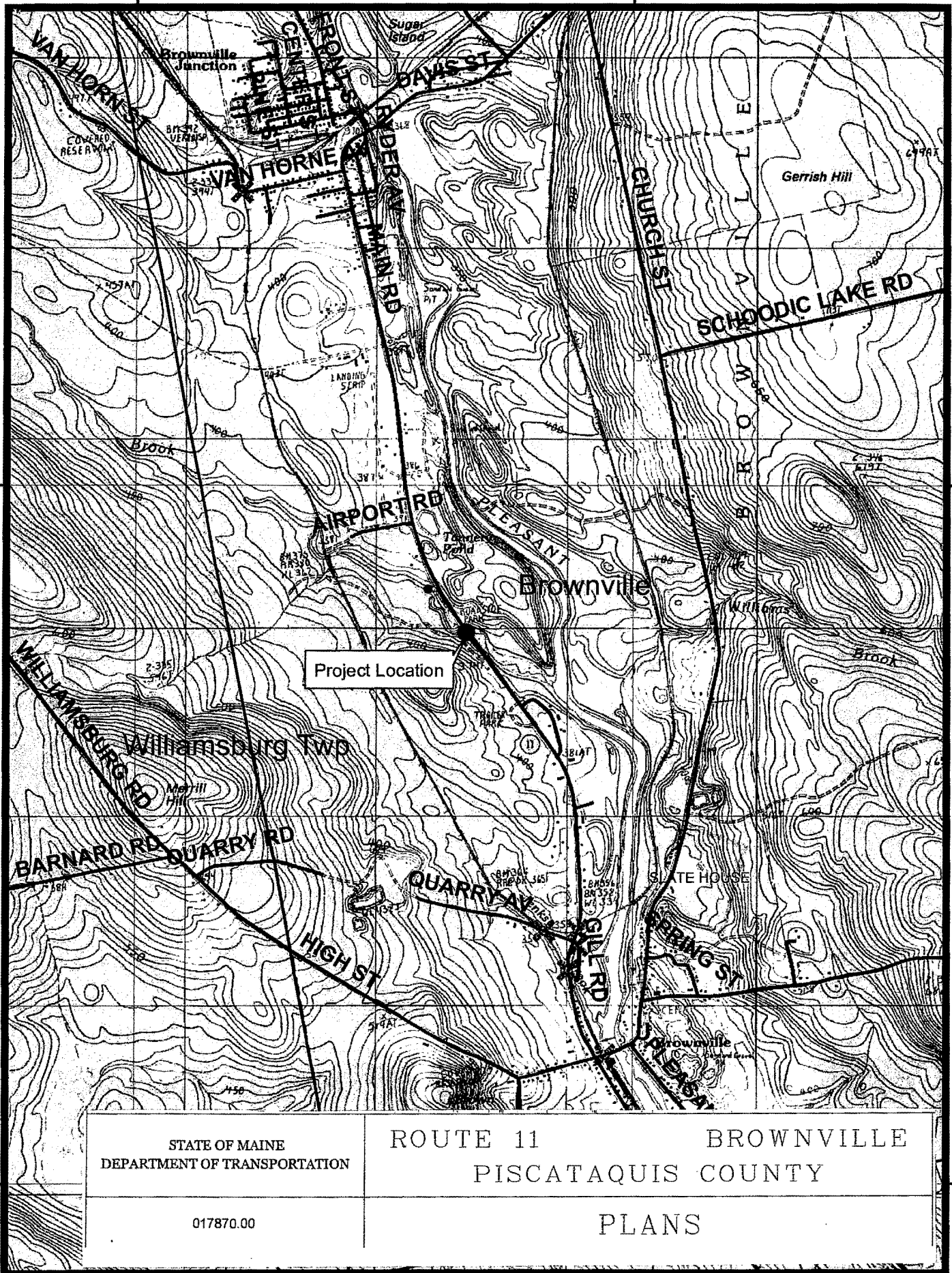

STATE OF MAINE
DEPARTMENT OF TRANSPORTATION

ROUTE 11 BROWNVILLE
PISCATAQUIS COUNTY

017870.00

PLANS

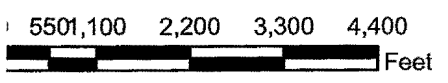

Brownville
17870.00

Route 11- Whetstone Bridge



SECTION H: IMPACT PLANS & PROJECT PLANS

017870.00

STATE OF MAINE
DEPARTMENT OF TRANSPORTATION

RUS Permanent IMPACTS = 3440 s.f.

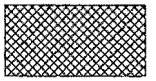

PSS PERMANENT IMPACTS = 1025 s.f.



RUS TEMPORARY IMPACTS = 10,350 S.F.

PSS TEMPORARY IMPACTS = 4,400

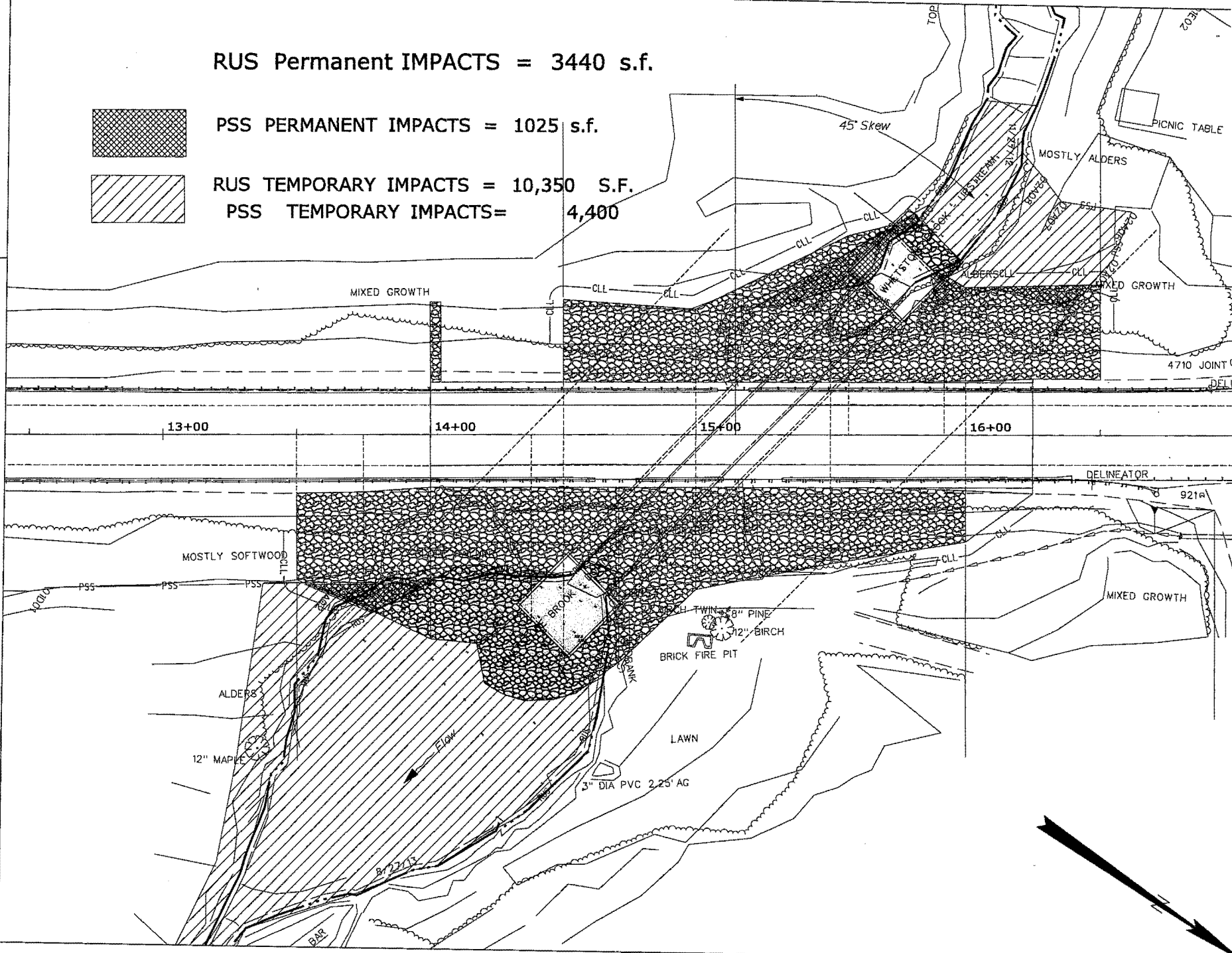

ROUTE 11
PISCATAQUIS COUNTY
BROWNVILLE

PLANS

SHEET NUMBER

1

OF 1

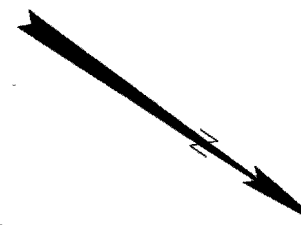

26'-0" Span x 11'-0" Rise
Precast Concrete Box

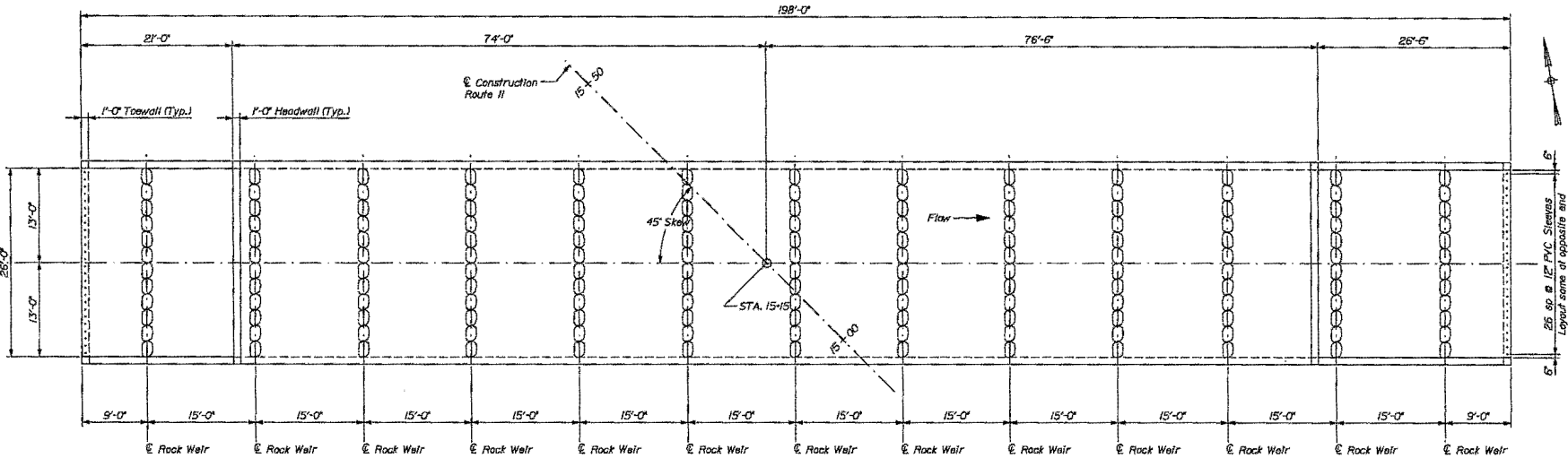

PRECAST CONCRETE BOX PLAN

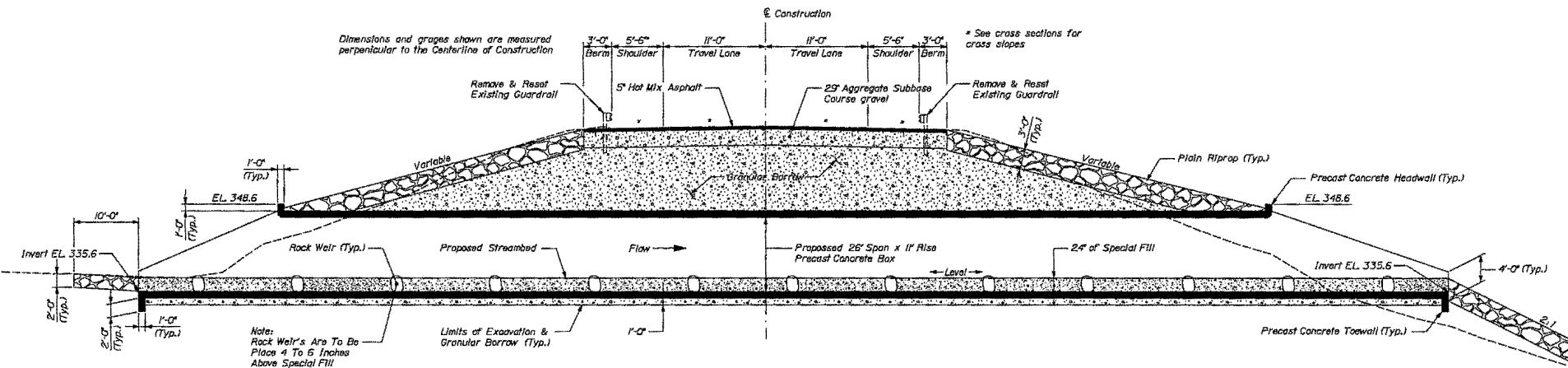

PROPOSED BRIDGE TRANSVERSE SECTION & APPROACH SECTION
(Along Centerline of Concrete Box)

PRECAST CONCRETE BOX NOTES

- The handling, and assembly of the precast units shall be in accordance with Special Provisions Section 534, Precast Structural Concrete, and with the manufacturer's specifications as applicable.
- Granular Borrow for the precast box bedding and backfill within the limits of excavation shall meet the requirements of Special Provision 534 and be compacted to no less than 92% of AASHTO T-180. All backfill material required for the reconstruction of roadway embankment removed to allow installation of the precast box and outside of the limits of excavation shall meet the requirements of Section 203.12 - Construction of Earth Embankment with Moisture and Density Control, except that the minimum required compaction shall be 92% of AASHTO T-180, Method C or D.

NO.	DATE	BY	DATE	BY
DESIGN CHECKED: P.B.	5/11/2012	SUN	5/11/2012	SIGNATURE
ENGINEER REVIEWED: P.B.		BAS		
DESIGN DEVELOPER: M.F.				
DESIGN REVIEWER: L.B.				
REVISIONS				
REVISION 1				
REVISION 2				
REVISION 3				

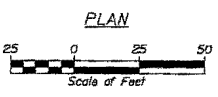
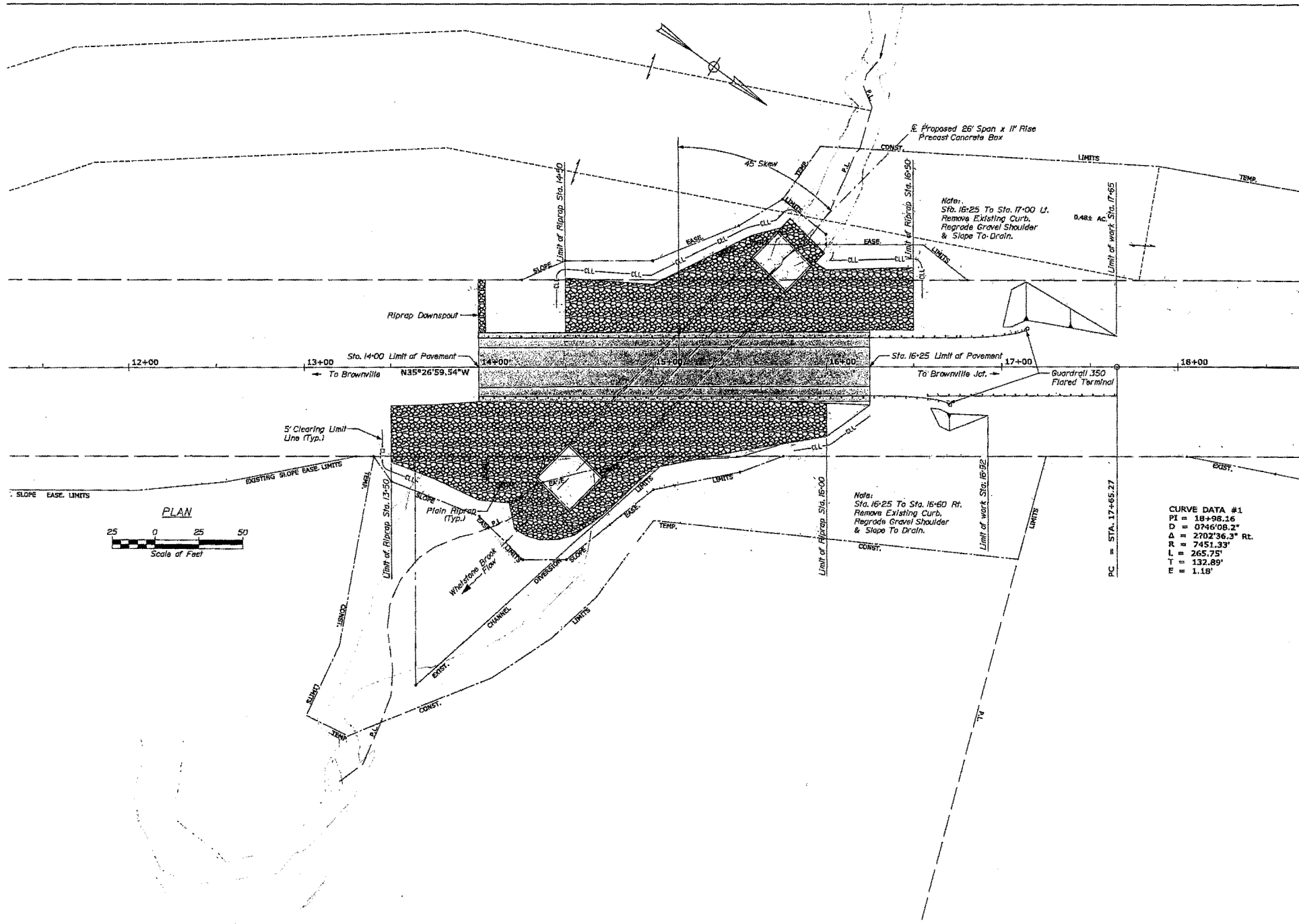

Proposed 26' Span x 11' Rise
Precast Concrete Box

Note:
Sta. 16+25 To Sta. 17+00 L.
Remove Existing Curb,
Regrade Gravel Shoulder
& Slope To Drain.

Note:
Sta. 16+25 To Sta. 16+60 R.
Remove Existing Curb,
Regrade Gravel Shoulder
& Slope To Drain.

CURVE DATA #1

PI	18+98.16
D	8746'08.2"
Δ	2702'36.3" RT.
R	7451.33'
T	265.75'
M	132.89'
e	1.18'

STATE OF MAINE
DEPARTMENT OF TRANSPORTATION
STP-1787(000)X

DATE	BY	DR	CHK	INSP	SVL	SGN

PROJECT NO. 1787
SHEET NO. 3

WHETSTONE BRIDGE
WHETSTONE BROOK
BROWNVILLE
PISCATAQUIS COUNTY
GENERAL PLANS

SHEET NUMBER
3
OF 3

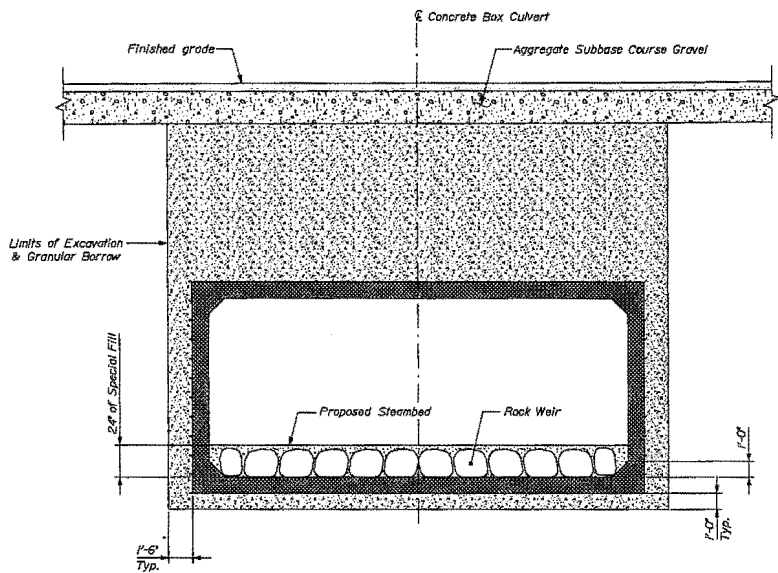

TYPICAL SECTION
(Shown through Rock Weir)

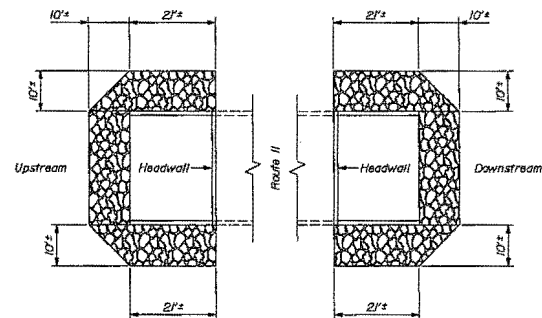

RIPRAP LAYOUT
Rock Weir not shown for clarity

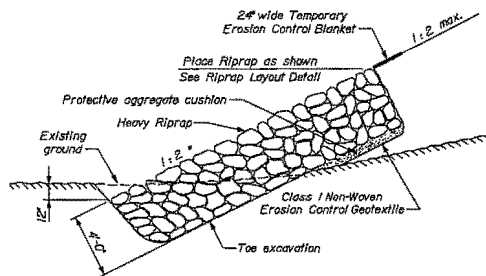

RIPRAP SIDE SLOPE

* Match ends of Concrete Box Culvert
(Refer to Page 620(05) for specific
details on geotextile placement)

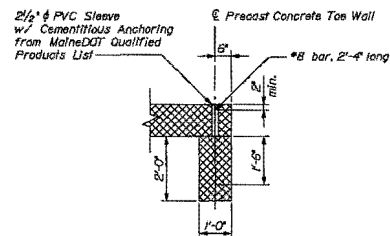

PRECAST CONCRETE TOEWALL DETAIL

PROJ. NUMBER	DATE	BY	DATE	BY	DATE	BY	DATE
DESIGN-DETAILS		EN	REVISED	REVISIONS	DATE	BY	DATE
CONSTRUCTION		CS					
REVISIONS-DETAILS		LD					
REVISIONS 1		LD					
REVISIONS 2		LD					
REVISIONS 3		LD					
REVISIONS 4		LD					
REVISIONS 5		LD					