



**US Army Corps
of Engineers®**
New England District
**696 Virginia Road
Concord, MA 0174**

15- DAY PUBLIC NOTICE

Comment Period Begins: September 24, 2013
Comment Period Ends: October 9, 2013
File Number: NAE-2011-1972
In Reply Refer To: Lindsay Flieger
Phone: (978) 318-8656
E-mail: Lindsay.Flieger@usace.army.mil

The District Engineer has received a permit application from the Sachem Head Yacht Club below to conduct work in waters of the United States as described below. **This proposal was previously described in our public notice dated August 6, 2013. This public notice serves to provide time for additional members of the public the opportunity to comment.**

APPLICANT Sachem's Head Yacht Club

ACTIVITY To authorize existing docks and two moorings fields at a yacht club facility. Work also includes repairing an existing stone groin. A detailed description and plans of the activity are attached.

WATERWAY AND LOCATION OF THE PROPOSED WORK

This work is proposed in Long Island Sound at 61 Chimney Corner Circle, Guilford, Connecticut. The proposed location on the USGS Guilford quadrangle sheet is at UTM coordinates 41.2448 N and -72.7085 W.

AUTHORITY

Permits are required pursuant to:

☒ Section 10 of the Rivers and Harbors Act of 1899

☒ Section 404 of the Clean Water Act

☐ Section 103 of the Marine Protection, Research and Sanctuaries Act.

The decision whether to issue a permit will be based on an evaluation of the probable impact of the proposed activity on the public interest. That decision will reflect the national concern for both protection and utilization of important resources. The benefit which may reasonably accrue from the proposal must be balanced against its reasonably foreseeable detriments. All factors which may be relevant to the proposal will be considered, including the cumulative effects thereof; among those are: conservation, economics, aesthetics, general environmental concerns, wetlands, cultural value, fish and wildlife values, flood hazards, flood plain value, land use, navigation, shoreline erosion and accretion, recreation, water supply and conservation, water quality, energy needs, safety, food production and, in general, the needs and welfare of the people.

The Corps of Engineers is soliciting comments from the public; Federal, state, and local agencies and officials; Indian Tribes; and other interested parties in order to consider and evaluate the impacts of this proposed activity. Any comments received will be considered by the Corps of Engineers to determine whether to issue, modify, condition or deny a permit for this proposal. To make this decision, comments are used to assess impacts on endangered species, historic properties, water quality, general environmental effects, and the other public interest factors listed above. Comments are used in the preparation of an Environmental Assessment and/or an Environmental Impact Statement pursuant to the National Environmental Policy Act. Comments are

CENAE-R
FILE NO. NAE-2011-1972

also used to determine the need for a public hearing and to determine the overall public interest of the proposed activity.

Where the activity involves the discharge of dredged or fill material into waters of the United States or the transportation of dredged material for the purpose of disposing it in ocean waters, the evaluation of the impact of the activity in the public interest will also include application of the guidelines promulgated by the Administrator, U.S Environmental Protection Agency, under authority of Section 404(b) of the Clean Water Act, and/or Section 103 of the Marine Protection Research and Sanctuaries Act of 1972 as amended.

The Magnuson-Stevens Fishery Conservation and Management Act, as amended by the Sustainable Fisheries Act of 1996 (Public Law 104-267), requires all federal agencies to consult with the National Marine Fisheries Service on all actions, or proposed actions, permitted, funded, or undertaken by the agency, that may adversely affect Essential Fish Habitat (EFH).

This project may adversely impact some shellfish beds. However, the District Engineer has made a preliminary determination that the site-specific adverse effect will not be substantial. Further consultation with the National Marine Fisheries Service regarding EFH conservation recommendations is being conducted and will be concluded prior to the final decision.

The New England District, Army Corps of Engineers has reviewed the list of species protected under the Endangered Species Act of 1973, as amended, which might occur at the project site. It is our preliminary determination that the proposed activity for which authorization is being sought is designed, situated or will be operated/used in such a manner that it is not likely to adversely affect any Federally listed endangered or threatened species or their designated critical habitat. By this Public Notice, we are requesting that the appropriate Federal Agency concur with our determination.

The States of Connecticut, Maine, Massachusetts, New Hampshire and Rhode Island have approved **Coastal Zone Management Programs**. Where applicable the applicant states that any proposed activity will comply with and will be conducted in a manner that is consistent with the approved Coastal Zone Management Program. By this Public Notice, we are requesting the State concurrence or objection to the applicant's consistency statement.

The following authorizations have been applied for, or have been, or will be obtained:

- ☒ Permit, License or Assent from State.
- ☐ Permit from Local Wetland Agency or Conservation Commission.
- ☐ Water Quality Certification in accordance with Section 401 of the Clean Water Act.

In order to properly evaluate the proposal, we are seeking public comment. Anyone wishing to comment is encouraged to do so. **Comments should be submitted in writing by the above date.** If you have any questions, please contact Lindsay Flieger at (978) 318-8656, (800) 343-4789 or (800) 362-4367, if calling from within Massachusetts.

Any person may request, in writing, within the comment period specified in this notice, that a public hearing be held to consider the application. Requests for a public hearing shall specifically state the reasons for holding a public hearing. The Corps holds public hearings for the purpose of obtaining public comments when that is the best means for understanding a wide variety of concerns from a diverse segment of the public.

CENAE-R
FILE NO. NAE-2011-1972

The initial determinations made herein will be reviewed in light of facts submitted in response to this notice. All comments will be considered a matter of public record. Copies of letters of objection will be forwarded to the applicant who will normally be requested to contact objectors directly in an effort to reach an understanding.

THIS NOTICE IS NOT AN AUTHORIZATION TO DO ANY WORK.



Robert J. DeSista
Chief, Permits and Enforcement Branch
Regulatory Division

If you would prefer not to continue receiving Public Notices, please contact Ms. Tina Chaisson at (978) 318-8058 or e-mail her at bettina.m.chaisson@usace.army.mil. You may also check here () and return this portion of the Public Notice to: Bettina Chaisson, Regulatory Division, U.S. Army Corps of Engineers, 696 Virginia Road, Concord, MA 01742-2751.

NAME: _____
ADDRESS: _____

PROPOSED WORK AND PURPOSE

The project includes work in navigable waters to repair an existing stone groin and authorize existing dock structures. Work also includes maintaining two existing mooring fields located adjacent to the Sachem's Head Yacht Club (SHYC). The proposed project is located in Long Island Sound on a small island accessed via a pedestrian bridge from 61 Chimney Corner Circle in Guilford, Connecticut.

The applicant is seeking to: 1) maintain existing sections of seasonal floating docks approximately 24.5' wide x 91' long on the eastern side of the island, 2) maintain two existing 16' wide x 20' long seasonal floating docks, four 10' wide x 20' long floating docks, and one 10' wide x 25' long floating dock on the northern side of the island, 3) maintain an existing 5' wide x 40' long wooden pier and a 4' wide x 26' long ramp and two 12' wide x 20' long floating docks on the northwestern corner of the property, 4) maintain two existing 10' wide x 20' long floating docks located north off of the shoreline of the aforementioned pier, 5) conduct maintenance to the existing stone groin off the northwestern corner of the island which will consist of taking displaced stones and placing them back on the groin; up to 25 cubic yards of additional stone may be necessary and work will be performed using a barge-mounted crane during high tide cycles.

The SHYC also proposes to retain and authorize 128 moorings (and two transient moorings) located in the adjacent Sachem Head Harbor and 20 moorings located in Joshua Cove Harbor. Both fields are managed and maintained by the SHYC with oversight by Sachem's head Harbor Management Commission.

The work is described on the enclosed plans entitled "Existing Dock and Mooring Field Authorization, Groin Maintenance, Sachem Head Yacht Club, 61 Chimney Corner Circle, New Haven County, Guilford, Connecticut" on 11 sheets, and dated "August 2, 2012" and revised "July 25, 2013."

EXISTING DOCK AND MOORING FIELD AUTHORIZATION

GROIN MAINTENANCE

Sachem Head Yacht Club

61 Chimney Corner Circle
New Haven County
Guilford, Connecticut

GENERAL NOTES:

1. BASE MAP COMPILED FROM THE FOLLOWING REFERENCE MAPS:
 - 1.1. "IMPROVEMENT LOCATION SURVEY FOR SACHEM HEAD YACHT CLUB - 61 CHIMNEY CORNER CIRCLE, GUILFORD, CONNECTICUT", SCALE: 1"=10'; DATED: JANUARY 26, 2012; REVISED: 1-30-12 AND PREPARED BY ANDERSON ENGINEERING & SURVEYING ASSOCIATES
 - 1.2. "FIGURE 1 PROPOSED MOORING FIELD PLAN - SACHEM'S HEAD HARBOR/JOSHUA COVE, GUILFORD, CONNECTICUT", SCALE: 1" = 100'; DATED: JUNE 27, 2006 AND PREPARED BY COASTLINE CONSULTING, LLC
 - 1.3. GENERAL LOCATION SURVEY SET IN GEODETIC DATUM PREPARED BY ANDERSON ENGINEERING AND SURVEYING ASSOCIATES IN SEPTEMBER 2012.
2. THIS PLAN SHOULD ONLY BE USED FOR GENERAL PRESENTATION AND NOT FOR CONSTRUCTION PURPOSES. ALL STRUCTURES, UTILITIES AND ELEVATIONS SHOULD BE FIELD VERIFIED PRIOR TO THE START OF ANY WORK.
3. THE ENGINEERING SEAL AND SIGNATURE IS PROVIDED TO INDICATE GENERAL CONFORMANCE WITH COASTAL ENGINEERING PRACTICE. THE ATTACHED DESIGNS ARE CONCEPTUAL AND FOR THE PURPOSE OF PERMITTING ONLY. THEY DO NOT INCLUDE A STRUCTURAL ENGINEERING ANALYSIS.

Drawing List

1 of 12	-	Cover Sheet
2 of 12	-	Site Location Map
3 of 12	-	Assessor's Map
4 of 12	-	Overall View - Aerial Image
5 of 12	-	Mooring Field West
6 of 12	-	Mooring Field East
7 of 12	-	Dock Installation
8 of 12	-	Groin Repair
9 of 12	-	Cross Sections A & B
10 of 12	-	Cross Section C-C
11 of 12	-	Cross Section D-D

Date: August 2, 2012

Revised: 7/25/2013

Permitting Agent: John B. Lust

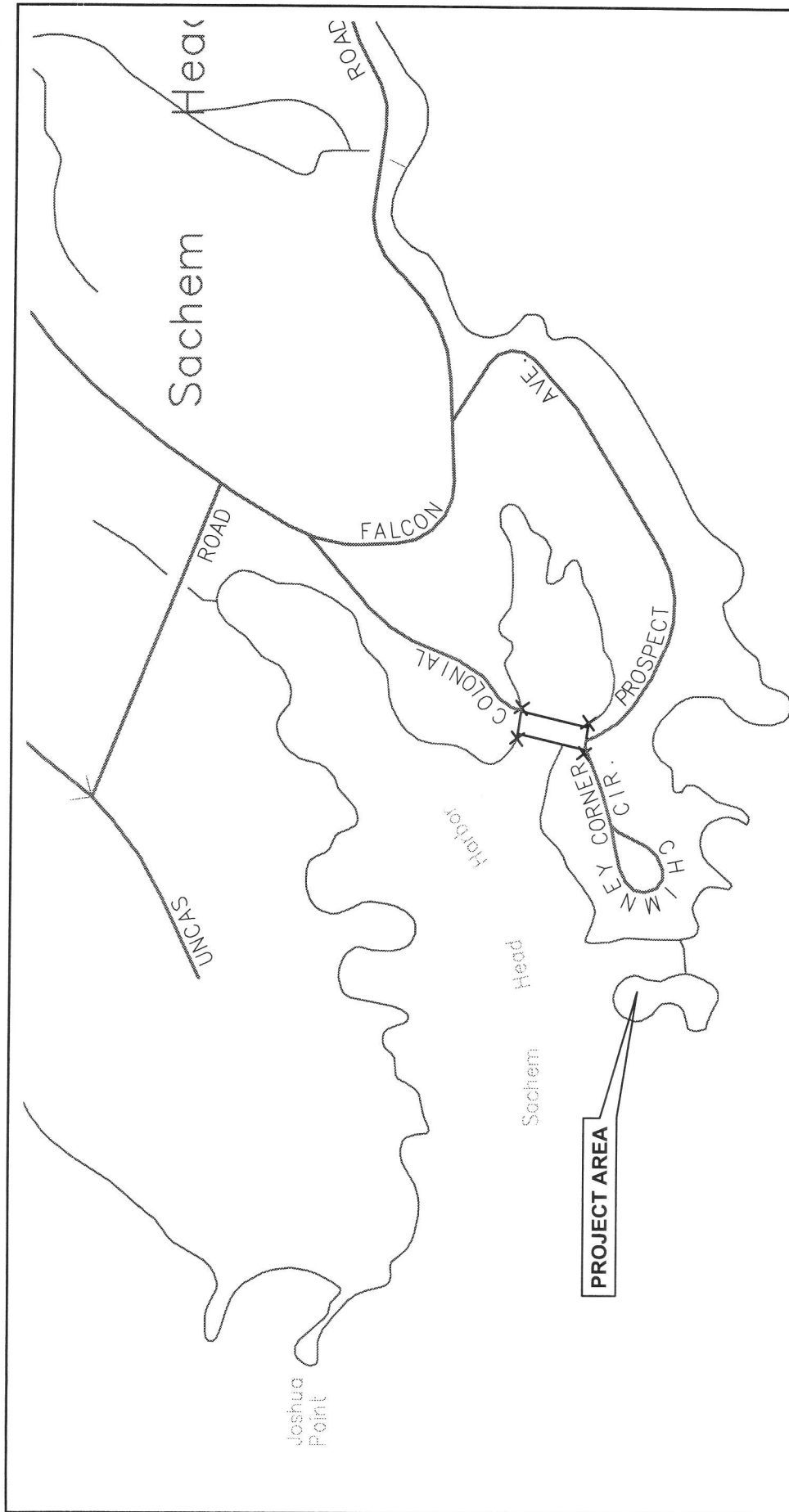

SITE LOCATION MAP

Scale: 1" = 500'



0 SCALE REF. 1"

PROJECT LOCATION MAP TAKEN FROM CT D.O.T. ELECTRONIC ROAD (TRU) MAPS.

Applicant	SACHEM HEAD YACHT CLUB 61 CHIMNEY CORNER CIRCLE NEW HAVEN COUNTY GUILFORD, CONNECTICUT
SITE LOCATION MAP Sheet: 2 of 12	

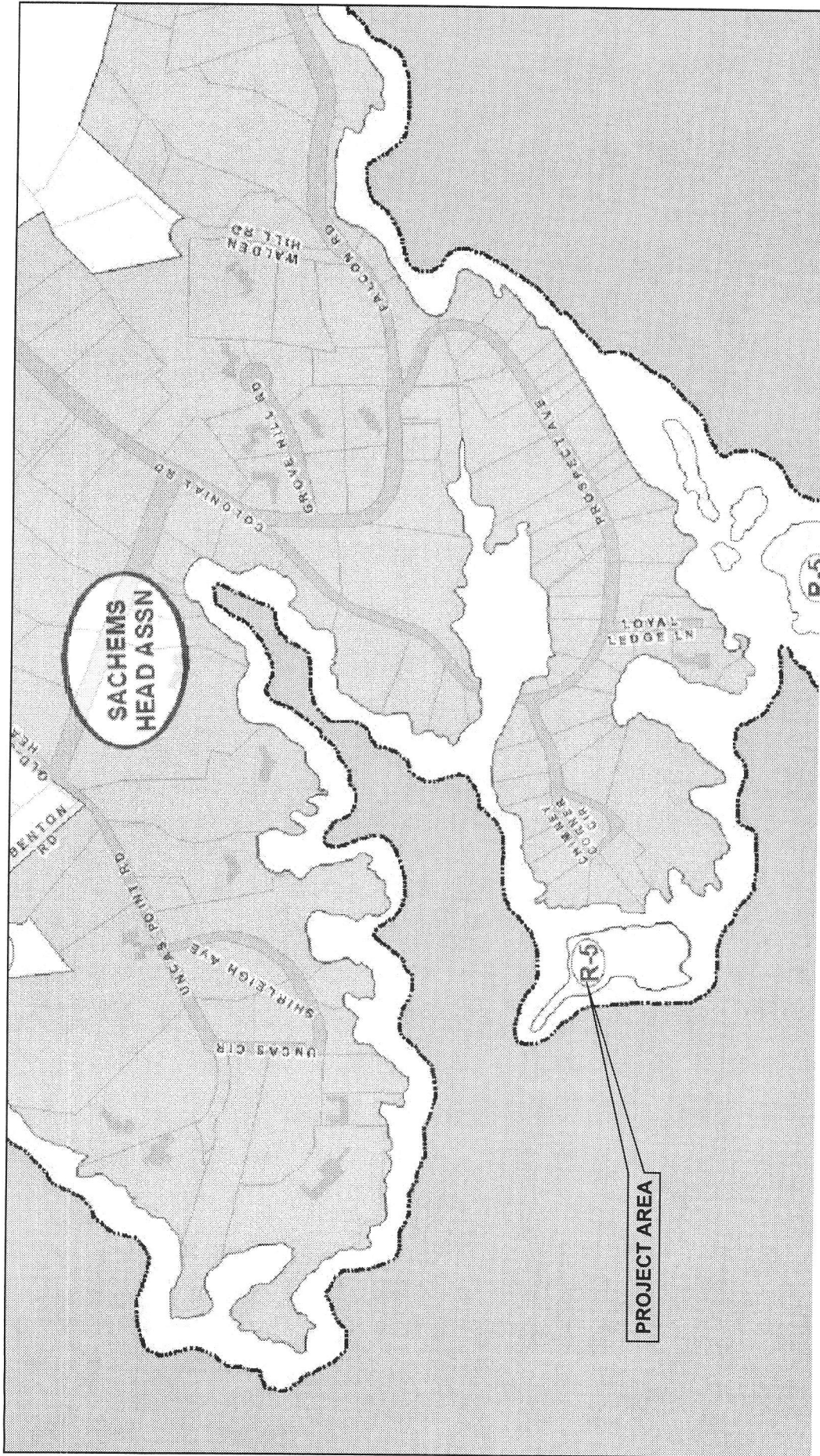

ASSESSOR MAP

Scale: 1" = 500'

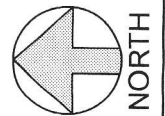

0 SCALE REF. 1"

TOWN OF GUILFORD GEOGRAPHIC INFORMATION SYSTEMS (GIS) IN JULY 2013

Applicant	SACHEM HEAD YACHT CLUB 61 CHIMNEY CORNER CIRCLE NEW HAVEN COUNTY GUILFORD, CONNECTICUT
ASSESSOR MAP	Sheet: 3 of 12

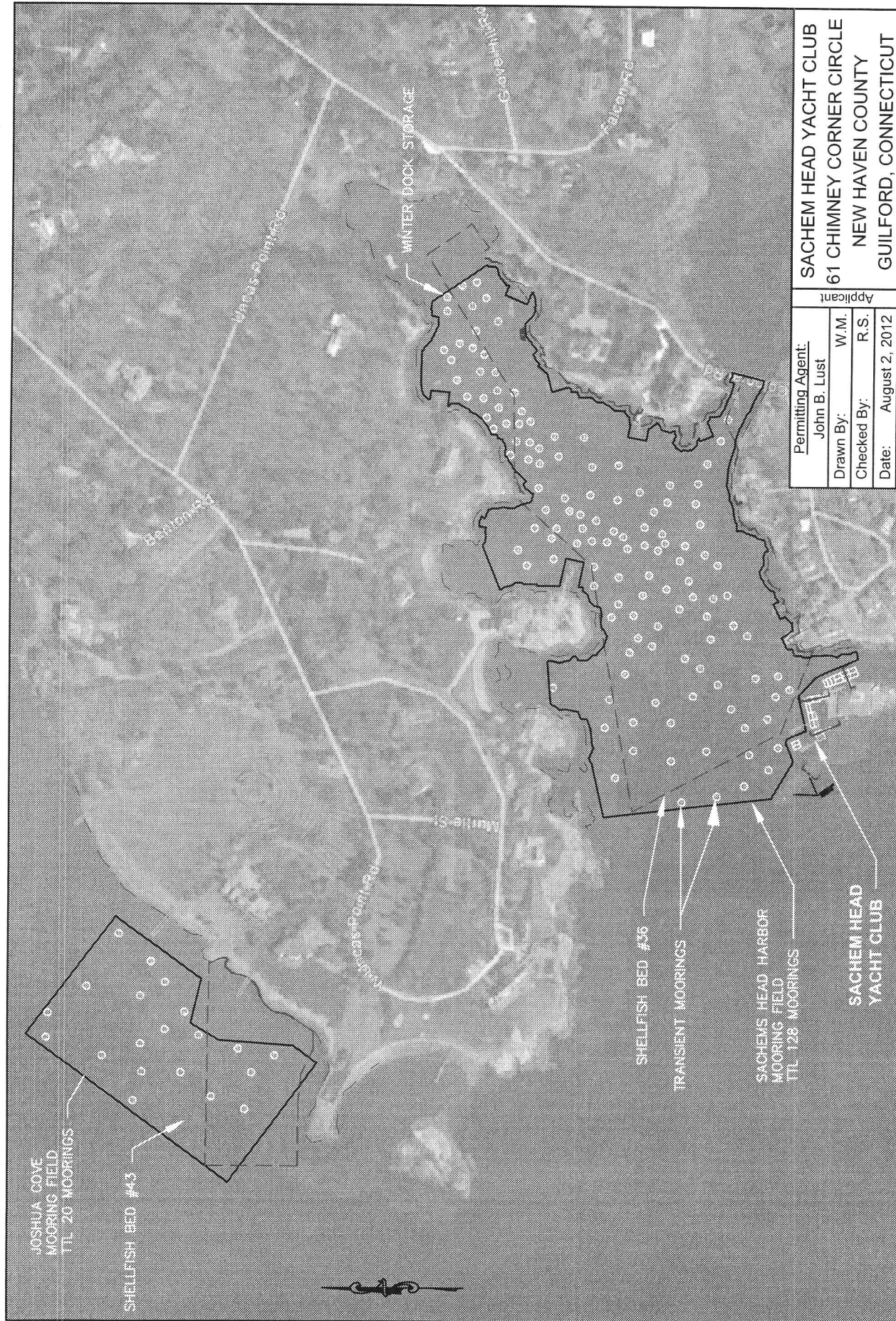

<div>DRAWING NOTES:</div> <div>1. TOTAL MOORING = 148</div>		<div>GRAPHIC SCALE</div> <div><div><div>0</div><div>175</div><div>350</div></div><div>(IN FEET)</div></div>	
Revised: 7/25/2013		Project	
DATUM = NGVD 29		MOORING FIELDS	
CJL = 5.1		AERIAL IMAGE	
MHW = 3.4		OVERALL VIEW	
MLW = --2.0		Sheet: 4 of 12	

DRAWING NOTES:

1. COORDINATES SHOWN ARE IN CT STATE PLANE NAD 83 DATUM
2. TOTAL MOORINGS IN SACHEMS COVE = 128
3. SOUNDING DEPTHS ARE IN MEAN LOW WATER DATUM PER REF. MAP 1.2

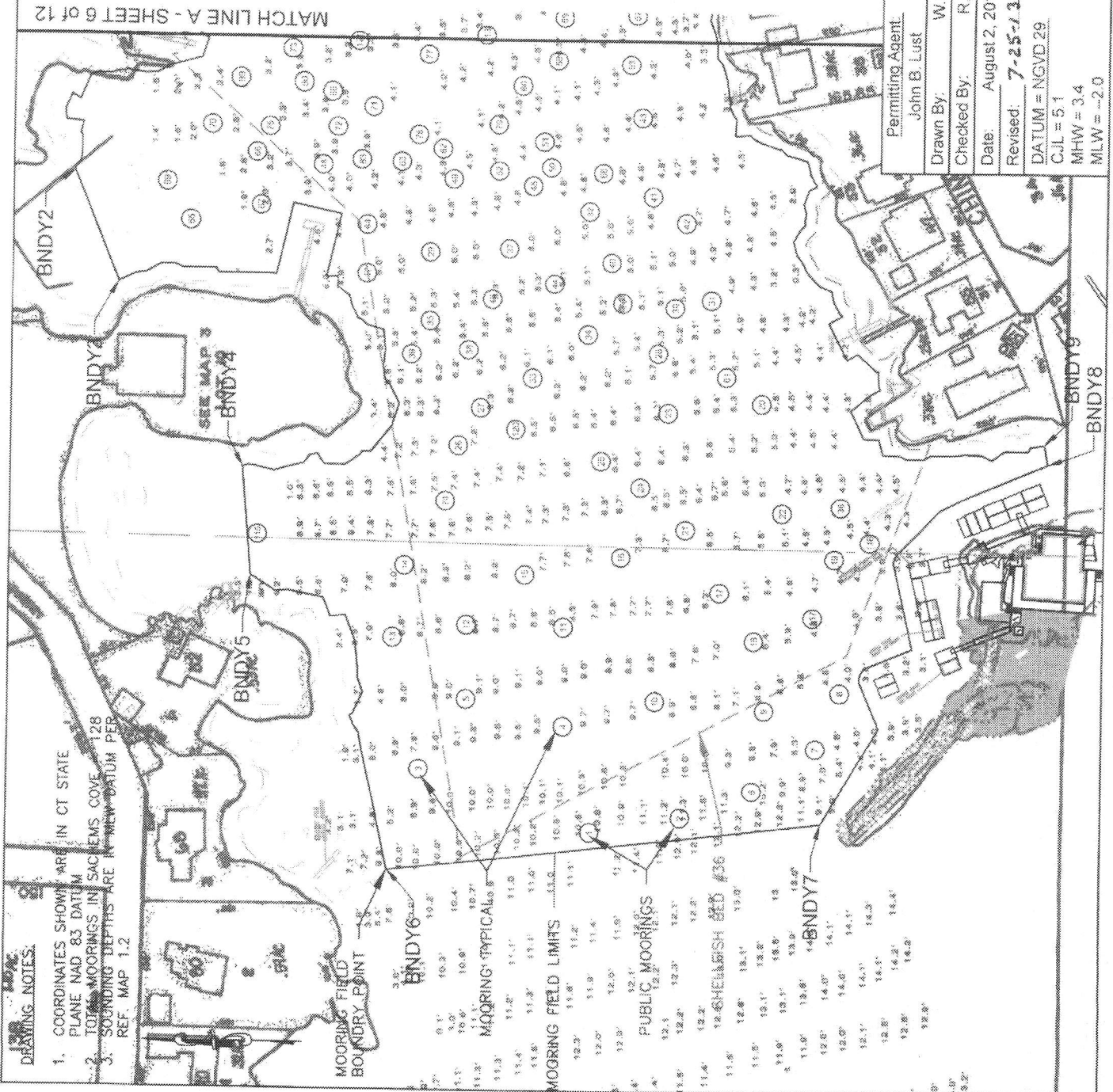

Point Table		
Boundary	Northing	Easting
BNDY1	651178.96	1012085.66
BNDY2	651036.69	1011434.56
BNDY3	650990.41	1011320.02
BNDY4	650862.14	1011130.00
BNDY5	650852.58	1011016.88
BNDY6	650708.52	1010713.68
BNDY7	650260.82	1010765.30
BNDY8	650032.45	1011141.64
BNDY9	650035.96	1011162.50
BNDY10	650286.70	1011881.81
BNDY11	650372.08	1011903.05
BNDY12	651031.75	1012181.93

SOUNDING DEPTHS ARE IN MEAN LOW
WATER DATUM PER REFERENCE MAP 1.2

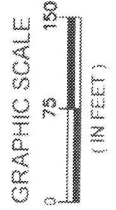

Permitting Agent John B. Lust	W.M.
Drawn By:	R.S.
Checked By:	
Date: August 2, 2012	
Revised: 7-25-13	
DATUM = NGVD 29	
C.U.L. = 5.1	
M.H.W. = 3.4	
MLW = -2.0	

SACHEM HEAD YACHT CLUB 61 CHIMNEY CORNER CIRCLE NEW HAVEN COUNTY GUILFORD, CONNECTICUT
SACHEMS HEAD COVE MOORING FIELD
EXISTING CONDITIONS
PLAN VIEW

Sheet: 5 of 12

MATCH LINE A - SHEET 5 OF 12

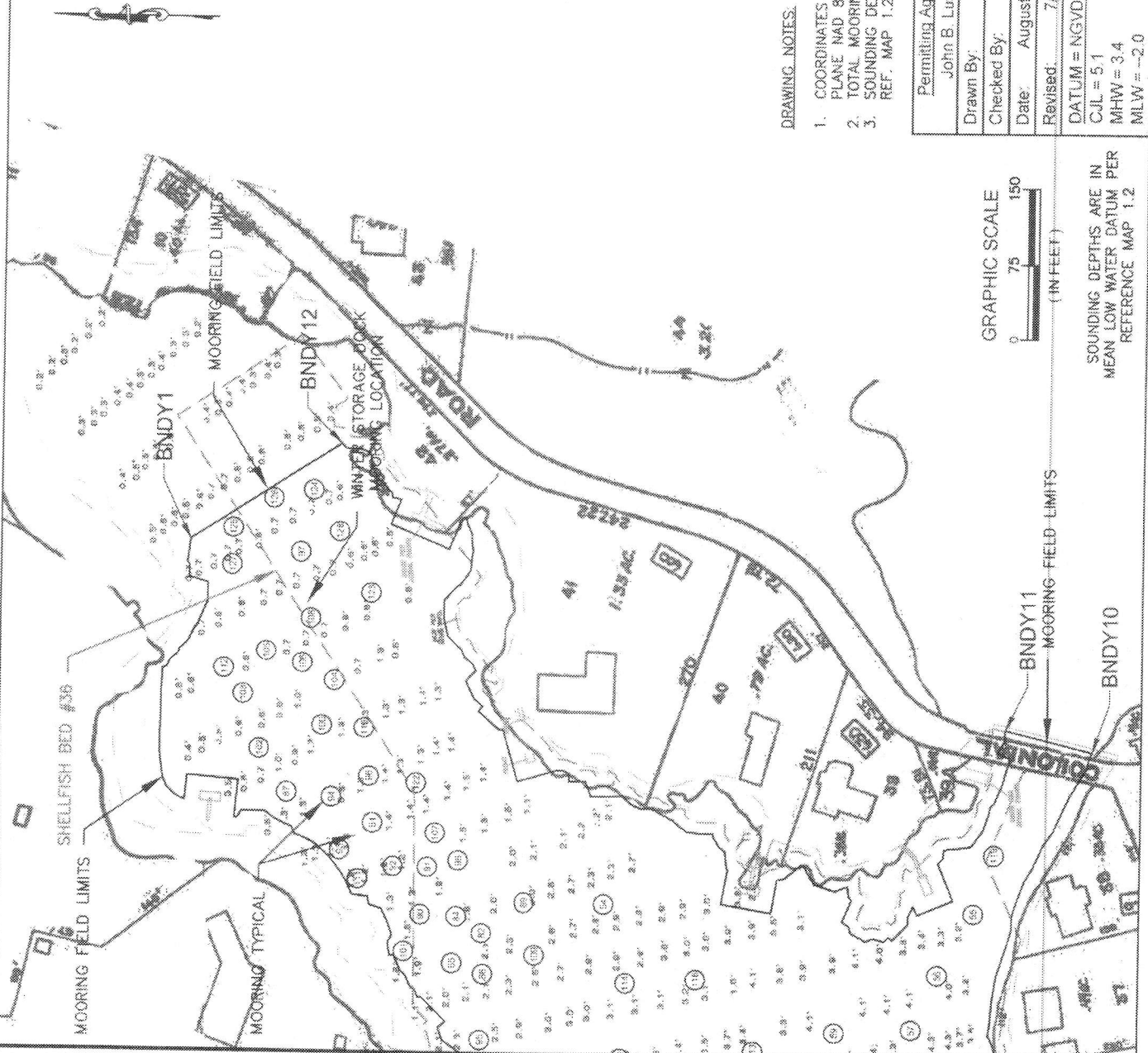

DRAWING NOTES:

1. COORDINATES SHOWN ARE IN CT STATE PLANE NAD 83 DATUM
2. TOTAL MOORINGS IN SACHEMS COVE = 128
3. SOUNDING DEPTHS ARE IN MLW DATUM PER REF. MAP 1.2

Point Table		
Boundary	Northing	Eastings
BNDY1	651178.96	1012085.66
BNDY2	651036.69	1011434.56
BNDY3	650990.41	1011320.02
BNDY4	650862.14	1011130.00
BNDY5	650852.58	1011016.88
BNDY6	650708.52	1010713.88
BNDY7	650260.82	1010763.30
BNDY8	650032.45	1011141.64
BNDY9	650035.96	1011162.50
BNDY10	650286.70	1011881.81
BNDY11	650372.08	1011903.05
BNDY12	651031.75	1012181.93

Permitting Agent: John B. Lust		SACHEM HEAD YACHT CLUB 61 CHIMNEY CORNER CIRCLE NEW HAVEN COUNTY GUILFORD, CONNECTICUT	
Drawn By: W.M.	Checked By: R.S.	Project: SACHEMS HEAD COVE MOORING FIELD	
Date: August 2, 2012	Revised: 7/25/2013	EXISTING CONDITIONS	
DATUM = NGVD 29 CJL = 5.1 MHW = 3.4 MLW = -2.0		PLAN VIEW	
		Sheet: 6 of 12	

1. COORDINATES SHOWN ARE IN CT STATE PLANE NAD 83 DATUM
2. TOTAL MOORING SHOWN = 20
3. SOUNDING DEPTHS ARE IN MLW DATUM PER REF. MAP 1.2

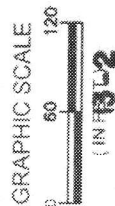

Point Table			
Boundary	Northing	Easting	
BNDY1	652249.09	1010129.23	
BNDY2	651712.69	1009736.25	
BNDY3	651475.54	1010052.76	
BNDY4	651538.30	1010089.83	
BNDY5	651736.55	1010113.04	
BNDY6	651812.17	1010159.32	
BNDY7	651784.21	1010278.42	
BNDY8	652012.26	1010443.95	
Mooring	Northing	Easting	
JC01	651666.81	1009931.75	
JC02	651588.16	1010073.68	
JC03	651685.09	1010101.14	
JC04	651757.91	1009963.62	
JC05	651789.66	1010127.50	
JC06	651837.00	1010027.93	
JC07	651800.63	1010183.89	
JC08	651879.68	1010142.30	
JC09	651879.05	1010269.32	
JC10	651941.75	1010029.61	
JC11	652048.69	1010072.40	
JC12	652194.77	1010120.18	
JC13	651648.63	1010028.01	
JC14	651944.63	1010233.73	
JC15	652088.08	1010259.13	
JC16	651964.09	1009953.76	
JC17	651944.83	1010104.59	
JC18	651917.69	1010324.50	
JC19	652195.56	1010186.56	
JC20	652003.62	1010399.65	

SACHEM HEAD YACHT CLUB
61 CHIMNEY CORNER CIRCLE
NEW HAVEN COUNTY
GUILFORD, CONNECTICUT

JOSHUA COVE
MOORING FIELD

EXISTING CONDITIONS

PLAN VIEW

Sheet: 7 of 12

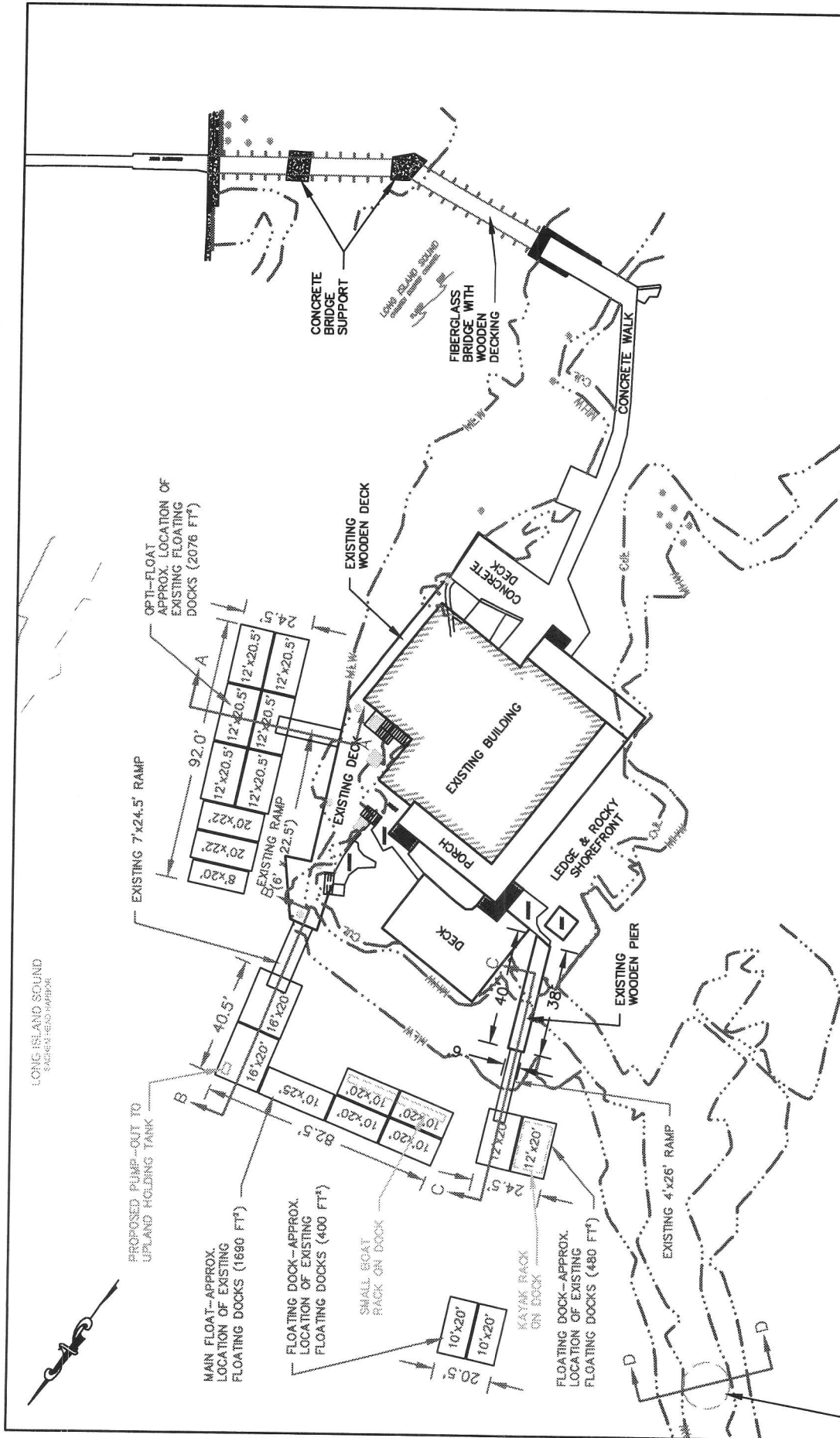

Permitting Agent: John B. Lust		Applicant: SACHEM HEAD YACHT CLUB 61 CHIMNEY CORNER CIRCLE NEW HAVEN COUNTY GUILFORD, CONNECTICUT	
Drawn By: W.M.	Checked By: R.S.	Project: DOCK INSTALLATION	
Date: August 2, 2012	Revised: 7/25/2013	EXISTING W/PROPOSED	
DATUM = NGVD 29 CJL = 5.1 MHW = 3.4 MLW = -2.0		PLAN VIEW	
		Sheet: 8 of 12	

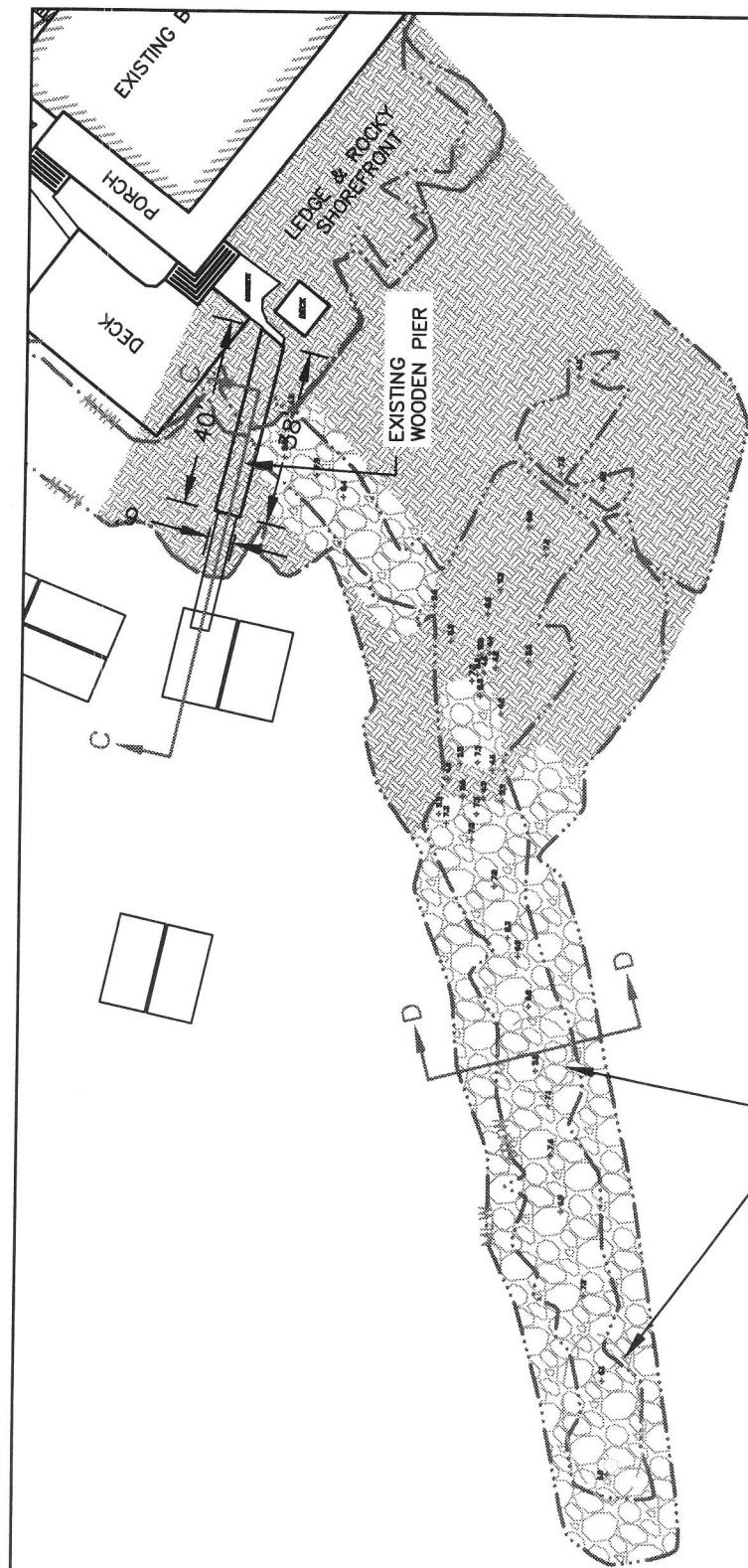

AREAS OF DAMAGED
STONE GROIN IN
NEED OF REPAIR



Permitting Agent: John B. Lust	Applicant	SACHEM HEAD YACHT CLUB 61 CHIMNEY CORNER CIRCLE NEW HAVEN COUNTY GUILFORD, CONNECTICUT
Drawn By: W.M.	Project	GROIN REPAIR
Checked By: R.S.		EXISTING W/PROPOSED
Date: August 2, 2012		PLAN VIEW
Revised: 7/25/2013		Sheet: 9 of 12
DATUM = NGVD 29 CJL = 5.1 MHW = 3.4 MLW = -2.0		

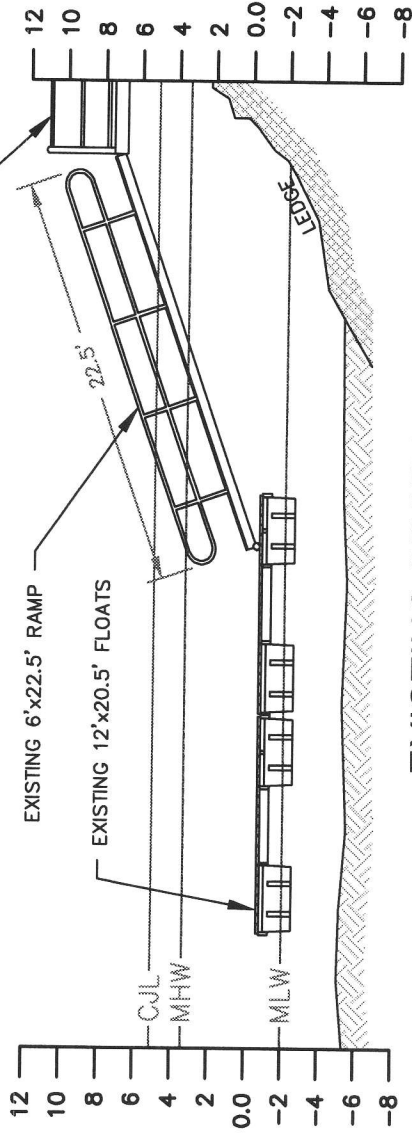

EXISTING SECTION A-A

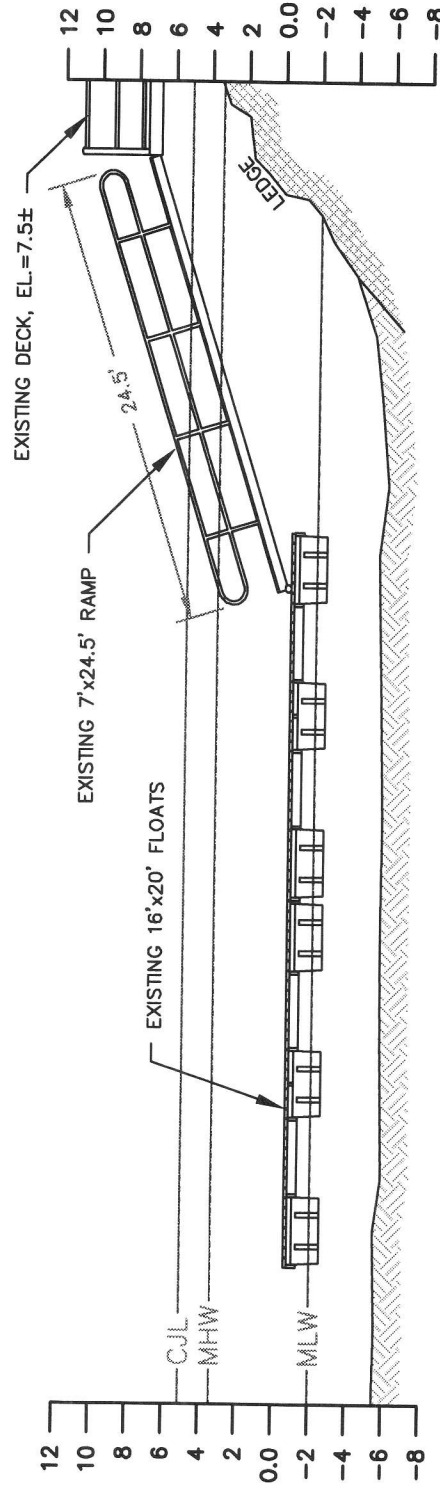

EXISTING SECTION B-B



Permitting Agent: John B. Lust	Applicant	SACHEM HEAD YACHT CLUB 61 CHIMNEY CORNER CIRCLE NEW HAVEN COUNTY GUILFORD, CONNECTICUT
Drawn By: W.M.	Project	DOCK INSTALLATION
Checked By: R.S.	CROSS SECTIONS A & B	
Date: August 2, 2012	SECTION VIEW	
Revised: 7/25/2013	Sheet: 10 of 12	
DATUM = NGVD 29 CJL = 5.1 MHW = 3.4 MLW = -2.0	Seal	

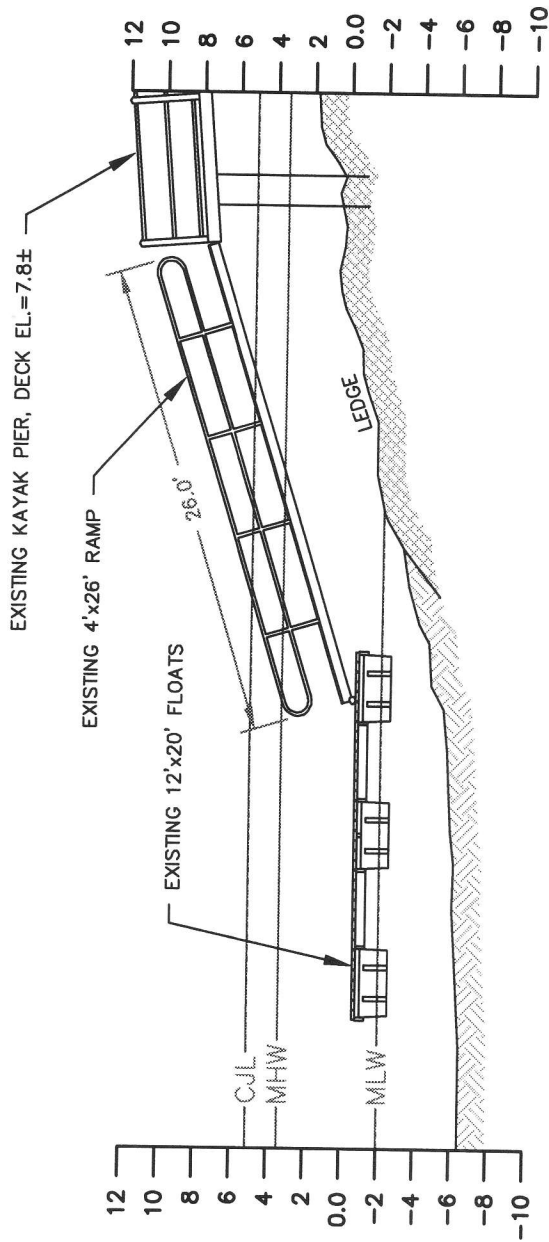

EXISTING SECTION C-C



Permitting Agent: John B. Lust	SACHEM HEAD YACHT CLUB		
	61 CHIMNEY CORNER CIRCLE		
Drawn By: W.M.	NEW HAVEN COUNTY		
Checked By: R.S.	GUILFORD, CONNECTICUT		
Date: August 2, 2012	DOCK INSTALLATION		
Revised: 7/25/2013	CROSS SECTION C-C		
DATUM = NGVD 29 CJL = 5.1 MHW = 3.4 MLW = -2.0	SECTION VIEW		
Seal	Sheet: 11 of 12		

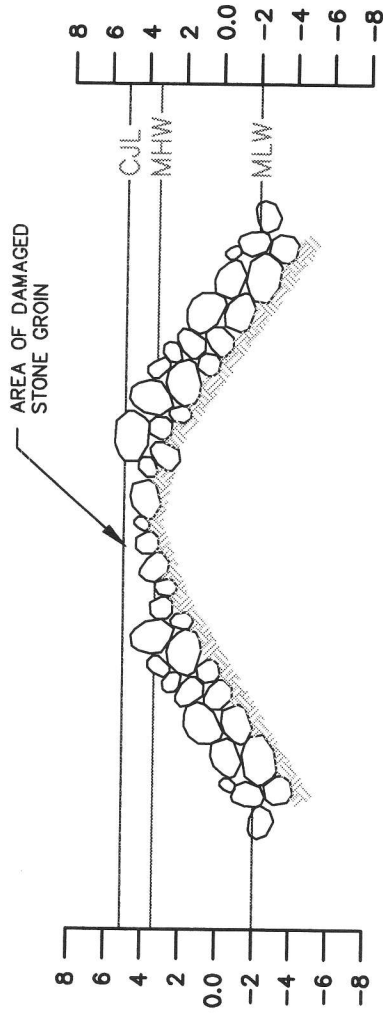

EXISTING SECTION

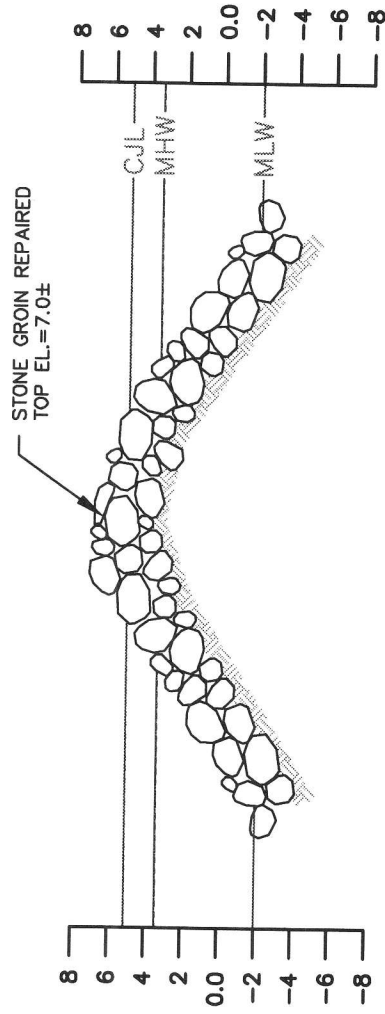

PROPOSED SECTION



<p>0 5 10 (IN FEET)</p>		<p>GRAPHIC SCALE</p>	
<p>0 5 10 (IN FEET)</p>		<p>GRAPHIC SCALE</p>	
<p>0 5 10 (IN FEET)</p>		<p>GRAPHIC SCALE</p>	
<p>0 5 10 (IN FEET)</p>		<p>GRAPHIC SCALE</p>	
<p>0 5 10 (IN FEET)</p>		<p>GRAPHIC SCALE</p>	
<p>0 5 10 (IN FEET)</p>		<p>GRAPHIC SCALE</p>	
<p>0 5 10 (IN FEET)</p>		<p>GRAPHIC SCALE</p>	
<p>0 5 10 (IN FEET)</p>		<p>GRAPHIC SCALE</p>	
<p>0 5 10 (IN FEET)</p>		<p>GRAPHIC SCALE</p>	
<p>0 5 10 (IN FEET)</p>		<p>GRAPHIC SCALE</p>	
<p>0 5 10 (IN FEET)</p>		<p>GRAPHIC SCALE</p>	
<p>0 5 10 (IN FEET)</p>		<p>GRAPHIC SCALE</p>	
<p>0 5 10 (IN FEET)</p>		<p>GRAPHIC SCALE</p>	
<p>0 5 10 (IN FEET)</p>		<p>GRAPHIC SCALE</p>	
<p>0 5 10 (IN FEET)</p>		<p>GRAPHIC SCALE</p>	
<p>0 5 10 (IN FEET)</p>		<p>GRAPHIC SCALE</p>	
<p>0 5 10 (IN FEET)</p>		<p>GRAPHIC SCALE</p>	
<p>0 5 10 (IN FEET)</p>		<p>GRAPHIC SCALE</p>	
<p>0 5 10 (IN FEET)</p>		<p>GRAPHIC SCALE</p>	
<p>0 5 10 (IN FEET)</p>		<p>GRAPHIC SCALE</p>	
<p>0 5 10 (IN FEET)</p>		<p>GRAPHIC SCALE</p>	
<p>0 5 10 (IN FEET)</p>		<p>GRAPHIC SCALE</p>	
<p>0 5 10 (IN FEET)</p>		<p>GRAPHIC SCALE</p>	
<p>0 5 10 (IN FEET)</p>		<p>GRAPHIC SCALE</p>	
<p>0 5 10 (IN FEET)</p>		<p>GRAPHIC SCALE</p>	
<p>0 5 10 (IN FEET)</p>		<p>GRAPHIC SCALE</p>	
<p>0 5 10 (IN FEET)</p>		<p>GRAPHIC SCALE</p>	
<p>0 5 10 (IN FEET)</p>		<p>GRAPHIC SCALE</p>	
<p>0 5 10 (IN FEET)</p>		<p>GRAPHIC SCALE</p>	
<p>0 5 10 (IN FEET)</p>		<p>GRAPHIC SCALE</p>	
<p>0 5 10 (IN FEET)</p>		<p>GRAPHIC SCALE</p>	
<p>0 5 10 (IN FEET)</p>		<p>GRAPHIC SCALE</p>	
<p>0 5 10 (IN FEET)</p>		<p>GRAPHIC SCALE</p>	
<p>0 5 10 (IN FEET)</p>		<p>GRAPHIC SCALE</p>	
<p>0 5 10 (IN FEET)</p>		<p>GRAPHIC SCALE</p>	
<p>0 5 10 (IN FEET)</p>		<p>GRAPHIC SCALE</p>	
<p>0 5 10 (IN FEET)</p>		<p>GRAPHIC SCALE</p>	
<p>0 5 10 (IN FEET)</p>		<p>GRAPHIC SCALE</p>	
<p>0 5 10 (IN FEET)</p>		<p>GRAPHIC SCALE</p>	
<p>0 5 10 (IN FEET)</p>		<p>GRAPHIC SCALE</p>	
<p>0 5 10 (IN FEET)</p>		<p>GRAPHIC SCALE</p>	
<p>0 5 10 (IN FEET)</p>		<p>GRAPHIC SCALE</p>	
<p>0 5 10 (IN FEET)</p>		<p>GRAPHIC SCALE</p>	
<p>0 5 10 (IN FEET)</p>		<p>GRAPHIC SCALE</p>	
<p>0 5 10 (IN FEET)</p>		<p>GRAPHIC SCALE</p>	
<p>0 5 10 (IN FEET)</p>		<p>GRAPHIC SCALE</p>	
<p>0 5 10 (IN FEET)</p>		<p>GRAPHIC SCALE</p>	
<p>0 5 10 (IN FEET)</p>		<p>GRAPHIC SCALE</p>	
<p>0 5 10 (IN FEET)</p>		<p>GRAPHIC SCALE</p>	
<p>0 5 10 (IN FEET)</p>		<p>GRAPHIC SCALE</p>	
<p>0 5 10 (IN FEET)</p>		<p>GRAPHIC SCALE</p>	
<p>0 5 10 (IN FEET)</p>		<p>GRAPHIC SCALE</p>	
<p>0 5 10 (IN FEET)</p>		<p>GRAPHIC SCALE</p>	
<p>0 5 10 (IN FEET)</p>		<p>GRAPHIC SCALE</p>	
<p>0 5 10 (IN FEET)</p>		<p>GRAPHIC SCALE</p>	
<p>0 5 10 (IN FEET)</p>		<p>GRAPHIC SCALE</p>	
<p>0 5 10 (IN FEET)</p>		<p>GRAPHIC SCALE</p>	
<p>0 5 10 (IN FEET)</p>		<p>GRAPHIC SCALE</p>	
<p>0 5 10 (IN FEET)</p>		<p>GRAPHIC SCALE</p>	
<p>0 5 10 (IN FEET)</p>		<p>GRAPHIC SCALE</p>	
<p>0 5 10 (IN FEET)</p>		<p>GRAPHIC SCALE</p>	
<p>0 5 10 (IN FEET)</p>		<p>GRAPHIC SCALE</p>	
<p>0 5 10 (IN FEET)</p>		<p>GRAPHIC SCALE</p>	
<p>0 5 10 (IN FEET)</p>		<p>GRAPHIC SCALE</p>	
<p>0 5 10 (IN FEET)</p>		<p>GRAPHIC SCALE</p>	
<p>0 5 10 (IN FEET)</p>		<p>GRAPHIC SCALE</p>	
<p>0 5 10 (IN FEET)</p>		<p>GRAPHIC SCALE</p>	
<p>0 5 10 (IN FEET)</p>		<p>GRAPHIC SCALE</p>	
<p>0 5 10 (IN FEET)</p>		<p>GRAPHIC SCALE</p>	
<p>0 5 10 (IN FEET)</p>		<p>GRAPHIC SCALE</p>	
<p>0 5 10 (IN FEET)</p>		<p>GRAPHIC SCALE</p>	
<p>0 5 10 (IN FEET)</p>		<p>GRAPHIC SCALE</p>	
<p>0 5 10 (IN FEET)</p>		<p>GRAPHIC SCALE</p>	
<p>0 5 10 (IN FEET)</p>		<p>GRAPHIC SCALE</p>	
<p>0 5 10 (IN FEET)</p>		<p>GRAPHIC SCALE</p>	
<p>0 5 10 (IN FEET)</p>		<p>GRAPHIC SCALE</p>	
<p>0 5 10 (IN FEET)</p>		<p>GRAPHIC SCALE</p>	
<p>0 5 10 (IN FEET)</p>		<p>GRAPHIC SCALE</p>	
<p>0 5 10 (IN FEET)</p>		<p>GRAPHIC SCALE</p>	
<p>0 5 10 (IN FEET)</p>		<p>GRAPHIC SCALE</p>	
<p>0 5 10 (IN FEET)</p>		<p>GRAPHIC SCALE</p>	
<p>0 5 10 (IN FEET)</p>		<p>GRAPHIC SCALE</p>	
<p>0 5 10 (IN FEET)</p>		<p>GRAPHIC SCALE</p>	
<p>0 5 10 (IN FEET)</p>		<p>GRAPHIC SCALE</p>	
<p>0 5 10 (IN FEET)</p>		<p>GRAPHIC SCALE</p>	
<p>0 5 10 (IN FEET)</p>		<p>GRAPHIC SCALE</p>	
<p>0 5 10 (IN FEET)</p>		<p>GRAPHIC SCALE</p>	
<p>0 5 10 (IN FEET)</p>		<p>GRAPHIC SCALE</p>	
<p>0 5 10 (IN FEET)</p>		<p>GRAPHIC SCALE</p>	
<p>0 5 10 (IN FEET)</p>		<p>GRAPHIC SCALE</p>	
<p>0 5 10 (IN FEET)</p>		<p>GRAPHIC SCALE</p>	
<p>0 5 10 (IN FEET)</p>		<p>GRAPHIC SCALE</p>	
<p>0 5 10 (IN FEET)</p>		<p>GRAPHIC SCALE</p>	
<p>0 5 10 (IN FEET)</p>		<p>GRAPHIC SCALE</p>	
<p>0 5 10 (IN FEET)</p>		<p>GRAPHIC SCALE</p>	
<p>0 5 10 (IN FEET)</p>		<p>GRAPHIC SCALE</p>	
<p>0 5 10 (IN FEET)</p>		<p>GRAPHIC SCALE</p>	
<p>0 5 10 (IN FEET)</p>		<p>GRAPHIC SCALE</p>	
<p>0 5 10 (IN FEET)</p>		<p>GRAPHIC SCALE</p>	
<p>0 5 10 (IN FEET)</p>		<p>GRAPHIC SCALE</p>	
<p>0 5 10 (IN FEET)</p>		<p>GRAPHIC SCALE</p>	
<p>0 5 10 (IN FEET)</p>		<p>GRAPHIC SCALE</p>	
<p>0 5 10 (IN FEET)</p>		<p>GRAPHIC SCALE</p>	
<p>0 5 10 (IN FEET)</p>		<p>GRAPHIC SCALE</p>	
<p>0 5 10 (IN FEET)</p>		<p>GRAPHIC SCALE</p>	
<p>0 5 10 (IN FEET)</p>		<p>GRAPHIC SCALE</p>	
<p>0 5 10 (IN FEET)</p>		<p>GRAPHIC SCALE</p>	
<p>0 5 10 (IN FEET)</p>		<p>GRAPHIC SCALE</p>	
<p>0 5 10 (IN FEET)</p>		<p>GRAPHIC SCALE</p>	
<p>0 5 10 (IN FEET)</p>		<p>GRAPHIC SCALE</p>	
<p>0 5 10 (IN FEET)</p>		<p>GRAPHIC SCALE</p>	
<p>0 5 10 (IN FEET)</p>		<p>GRAPHIC SCALE</p>	
<p>0 5 10 (IN FEET)</p>		<p>GRAPHIC SCALE</p>	
<p>0 5 10 (IN FEET)</p>		<p>GRAPHIC SCALE</p>	
<p>0 5 10 (IN FEET)</p>		<p>GRAPHIC SCALE</p>	
<p>0 5 10 (IN FEET)</p>		<p>GRAPHIC SCALE</p>	
<p>0 5 10 (IN FEET)</p>		<p>GRAPHIC SCALE</p>	
<p>0 5 10 (IN FEET)</p>		<p>GRAPHIC SCALE</p>	
<p>0 5 10 (IN FEET)</p>		<p>GRAPHIC SCALE</p>	
<p>0 5 10 (IN FEET)</p>		<p>GRAPHIC SCALE</p>	
<p>0 5 10 (IN FEET)</p>		<p>GRAPHIC SCALE</p>	
<p>0 5 10 (IN FEET)</p>		<p>GRAPHIC SCALE</p>	
<p>0 5 10 (IN FEET)</p>		<p>GRAPHIC SCALE</p>	
<p>0 5 10 (</p>			