



**US Army Corps  
of Engineers**®  
New England District  
696 Virginia Road  
Concord, MA 01742-2751

# PUBLIC NOTICE

**Comment Period Begins:** July 13, 2021  
**Comment Period Ends:** August 12, 2021  
**File Number:** NAE-2021-00181  
**In Reply Refer To:** Christina M. Comeau  
**Phone:** (978) 318-8705  
**E-mail:** Christina.M.Comeau@usace.army.mil

---

The District Engineer has received a permit application to conduct work in waters of the United States from 190 South Thames Street, LLC, 282 Franklin Street, Norwich, CT 06360. This work is proposed in the Thames River at 190 South Thames Street, Norwich, Connecticut. The site coordinates are: Latitude 41.517032, Longitude -72.079017.

The work involves the installation and maintenance of 1,222 LF of 8' wide batter braced, pile restrained floating docks, (2) hinged access ramps, and associated pilings and utilities. The pilings will be installed with either a land-based crane or a barge mounted crane. This project is to establish a new commercial boating facility at this location. The project purpose is to provide a recreational service to the area by establishing docking slips.

The work is shown on the enclosed plans entitled "SHOREFRONT MODIFICATIONS, CITY OF NORWICH, NEW LONDON COUNTY, CONNECTICUT," on 7 sheets, and dated "OCTOBER 1, 2020."

No compensatory mitigation has been proposed for this project. Special conditions will be included in the permit authorization to minimize impacts to Endangered Species Act listed species and essential fish habitat in the project area.

## **AUTHORITY**

Permits are required pursuant to:

- Section 10 of the Rivers and Harbors Act of 1899
- Section 404 of the Clean Water Act
- Section 103 of the Marine Protection, Research and Sanctuaries Act.
- Section 14 of the Rivers and Harbors Act of 1899 (33 USC 408)

The decision whether to issue a permit will be based on an evaluation of the probable impact of the proposed activity on the public interest. That decision will reflect the national concern for both protection and utilization of important resources. The benefit which may reasonably accrue from the proposal must be balanced against its reasonably foreseeable detriments. All factors which may be relevant to the proposal will be considered, including the cumulative effects thereof; among those are: conservation, economics, aesthetics, general environmental concerns, wetlands, cultural value, fish and wildlife values, flood hazards, flood plain value, land use, navigation, shoreline erosion and accretion, recreation, water supply and conservation, water quality, energy needs, safety, food production and, in general, the needs and welfare of the people.

**CENAE-R**  
**FILE NO. NAE-2021-00181**

The U.S. Army Corps of Engineers, New England District (USACE), is soliciting comments from the public; Federal, state, and local agencies and officials; Indian Tribes; and other interested parties in order to consider and evaluate the impacts of this proposed activity. The USACE will consider all comments received to determine whether to issue, modify, condition or deny a permit for this proposal. To make this decision, comments are used to assess impacts on endangered species, historic properties, water quality, general environmental effects, and the other public interest factors listed above. Comments are used in the preparation of an Environmental Assessment and/or an Environmental Impact Statement pursuant to the National Environmental Policy Act. Comments are also used to determine the need for a public hearing and to determine the overall public interest of the proposed activity.

The activities proposed herein may also require permission from the USACE pursuant to 33 U.S.C. 408 if it will alter or temporarily or permanently occupy or use a USACE federally authorized Civil Works project known as the Thames River. The proposed alteration involves the construction of a new commercial boating facility. The proposed alteration is located at 190 South Thames Street, Norwich, CT. A permit pursuant to Section 10/404/103 shall not be granted until the Section 408 permission is issued. Through this public notice we are soliciting information necessary to inform the USACE evaluation and review.

**ESSENTIAL FISH HABITAT**

The Magnuson-Stevens Fishery Conservation and Management Act, as amended by the Sustainable Fisheries Act of 1996 (Public Law 104-267), requires all federal agencies to consult with the National Marine Fisheries Service on all actions, or proposed actions, permitted, funded, or undertaken by the agency, that may adversely affect Essential Fish Habitat (EFH). Essential Fish Habitat describes waters and substrate necessary for fish for spawning, breeding, feeding or growth to maturity.

This project will impact .23 acres of EFH. This habitat consists of subtidal silts. Loss of this habitat may adversely affect species that use these waters and substrate. However, the District Engineer has made a preliminary determination that the site-specific adverse effect will not be substantial. Further consultation with the National Marine Fisheries Service regarding EFH conservation recommendations is being conducted and will be concluded prior to the final decision.

**NATIONAL HISTORIC PRESERVATION ACT**

Based on his initial review, the District Engineer has determined that little likelihood exists for the proposed work to impinge upon properties with cultural or Native American significance, or listed in, or eligible for listing in, the National Register of Historic Places. Therefore, no further consideration of the requirements of Section 106 of the National Historic Preservation Act of 1966, as amended, is necessary. This determination is based upon one or more of the following:

- a. The permit area has been extensively modified by previous work.
- b. The permit area has been recently created.
- c. The proposed activity is of limited nature and scope.
- d. Review of the latest published version of the National Register shows that no presence of registered properties listed as being eligible for inclusion therein are in the permit area or general vicinity.
- e. Coordination with the State Historic Preservation Officer and/or Tribal Historic Preservation Officer(s).

**ENDANGERED SPECIES CONSULTATION**

The USACE has reviewed the application for the potential impact on Federally-listed threatened or endangered species and their designated critical habitat pursuant to section 7 of the Endangered Species Act as amended. It is our preliminary determination that the proposed activity for which authorization is being sought is designed, situated or will be operated/used in such a manner that it is not likely to adversely affect a listed species or their critical habitat. We are coordinating with the National Marine Fisheries Service and/or U.S. Fish and Wildlife Service on listed species under their jurisdiction and the ESA consultation will be concluded prior to the final decision.

**OTHER GOVERNMENT AUTHORIZATIONS**

The states of Connecticut, Maine, Massachusetts, New Hampshire and Rhode Island have approved Coastal Zone Management Programs. Where applicable, the applicant states that any proposed activity will comply with and will be conducted in a manner that is consistent with the approved Coastal Zone Management Program. By this Public Notice, we are requesting the State concurrence or objection to the applicant's consistency statement.

The following authorizations have been applied for, or have been, or will be obtained:

- ( X ) Permit, license or assent from State.
- ( X ) Permit from local wetland agency or conservation commission.
- ( ) Water Quality Certification in accordance with Section 401 of the Clean Water Act.

**COMMENTS**

In order to properly evaluate the proposal, we are seeking public comment. Anyone wishing to comment is encouraged to do so. Comments should be submitted in writing by the above date. If you have any questions, please contact Christina M. Comeau at (978) 318-8705, (800) 343-4789 or (800) 362-4367, if calling from within Massachusetts.

Any person may request, in writing, within the comment period specified in this notice, that a public hearing be held to consider the application. Requests for a public hearing shall specifically state the reasons for holding a public hearing. The USACE holds public hearings for the purpose of obtaining public comments when that is the best means for understanding a wide variety of concerns from a diverse segment of the public.

The initial determinations made herein will be reviewed in light of facts submitted in response to this notice. All comments will be considered a matter of public record. Copies of letters of objection will be forwarded to the applicant who will normally be requested to contact objectors directly in an effort to reach an understanding.

**CENAE-R**  
**FILE NO. NAE-2021-00181**

**THIS NOTICE IS NOT AN AUTHORIZATION TO DO ANY WORK.**

*Kevin R Kotelly*

**Kevin R. Kotelly, P.E.**  
**Chief, Permits and Enforcement Branch**  
**Regulatory Division**

---

If you would prefer not to continue receiving Public Notices by email, please contact Ms. Tina Chaisson at (978) 318-8058 or e-mail her at [bettina.m.chaisson@usace.army.mil](mailto:bettina.m.chaisson@usace.army.mil).

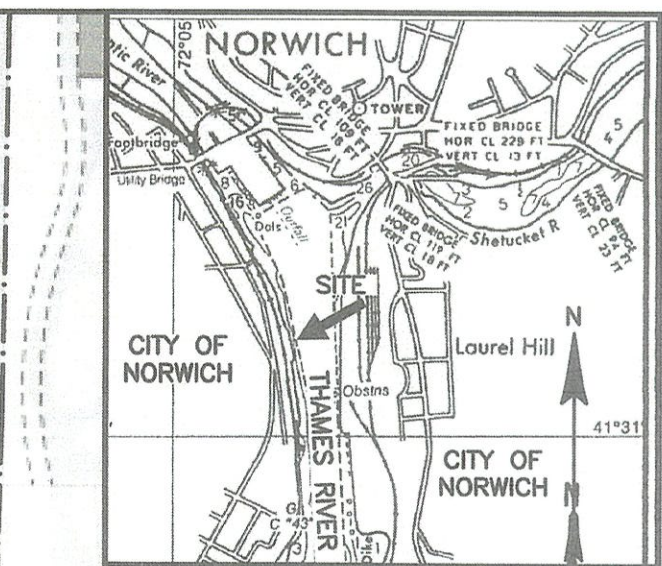
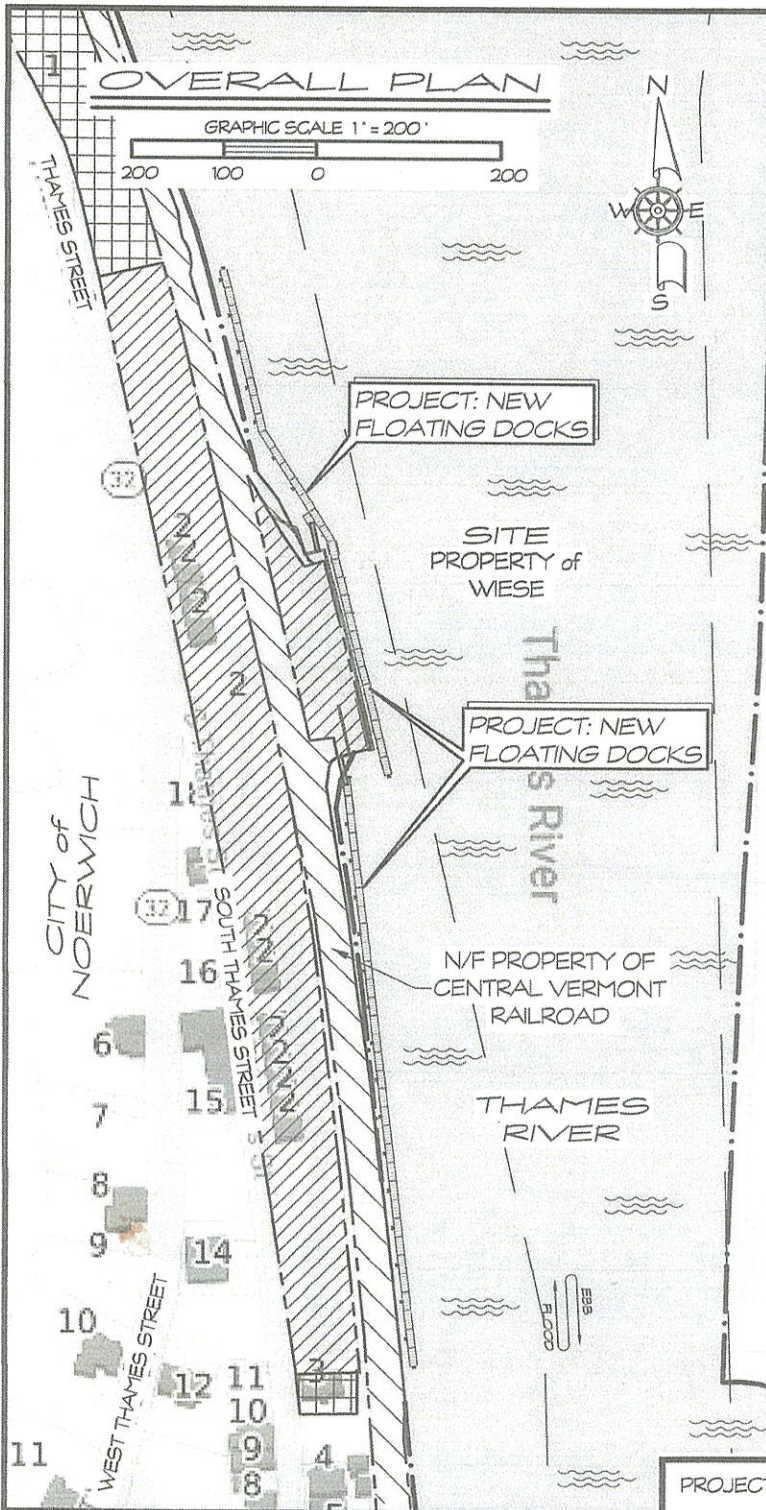

**LOCATION MAP**

REFERENCE CHART: 13214  
NOT TO SCALE

- NOTES:
1. ELEVATION DATUM IS NAVD 1998.
  2. TIDE DATA IS TAKEN FROM 2021 NOAA TIDE TABLES REFERENCE : NORWIH. CJL IS TAKEN FROM THE COASTAL JURISDICTIONAL LINE FACT SHEET : THAMES RIVER - NORWICH
  3. PROJECT DESCRIPTION: INSTALL 1,226±LF OF 8-FT WIDE BATTER BRACED PILE RESTRAINED FLOATING DOCKS INCLUDING TWO ASSOCIATED HINGED ACCESS RAMPS, WATER AND ELECTRIC UTILITIES AND RESTRAINT PILES ALL WATERWARD OF THE MEAN HIGH WATER AND COASTAL JURISDICTION LINES.
  4. PROJECT PURPOSE: TO ESTABLISH A COMMERCIAL MARINA IN SUPPORT OF RECREATIONAL BOATING ACCESS.
  5. THESE APPLICATION DRAWINGS REPRESENT A COMPILATION OF SURVEYS FOR ENVIRONMENTAL PERMIT PURPOSES. THEY ARE NOT CONSTRUCTION CONTRACT DOCUMENTS. A CITY BUILDING PERMIT(S) MAY BE REQUIRED.
  6. ADJOINING PROPERTY OWNERS:  
WEST:  
CENTRAL VERMONT RAILROAD  
C/O CANADIAN NATIONAL PROPERTY TAX GROUP  
PO BOX 8100  
DOWNTOWN STATION  
H3C 3N4 CANADA

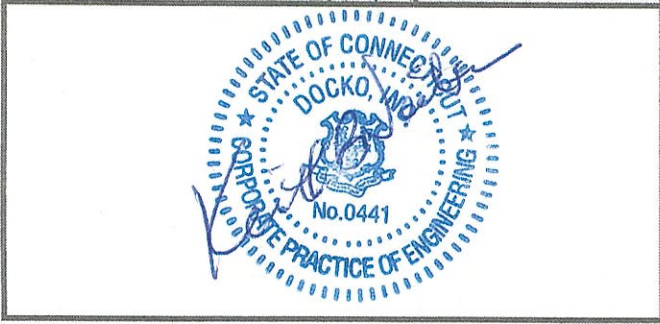

PROJECT: SHOREFRONT MODIFICATIONS

LOCATION: CITY OF NORWICH  
NEW LONDON COUNTY, CONNECTICUT

WATERWAY: THAMES RIVER

DATE: OCTOBER 1, 2020

APPLICANT: 190 SOUTH THAMES STREET LLC

AGENT: SHEET 1 OF 7

**DOCKO, INC.**  
Keith B. Nelson, PE  
Mystic, CT 06355  
860 572 8939 FAX 860 572 7569  
EMAIL: OFFICE@DOCKO.COM

DWG 19-09-3059

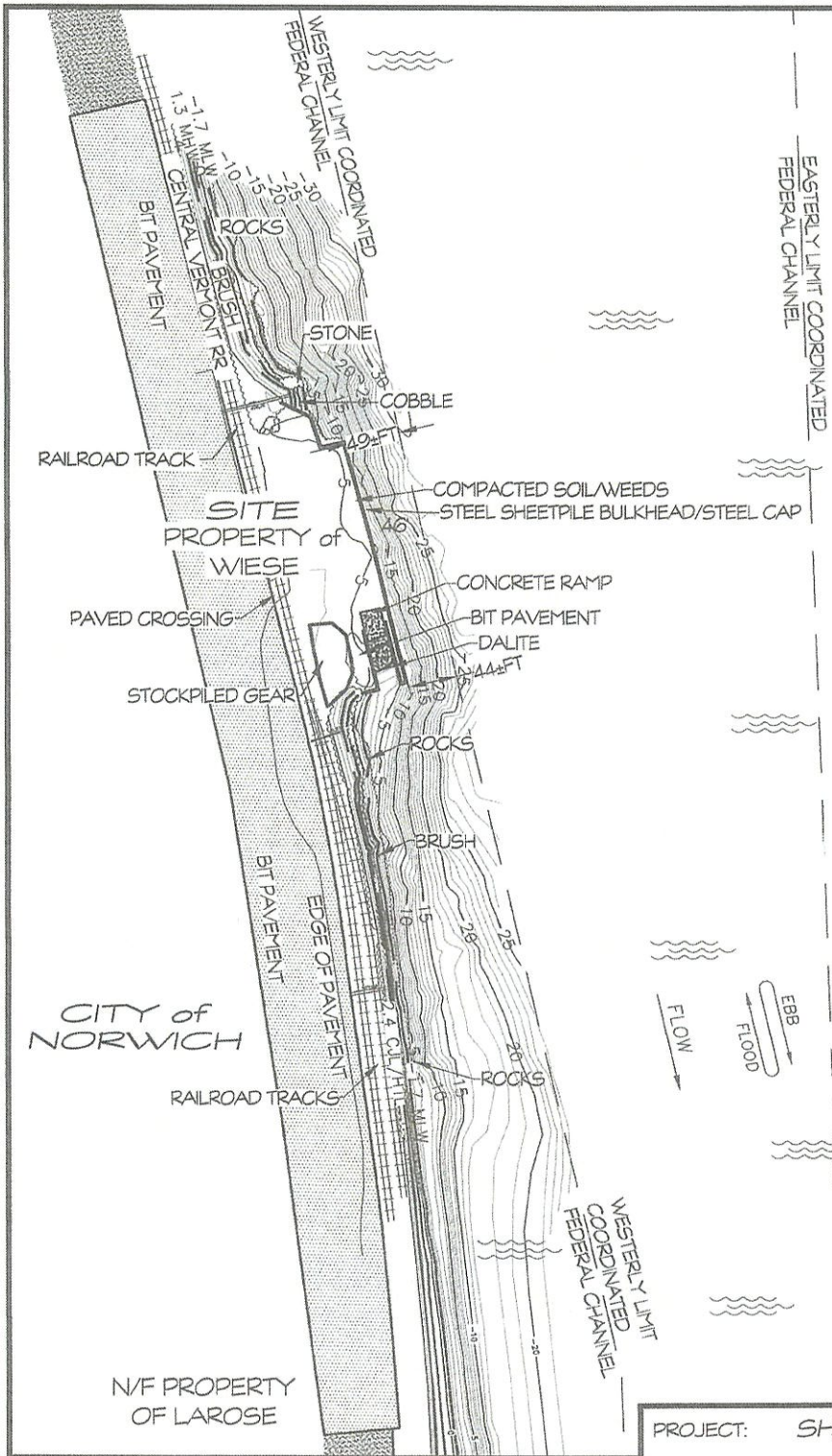

NOTE:  
 NO OSPREY POLES WERE OBSERVED  
 WITHIN 500-FT OF THE SITE  
 ELEVATIONS ARE BASED ON NAVD 88  
 SURVEY by RESOURCE MANAGEMENT & MAPPING



THAMES RIVER

**EXISTING CONDITIONS**

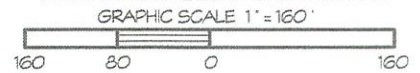

DEEP RESOURCES  
 ESTUARINE EMBAYMENTS  
 COASTAL FLOOD HAZARD  
 DEVELOPED SHOREFRONT

PROJECT: SHOREFRONT MODIFICATIONS

LOCATION: CITY OF NORWICH  
 NEW LONDON COUNTY, CONNECTICUT

WATERWAY: THAMES RIVER  
 DATE: OCTOBER 1, 2020  
 APPLICANT: 190 SOUTH THAMES STREET LLC

AGENT: SHEET 2 OF 7

**DOCKO, INC.**

Keith B. Neilson, PE  
 Mystic, CT 06355  
 860 572 8939 FAX 860 572 7569  
 EMAIL: OFFICE@DOCKO.COM



DWG 19-09-3059



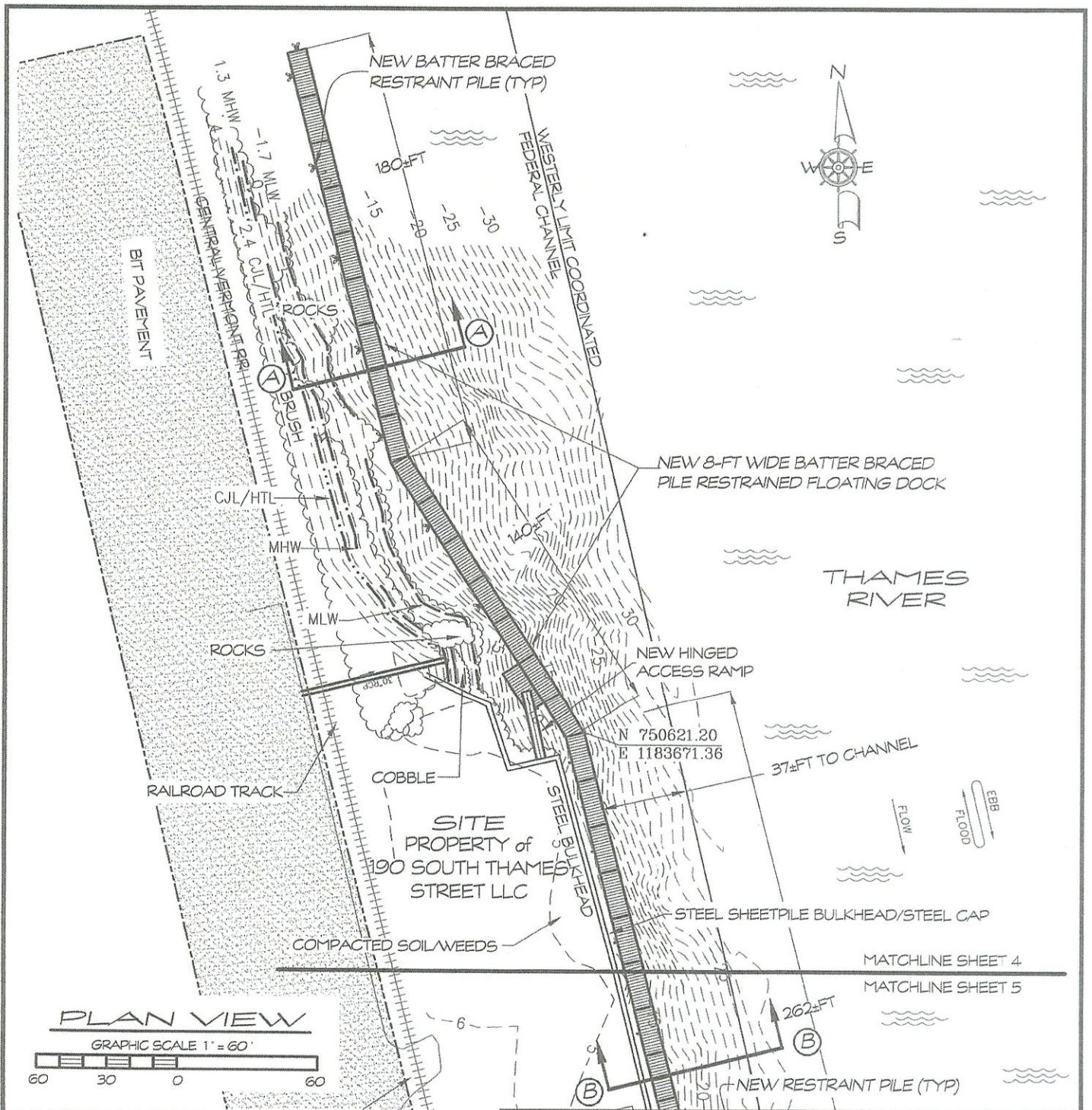

ELEVATIONS ARE BASED ON NAVD 88  
 SURVEY by RESOURCE MANAGEMENT & MAPPING



PROJECT: SHOREFRONT MODIFICATIONS

LOCATION: CITY OF NORWICH  
 NEW LONDON COUNTY, CONNECTICUT

WATERWAY: THAMES RIVER

DATE: OCTOBER 1, 2020

APPLICANT: 190 SOUTH THAMES  
 STREET LLC

AGENT: SHEET 3 OF 7

**DOCKO, INC.**

Keith B. Neilson, PE  
 Mystic, CT 06355  
 860 572 8939 FAX 860 572 7569  
 EMAIL: OFFICE@DOCKO.COM



DWG 19-09-3059

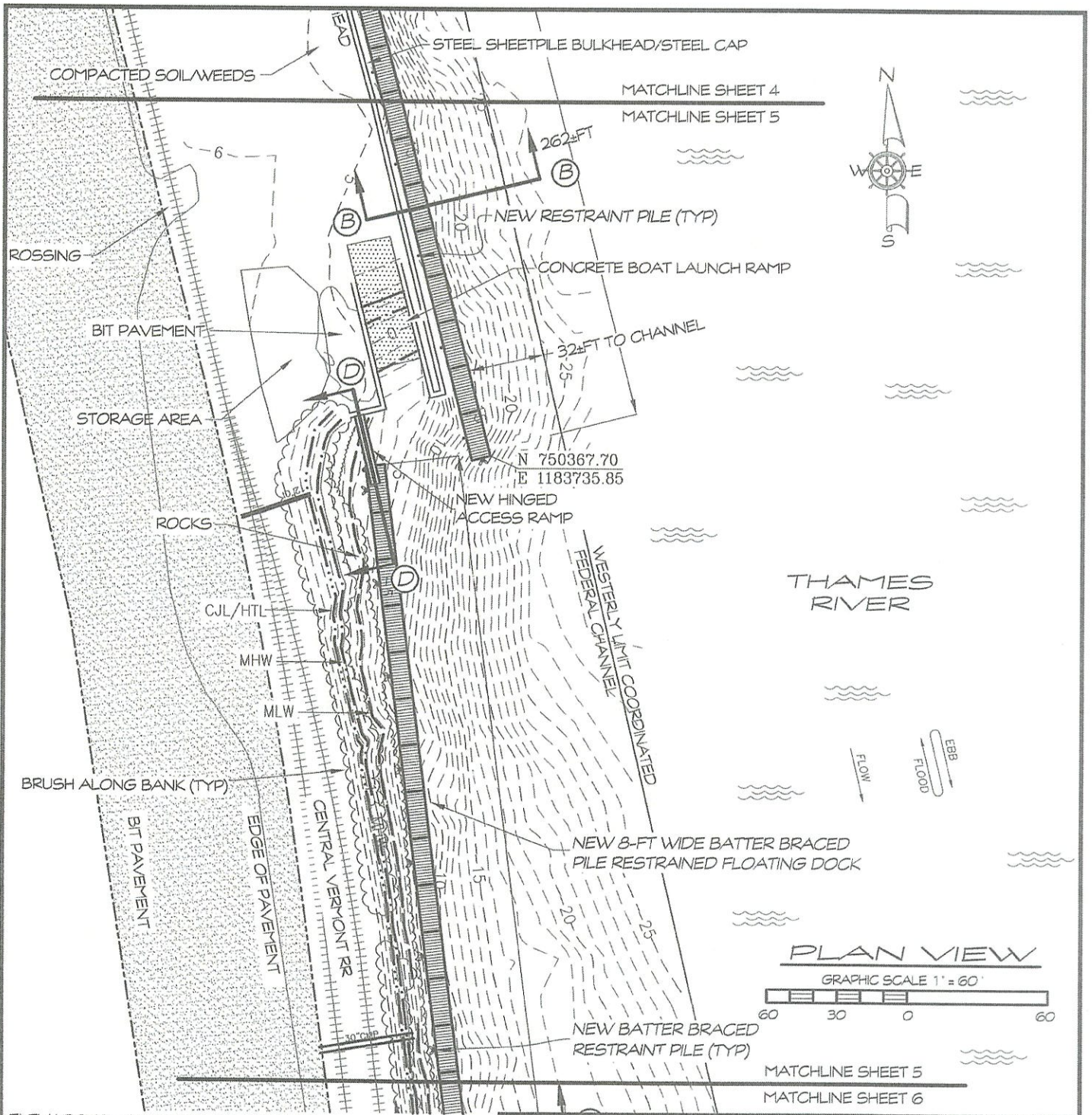

ELEVATIONS ARE BASED ON NAVD 88  
 SURVEY by RESOURCE MANAGEMENT & MAPPING

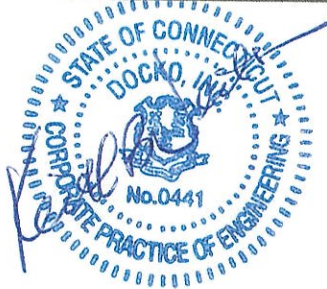

PROJECT: SHOREFRONT MODIFICATIONS

LOCATION: CITY OF NORWICH  
 NEW LONDON COUNTY, CONNECTICUT

WATERWAY: THAMES RIVER  
 DATE: OCTOBER 1, 2020  
 APPLICANT: 190 SOUTH THAMES STREET LLC

AGENT: SHEET 4 OF 7

**DOCKO, INC.**

Keith B. Neilson, PE  
 Mystic, CT 06355  
 860 572 8939 FAX 860 572 7569  
 EMAIL: OFFICE@DOCKO.COM



DWG 19-09-3059



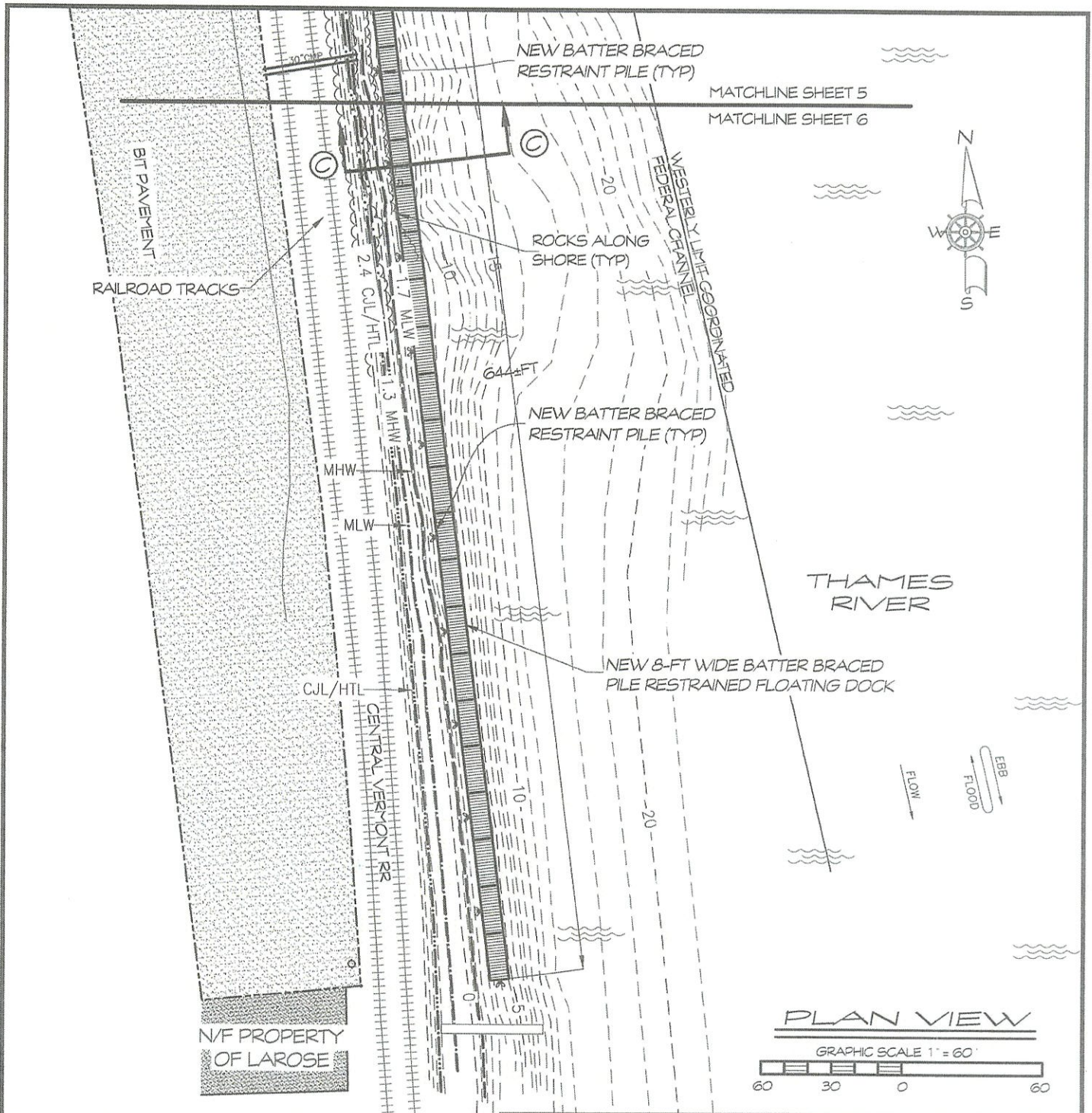

ELEVATIONS ARE BASED ON NAVD 88  
 SURVEY by RESOURCE MANAGEMENT & MAPPING

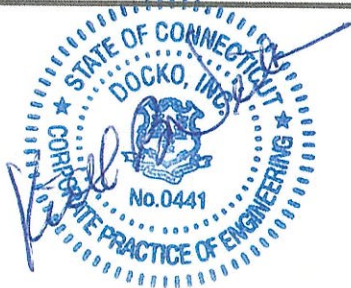

PROJECT: SHOREFRONT MODIFICATIONS

LOCATION: CITY OF NORWICH  
 NEW LONDON COUNTY, CONNECTICUT

WATERWAY: THAMES RIVER

DATE: OCTOBER 1, 2020

APPLICANT: 190 SOUTH THAMES  
 STREET LLC

AGENT: SHEET 5 OF 7

**DOCKO, INC.**

Keith B. Neilson, PE  
 Mystic, CT 06355  
 860 572 8939 FAX 860 572 7569  
 EMAIL: OFFICE@DOCKO.COM



DWG 19-09-3059

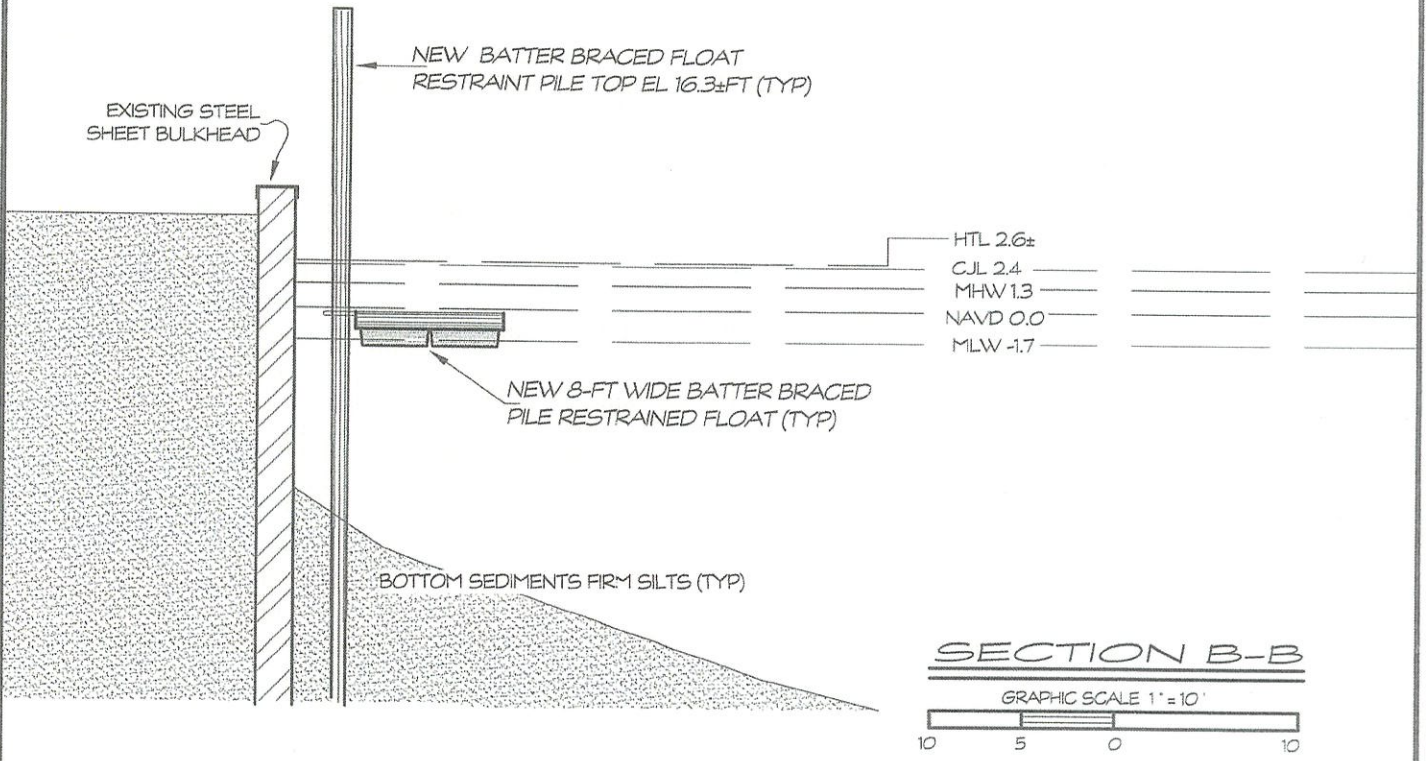
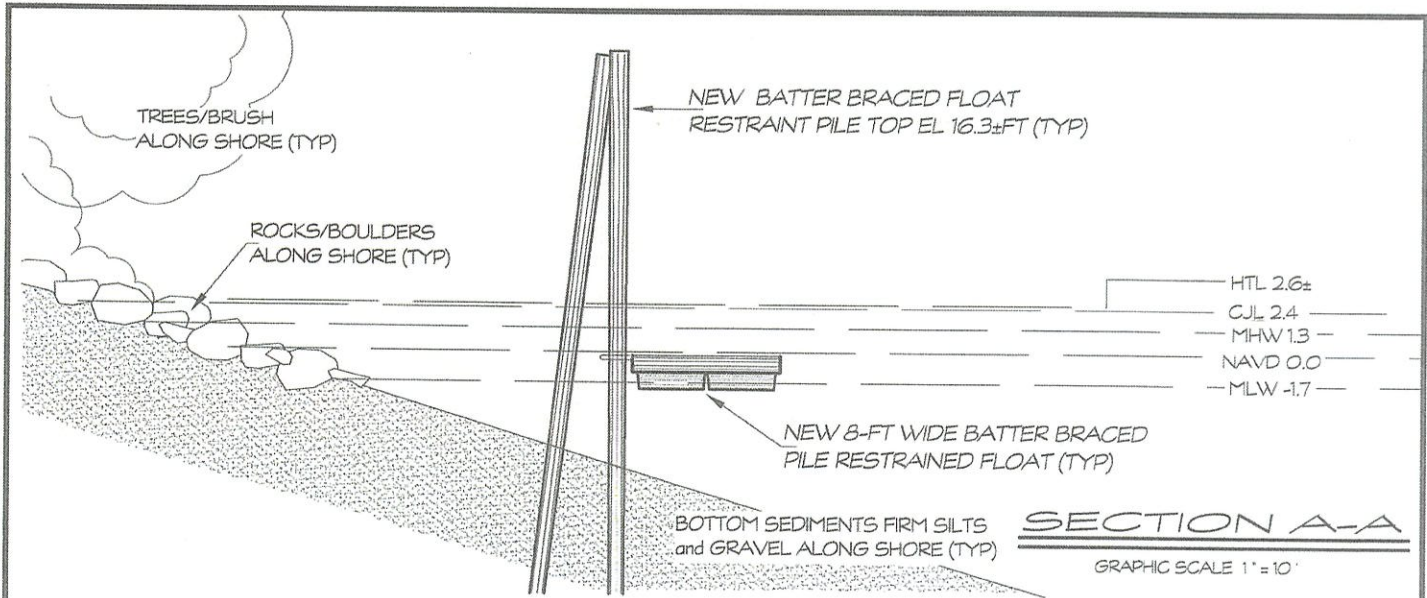

ELEVATIONS ARE BASED ON NAVD 88

PROJECT: SHOREFRONT MODIFICATIONS

LOCATION: CITY OF NORWICH  
NEW LONDON COUNTY, CONNECTICUT

WATERWAY: THAMES RIVER  
DATE: OCTOBER 1, 2020  
APPLICANT: 190 SOUTH THAMES  
STREET LLC

AGENT: SHEET 6 OF 7

**DOCKO, INC.**

Keith B. Neilson, PE  
Mystic, CT 06355  
860 572 8939 FAX 860 572 7569  
EMAIL: OFFICE@DOCKO.COM



DWG 19-09-3059

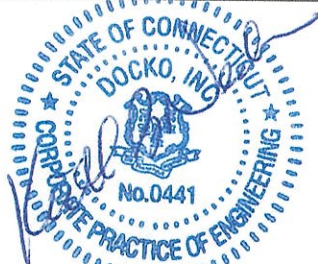

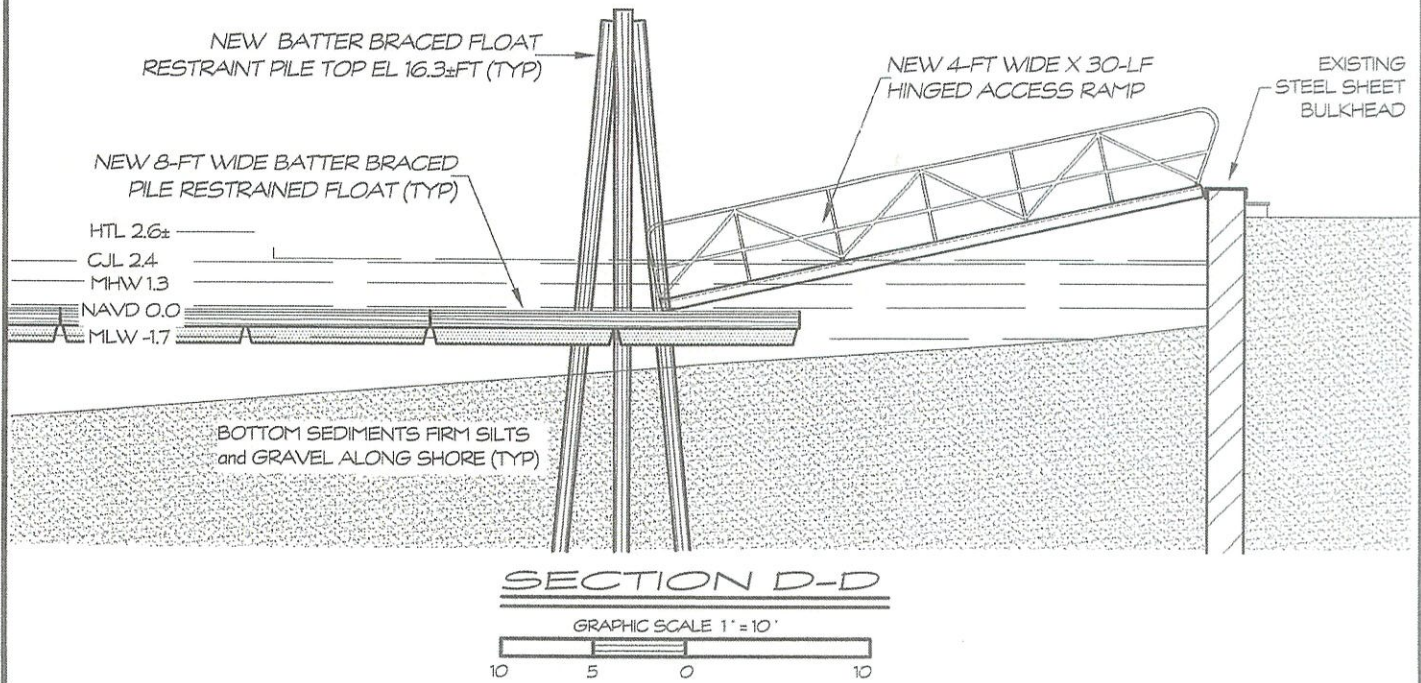
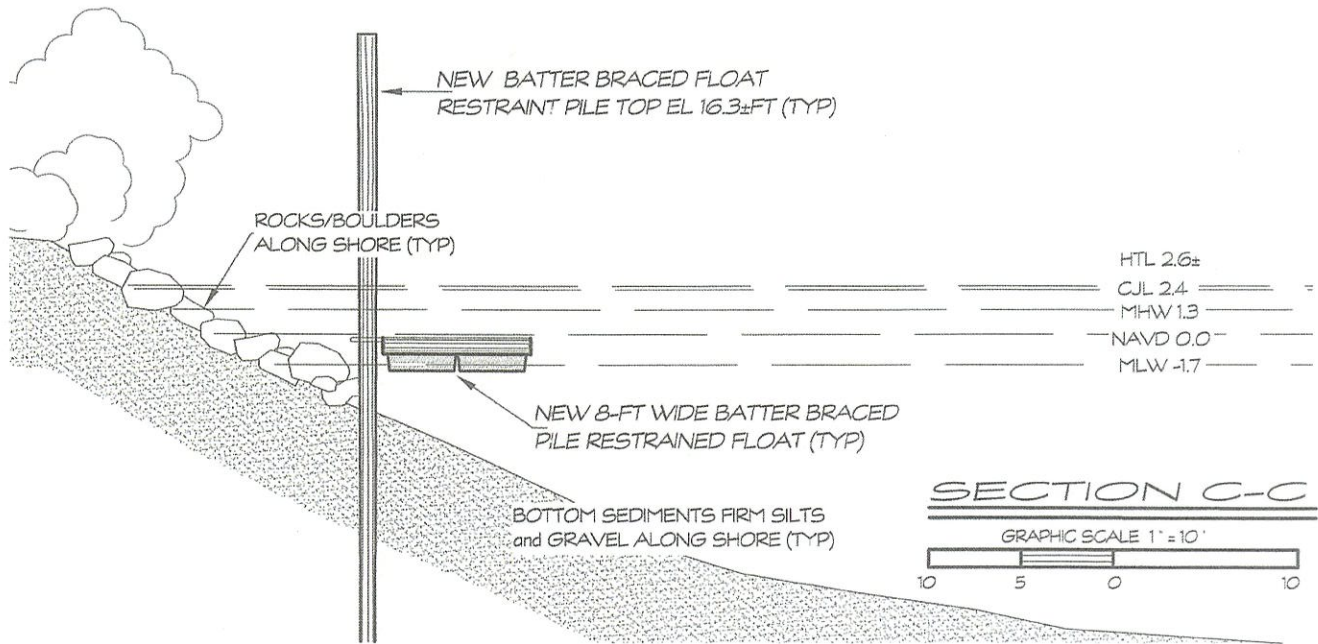

ELEVATIONS ARE BASED ON NAVD 88

PROJECT: SHOREFRONT MODIFICATIONS

LOCATION: CITY OF NORWICH  
NEW LONDON COUNTY, CONNECTICUT

WATERWAY: THAMES RIVER

DATE: OCTOBER 1, 2020

APPLICANT: 190 SOUTH THAMES  
STREET LLC

AGENT: SHEET 7 OF 7

**DOCKO, INC.**

Keith B. Nelson, PE  
Mystic, CT 06355  
860 572 8939 FAX 860 572 7569  
EMAIL: OFFICE@DOCKO.COM



DWG 19-09-3059

