

The Siemon Company

File No.: 199701597

City and State: Watertown, CT

General Impacts: 0.32 acre

Functions and Values Lost: (from database)

Floodflow Alteration

Sediment Retention

Wildlife Habitat

Year(s) Mitigation Constructed: (from database) November 1998

Size and Type of Mitigation as Proposed: (from database) 0.13 non-tidal scrub-shrub

Proposed Functions and Values of Mitigation: (from database)

Wildlife Habitat

Mitigation Special Condition(s):

1. To mitigate for wetland impacts from the project, permittee shall construct a wetland creation area and plant a wetland buffer along the edge of the parking lot as described in the mitigation plan entitled, "Wetland Mitigation Planting Plan – Depot Street Property Along Steele Brook – Watertown, CT", dated "January 30, 1998" (five page letter/report with two attached sheets showing the planting areas).

Remarks:

File contains the permit but is otherwise lacking important information.

Directions:

Take 128/95 south. Take exit 25, I-90/Mass Pike. Take the ramp going west to New York/Springfield/Framingham. Take exit 9, I-84 west toward Hartford/New York City. Take exit 20, CT-8 north toward Torrington. Take exit 35, CT-63 west. Follow CT-63 west to Main Street. Turn right onto Atwood Court. The site is at Depot Street. It's alongside Steele Brook.

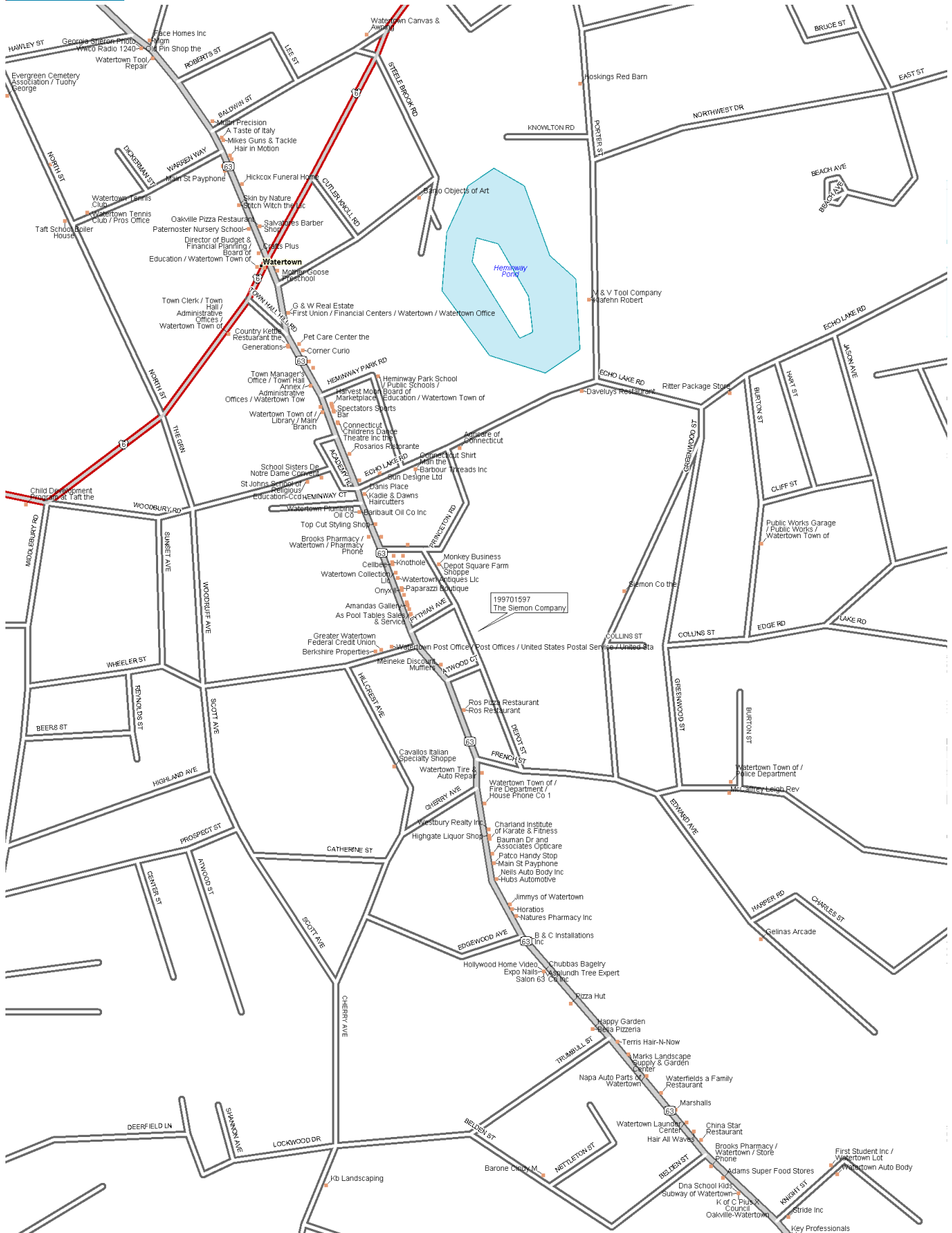

GEOLOGICAL SURVEY

73°07'30"

657000m.F

HARTFORD 28 MI.
THOMASTON 4 MI.

658

659

5'

660

TORRINGTON 15 MI.
 THOMASTON 4 MI.

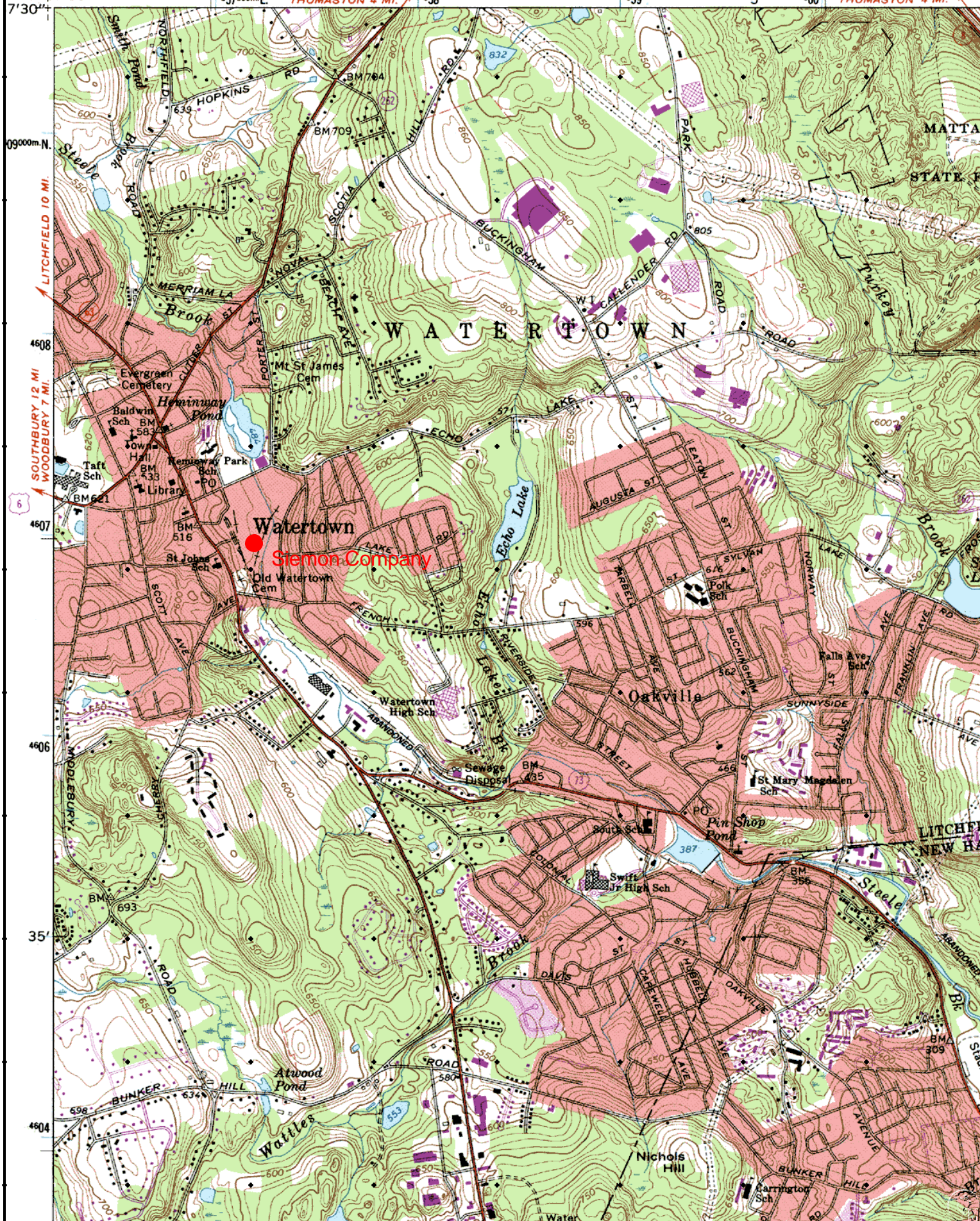

MITIGATION SITE FIELD DATA FORM

Site Name: Siemon Co. File No. 199701597

City/Town: Watertown State: CT Waterbody: _____

Monitor(s): Keith Wright Date: 8-28-02

Was site constructed? yes

Is site wetland? no

Size of proposed wetland: 0.13 acre

Actual size of wetland: TBD

Landscape position: stream bed

Lat/Long Points: 41.60199N 73.11185W

Saved GPS Waypoint name: SIE

GPS Tracking Log Name: N/A

Perimeter: TBD

Surrounding land use:

Street, residential

Is wetland function compromised by
surrounding land use?

This site has limited wildlife value to its
proximity to the road.

Plant health:

Poor

Invasive species:

Large-leafed bamboo-like plant with
yellow/white flowers at each leaf – *Polygonum*
cuspidatum

Plants:

Alnus rugosa

Betula populifolia

Carex lurida

Eupatorium perfoliatum

Juncus effusus

Panicum sp.

Poaceae sp.

Polygonum cuspidatum

Rosa sp.

Rubus sp.

Scirpus cyperinus

Verbena hastata

Vicia sp.

Wildlife use:

None observed.

Soils Data:

| DEPTH | HORIZON | MATRIX | REDOX | COMMENTS |
|-------|---------|----------|--|-------------|
| 0-10" | A | 10YR 3/3 | 15% prominent oxidized rhizospheres 2.5YR 4/8 | loamy sand |
| 10+ | C | 10YR 3/3 | | medium sand |

Sketch approximate mitigation site, noting areas and types of wetlands, waters, other features, landscape position, landmarks, etc., and data and photo point(s)

See file.

Overall Description of site:

This site is on Depot St. just past Siemon Co. It is adjacent to Steele Brook. It is a small hydrologically-challenged site. Water comes in with rain because of pipes that run down from rooftops of the buildings that are nearby. However, the water leaves the site fairly quickly, according to plant engineer Paul Knickerbocker.

Comments, problems, recommendations:

The water washes down from roofs and deposits large amounts of cigarette butts and debris, and the wetland drains into Steele Brook.

Beware of 1.5 ft. deep hole. It is a foot wide but covered by thick vegetation.

The site does not hold water, possibly due to the sandy nature of the soil.

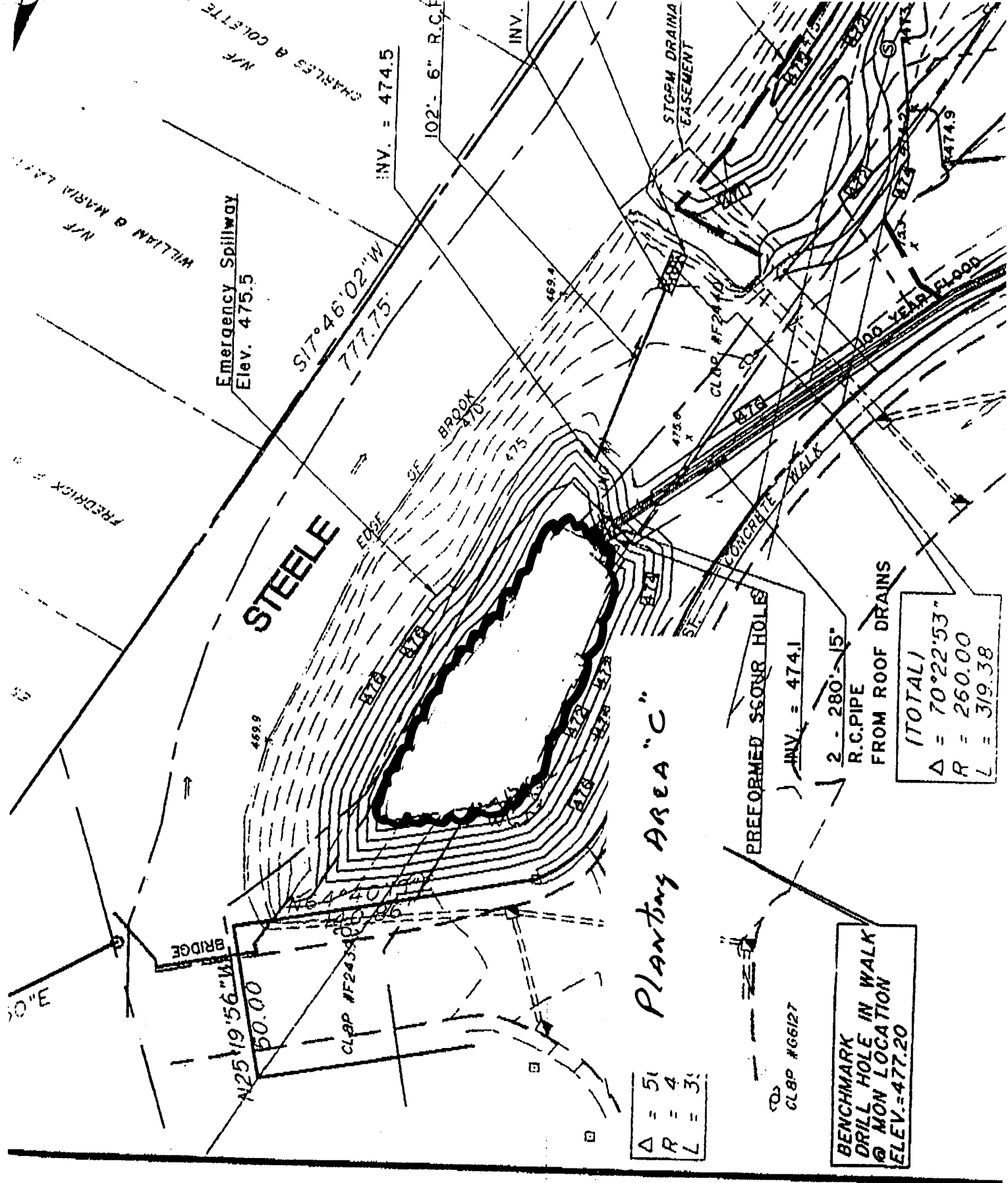

Disturbed Area Within Wetlands

Cut in wetland area - 122.6 c.y.

Fill in wetland area - 383.3 c.y.

Total area of wetland disturbed - 14,575 s.f.

Impervious area in wetland - 6915 s.f.

Disturbed wetland to be re-established - 7,660 s.f.

Wetland Creation Area

5,806 S.F.

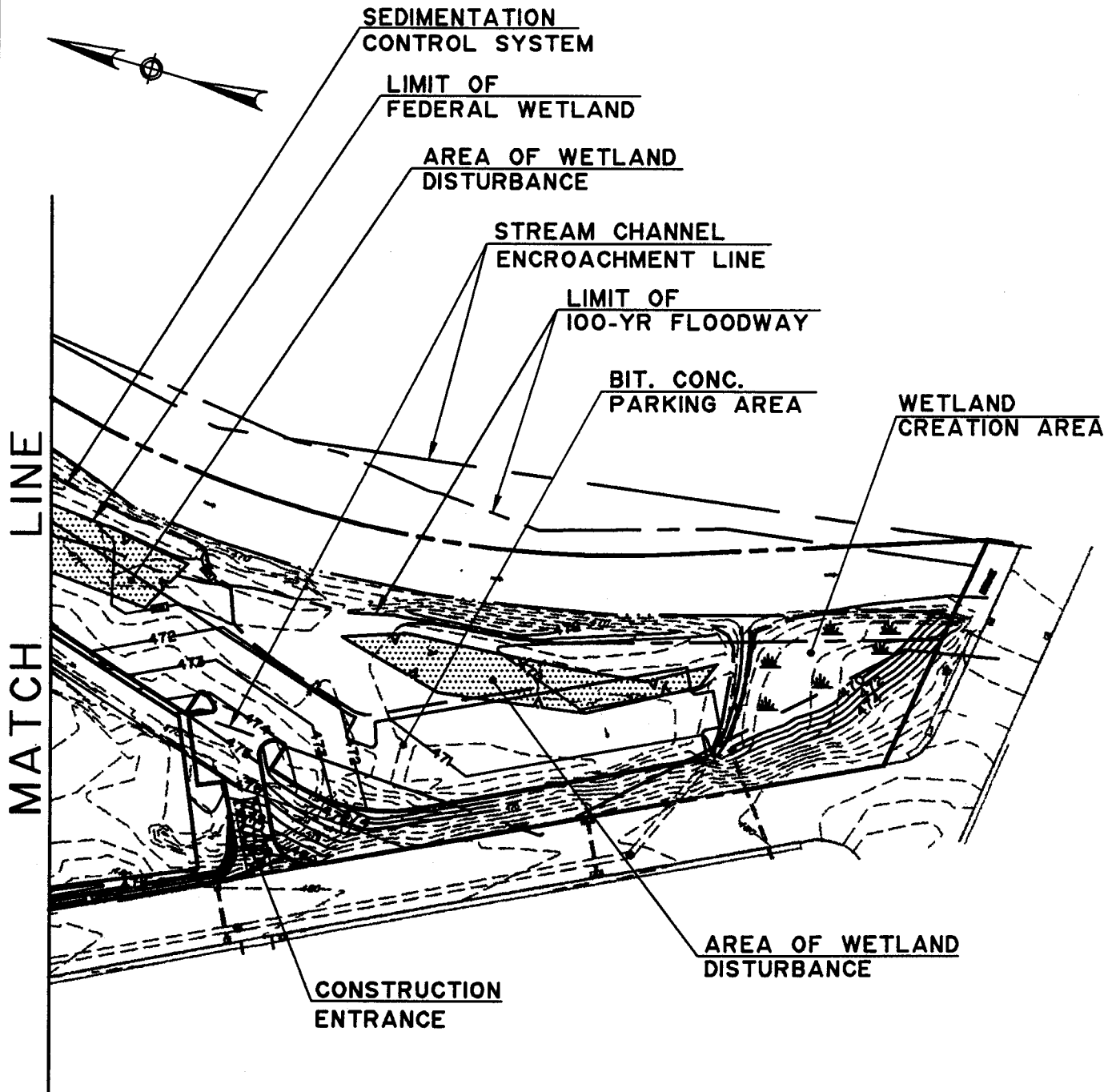

Revised 7/31/97

| | |
|---|-----------------|
| PROPOSED SITE PLAN SIEMON COMPANY | |
| PRINCETON ROAD AND DEPOT STREET WATERTOWN, CONNECTICUT | |
| PROJECT NO. 1477 | DESIGNED E.C.B. |
| DATE JUNE, 1997 | SCALE 1" = 100' |



**CONSULTING
ENGINEERS**

606 Willard Avenue
Newington, Connecticut 06111
(800) 666-5306
FAX (800) 666-5163

3
3

Wetland Function-Value Evaluation Form

Total area of wetland 0.13 ac Human made? yes Is wetland part of a wildlife corridor? no or a "habitat island"? no

Adjacent land use street, residential Distance to nearest roadway or other development 0 feet

Dominant wetland systems present PSS/PEM Contiguous undeveloped buffer zone present 0%

Is the wetland a separate hydraulic system? yes If not, where does the wetland lie in the drainage basin? n/a

How many tributaries contribute to the wetland? 0 Wildlife & vegetation diversity/abundance (see attached list)

Simon Company

Wetland I.D. 199701597













Latitude N41.60199 Longitude W73.11185

Prepared by: RL PM Date 5/14/03

Wetland Impact:
Type _____ Area _____

Evaluation based on:
Office X Field _____

Corps manual wetland delineation
completed? Y _____ N X

| Function/Value | Suitability Y N | | Rationale (Reference #)* | Principal Function(s)/Value(s) | Comments |
|---|--------------------|---|-----------------------------|-----------------------------------|-----------------------------|
|  Groundwater Recharge/Discharge | X | | | | sandy substrate |
|  Floodflow Alteration | | X | | | outside 100 year flood zone |
|  Fish and Shellfish Habitat | | X | | | |
|  Sediment/Toxicant Retention | X | | | X | receives runoff |
|  Nutrient Removal | | X | | | |
|  Production Export | | X | | | |
|  Sediment/Shoreline Stabilization | | X | | | |
|  Wildlife Habitat | | X | | | |
|  Recreation | | X | | | |
|  Educational/Scientific Value | | X | | | |
|  Uniqueness/Heritage | | X | | | |
|  Visual Quality/Aesthetics | | X | | | |
| ES Endangered Species Habitat | | X | | | |
| Other | | | | | |

Notes:

* Refer to backup list of numbered considerations.

199701597
Siemon Co.
Watertown, CT
8/28/02



Note *Polygonum cuspidatum* on right.



Debris washed in from upland and rooftop.

USGS 2 km W of Oakville, Connecticut, United States 12 Apr 1991



0 100M

0 100yd

Image courtesy of the U.S. Geological Survey
© 2002 Microsoft Corporation. All rights reserved.