

Maine Turnpike Authority

Congress Street Interchange

File No.: 199202046

City and State: Portland, ME

General Impacts: 12.66 acres other

Functions and Values Lost:

- Groundwater
- Floodflow Alteration
- Sediment Retention
- Nutrient Removal
- Wildlife Habitat

Year(s) Mitigation Constructed: May 1999

Size and Type of Mitigation as Proposed:

- 8.19 acres wetland and upland preservation
- 2.93 acres non-tidal emergent
- 6.04 acres non-tidal scrub-shrub
- 1.46 acres non-tidal wet meadow
- 1.23 non-tidal open water

Proposed Functions and Values of Mitigation: (From EA/SOF)

- Water Quality Maintenance
- Floodflow Alteration
- Wildlife Habitat

Mitigation Special Condition(s):

4. The permittee shall implement a mitigation plan to compensate for the project's impact to 12.66 acres of wetlands. The details of this plan are described in the document entitled "Final Wetland Mitigation Plan for the Proposed Jetport Interchange with the Maine Turnpike, Portland-South Portland", dated "January 1997". This plan, targeting lost water quality maintenance, visual quality/aesthetics, and wildlife habitat functions, involves the restoration/enhancement and creation of approximately 11.66 acres of wetlands and the preservation of an adjacent 8.19 acres of existing wetlands and uplands at a former sand pit operation off Pleasant Hill Road and highland Avenue at Scarborough, Maine.

5. The mitigation area shall be monitored by Normandeau Associates, Inc. or another qualified, environmental consultant for a period of at least 5 consecutive growing seasons following the initial construction and plantings. The Corps of Engineers reserves the

right to review the qualifications of the environmental consultant. The consultant shall inspect the mitigation areas near the end of each growing season, and the inspection reports shall be submitted to the Corps of Engineers not later than December 31st of each year. The reports shall include at a minimum (1) labeled, spot and panoramic photographs, (2) comparison plans of the mitigation plan with the actual situation, and (3) a narrative, including recommendations for remedial actions that may be necessary to ensure success of the mitigation.

In accordance with the schedule in the mitigation plan, plantings which have died or appear to be in poor health shall be replaced according to the remediation plan or any recommendations that have been approved in writing by the Corps of Engineers. Other remedial actions – coordinated with the Corps – shall occur at the first environmentally appropriate time. If any specimens of Phragmites sp. or Purple Loosestrife (Lythrum salicaria) appear in the off site areas during the monitoring period within areas disturbed by the construction activities, the permittee shall inform the Corps of Engineers. In coordination with the Corps, the permittee shall endeavor to eradicate those species from the affected areas.

6. The mitigation site described in condition 3 above shall be protected in perpetuity from the future development following construction. Remediation and monitoring efforts by the permittee shall be authorized in the restoration sites; however, no other filling, clearing, or other disturbance is authorized. The mitigation area shall be protected by conservation easement or deed restriction. The permittee shall provide documentary evidence sufficient to verify granting of the conservation easement or deed restriction. This evidence shall be provided to the Corps within ninety (90) days of completion of construction at the mitigation site.

Remarks:

None

Directions:

Take 128/95 north. When it splits, bear right staying on I-95 north. Take exit 6A, I-295 north toward South Portland/Portland Downtown. I-295 becomes I-95/Maine Turnpike. Take exit 6. Take connector to Routes 1/9 north. Go approximately 3 miles to Pleasant Hill Road on the right. Follow to Highland Road. Turn left. Take to town/city line. Site is immediately before the line on the left. There is a gate. Go in gate and down road. Site goes from first gate on the left along the road to a second gate. If keys to the gates are available, there is a road through the site.

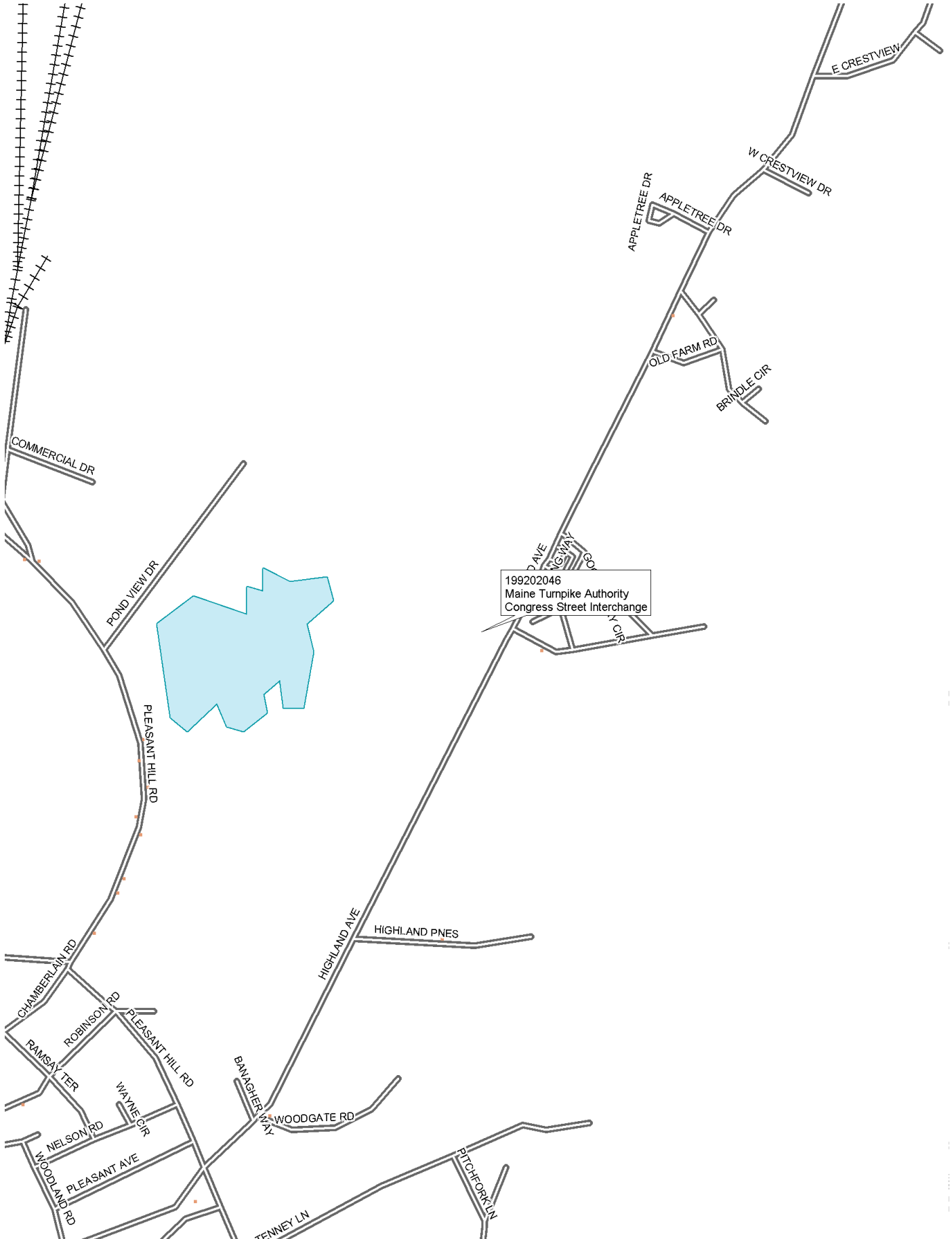

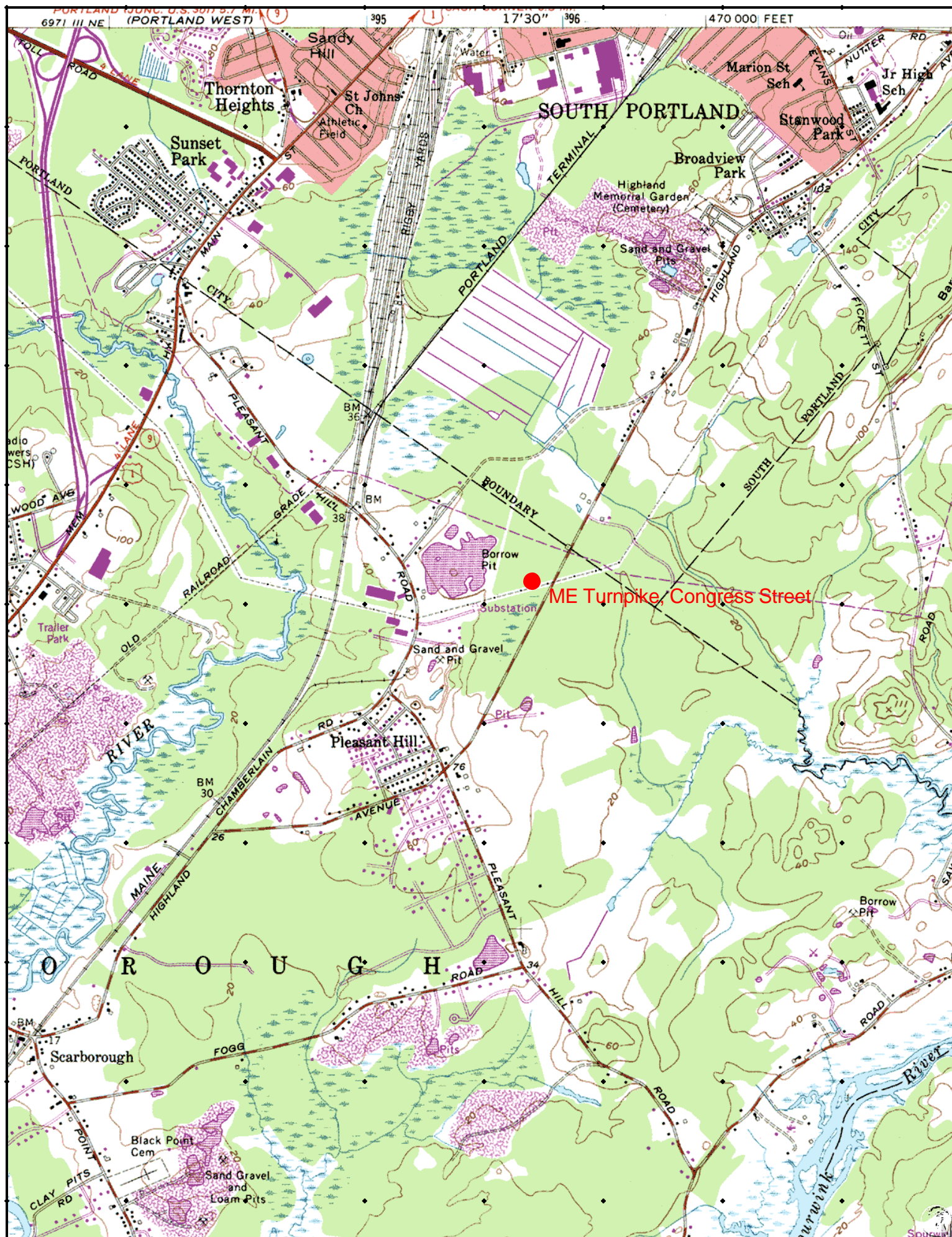

MITIGATION SITE FIELD DATA FORM

Site Name: Maine Turnpike Authority – Congress Street **File No.** 199202046

City/Town: Scarborough **State:** ME **Waterbody:** _____

Monitor(s): Paul Minkin, Kathleen McKee, Keith Wright, Jay Clement, Peter Tischbein

Date: 7-31-02

Was site constructed? yes

Is site wetland? yes

Size of proposed wetland: TBD

Actual size of wetland: TBD

Landscape position: TBD

Lat/Long Points: 43.49738N 070.28088W

Saved GPS Waypoint name: MTA

GPS Tracking Log Name: N/A

Perimeter: TBD

Surrounding land use:

Forested (mixed hardwood); forested fringe near highway; access road.

Is wetland function compromised by surrounding land use?

Highway diminishes the ability of wildlife to enter and leave site.

Plant health:

Good.

Invasive species:

Lythrum salicaria, *Elaeagnus* sp., *Phragmites australis*, *Phalaris arundinacea*

Wildlife use:

Deer tracks, red-winged blackbird, remains of a woodchuck, gold finch, bittern, frogs, marsh wren, other birds

Plants:

Wet meadow:

Acer rubrum
Alnus rugosa
Carex lurida
Carex sp.
Carex sp. (ovales)
Carex vulpinoidea
Elaeagnus sp.
Euthamia graminifolia
Fraxinus pennsylvanica
Galium sp.
Hypericum sp.
Ilex verticillata
Juncus effusus
Lythrum salicaria
Oenothera sp.
Phalaris arundinacea
Phleum pratense
Phragmites australis
Poaceae spp.
Potentilla sp. (*simplex* ?)
Sambucus canadensis
Scirpus atrovirens
Scirpus cyperinus
Solidago rugosa
Solidago sp.
Tridens flavus
Typha latifolia
Verbena hastata
Vicia sp.

Pond area:*Nymphaea odorata**Pontederia cordata***Emergent marsh:***Alisma* sp.*Alnus rugosa**Asclepias incarnata**Carex* sp. (ovales)*Carex vulpinoidea**Cephalanthus occidentalis**Cornus amomum**Eupatorium perfoliatum**Fraxinus pennsylvanica**Galium* sp.*Juncus effusus**Leersia oryzoides**Lysimachia terrestris**Lythrum salicaria**Phalaris arundinacea**Pontederia cordata**Scirpus americanus**Scirpus atrovirens**Scirpus cyperinus**Scirpus validus**Scirpus validus**Typha latifolia**Zizania aquatica***Soils Data:**

A – wet meadow

DEPTH	HORIZON	MATRIX	REDOX	COMMENTS
0.5 – 0"	O			fibric (sphagnum)
0 – 4	A	10YR 3/1	oxidized rhizospheres	fine silt loam
4 – 18	B	2.5Y 3/1	10YR 4/6, 5GY 4/0, common, medium, distinct	sandy silt loam

B – PEM

DEPTH	HORIZON	MATRIX	REDOX	COMMENTS
0 – 12"+	A	10YR 3/1	conc. - 10YR 5/6 common, medium, faint depl. - 5Y 4/1 common, medium, prominent	sandy loam

Sketch approximate mitigation site, noting areas and types of wetlands, waters, other features, landscape position, landmarks, etc., and data and photo point(s)

See file.

Overall Description of site:

A large open field with two shallow ponds, intersected by a dirt road. Grading of site is pit and mound. The pits hold 6-7 inches of water. The site has woody debris scattered throughout. Monitoring wells were installed by Maine DPW. Bird habitat for this site is high.

Comments, problems, recommendations:

Phragmites may become more dominant in this site and should be controlled.

The shrub meadow was not being colonized by new shrubs; the only shrubs that were there had been planted. This may be because the proposed shrub meadow is too far away from a seed source and competition is high and vegetation is dense.

The ponded areas are shallow and may grow in over time.

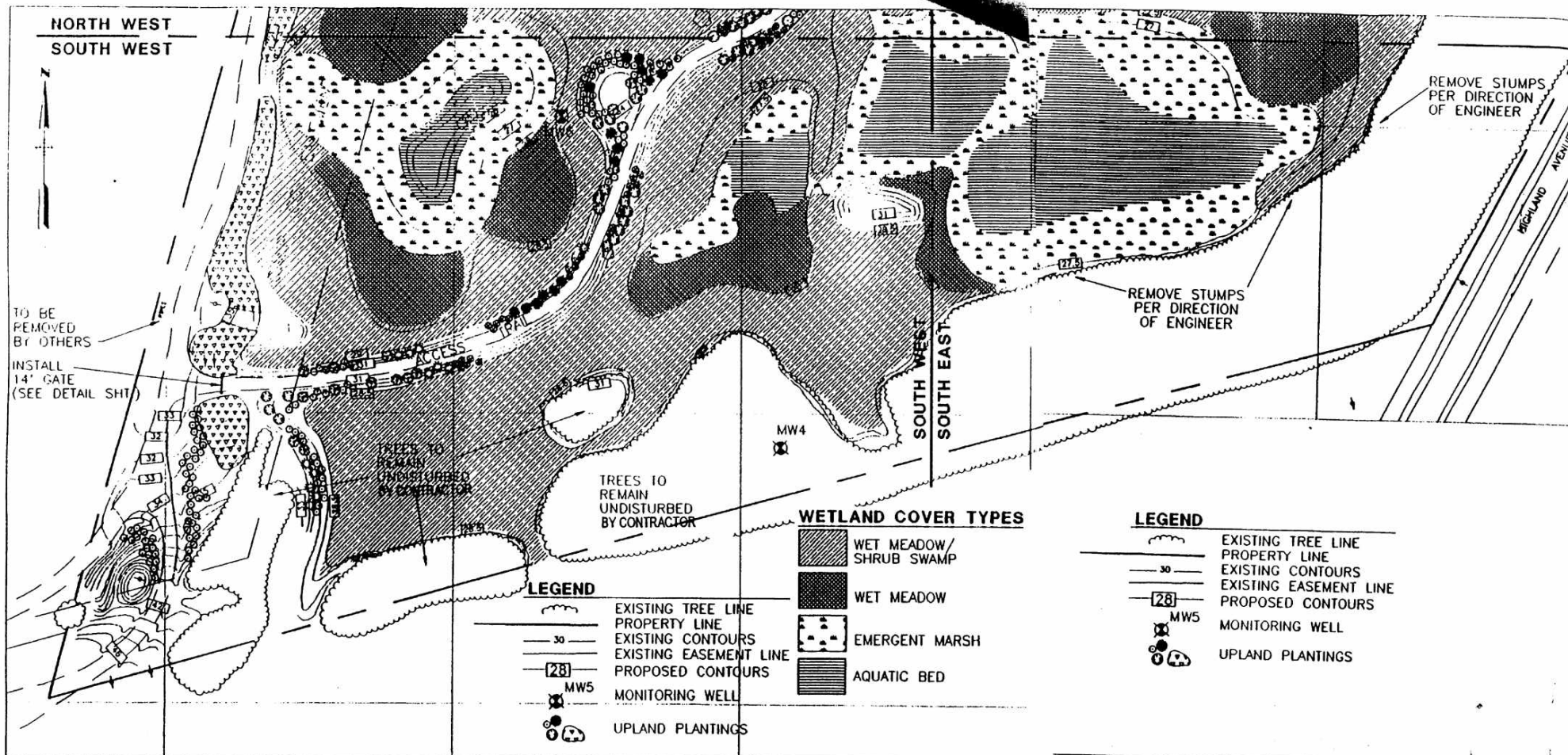

1000' 0' SCALE 1000' 2000'

NORMANDEAU ASSOCIATES INC.
 ENVIRONMENTAL CONSULTANTS
 25 Nashua Road Bedford, New Hampshire 03110-5500

Maine Turnpike Authority
 Maine Turnpike



JETPORT INTERCHANGE
 PROUT MITIGATION SITE

HNTB

HOWARD NEEDLES TAMMEN & BERGENDOFF, INC.
 ARCHITECTS ENGINEERS PLANNERS

FIGURE 5-2

PLANTING PLAN

NOV. 27, 1996

Sheet No.
 3C of 4

ASSOCIATES INC.
 CONSULTANTS
 25 Nashua Road Bedford, New Hampshire 03110-5500

Maine Turnpike Authority
 Maine Turnpike



JETPORT INTERCHANGE
 PROUT MITIGATION SITE

HNTB

FIG

NO

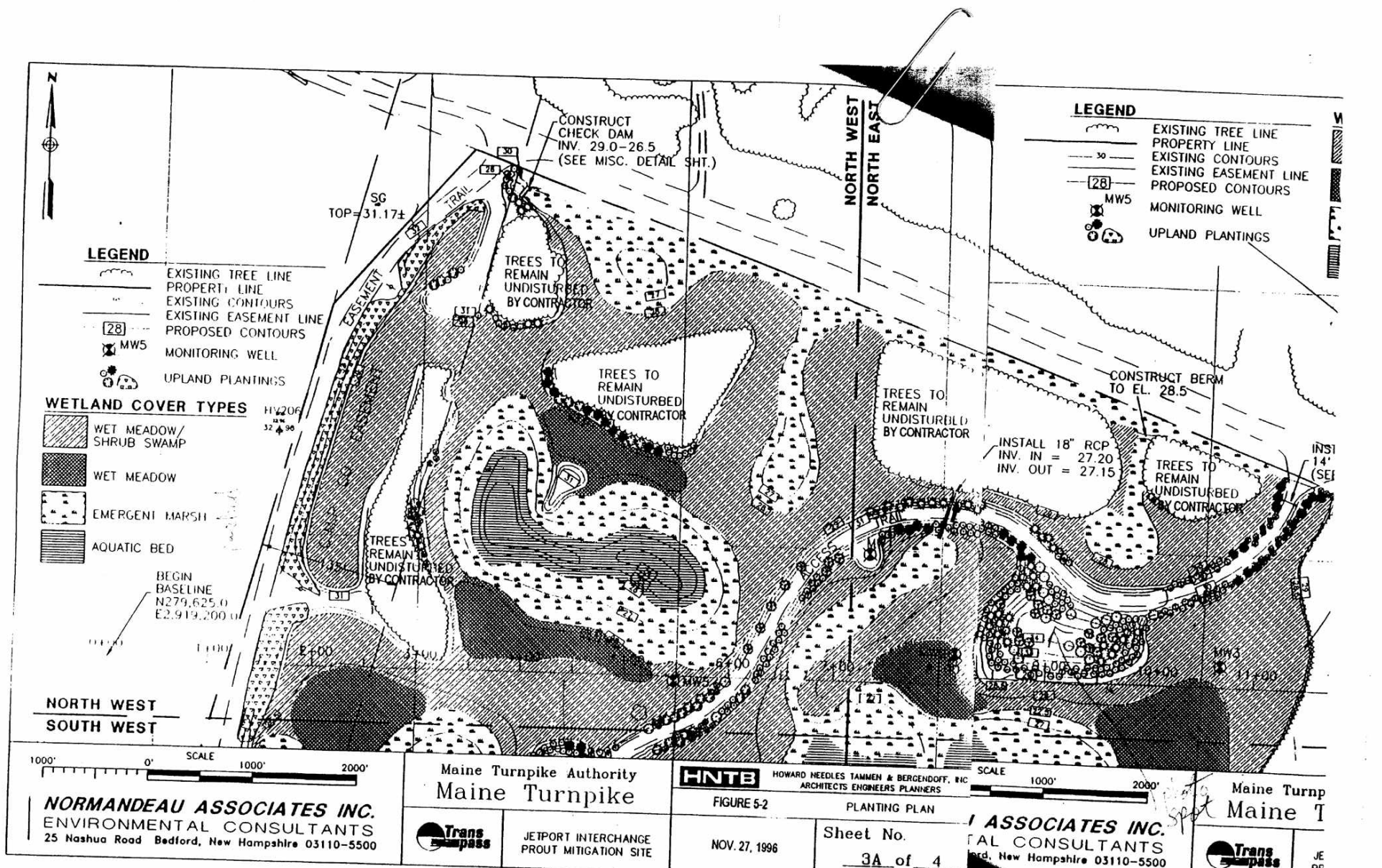

Wetland Function-Value Evaluation Form

MTA – Congress Street
199202046

Total area of wetland 11.72 ac Human made? yes Is wetland part of a wildlife corridor? no or a "habitat island"? no

Adjacent land use forest, gravel road Distance to nearest roadway or other development 10 feet gravel

Dominant wetland systems present	PEM/PSS/POW	Contiguous undeveloped buffer zone present	no
----------------------------------	-------------	--	----

Is the wetland a separate hydraulic system? no If not, where does the wetland lie in the drainage basin? top

How many tributaries contribute to the wetland? _____ Wildlife & vegetation diversity/abundance (see attached list)

Wetland I.D. 199202046

Latitude N42.49738 Longitude W71.28088













Prepared by: KM KW PM Date 7/31/02

Wetland Impact:
Type _____ Area _____

Evaluation based on:

Office Field X

Corps manual wetland delineation completed? Y_____ N X

Function/Value		Suitability Y N	Rationale (Reference #)*	Principal Function(s)/Value(s)	Comments
	Groundwater Recharge/Discharge	X		10,12	
	Floodflow Alteration	X			
	Fish and Shellfish Habitat		X		
	Sediment/Toxicant Retention	X		2,3,	pit/mound and ponds
	Nutrient Removal	X		2,3,4,8,7	
	Production Export	X		1,2,4,5,7,12	not flushing out but wildlife usage
	Sediment/Shoreline Stabilization	X		2,3	
	Wildlife Habitat	X			X
	Recreation		X		
	Educational/Scientific Value		X		
	Uniqueness/Heritage		X		
	Visual Quality/Aesthetics		X		
ES	Endangered Species Habitat		X		
	Other				

Notes:

* Refer to backup list of numbered considerations.

199202046
Maine Turnpike Authority – Congress Street Interchange
Scarborough, ME
7/31/02



Looking southeast, south, and southwest across site from mound near trail through site.

USGS 5 km SW of South Portland, Maine, United States 29 Apr 1998



0 100M

0 100yd

Image courtesy of the U.S. Geological Survey
© 2003 Microsoft Corporation. All rights reserved.