

Lego Systems

File No.: 198802617

City and State: Enfield, CT

General Impacts: 0.96 acre non-tidal emergent

Functions and Values Lost: Wildlife Habitat

Year(s) Mitigation Constructed: April 1991

Size and Type of Mitigation as Proposed: 1.5 acres PEM

Proposed Functions and Values of Mitigation: Wildlife Habitat

Mitigation Special Condition(s):

The applicant shall re-establish an approximately 1.5 acre wetland with emergent plants in a field west of the existing building, as described in plans entitled "Proposed Wetland" in 2 sheets and revised on "August 15, 1989" and subject to the attached conditions and following special conditions.

This wetland shall be monitored for three years, with four reports submitted jointly to the Army Corps of Engineers and to the National Fish and Wildlife Service. One report will be submitted when construction of the wetland is complete and it will describe the types of numbers of plants emplaced and describe any changes to the proposed wetland plans. The remaining three reports will be annual reports, produced the end of each growing season and should include, but not be limited to, a list of plants surviving from the planting effort, a list of plants naturally establishing themselves, descriptions of any indication of wildlife use, and photos of the site, including some from a single recoverable reference point.

Any of the cultivated plants which do not survive the first growing season will be replaced. Subsequent mortality of the cultivated plants will be noted in the subsequent reports, but species will be discussed in the last year's report.

Any specimens of common reed, *Phragmites australis*, and purple loosestrife, *Lythrum salicaria*, will be removed from the proposed wetland during the annual survey if discovered.

Remarks:

Permit not found.

Directions:

Take Route I-95 south to I-90 Mass Pike. Take exit 6, I-291 toward Springfield/Hartford, CT. Keep left at the fork in the ramp. Merge onto I-291 south. Take exit 1A, I-91 south toward Hartford, CT. Keep left at the fork in the ramp. Merge on I-91 south. Take exit 48, CT-220/Elm Street toward Thompsonville. Turn left onto CT-220/Elm Street. Continue to follow Elm Street. Stay straight to go onto Moody Road. Turn left onto Print Shop Road.



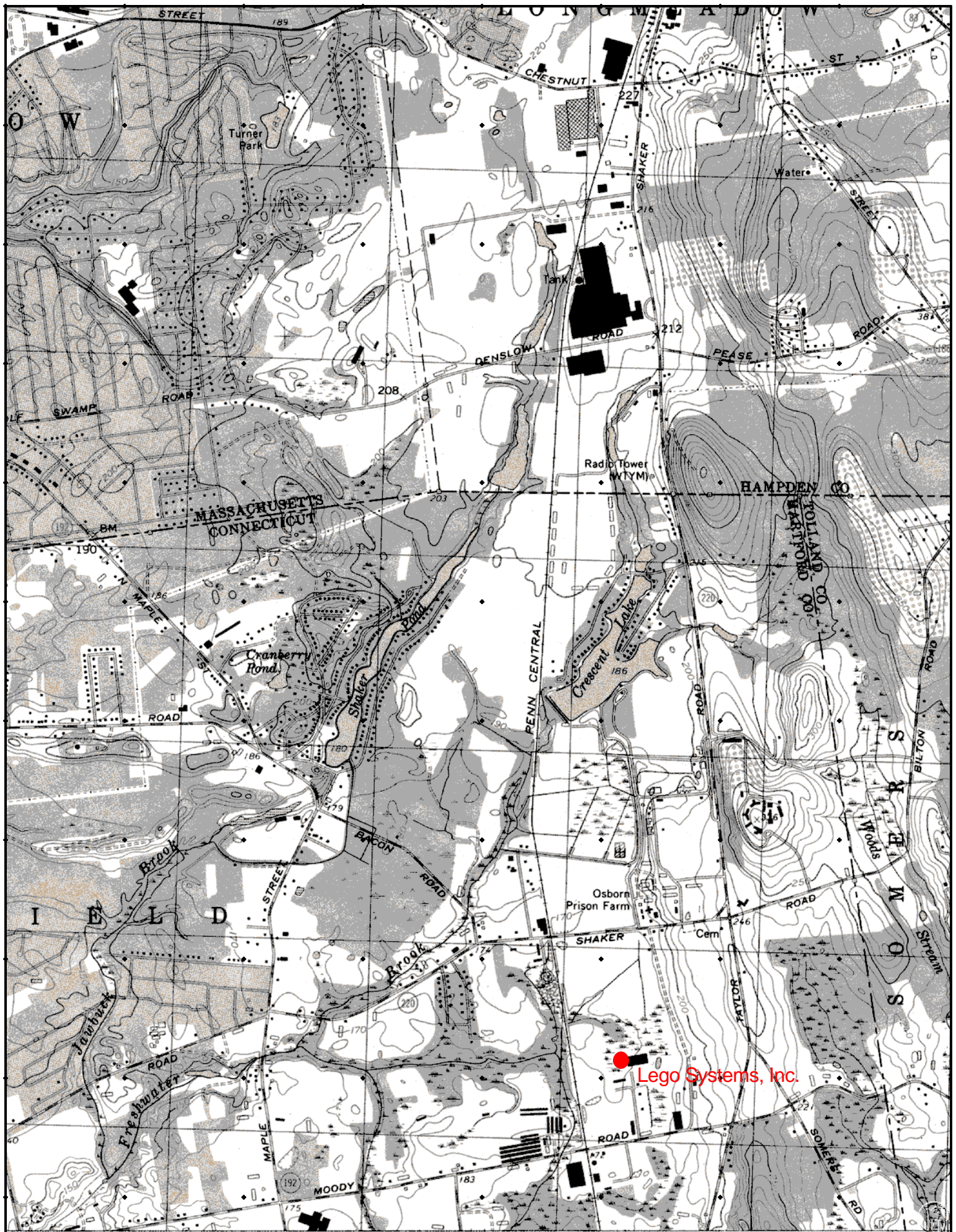

MITIGATION SITE FIELD DATA FORM

Site Name: Lego Systems, Inc. File No. 198802617

City/Town: Enfield State: CT Waterbody: Freshwater Brook

Monitor(s): McKee, Wright Date: 6-17-02

Was site constructed? yes

Is site wetland? yes

Size of proposed wetland: 1.5 acres

Actual size of wetland: app. same

Landscape position: ponded depression

Lat/Long Points: 41.8704 W072.71823

Saved GPS Waypoint name: LEG

GPS Tracking Log Name: N/A

Perimeter: TBD

Surrounding land use:

The factory is separated from the wetland by a large upland grassland. More than half of the wetland is surrounded by forested wetland.

Is wetland function compromised by surrounding land use?

No

Plant health:

Good

Invasive species:

Phragmites australis (trace), *Phalaris arundinacea* monoculture throughout much of the site. *Rosa multiflora* formed an impenetrable thicket on one side of the pond.

Wildlife use:

Frogs, red-winged blackbird, gold finch, painted turtle laying eggs, muskrat evidence, reports of red fox, coyote, great blue heron, and owls

Plants:

Acer rubrum
Betula populifolia
Carex lurida
Eleocharis sp.
Galium sp.
Lemna sp.
Onoclea sensibilis
Phalaris arundinacea
Phragmites australis
Rhamnus frangula
Robinia pseudoacacia
Rosa multiflora
Salix sp.
Scirpus sp.
Scirpus validus
Solidago sp.
Spiraea tomentosa
Typha latifolia

Soils Data:

Soils data not collected at this site.

Sketch approximate mitigation site, noting areas and types of wetlands, waters, other features, landscape position, landmarks, etc., and data and photo point(s):

See field notes.

Overall Description of site:

None.

Comments, problems, recommendations:

The primary objective of this mitigation was to create a shallow open water area with an emergent marsh. This was accomplished. There is a diversity of plants in places where the *Phalaris arundinacea* monoculture has not taken over. The site also shows evidence of wildlife use. Its position in the watershed (near a brook) allows it to provide some floodwater retention.

This site's Mitigation Monitoring Report Review indicates that the first monitoring report noted mortality of some planted plants. While the permit required them to be replanted, there was no mention of them in future monitoring reports. The permit required four annual monitoring reports (which were submitted) that included plant survivorship rates, but this information was not reported. The number of plant species that were originally planted was less than the number of plant species observed. The western side of the wetland was dominated by an impenetrable thicket of *Rosa multiflora*.

198802617
Lego Systems, Inc.
Enfield, CT

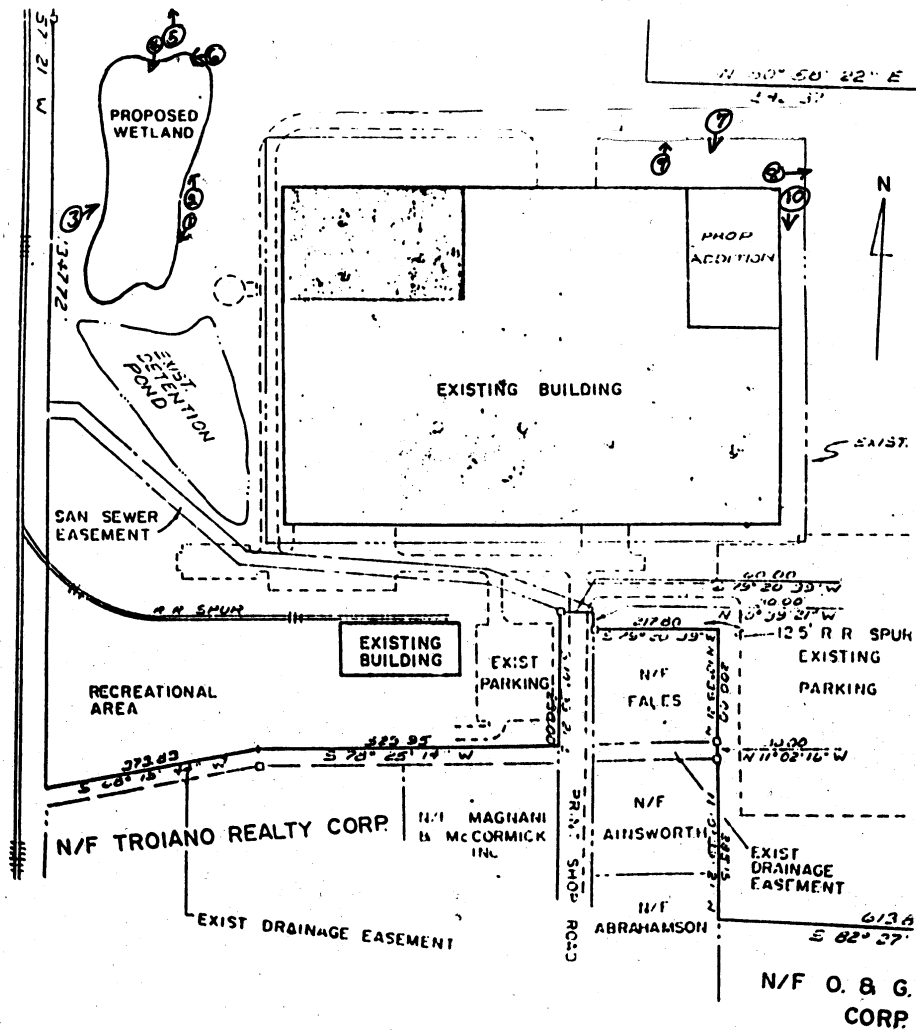

LOCATION PLAN
FOR: Lego Systems
AT: Enfield, CT
SCALE: NTS

DATE: 6/8/89

Plan 1

Sketch approximate mitigation site, noting areas and types of wetlands, waters, other features, landscape position, landmarks, etc., and data and photo point(s)

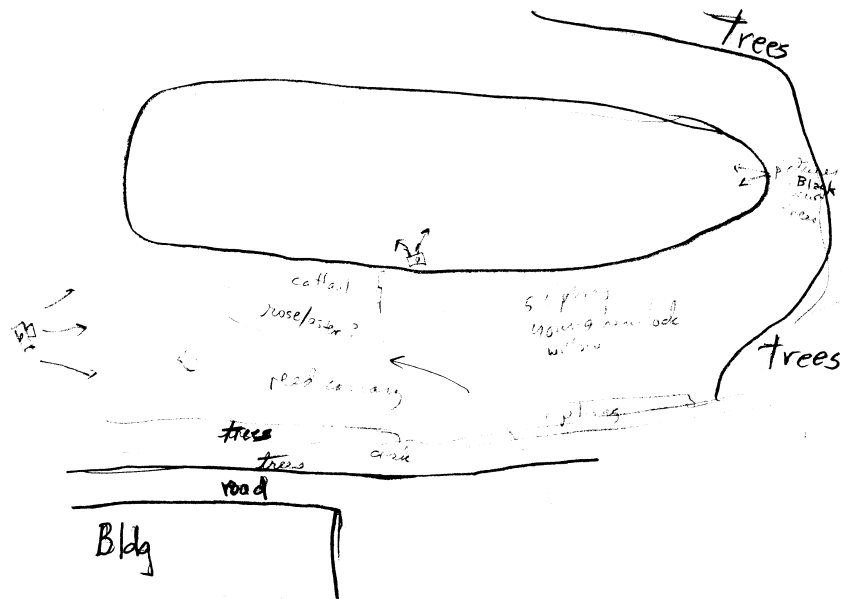

Comments: ~~South of road~~

0-2" A 1st
2-5" for 2nd
5" for 3rd (and) 4th

Wetland Function-Value Evaluation Form

Total area of wetland 1.5 ac Human made? yes Is wetland part of a wildlife corridor? _____ or a "habitat island"? _____

Adjacent land use upland grassland, forested wetland Distance to nearest roadway or other development ~1,000 feet

Dominant wetland systems present PEM Contiguous undeveloped buffer zone present yes

Is the wetland a separate hydraulic system? yes If not, where does the wetland lie in the drainage basin? _____

How many tributaries contribute to the wetland? none Wildlife & vegetation diversity/abundance (see attached list)

Wetland I.D. Lego Systems 198802617













Latitude N41.8704 Longitude W72.71823

Prepared by: Wright Date 6/25/02

Wetland Impact:
Type _____ Area _____

Evaluation based on:
Office _____ Field X

Corps manual wetland delineation
completed? Y X N _____

Function/Value	Suitability Y N		Rationale (Reference #)*	Principal Function(s)/Value(s)	Comments
 Groundwater Recharge/Discharge		X			
 Floodflow Alteration	X		7,13	X	
 Fish and Shellfish Habitat		X			
 Sediment/Toxicant Retention	X		1,2,3,5,10,12		
 Nutrient Removal	X		2,3,5,8,9		
 Production Export	X		1,2,4,7,8,12		
 Sediment/Shoreline Stabilization		X			
 Wildlife Habitat	X		1,3,4,5,7,9,11,17	X	
 Recreation		X			
 Educational/Scientific Value		X			
 Uniqueness/Heritage		X			
 Visual Quality/Aesthetics		X			
ES Endangered Species Habitat		X			
Other					

Notes:

* Refer to backup list of numbered considerations.

198802617
Lego Systems
Enfield, CT
6/17/02



East side of pond facing northwest



On east side of pond facing southwest



On north side of wetland facing south

USGS 5 km NE of Enfield, Connecticut, United States 23 Apr 1990



0 100 200M

0 100 200yd

Image courtesy of the U.S. Geological Survey
© 2003 Microsoft Corporation. All rights reserved.