

## Daily Report

<b>Project:</b>	Durham Meadows Pipeline Installation	<b>Date:</b>	October 17, 2019
<b>Location:</b>	Talcott Ridge Drive, Middletown CT	<b>Day of Week:</b>	Thursday
<b>Project #:</b>	AECOM: 60445033	<b>Report No:</b>	15
<b>Contractor:</b>	Ludlow Construction	<b>Page:</b>	1 of 10

### Weather Conditions

**Conditions:** Daylight hours. Windy with occasional gusts. 65% clouds/partly sunny.  
**Temperature (°F):** High 57°F Low 46°F

Contractors & Subcontractors Workforce								
Trade	#	x	hrs	Trade	#	x	hrs	
USACE				Ludlow Construction				
	Field Engineer	1	x	8	Superintendent	1	x	8
				Safety Officer	1	x	8	
				Foreman	1	x	8	
				Dump truck Operator	3	x	8	
				Excavator Operator	2	x	8	
				Skid Steer/Bucket Loader Op.	1	x	8	
				Laborers	4	x	8	
				Total 10 persons + 1 sub. Trucker				
				Note that some persons operate				
				Multiple pieces equipment.				
				Sub-contractor				
				Dump truck Operator	1	x	8	
			Middletown Police Dept.					
			Police Officer Detail	1	x	8		

Equipment in Use			
Type	#	x	hrs
Concrete sawing machine	0	x	8
Dump truck	4	x	8
Excavator - Large	1	x	8
Skid Steer / Bucket Loader	1	x	8
Plate Compactor	1	x	8
Jumping Jack Compactor	2	x	8
Light Tower	0	x	8
Mid-size Excavator	1	x	8
Tractor-style Excavator	0	x	8
Pipe saw	1	x	8
Rolling Compactor	1	x	8
Street Sweeper (Broce Broom)	1	x	8
Material Hopper	1	x	8

<b>Visitors:</b>	Rich Belandry (AECOM)	Steve Dunbar (USACE)
	Ed Hathaway (EPA)	
	Carl Niemitz (USACE)	Lisa Belisle (USACE)

### Notes:

**Begin at 47+27.67 and End at 46+50.34** Distance counts down as one proceeds up – east on - Talcott Ridge Dr.; distance is by length of pipe, not “road distance” uphill along Talcott.

**Photos:** Could not correct time stamp. Date only on photos.

**Pipe Connections:** Though not noted specifically below, all pipe connections are restrained either by bell groove locks or mega-lugs connectors. This has been the case for the entire run up Talcott Ridge Drive.

0730 – On site: Talcott Ridge Dr. excavation started with medium size excavator to make turn then switch to large (CAT 336E) excavator. Begin day at 47+27.67 on the upside of a 22.5° bend. See Figure below for updated information on the bend.

0910 – Dig out under existing 8” restrained water line. Line located at approximately 47+19.

0940 – First section of 16” DI pipe installed under existing water line - 11 feet of pipe to 47+16.67. This section crosses under existing 8” restrained water line. There is 0.5 feet of clearance between bottom of existing line and top of 16” DI line installed. Two 16” butterfly, 16x16x8 T and one 8” gate valve assembly coming in next.

<b>Res. Representative:</b>	W. Abrahams-Dematte	<b>Date:</b>	10/17/19
-----------------------------	---------------------	--------------	----------

## Daily Report

<b>Project:</b>	Durham Meadows Pipeline Installation	<b>Date:</b>	October 17, 2019
<b>Location:</b>	Talcott Ridge Drive, Middletown CT	<b>Day of Week:</b>	Thursday
<b>Project #:</b>	AECOM: 60445033	<b>Report No:</b>	15
<b>Contractor:</b>	Ludlow Construction	<b>Page:</b>	2 of 10

1000 – The triple valve/Tee section installed. Stations west to east are 16” Butterfly – 47+16.17 at elevation 358.04 / 16x16x8 Tee. – 47+13.34 at elevation 358.04 / 16” Butterfly – 47+10.5 at elevation 358.02. The depth below current blacktop surface 7.23 feet (365.27’). The 8-inch gate valve is located 20” off the center line of the Tee to the south side of the line. NOTE: Update from 22.5° turn located at 47+27.67 (bend installed at end of previous day). New ties taken from catch basins (see Figure below) and elevation shot of 357.51’ top of bend, 7.56’ below top of asphalt.

1025 – Install first full 20-foot line of 16” DI to 46+90.34.

1130 – Visitors from AECOM, EPA, and USACE. Depart approx. 1200.

1200 – Preparing trench for second 20-foot section of 16” DI pipe to 46+70.34. This section crosses under 18-inch catch basin drain pipe, with approximately 1.5-foot separation between pipes.

1230 – Setting second 20-foot section.

1250 – Laying stone base for third 20-foot section of 16” DI pipe. This is the final section of pipe for the day ending at 46+50.34. Total distance installed 77.33 feet.

1300 – Off-site to trailers at MMC.

### Payment Items:

**Res. Representative:**

W. Abrahams-Dematte

**Date:** 10/17/19

## Daily Report

**Project:** Durham Meadows Pipeline Installation  
**Location:** Talcott Ridge Drive, Middletown CT  
**Project #:** AECOM: 60445033  
**Contractor:** Ludlow Construction

**Date:** October 17, 2019  
**Day of Week:** Thursday  
**Report No:** 15  
**Page:** 3 of 10



Figure 1 – Start Station 47+27.67. Note existing 8" restrained water line just beyond end of trench box. 16" DI will eventually run 0.5 feet under this line. First section installed – 11 feet to 47+16.67 Picture taken facing east.

**Res. Representative:** W. Abrahams-Dematte

**Date:** 10/17/19

## Daily Report

**Project:** Durham Meadows Pipeline Installation  
**Location:** Talcott Ridge Drive, Middletown CT  
**Project #:** AECOM: 60445033  
**Contractor:** Ludlow Construction

**Date:** October 17, 2019  
**Day of Week:** Thursday  
**Report No:** 15  
**Page:** 4 of 10



Figure 2 – Facing down into trench from north side. Note 8" existing line to right side crossing over first 11 feet of 16" DI installed. This is followed by the assembly currently being lowered into the trench – two 16" butterfly valves (red) either side of a 16x16x8 Tee-section (centered) with an 8" gate valve (red) 20" off the center line of the T to the south side.

## Daily Report

**Project:** Durham Meadows Pipeline Installation  
**Location:** Talcott Ridge Drive, Middletown CT  
**Project #:** AECOM: 60445033  
**Contractor:** Ludlow Construction

**Date:** October 17, 2019  
**Day of Week:** Thursday  
**Report No:** 15  
**Page:** 5 of 10



Figure 3 – Picture taken facing east. Thrust blocks installed on north side of Tee-section across from 8" gate valve.

## Daily Report

**Project:** Durham Meadows Pipeline Installation  
**Location:** Talcott Ridge Drive, Middletown CT  
**Project #:** AECOM: 60445033  
**Contractor:** Ludlow Construction

**Date:** October 17, 2019  
**Day of Week:** Thursday  
**Report No:** 15  
**Page:** 6 of 10



Figure 4 – Picture facing west. First 20-foot section of 16" DI installed to 46+90.34, just short of crossing under 18" catch basin drainage pipe. Next section of pipe will cross approximately 1.5 feet below the drain pipe..

## Daily Report

**Project:** Durham Meadows Pipeline Installation  
**Location:** Talcott Ridge Drive, Middletown CT  
**Project #:** AECOM: 60445033  
**Contractor:** Ludlow Construction

**Date:** October 17, 2019  
**Day of Week:** Thursday  
**Report No:** 15  
**Page:** 7 of 10



Figure 5 – Facing west into trench. Installing valve extension stems and raising grade. Note shiny water line marker tape.

## Daily Report

**Project:** Durham Meadows Pipeline Installation  
**Location:** Talcott Ridge Drive, Middletown CT  
**Project #:** AECOM: 60445033  
**Contractor:** Ludlow Construction

**Date:** October 17, 2019  
**Day of Week:** Thursday  
**Report No:** 15  
**Page:** 8 of 10



Figure 6 – Facing west, compacting lifts with Jumping Jack around valve box risers.

## Daily Report

**Project:** Durham Meadows Pipeline Installation  
**Location:** Talcott Ridge Drive, Middletown CT  
**Project #:** AECOM: 60445033  
**Contractor:** Ludlow Construction

**Date:** October 17, 2019  
**Day of Week:** Thursday  
**Report No:** 15  
**Page:** 9 of 10



Figure 7 – Facing east, final 20-foot section of pipe installation.

## Daily Report

<b>Project:</b>	Durham Meadows Pipeline Installation	<b>Date:</b>	October 17, 2019
<b>Location:</b>	Talcott Ridge Drive, Middletown CT	<b>Day of Week:</b>	Thursday
<b>Project #:</b>	AECOM: 60445033	<b>Report No:</b>	15
<b>Contractor:</b>	Ludlow Construction	<b>Page:</b>	10 of 10

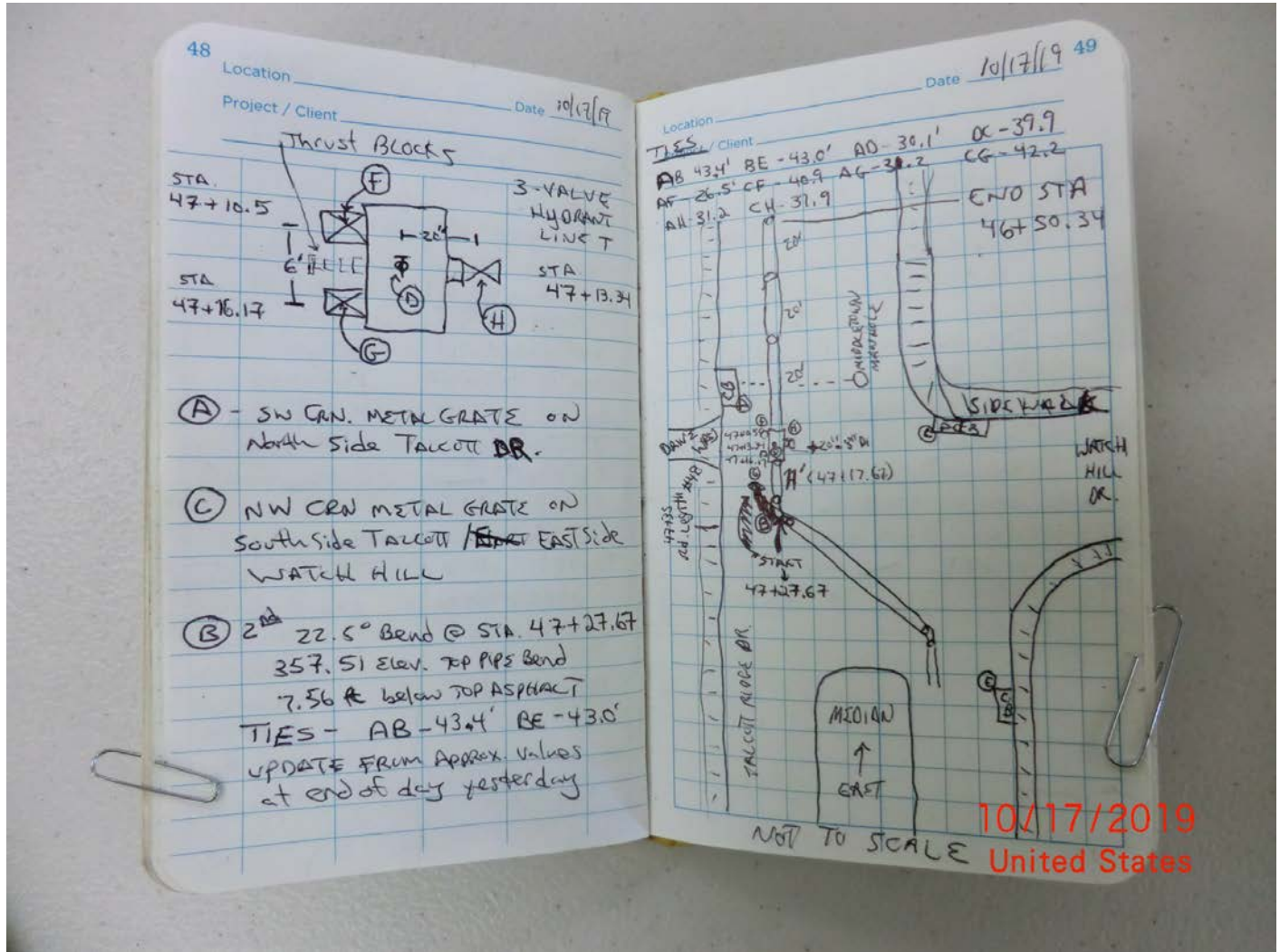

Figure 8 – Tie-offs and elevations. Note start and end points. Circled letters are consistent from left to right page. Detail on left page is an enlargement of Tee-section installed just after 2<sup>nd</sup> bend in the line.