

**US Army Corps
of Engineers®**
New England District

[illegible]

U.S. ARMY CORPS OF ENGINEERS NEW YORK AND DISTRICT CONCORD, MASSACHUSETTS www.usace.army.mil	REVIEWED BY: <i>William J. Ginter</i> CONDUCTED BY: <i>William J. Ginter</i> DATE: <i>8/28/2013</i> DWN BY: <i>SWK</i> CND BY: <i>SWK</i> DESIGN FILE: <i>RC-NS-230N</i> DRAWING CODE: <i>10-2-27</i> FILE NAME: <i>RC2727</i> SIZE: <i>1" = 10'</i> ANS I F
---	---

RICHMOND HARBOR
WINDHAM AND RICHMOND, MAINE
CONDITION SURVEY

12 AND 15-FOOT CHANNELS
WESTERN SIDE OF SWAN ISLAND

SHEET
IDENTIFICATION
V-102
SHEET 2 OF 10

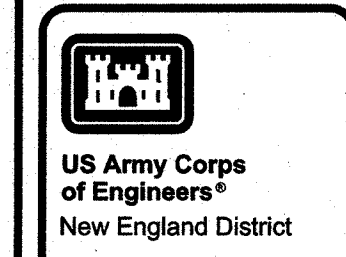
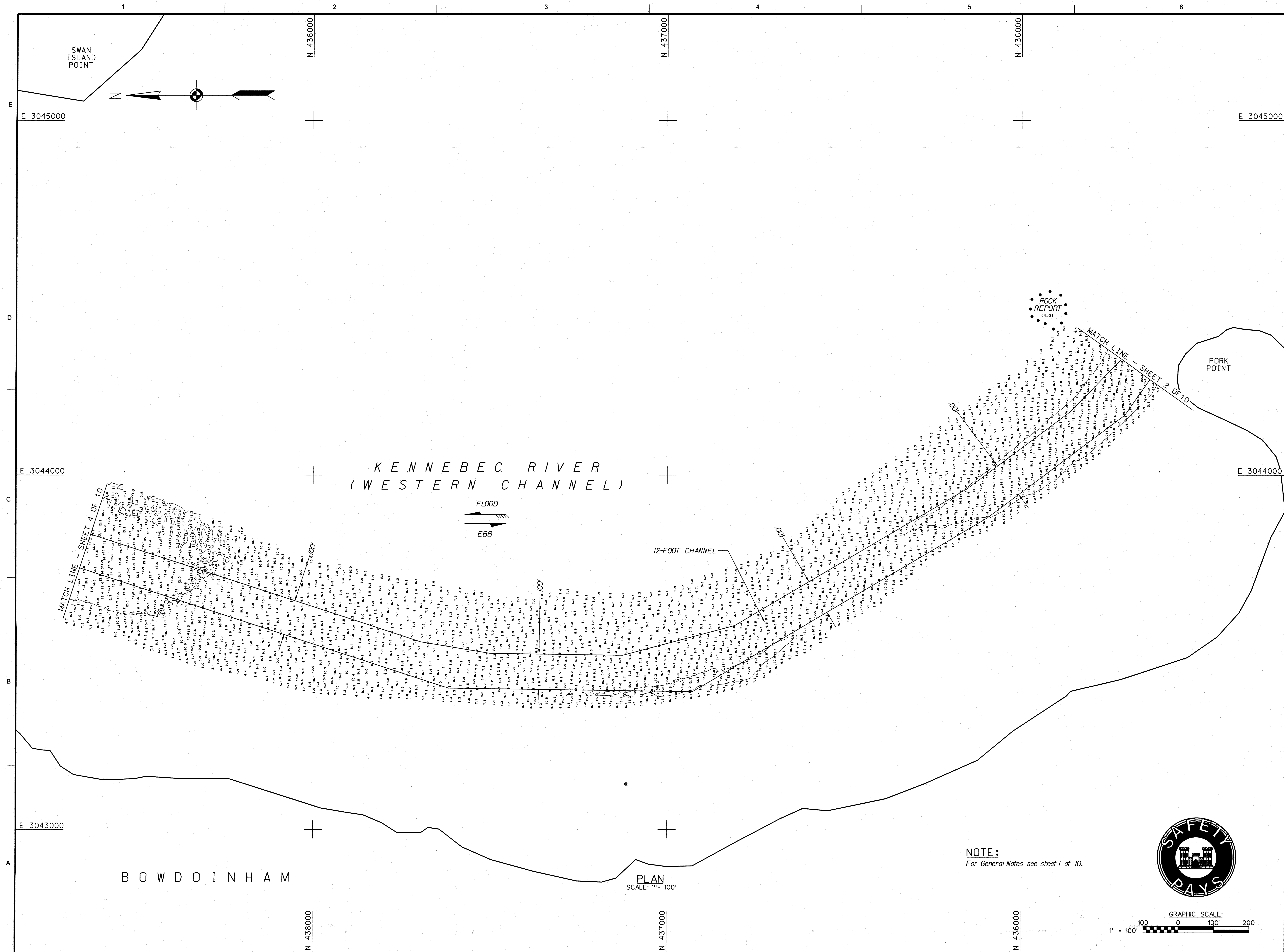
[illegible]

U.S. ARMY CORPS OF ENGINEERS NEW ENGLAND DISTRICT CONCORD, MASSACHUSETTS www.hab.usace.army.mil		REVIEWED BY: <i>John W. Rafter</i> SPECIALIST BY: <i>John W. Rafter</i> DATE: 8/28/2013	DWM BY: <i>John W. Rafter</i> SWM BY: <i>John W. Rafter</i> DATE: 8/28/2013
PERMITTED BY: <i>John W. Rafter</i> Chief Survey Section		RICHMOND FILE RICHMOND FILE RICHMOND FILE	DRAWING CODE: RIC-2727
PLOT SCALE: 1" = 100'		PLOT DATE: 8/28/2013	FILE NAME:
SIZE:		ANS I	RIC2727V103.303

RICHMOND HARBOR
BOWDOINHAM AND RICHMOND, MAINE
CONDITION SURVEY

12 AND 15-FOOT CHANNELS
WESTERN SIDE OF SWAN ISLAND

SHEET
IDENTIFICATION
V-103
SHEET 3 OF 10



GRAPHIC SCALE:

1" = 100'



A horizontal graphic scale bar. The bar is divided into four segments. The first segment is 100 feet long and is filled with a black and white checkerboard pattern. The second segment is 100 feet long and is solid black. The third segment is 100 feet long and is solid white. The fourth segment is 100 feet long and is solid black. Above the bar, the numbers 100, 0, 100, and 200 are marked at the segment boundaries. To the left of the bar, the text '1" = 100\'' is written.

NOTE:
For General Notes see sheet 1 of 10.

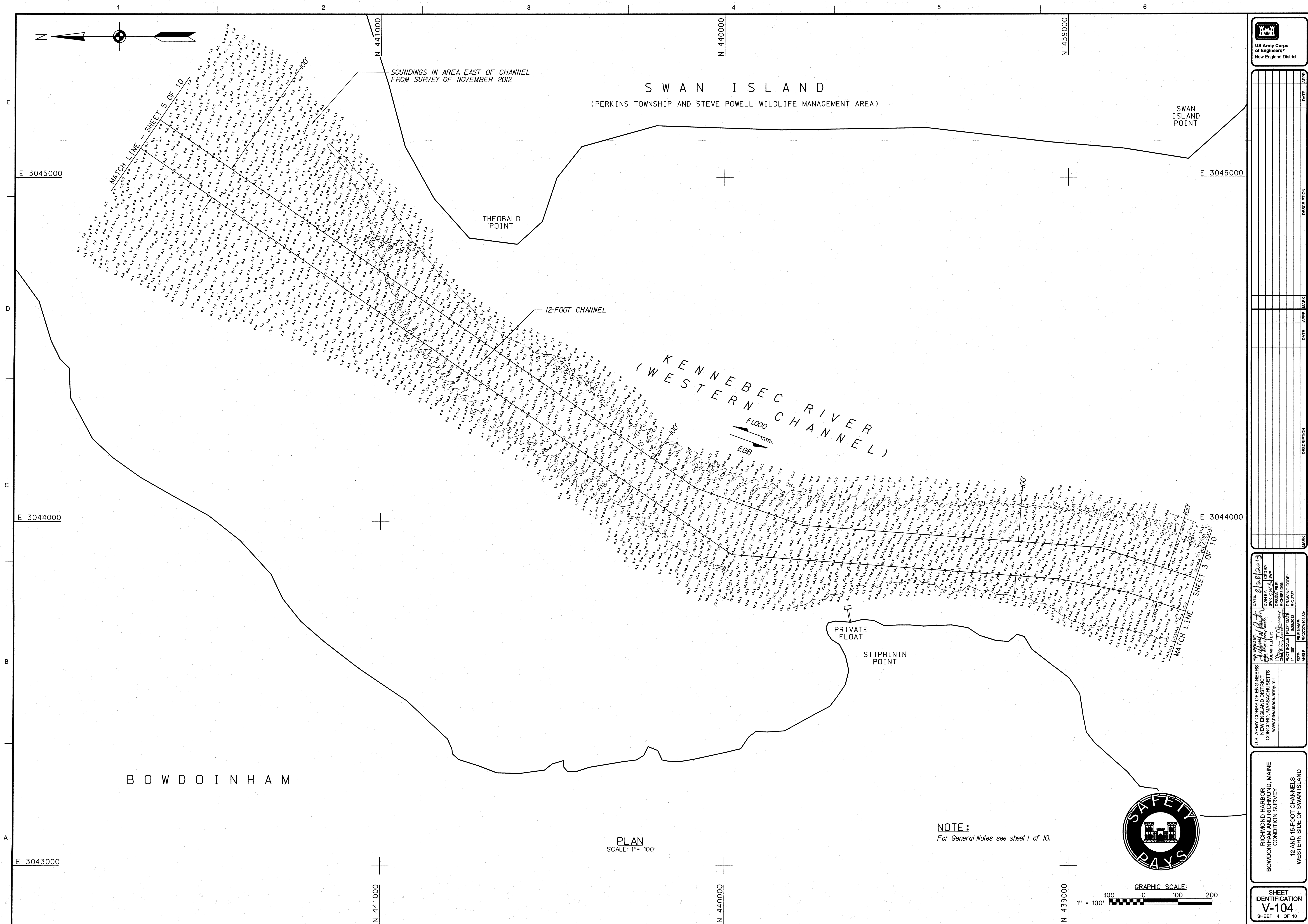

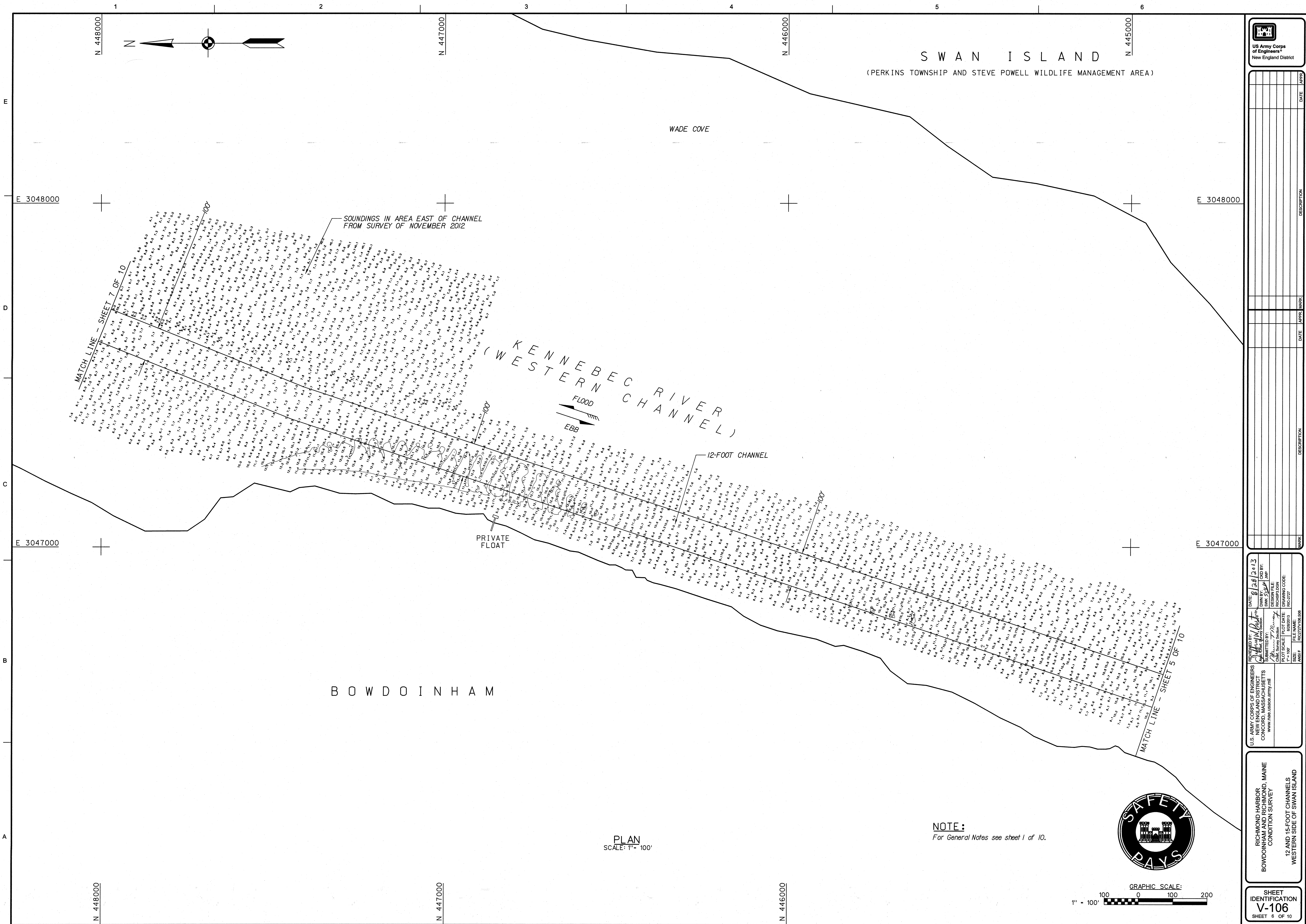

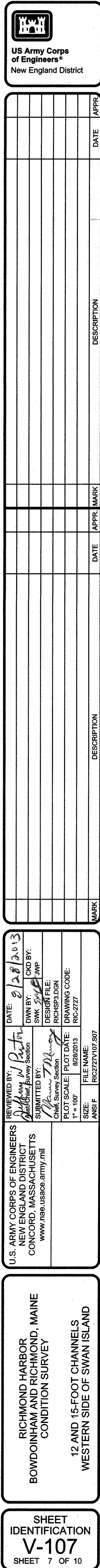

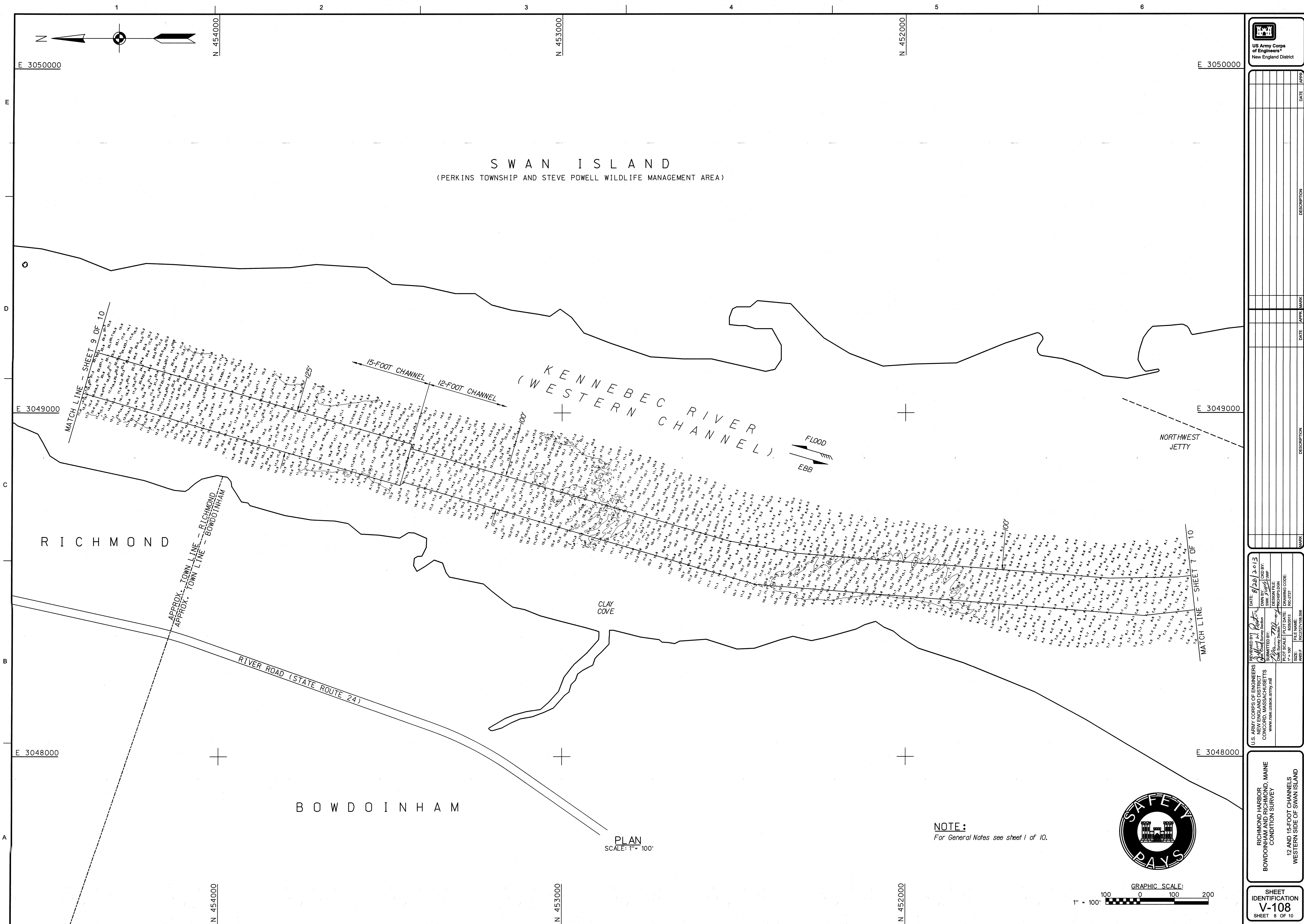

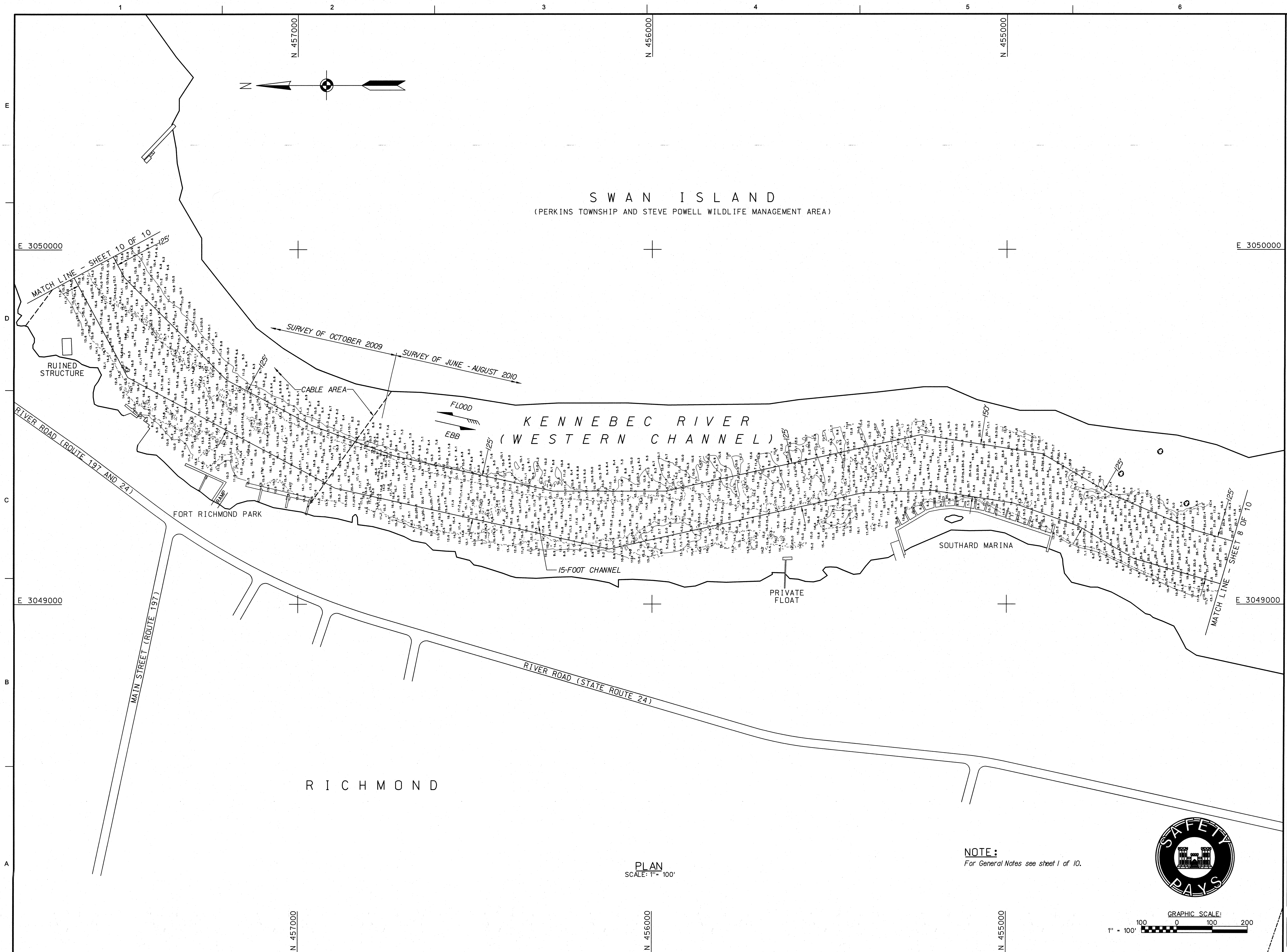

**U.S. Army Corps
of Engineers®**
New England District

[illegible]

SUBMITTED BY: *John P. Gagnier*
 Chief Survey Section
 NEW ENGLAND DISTRICT
 CONCORD, MASSACHUSETTS
 www.nbe.usace.army.mil

DWN BY: *SWM*
 SWM: *SWM*
 JWP
 CKD BY: *SWM*
 JWP

DESIGN FILE: *RICHSPL03N*
 DRAWING CODE: *RC-2777*

PLOT DATE: *8/28/2013*
 PLOT SCALE: *1" = 100'*

FILE NAME: *RC2772V03.500*
 ANSIF:

RICHMOND HARBOR
LOWDOINHAM AND RICHMOND, MAINE
CONDITION SURVEY

12 AND 15-FOOT CHANNELS
WESTERN SIDE OF SWAN ISLAND

SHEET
IDENTIFICATION
V-109
SHEET 9 OF 10

