

NORWALK HARBOR
NORWALK, CONNECTICUT
6, 10 & 12-FOOT CHANNELS
6 AND 10-FOOT ANCHORAGES
CT-SPCS NAD 1983 ZONE 0600

BRIDGE CLEARANCES FROM MHW
OBTAINED FROM NOAA CHART 12368 NTM Ed. 27.73 Dated Jan. 08
WASHINGTON STREET BRIDGE (BASCULE)
HOR CL 100 FT
VERT CL 8 FT

RAILROAD BRIDGE (SWING)
HOR CL 55 FT, EAST DRAW
HOR CL 58 FT, WEST DRAW
VERT CL 16 FT

CONNECTICUT TURNPIKE (I-95) BRIDGE (FIXED)
HOR CL 100 FT
VERT CL 60 FT

No.	Active Depth / Feature	Authorized Project Dimensions						
		Widths		Length		Depth	Area	Perimeter
		Feet	Feet	Miles	Nm	Feet	Sq Ft	
1.	12-Foot Entrance Channel	200		10.091	1.91	1.66	12,205,418	20,601
2.	12-Foot Channel	150, 250		5.321	1.01	0.88	996,342	11,008
3.	10-Foot Channel	100 to 200		7.558	1.43	1.25	1,062,594	15,337
4.	10-Foot Turning Basin						28,914	0.66
5.	10-Foot Anchorage						773,162	17.75
6.	6-Foot Channel	100 to 150		1.849	0.35	0.30	222,395	3,982
7.	6-Foot Anchorage						418,678	9.61

#	EASTING	NORTHING
1	815616.02	582489.38
2	820789.72	589853.72
3	820702.39	591040.52
4	820502.93	591025.85
5	820558.98	590264.20
6	820427.55	589686.12
7	815452.37	582604.35
8	819968.14	593207.65
9	817561.65	596312.13
10	816893.14	597317.78
11	816844.83	597390.44
12	816758.50	597920.11
13	816691.94	598194.51
14	816583.50	598483.42
15	816529.37	598774.10
16	816574.82	599005.01
17	816668.81	599154.25
18	817221.24	599707.17
19	817898.45	599946.06
20	818043.40	600048.02
21	818127.71	600246.01
22	818015.21	600530.44
23	817970.21	600676.44
24	817922.55	600817.54
25	817854.49	601039.87
26	817711.10	601303.38
27	817722.03	601531.43
28	817799.86	601751.39
29	818258.00	602346.91
30	818348.00	602602.01
31	818371.92	603004.09
32	818342.69	603122.16
33	818100.52	603663.07
34	817996.69	603822.19
35	817940.71	604004.26
36	817899.54	604235.63
37	817788.13	604201.76
38	817949.53	603841.23
39	817950.50	603753.40
40	818190.07	603218.32
41	818225.82	603074.05
42	818210.27	602812.78
43	817973.16	602140.65
44	817576.34	601624.85
45	817556.95	601220.53
46	817796.68	600779.95
47	817874.59	600647.16
48	817919.59	600501.16
49	817925.78	600282.28
50	817851.99	600109.00
51	817642.95	599961.97
52	817002.83	599736.16
53	816611.10	599344.09
54	816433.03	599061.35
55	816389.72	598841.28
56	816508.17	598205.09
57	816628.84	597744.34
58	816724.37	597507.90
59	816738.04	597424.01
60	816718.83	597234.39
61	816746.39	597086.94
62	817444.82	596036.29
63	817956.92	595557.38
64	819480.97	593591.28
65	819770.07	593065.51
66	819370.56	594665.54
67	819294.23	594827.85
68	819097.86	595079.58
69	818363.48	595452.42
70	818056.08	595674.29
71	819679.86	595563.94
72	819706.92	595778.87
73	819615.72	596233.78
74	819385.60	596492.66
75	819310.86	596426.22
76	819523.00	596187.58
77	819574.71	595929.60
78	819517.74	595477.02
79	819250.77	596644.34
80	819110.28	597001.79
81	818986.30	597389.73
82	818930.76	597372.11
83	818884.73	597426.16
84	818814.53	597441.11
85	818786.54	597137.94
86	818859.11	596551.62

SOUTH NORWALK

HOYT ISLAND

MANRESA ISLAND

KEYSER POINT

CEDAR HAMMOCK

TAVERN ISLAND

NORWALK HARBOR

LONG BEACH BEACON

LONG BEACH

WHITE ROCK BEACON

ROGERS REEF

WHITE ROCK

NORWALK HARBOR, CONNECTICUT

Condition of Improvement as of April 2008

LOCATION: Norwalk Harbor is located at the mouth of the Norwalk River on the north shore of Long Island Sound, about 8 miles east of Stamford and 13 miles west of Bridgeport.

AUTHORIZATION:	Date Authorized	Authority	Work Authorized
	2 March 1945	RHA - 1945	East Norwalk channel widening and anchorage.
	2 March 1919	RHA - 1919	South Norwalk and Norwalk channels and 10-foot anchorage.
	12 October 1996	RHA - 1996	Re-alignment portion of 10-foot turning basin, 6-foot channel and anchorage.
	30 July 2007	RHA - 2007	Re-alignment portion of 10-foot turning basin.

EXISTING PROJECT: The project provides for a 12-foot channel, 200 feet wide, from Outer Harbor to Gregory Point, thence, 150 feet wide, from Gregory Point to South Norwalk and then 250 feet wide along the wharves to Washington Street Bridge, a length of about 3.2 miles. Thence, a 10-foot channel, generally 100 feet wide, from the Washington Street Bridge into a 10-foot turning basin (0.7 acre), at the head of navigation at Norwalk, a length of about 1.5 miles; a 10-foot anchorage basin, 17.8 acres in area, opposite Fitch Point and adjacent to the 12-foot channel; a 6-foot channel, 100 to 150 feet wide, along the east side of the harbor to the head of the harbor at East Norwalk, a length of about 0.35 mile; and a 6-foot anchorage basin, 9.6 acres in area, adjacent to the upper portion of the East Norwalk Channel.

TOPOGRAPHY: All topography, including shoreline, bridges, piers, etc., is an approximate location unless otherwise noted on this sheet, and should be used as a general reference only.

DATUM PLANE: Mean Lower Low Water (MLLW) information obtained from NOAA National Ocean Surveys (NOS) Publication No. 8468448, coordinates are based on the Lambert Grid System for the State of Connecticut (Zone 0600) and NAD 1983.

PLAN
SCALE: 1" = 400'

PLAN
SCALE: 1" = 400'

PLAN
SCALE: 1" = 400'

GRAPHIC SCALE:
1" = 400'

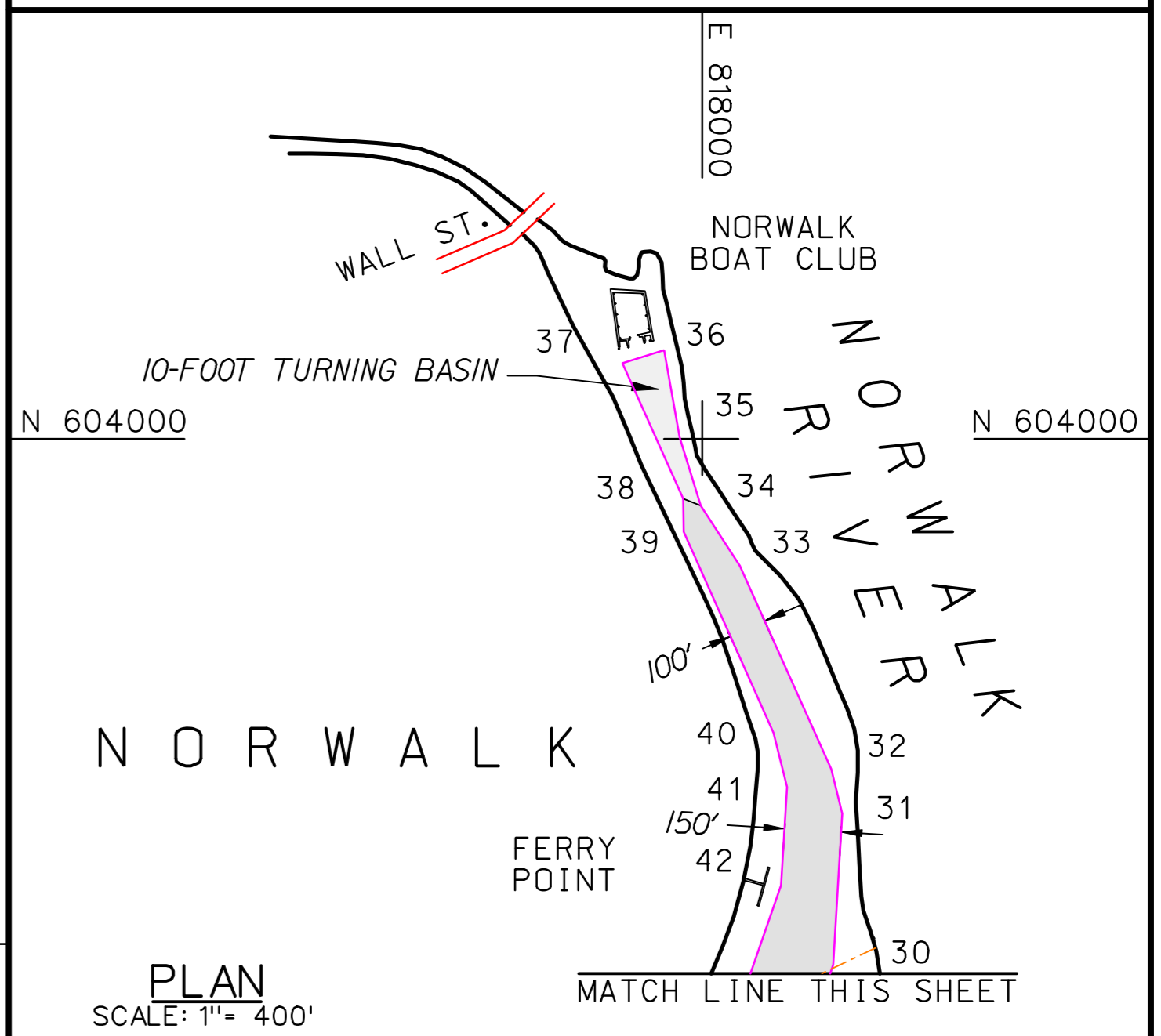
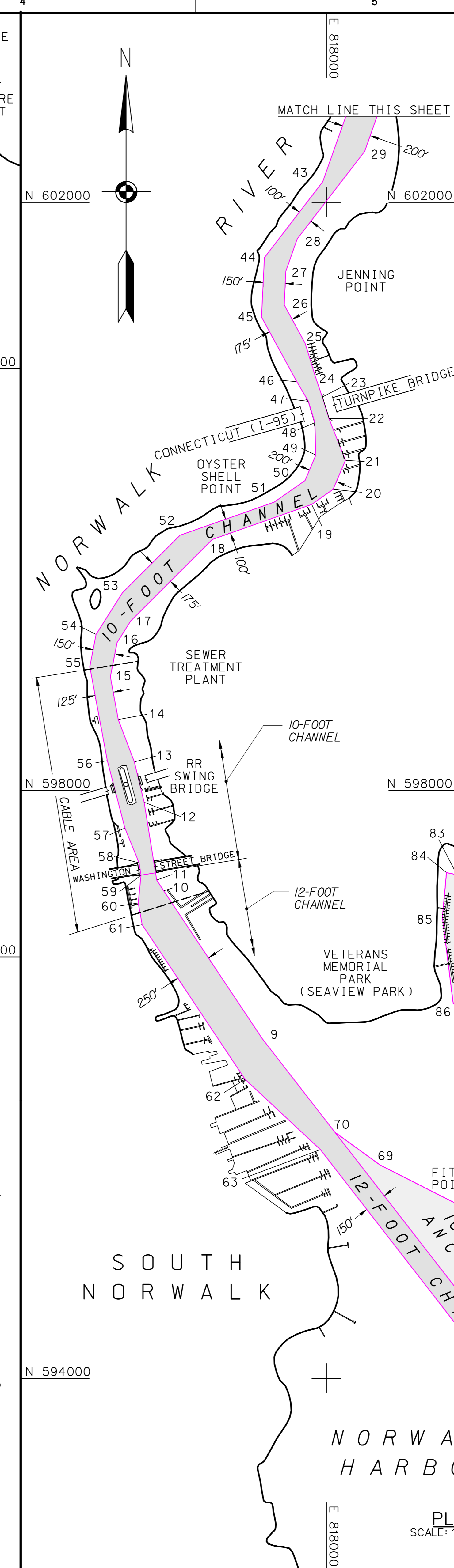
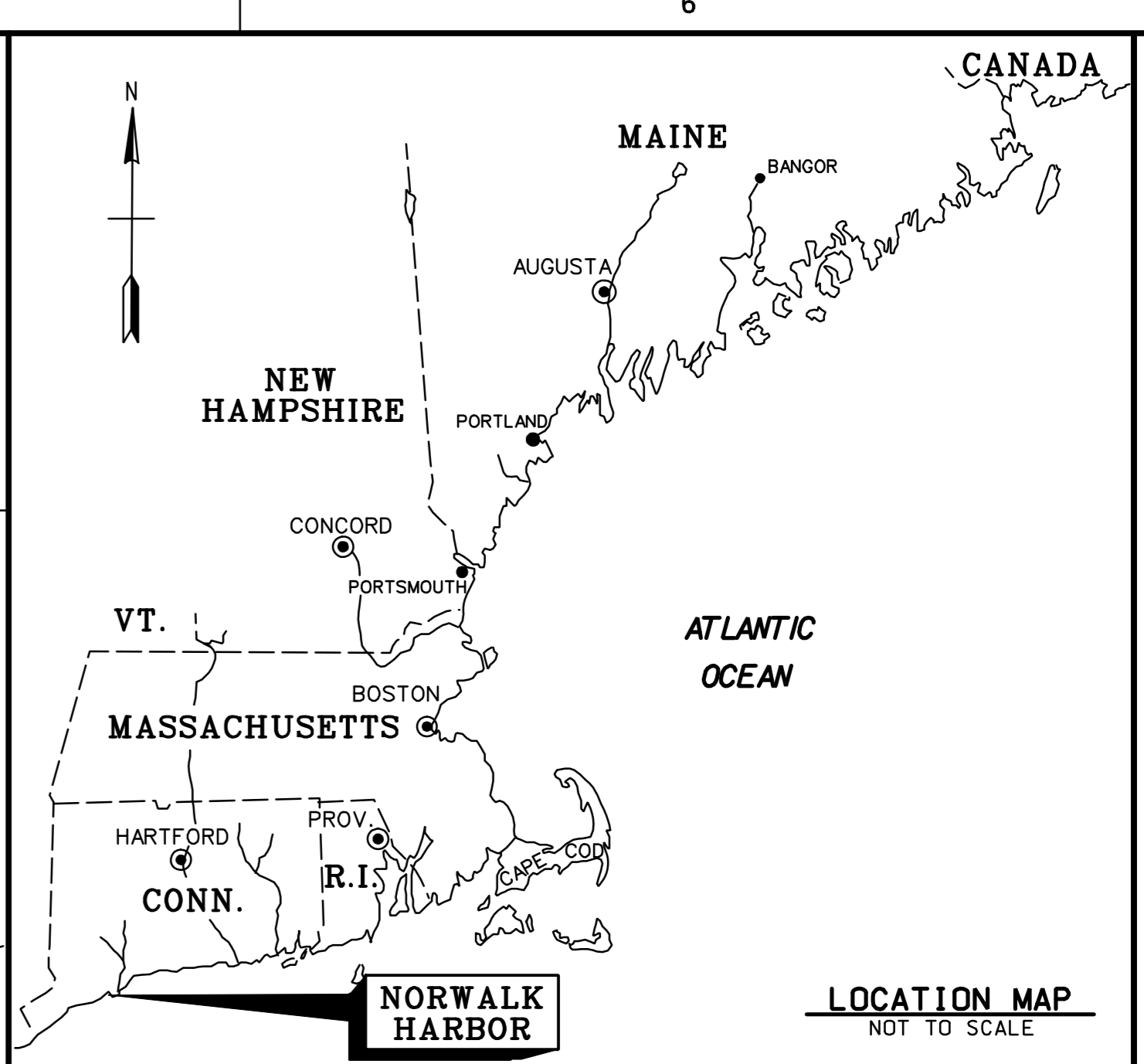

US Army Corps of Engineers
New England District

DATE	6/15/2008	DESIGN FILE	NWHSP3.DGN
REVIEWED BY	Chief, State Ocean	DESIGN FILE	NWHSP3.DGN
CONCURRED BY	Chief, Navigation Section	SCALE	1" = 400'
FILE NAME	NWHSP3.DGN	FILE NAME	NWHSP3.DGN

NORWALK HARBOR
NORWALK, CONNECTICUT
MASTER LAYOUT PLAN
6, 10 AND 12-FOOT CHANNELS
6 AND 10-FOOT ANCHORAGES
10-FOOT TURNING BASIN

SHEET IDENTIFICATION
NWH-M1
SHEET 1 OF 1