

GENERAL NOTES:

1. Soundings are in feet and tenths. The reference plane is Mean Lower Low Water (MLLW) and is based on the 1983-2001 Tidal Epoch. Soundings noted with a (+) are above the reference plane of MLLW. Soundings without a sign are below the reference plane of MLLW and should be considered negative.
2. Topography shown is from previous surveys and/or NOAA Chart No. 1321I. All topography, including shoreline, bridges, piers, etc., is located approximately unless otherwise noted and should be used as a general reference only.
3. Bench Mark Data/Tides were recorded using RTK GPS. The MLLW to NAVD88 correction for this project is 1.77 feet. This correction is referenced from NOAA's V-Datum model in the vicinity of Niantic, Niantic River, Connecticut. NAVD88 is above MLLW; therefore the correction should be added to NAVD88 to convert to MLLW. No tide gauges were used on this project. Average range of tide is 2.6 feet.
4. Coordinates shown are based on the Lambert Grid System for the State of Connecticut (Zone 0600) NAD 83 and are based on US survey feet.
5. Survey was performed utilizing an R2 Sonic Multibeam Sonar System 2024 operating at 300 kHz. Horizontal positioning and real-time tides were obtained using a Leica 1200 RTK GPS System. The RTK base station used was Station First (2014).
6. The sounding information shown on these charts represents the SHOALEST soundings of those obtained from hydrographic surveys conducted during July 2014.
7. The sounding information depicted on these charts should NOT be used to determine volumes. Volumes are determined from more sounding information than shown. Additional sounding information is available upon request.
8. The information depicted on these charts represents the results of surveys made on the dates indicated, and can only be considered as indicating the general conditions existing at that time.
9. Field Book: R&H 3851

6-Foot depth contour: - - - - -
 8-Foot depth contour: _____
 Survey by: Robert MacGovern and crew
 Refer to Survey No. 14-1328

INDEX OF NAVIGATION AIDS			
NO.	DATE	STATE PLANE COORDINATES	GEOGRAPHIC POSITION
GC-1	07/24/14	N 677644.08 E 1156012.92	41° - 19' - 10.1"N 72° - 10' - 55.4"W
GC-3	07/24/14	N 678249.31 E 1156758.27	41° - 19' - 16.0"N 72° - 10' - 45.5"W
RN-4	07/24/14	N 678170.06 E 1156813.40	41° - 19' - 15.3"N 72° - 10' - 44.8"W
RN-6	07/24/14	N 679816.69 E 1157033.86	41° - 19' - 31.5"N 72° - 10' - 41.8"W
Bn G-7	07/24/14	N 680019.10 E 1156459.81	41° - 19' - 33.6"N 72° - 10' - 49.3"W
Bn R-8	07/24/14	N 680190.11 E 1156469.31	41° - 19' - 35.2"N 72° - 10' - 49.2"W
RN-10	07/24/14	N 680526.83 E 1155788.66	41° - 19' - 38.6"N 72° - 10' - 58.0"W
GC-11	07/24/14	N 680718.73 E 1155546.25	41° - 19' - 40.5"N 72° - 11' - 01.2"W
RN-12	07/24/14	N 680805.10 E 1155641.48	41° - 19' - 41.4"N 72° - 11' - 00.0"W
Bn G-13	07/24/14	N 681231.26 E 1155827.67	41° - 19' - 45.6"N 72° - 10' - 57.5"W
RN-14	07/24/14	N 681308.56 E 1156017.78	41° - 19' - 46.3"N 72° - 10' - 55.0"W
GC-15	07/24/14	N 681805.18 E 1156184.35	41° - 19' - 51.2"N 72° - 10' - 52.8"W
RN-16	07/24/14	N 681946.59 E 1156448.67	41° - 19' - 52.6"N 72° - 10' - 49.3"W
Bn G-17	07/24/14	N 682271.48 E 1156457.95	41° - 19' - 55.8"N 72° - 10' - 49.1"W
RN-18	07/24/14	N 682810.13 E 1156909.13	41° - 20' - 01.1"N 72° - 10' - 43.2"W

INDEX OF NAVIGATION AIDS			
NO.	DATE	STATE PLANE COORDINATES	GEOGRAPHIC POSITION
GC-19	07/24/14	N 682819.02 E 1156760.00	41° - 20' - 01.2"N 72° - 10' - 45.1"W
GC-21	07/24/14	N 683318.21 E 1156894.99	41° - 20' - 06.1"N 72° - 10' - 43.3"W
GC-21A	07/24/14	N 683432.56 E 1156148.30	41° - 20' - 07.3"N 72° - 10' - 53.1"W
RN-22	07/24/14	N 683374.48 E 1156967.32	41° - 20' - 06.7"N 72° - 10' - 42.4"W
RN-22A	07/24/14	N 683562.04 E 1156191.75	41° - 20' - 08.6"N 72° - 10' - 52.5"W
GC-23	07/24/14	N 683707.37 E 1155958.83	41° - 20' - 10.0"N 72° - 10' - 55.5"W
RN-24	07/24/14	N 683678.95 E 1156074.61	41° - 20' - 09.7"N 72° - 10' - 54.0"W
GC-25	07/24/14	N 683835.13 E 1155809.30	41° - 20' - 11.3"N 72° - 10' - 57.5"W
RN-26	07/24/14	N 684083.35 E 1155939.86	41° - 20' - 13.7"N 72° - 10' - 55.8"W
Bn G-1	07/24/14	N 684528.22 E 1155808.23	41° - 20' - 18.1"N 72° - 10' - 57.4"W
Bn G&R SC	07/24/14	N 684590.39 E 1155801.07	41° - 20' - 18.8"N 72° - 10' - 57.5"W
Bn R-28	07/24/14	N 684951.92 E 1155765.35	41° - 20' - 22.3"N 72° - 10' - 58.0"W
GC-29	07/24/14	N 685302.39 E 1155491.67	41° - 20' - 25.8"N 72° - 11' - 01.5"W
RN-30	07/24/14	N 685377.89 E 1155636.94	41° - 20' - 26.5"N 72° - 10' - 59.6"W

PLAN
SCALE: 1" = 100'

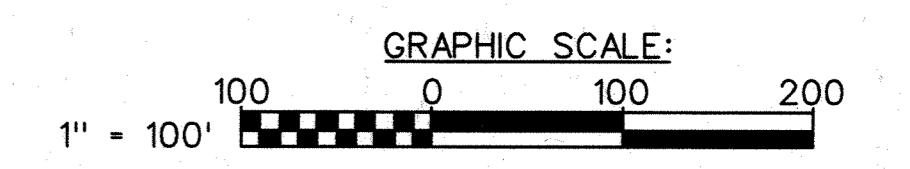

US Army Corps of Engineers
New England District

NO.	DATE	DESCRIPTION

DATE: 9/11/2014
 DRAWN BY: [Signature]
 CHECKED BY: [Signature]
 DESIGN FILE: [Blank]
 NAME: V-101
 FILE NAME: [Blank]
 SIZE: [Blank]
 AMBIT: [Blank]

U.S. ARMY CORPS OF ENGINEERS
NEW ENGLAND DISTRICT
CONCORD, MASSACHUSETTS
www.nhe.usace.army.mil

NIANTIC BAY AND HARBOR
EAST LYME AND WATERBURY, CONNECTICUT
CONDITION SURVEY

6 AND 8-FOOT CHANNELS

SHEET IDENTIFICATION
V-101
SHEET 1 OF 3

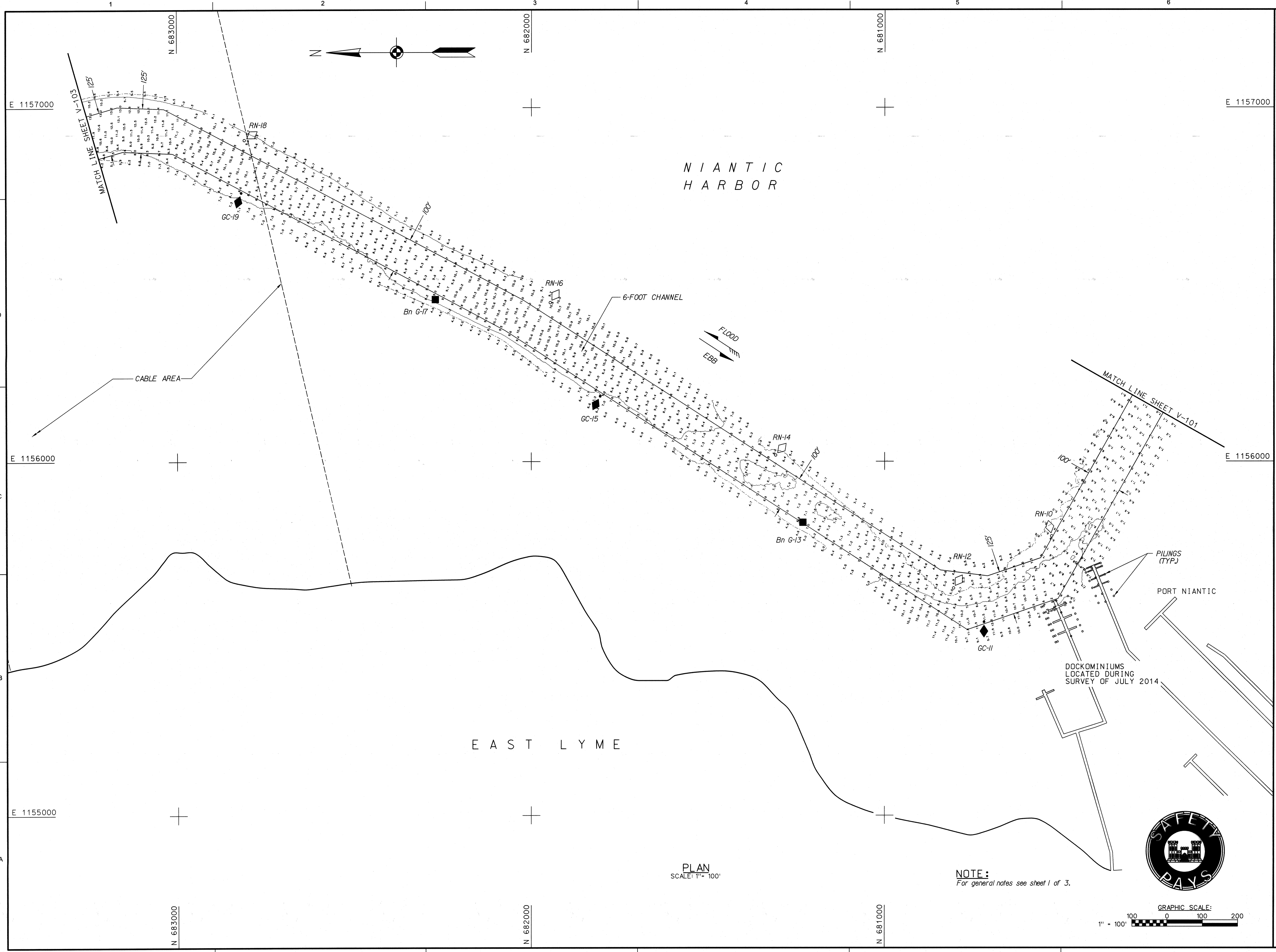

PLAN
SCALE: 1" = 100'

NOTE:
For general notes see sheet 1 of 3.

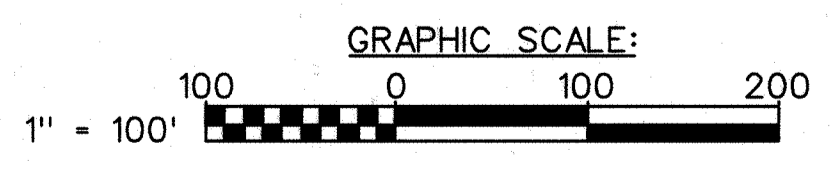

US Army Corps of Engineers
New England District

DESCRIPTION	DATE	APPROVAL MARK

REVIEWED BY: <i>[Signature]</i> DATE: 9/19/2014	DESIGN FILE: <i>[Signature]</i> FILE NAME: <i>[Signature]</i>	DATE: 9/19/2014 DRAWN BY: <i>[Signature]</i> CHECKED BY: <i>[Signature]</i> PROJECT: NIANTIC HARBOR AND WATERWAY PROJECT NUMBER: 6 AND 8-FOOT CHANNELS PROJECT LOCATION: NIANTIC HARBOR AND WATERWAY PROJECT DESCRIPTION: CONDITION SURVEY PROJECT SCALE: 1" = 100' PROJECT DATE: 9/19/2014 PROJECT FILE NAME: NIANTIC_HARBOR_V-102.dwg PROJECT SIZE: 1000x1000 PROJECT ANSF: 1000x1000
--	--	--

U.S. ARMY CORPS OF ENGINEERS
 NEW ENGLAND DISTRICT
 CONCORD, MASSACHUSETTS
 www.usace.army.mil

NIANTIC HARBOR AND WATERWAY EAST LYME AND WATERWAY, CONNECTICUT CONDITION SURVEY	6 AND 8-FOOT CHANNELS
--	-----------------------

SHEET IDENTIFICATION V-102 SHEET 2 OF 3
--

1 2 3 4 5 6
 N 686000 N 685000 N 684000 N 683000

E 1157000

E 1157000

E 1156000

E 1156000

E 1155000

A EAST LYME

N I A N T I C H A R B O R

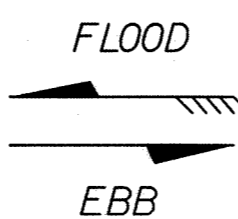
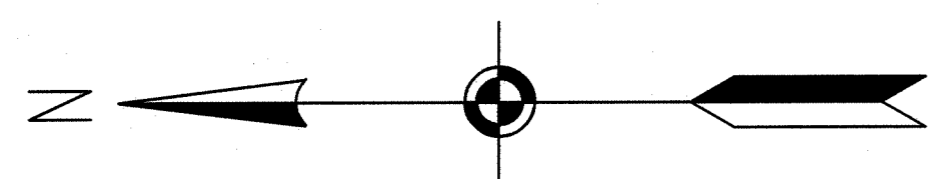

PIPE

MATCH LINE SHEET V-102

RN-22

GC-21

100'

RN-22A

RN-24

GC-21A

CABLE AREA

E 1156000

6-FOOT CHANNEL

Bn R-28

RN-26

RN-30

Bn G-1
 G&R-SC

GC-25

GC-23

GC-29

SAUNDERS POINT

PINE GROVE

SMITH COVE

NOTE:
 For general notes see sheet 1 of 3.

PLAN
 SCALE: 1" = 100'

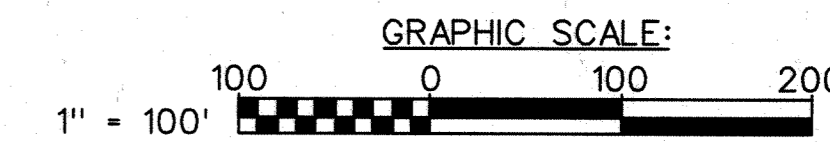

N 686000

N 685000

N 684000

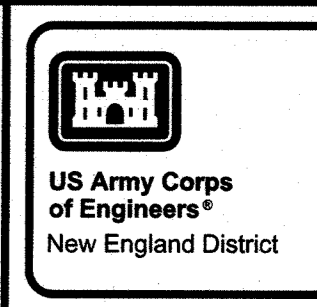

US Army Corps of Engineers
 New England District

MARK	DESCRIPTION	DATE	APPROVED

DATE	9/19/2014
DRAWN BY	
DESIGNED BY	
DESIGN FILE	
INVESTIGATOR	
FILE NAME	
SIZE	
ANSI	

U.S. ARMY CORPS OF ENGINEERS
 NEW ENGLAND DISTRICT
 CONCORD, MASSACHUSETTS
 www.usace.army.mil

SHEET IDENTIFICATION
 V-103
 SHEET 3 OF 3