



PUBLIC NOTICE

**US Army Corps
of Engineers**®
New England District
696 Virginia Road
Concord, MA 01742-2751

Comment Period Begins: August 29, 2017
Comment Period Ends: September 28, 2017
File Number: NAE-2004-02293
In Reply Refer To: Greg Penta
Phone: (978) 318-8862
E-mail: gregory.r.penta@usace.army.mil

The District Engineer has received a permit application to conduct work in waters of the United States from Patrick Brennan, Commodore, Marshfield Yacht Club, located at 11 Ridge Road, Marshfield, Massachusetts. Dredge work is proposed in the South River at 11 Ridge Road, Marshfield, Massachusetts, and disposal of the dredged material is proposed at Rexhame Beach at 325 Standish Street, Marshfield, Massachusetts.

The work involves adding two 3-foot x 35-foot finger floats for dinghies at the beginning of C Dock; and maintenance and improvement dredging of approximately 8,800 cubic yards from a 68,040 square foot (SF) area. The work in Area 1 involves dredging 5,800 cubic yards (CY) from a 44,260 SF area. This area was previously dredged to -4 mean low water (MLW) and would be dredged to -5 MLW. The work in Area 2 involves dredging 958 CY from a 7,930 SF area. This area was previously dredged to -5 MLW and would again be dredged to -5 MLW. The work in Area 3 involves dredging 2042 CY from a 15,850 SF area. This area was previously dredged to -4 MLW and would be dredged to -5 MLW. A total of 7,300 cubic yards of well-sorted sand from these three areas would be hydraulically dredged and disposed of landward of the high tide line in a 160,000 SF area on Rexhame Beach, located at 325 Standish Street in the Rexhame Section of Marshfield. The remaining 1,500 cubic yards of dredged material from a 15,400 SF area known as "Area Z", which is within Area A, has been determined by the Massachusetts Department of Environmental Protection as unsuitable for beach nourishment. This material will be disposed of at an upland location, which is currently intended to be the Town of Marshfield's disposal site off of Joseph Driebeck Way.

The work is shown on the enclosed plans titled, "Plan accompanying petition of Marshfield Yacht Club, Inc. to dredge the club's boat basin and reuse the dredged material as beach nourishment at Rexhame Beach and to construct and maintain additional finger floats in the South River, Marshfield", on five sheets, and dated "June 2016". Sheet 3 of 5 was revised on "7/13/17" to show "Area Z".

Permits are required pursuant to:

- Section 10 of the Rivers and Harbors Act of 1899
 Section 404 of the Clean Water Act
 Section 103 of the Marine Protection, Research and Sanctuaries Act.

The decision whether to issue a permit will be based on an evaluation of the probable impact of the proposed activity on the public interest. That decision will reflect the national concern for both protection and utilization of important resources. The benefit which may reasonably accrue from the proposal must be balanced against its reasonably foreseeable detriments. All factors which may be relevant to the proposal will be considered, including the cumulative effects thereof; among those are: conservation, economics, aesthetics, general environmental concerns, wetlands, cultural value, fish and wildlife values, flood hazards, flood plain value, land

We are coordinating with the NMFS and/or U.S. Fish and Wildlife Service on endangered species under their jurisdiction and the ESA consultation will be concluded prior to the final decision.

COASTAL ZONE MANAGEMENT

The states of Connecticut, Maine, Massachusetts, New Hampshire and Rhode Island have approved Coastal Zone Management Programs. Where applicable, the applicant states that any proposed activity will comply with and will be conducted in a manner that is consistent with the approved Coastal Zone Management Program. By this Public Notice, we are requesting the State concurrence or objection to the applicant's consistency statement.

The following authorizations have been applied for, or have been, or will be obtained:

- (x) Permit, license or assent from state.
- (x) Permit from local wetland agency or conservation commission.
- (x) Water Quality Certification in accordance with Section 401 of the Clean Water Act.

COMMENTS

In order to properly evaluate the proposal, we are seeking public comment. Anyone wishing to comment is encouraged to do so. Comments should be submitted in writing by the above date. If you have any questions, please contact Greg Penta at (978) 318-8862, (800) 343-4789 or (800) 362-4367, if calling from within Massachusetts.

Any person may request, in writing, within the comment period specified in this notice, that a public hearing be held to consider the application. Requests for a public hearing shall specifically state the reasons for holding a public hearing. The Corps holds public hearings for the purpose of obtaining public comments when that is the best means for understanding a wide variety of concerns from a diverse segment of the public.

The initial determinations made herein will be reviewed in light of facts submitted in response to this notice. All comments will be considered a matter of public record. Copies of letters of objection will be forwarded to the applicant who will normally be requested to contact objectors directly in an effort to reach an understanding.

THIS NOTICE IS NOT AN AUTHORIZATION TO DO ANY WORK.



Barbara Newman
Chief, Permits and Enforcement Branch
Regulatory Division

If you would prefer not to continue receiving Public Notices by email, please contact Ms. Tina Chaisson at (978) 318-8058 or e-mail her at bettina.m.chaisson@usace.army.mil. You may also check here () and return this portion of the Public Notice to: Bettina Chaisson, Regulatory Division, U.S. Army Corps of Engineers, 696 Virginia Road, Concord, MA 01742-2751.

NAME: _____
ADDRESS: _____
PHONE: _____

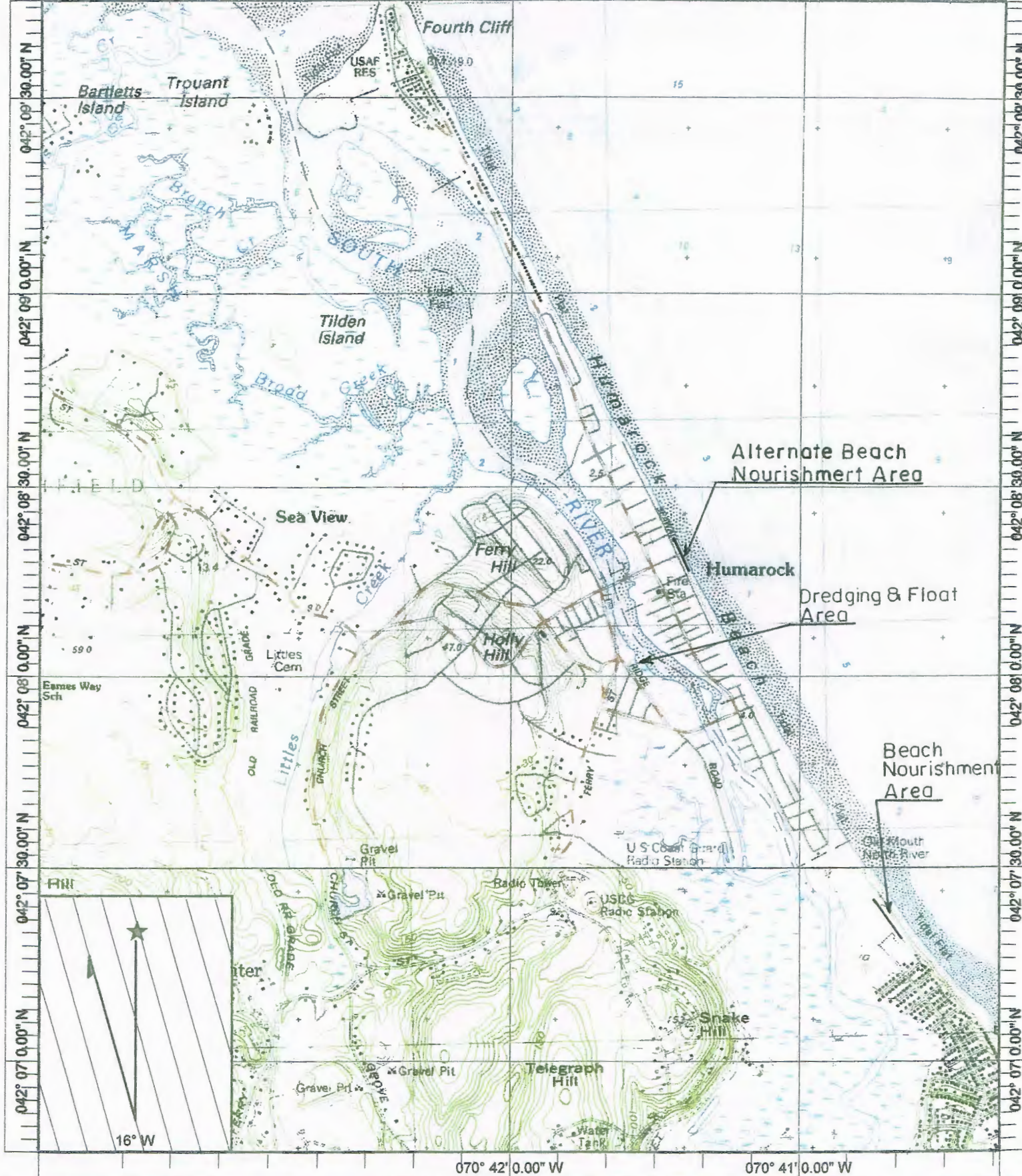

Name: SCITUATE
 Date: 11/18/2009
 Scale: 1 inch equals 2000 feet

Marshfield Yacht Club
 Dredging & Floats &
 Beach Nourishment

I certify that this plan has been prepared in accordance with the rules and regulations of the Registers of Deeds

John A. Carocefalo

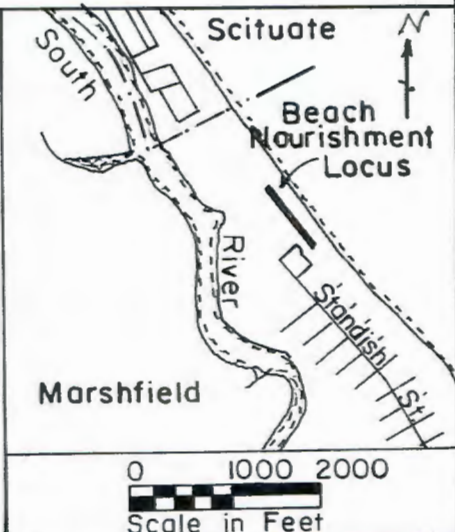
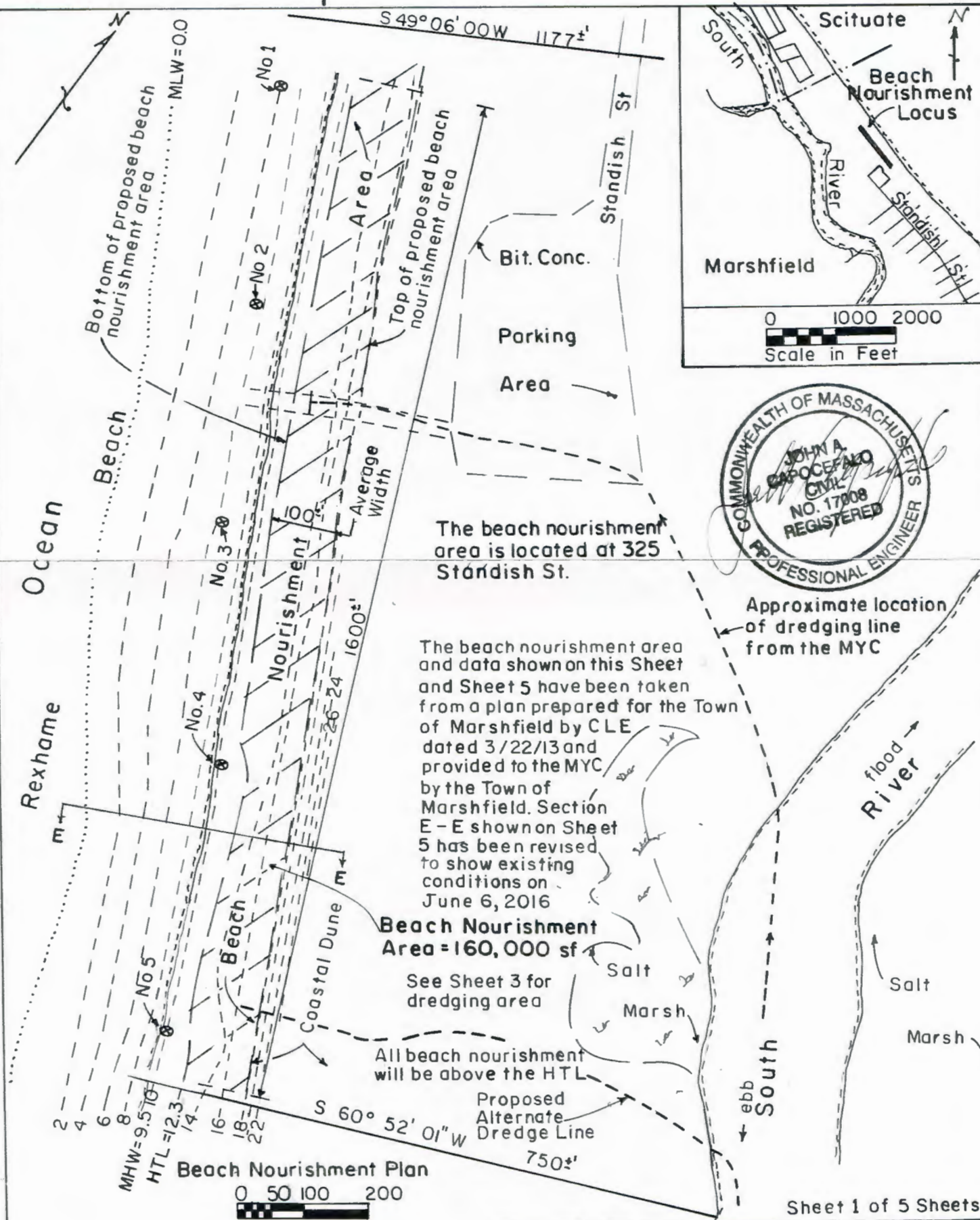

The beach nourishment area is located at 325 Standish St.

The beach nourishment area and data shown on this Sheet and Sheet 5 have been taken from a plan prepared for the Town of Marshfield by CLE dated 3/22/13 and provided to the MYC by the Town of Marshfield. Section E-E shown on Sheet 5 has been revised to show existing conditions on June 6, 2016

Beach Nourishment Area = 160,000 sf

See Sheet 3 for dredging area

All beach nourishment will be above the HTL

Proposed Alternate Dredge Line

Beach Nourishment Plan

0 50 100 200

Sheet 1 of 5 Sheets

Plan accompanying petition of Marshfield Yacht Club, Inc. to dredge the Club's boat basin and reuse the dredged material as beach nourishment at Rexhame Beach and to construct and maintain additional finger floats in the South River, Marshfield

June 2016

I certify that this plan has been prepared in accordance with the rules and regulations of the Registers of Deeds

John A. Capozefalo

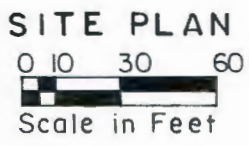
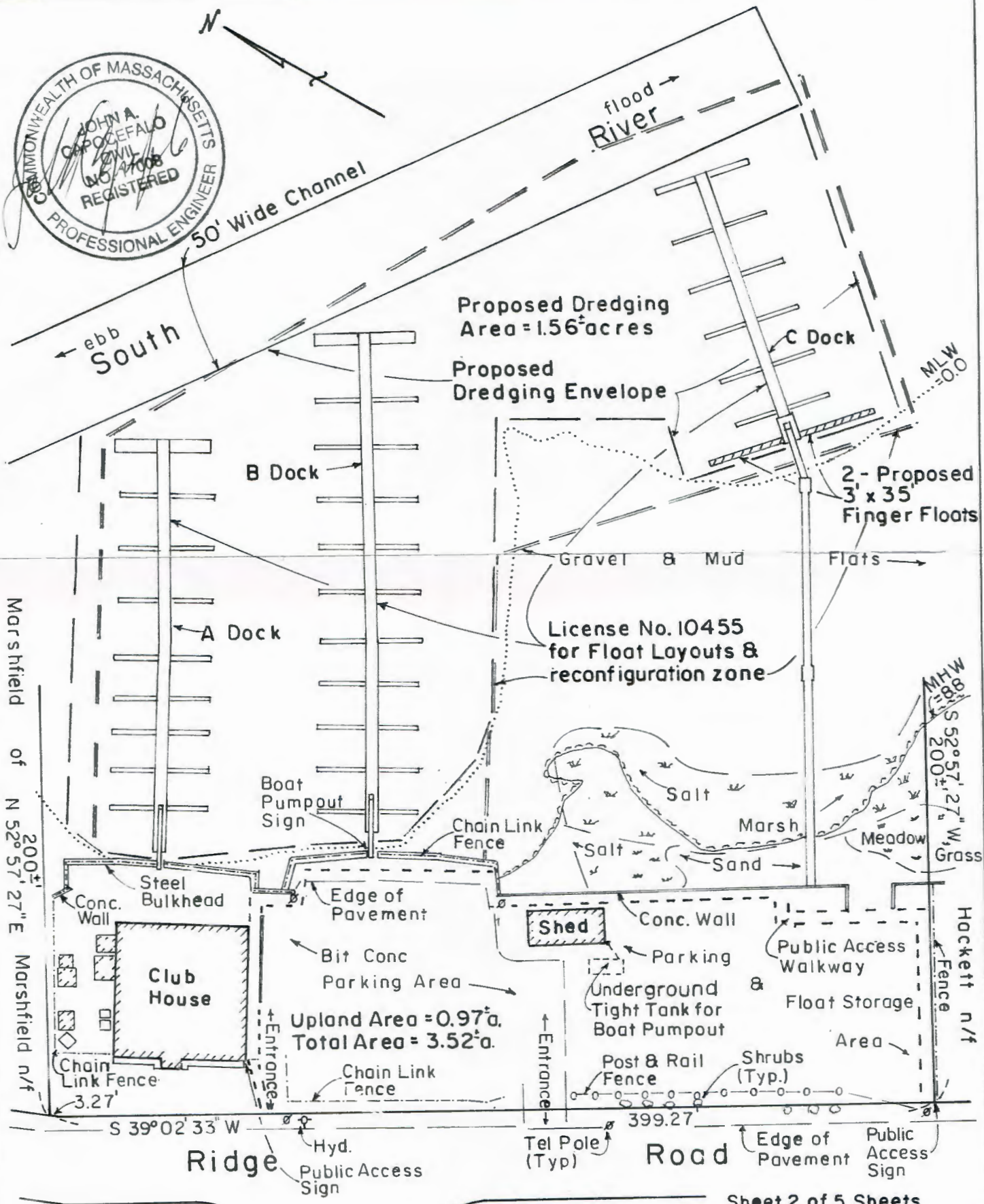
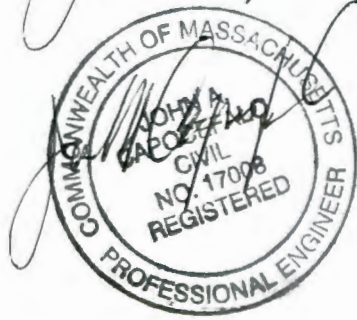

See Sheet for Dredging Soundings

I certify that this plan has been prepared in accordance with the rules and regulations of the Registers of Deeds

John A. Capicello

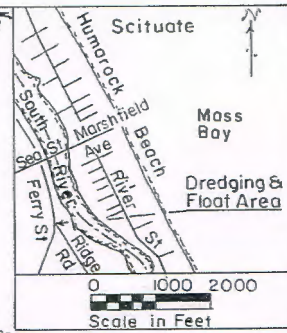
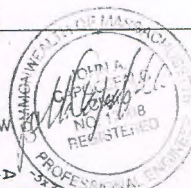
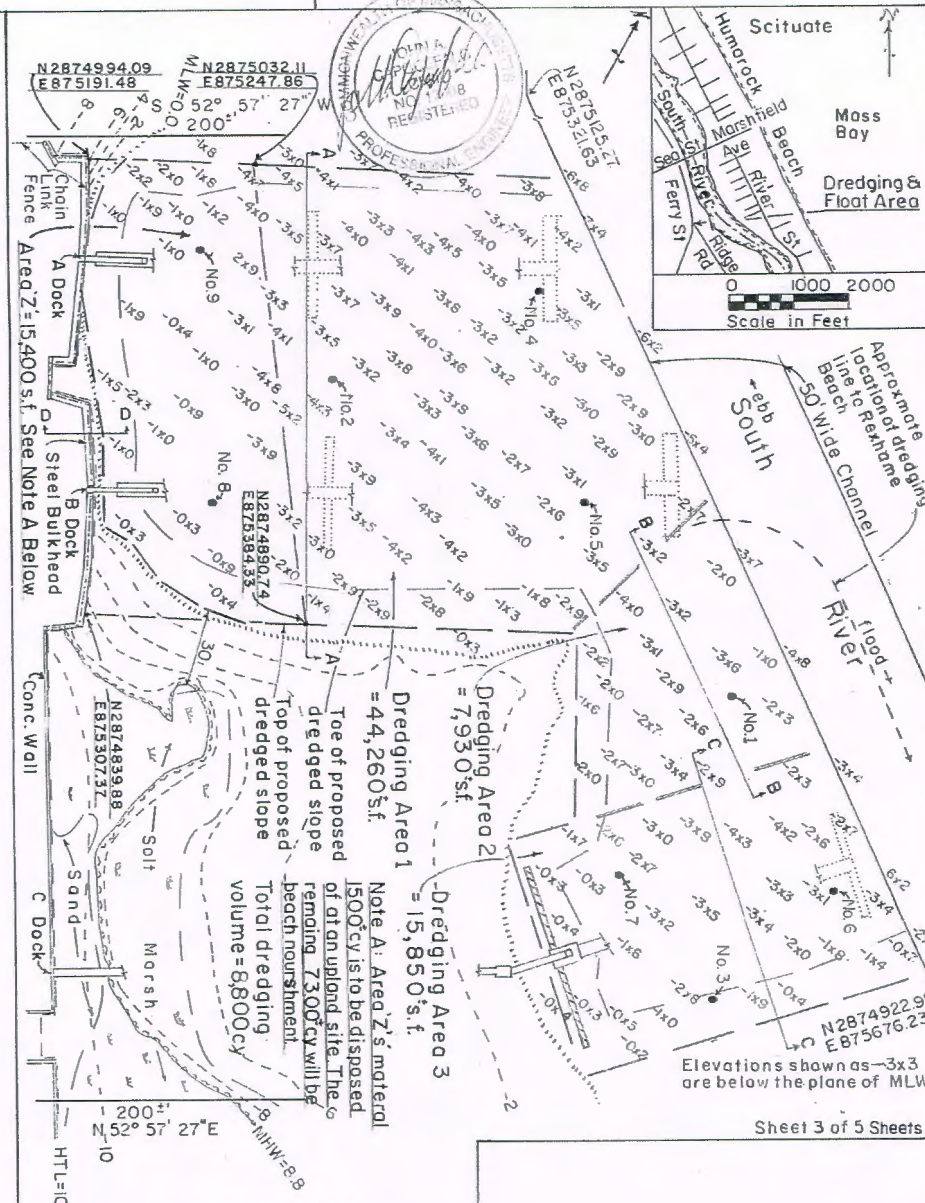
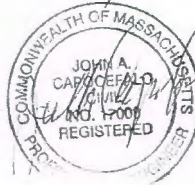

N2874994.09
E875191.48

N2875032.11
E875247.86

Area Z = 15,400 s.f. See Note A Below

N2874839.88
E875307.37

N2874890.74
E875384.33

N2874922.98
E875676.25

SOUNDINGS PLAN
0 50 100 150 200
Scale in Feet

Rev. 7/13/17

Elevations shown as -3x3 are below the plane of MLW

Sheet 3 of 5 Sheets

I certify that this plan has been prepared in accordance with the rules and regulations of the Registers of Deeds

John A. Capoccealo

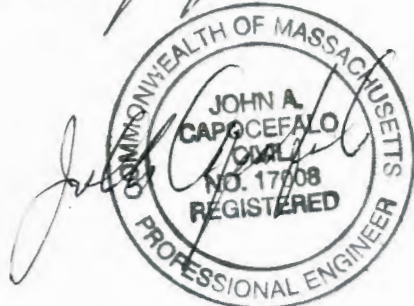

Dredging Sub-section 3

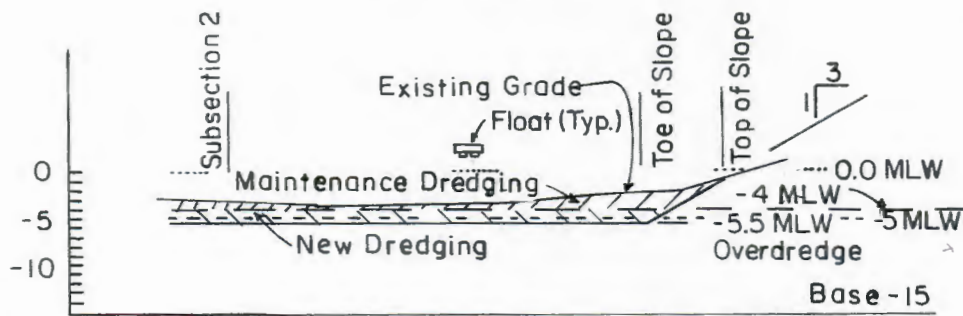

New Dredging
= 880 cy from -4 to -5.5 MLW

Maintenance Dredging
= 1,162 cy to -4 MLW



SECTION C-C

Dredging Sub-section 2

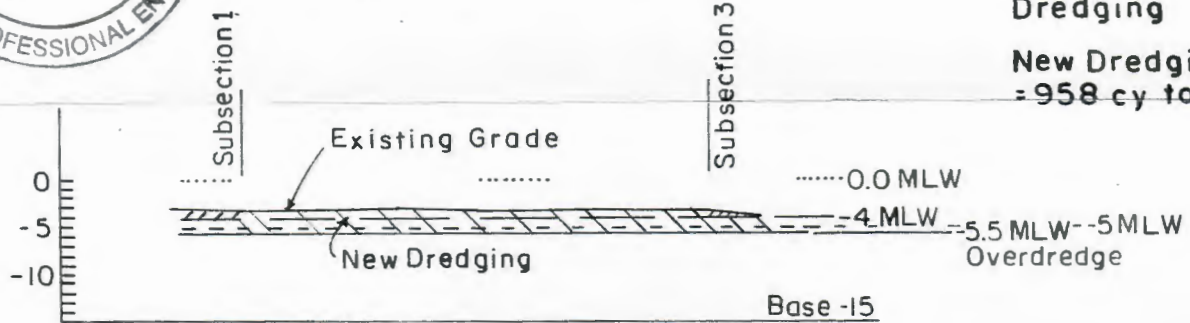

No Maintenance Dredging

New Dredging
= 958 cy to -5.5 MLW

SECTION B-B

Dredging Sub-section 1

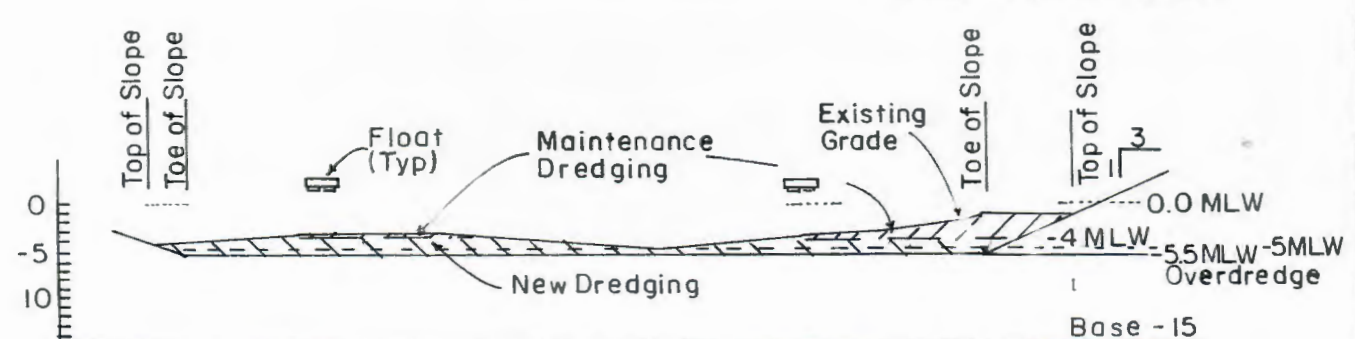

Maintenance Dredging
= 3,174 cy from -4 MLW

New Dredging = 2,626 cy from -4 to -5.5 MLW

SECTION A-A

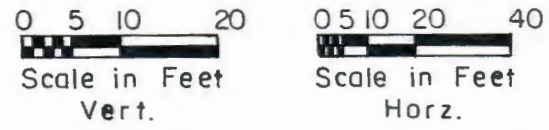

I certify that this plan has been prepared in accordance with the rules and regulations of the Registers of Deeds

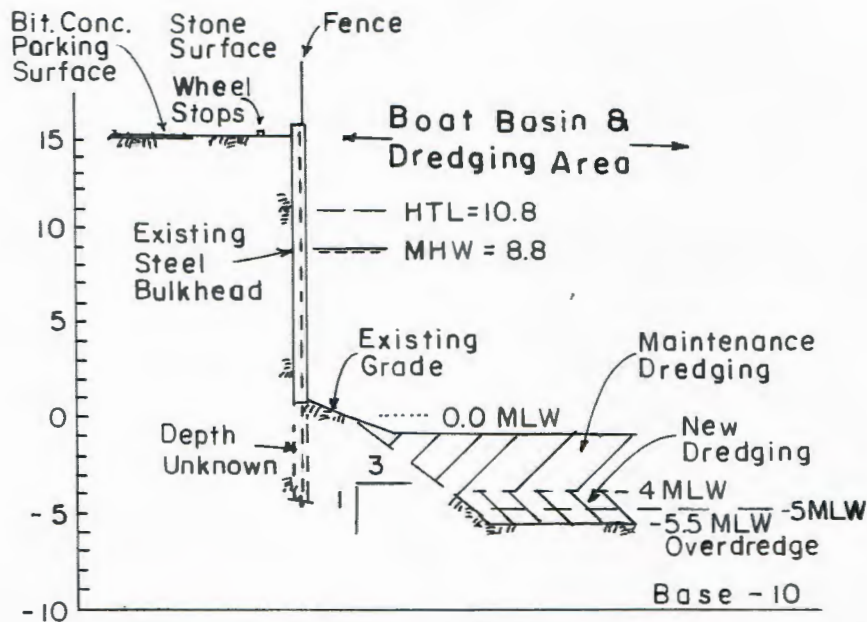
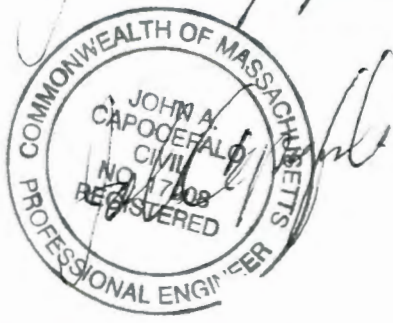

SECTION D-D

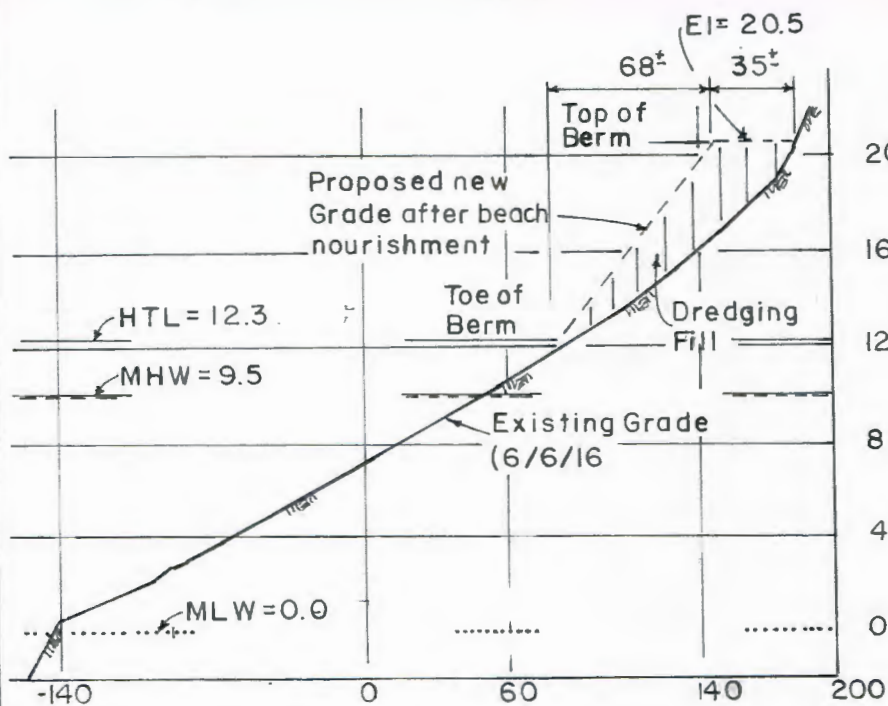
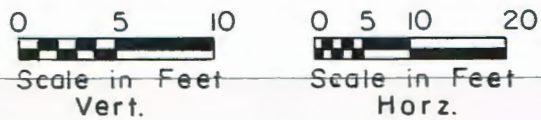

SECTION E-E

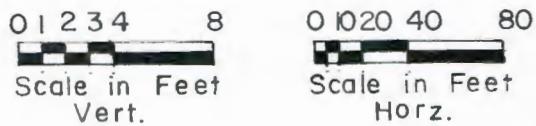

Previous dredging and float were approved under DEP License Nos. 313, 2945 & 11716, DEP, WQC No. 90-0588 and Administrative Consent Order BRP WP 07 W041112 and USAC of E 76-516, NAE 90-10820, 94-02755 & 04-2293

Sounding shown on Sheet 3 have been taken Bathymetric Survey Plan by Steele Associates Marine Consultants, LLC, dated 4/18/14 performed for the Marshfield Yacht Club and field surveys

The property lines shown on these plans are not the results of an actual on the ground survey. The lines of ownership have been compiled from plans and deeds of record and field surveys

The Marshfield Yacht Club and the beach nourishment are in Residential R 3 Zones

Yacht Club property is shown as Lots 80 & 82 on L.C.P. 4392-14 Lot 83 on LCP 4329-14, Sheet 1 and Lots 385 & 386 on LCP 4392-46 and field with Certificates 10960, 30104, 82826 & 108441 Beach Nourishment property is shown as Lot 2 on LCP 14924 A filed with Certificate 5191

Elevations are based on MLW as determined by the bench mark set for previous dredging projects at this site