

AECOM
 in association with

BLACK & VEATCH

THE METROPOLITAN DISTRICT
 SOUTH HARTFORD CONVEYANCE AND STORAGE TUNNEL
 TUNNEL PUMP STATION FACILITIES

REFERENCE:

SCALE:

DATE:

FIGURE 5



- D PERMANENT FEDERAL AND STATE WETLAND IMPACT AREA (11,150 SF)
- Y EXISTING STATE ONLY WETLAND RESTORED AND IMPROVED TO FEDERAL QUALITY WETLAND AFTER CONSTRUCTION (21,961 SF)
- X EXISTING FEDERAL WETLAND RESTORED TO FEDERAL QUALITY WETLAND AFTER CONSTRUCTION (45,794 SF)
- Z EXISTING UPLAND AREA CONSTRUCTED TO FEDERAL QUALITY WETLAND BEFORE CONSTRUCTION (21,457 SF)
- A AREA WAS HISTORICALLY UPLAND FOREST. FEDERAL AND STATE WETLAND WAS RECENTLY CREATED WITH IMPORTED POORLY DRAINING DREDGE MATERIAL. WETLAND WITH MINIMAL FUNCTIONS AND VALUES. (9,590 SF)

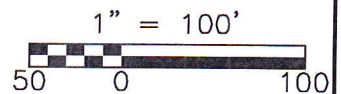

ANSI A - 5-11-06

AECOM

in association with
BLACK & VEATCH

THE METROPOLITAN DISTRICT
 SOUTH HARTFORD CONVEYANCE AND STORAGE TUNNEL
 PERMANENT IMPACTS TO FEDERAL
 WETLANDS WITH MITIGATION





REFERENCE:

SCALE:

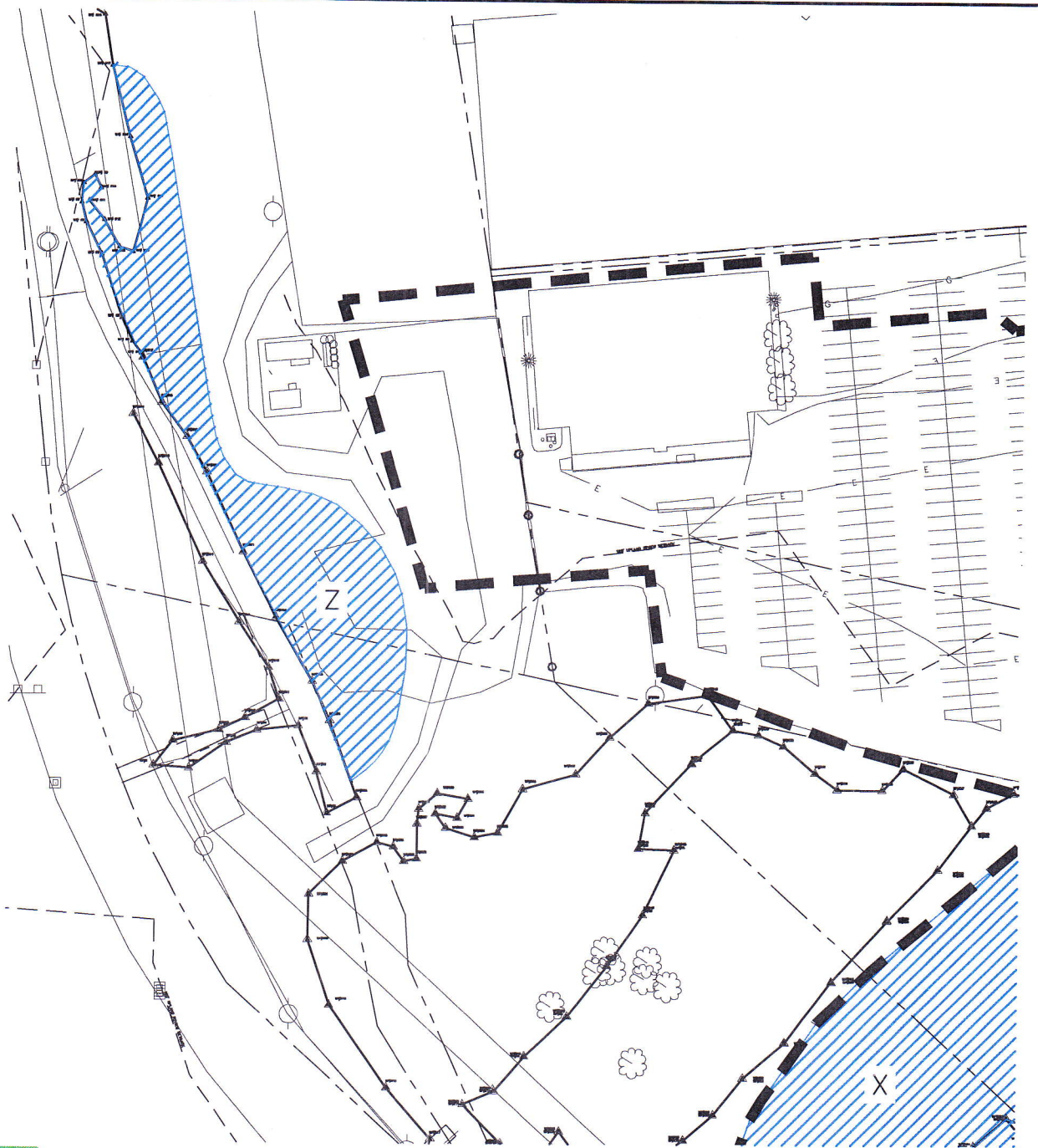
DATE:

FIGURE 6a



-  **D** PERMANENT FEDERAL AND STATE WETLAND IMPACT AREA (11,150 SF)
-  **Y** EXISTING STATE ONLY WETLAND RESTORED AND IMPROVED TO FEDERAL QUALITY WETLAND AFTER CONSTRUCTION (21,961 SF)
-  **X** EXISTING FEDERAL WETLAND RESTORED TO FEDERAL QUALITY WETLAND AFTER CONSTRUCTION (45,794 SF)
-  **Z** EXISTING UPLAND AREA CONSTRUCTED TO FEDERAL QUALITY WETLAND BEFORE CONSTRUCTION (21,457 SF)
-  **A** AREA WAS HISTORICALLY UPLAND FOREST. FEDERAL AND STATE WETLAND WAS RECENTLY CREATED WITH IMPORTED POORLY DRAINING DREDGE MATERIAL WETLAND WITH MINIMAL FUNCTIONS AND VALUES. (9,590 SF)

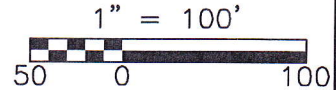

ANSI A - 5-11-06



in association with

BLACK & VEATCH

THE METROPOLITAN DISTRICT
SOUTH HARTFORD CONVEYANCE AND STORAGE TUNNEL
PERMANENT IMPACTS TO FEDERAL
WETLANDS WITH MITIGATION

REFERENCE:	SCALE:	DATE:
		FIGURE 6b

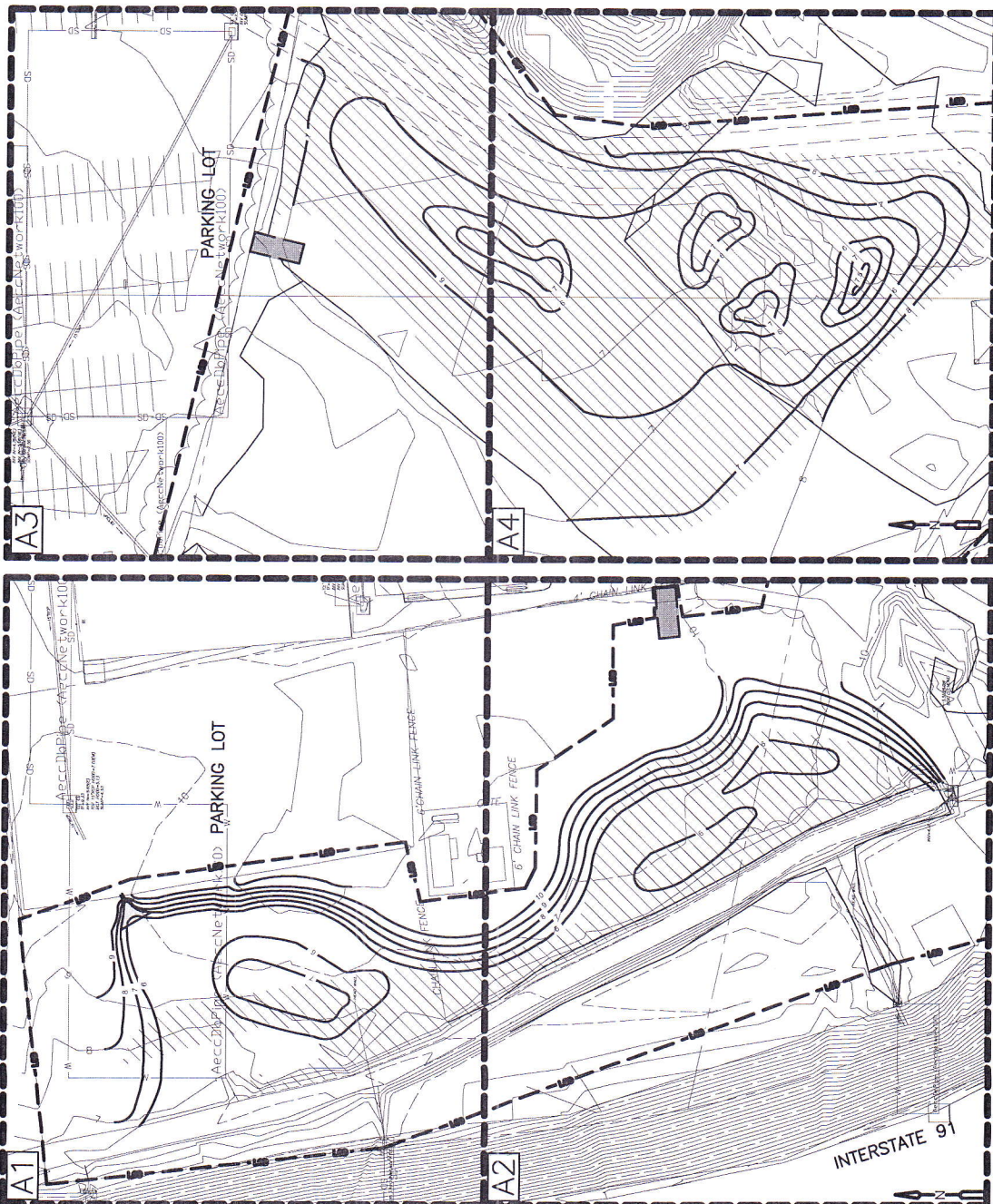

LAUNCH SHAFT - WETLAND MITIGATION - ENLARGEMENT - AREA Z - GRADING PLAN
 NOT TO SCALE

GENERAL GRADING NOTES:
 1. THE CONTRACTOR SHALL EXAMINE THE SITE CONDITIONS UNDER WHICH THE WORK IS TO BE PERFORMED AND SHALL VERIFY THE ACCURACY OF THE DATA AND THE SUFFICIENCY OF THE CONDITIONS PRIOR TO ANY CONSTRUCTION WORK.
 2. REFER TO CIVIL ENGINEERING UTILITY PLANS FOR LOCATION AND DETAILS PERTAINING TO EXISTING UTILITIES.
 3. NO GRADING SHALL BE PERFORMED OUTSIDE THE LIMITS OF CONSTRUCTION AS DEFINED BY THE CONTRACTOR'S PRESERVATION FENCE AND/OR SECURITY FENCE.
 4. EXISTING TREES SHALL BE PRESERVED AND PROTECTED TO REMAIN TO REMAIN UNLESS OTHERWISE NOTED ON THE PLANS.
 5. ALL EXISTING UTILITIES SHALL BE MAINTAINED AND OPEN TRANSITION FROM PROPOSED FINISHED GRADES TO ADJACENT EXISTING GRADES.
 6. MATERIAL FACTOR SHALL PROVIDE POSITIVE DRAINAGE AWAY FROM ALL STRUCTURES AND PLANT MATERIAL.
 7. FINISH GRADING SHALL BE APPROVED BY THE OWNER'S REPRESENTATIVE PRIOR TO INSTALLATION.
 8. SITE ACCESS LOCATIONS SHALL BE FIELD VERIFIED AND APPROVED BY THE ENGINEER PRIOR TO COMMENCEMENT OF WORK.

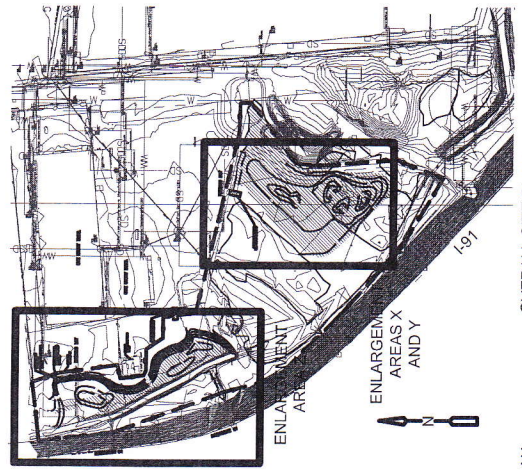
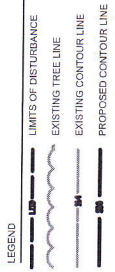

OVERALL SITE PLAN
 NOT TO SCALE

MDC
 The Metropolitan District
 555 Main Street
 Hartford, Connecticut

REV.	DATE	BY	CHKD	REMARKS

60% SUBMITTAL
 NOT FOR
 CONSTRUCTION

PROJECT NO. 20XX-C-104
 DRAWN BY: J. BILAK
 CHECKED BY: J. BILAK
 APPROVED BY: J. BILAK
 DATE: 2014

LAUNCH SHAFT - WETLAND MITIGATION
 GRADING PLANS

VERTICAL DATUM IS NAVD 83
 HORIZONTAL DATUM IS NAD 83/92
 PLAN NUMBER
 SHEET NO.
 C-104

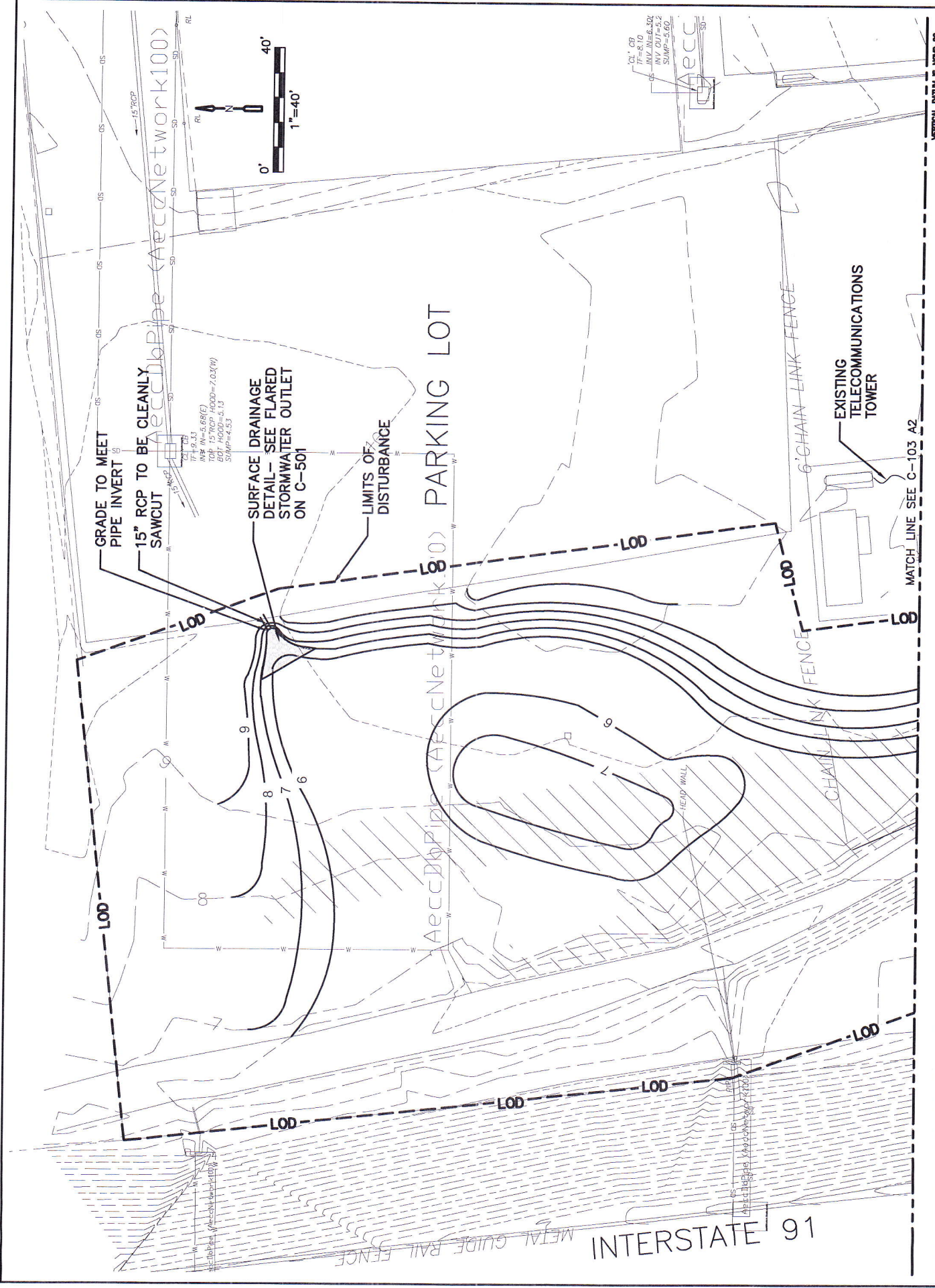

CL. CB
 TF = 5.10
 INV. 1015.00
 INV. 1016.00
 SUMP = 5.60

AeccNetwork100
 AeccNetwork100
 AeccNetwork100

M&P IN=5.68(E)
 TOP 15" RCP HOOD=7.02(W)
 SD HOOD=5.13
 SUMP=6.53

The Metropolitan District 555 Main Street Hartford, Connecticut	DATE: _____ TIME: _____ BY: _____ CHECKED: _____ APPROVED: _____	60% SUBMITTAL NOT FOR CONSTRUCTION	 AECCE CONSULTING CONTRACT NO. 20XX-XX SOUTH HARTFORD CONVEYANCE AND STORAGE TUNNEL	LAUNCH SHAFT - WETLAND MITIGATION AREA Z - GRADING PLAN	SHEET NO. C-104 A1
	PROJECT NO. 2002-C-100 DRAWN BY: J. BILALIAN CHECKED BY: J. BILALIAN DATE: 10/15/02 APPROVED BY: J. BILALIAN DATE: 10/15/02	60% SUBMITTAL NOT FOR CONSTRUCTION	AECCE CONSULTING CONTRACT NO. 20XX-XX SOUTH HARTFORD CONVEYANCE AND STORAGE TUNNEL	LAUNCH SHAFT - WETLAND MITIGATION AREA Z - GRADING PLAN	SHEET NO. C-104 A1

VERTICAL DATUM IS NAVD 83
 HORIZONTAL DATUM IS NAD 83/92

1" CONSTRUCTION
 BLACK/WHITE

60% SUBMITTAL
 NOT FOR
 CONSTRUCTION

PROJECT NO. 2002-C-100
 DRAWN BY: J. BILALIAN
 CHECKED BY: J. BILALIAN
 DATE: 10/15/02
 APPROVED BY: J. BILALIAN
 DATE: 10/15/02

AECCE CONSULTING
 CONTRACT NO. 20XX-XX
 SOUTH HARTFORD CONVEYANCE AND
 STORAGE TUNNEL

LAUNCH SHAFT - WETLAND MITIGATION
 AREA Z - GRADING PLAN

SHEET NO.
 C-104 A1