



JOINT PUBLIC NOTICE

Today's Date: May 13, 2014
Hearing Date: June 30, 2014
Comment Period Ends: July 14, 2014

Corps File Number: NAE 2013-1623
In Reply Refer To:
NH DES
Wetlands Bureau File # 2014- 01053



U.S. Department of Transportation
Federal Highway Administration



US Army Corps
of Engineers
New England District

Notice of opportunity to comment and announcement of Joint Public Hearing to be held in Portsmouth at the NH DES Pease Field Office at 222 International Drive on Monday evening June 30, 2014 at 6:00 PM.

The Maine and New Hampshire Departments of Transportation in cooperation with the Federal Highway Administration propose to dredge and / or fill approximately 1.71 acres of estuarine waters and river bottom in conjunction with the construction of a new replacement bridge across the Piscataqua River to replace the Sara Mildred Long Bridge between Portsmouth, New Hampshire and Kittery, Maine. See attached plans.

Proposed mitigation would involve an in lieu fee of approximately \$442,000 to be used for tidal restoration projects within the Piscataqua River estuary.

This is a notice of your opportunity to comment and announcement of a Joint Public Hearing to be held at the New Hampshire Department of Environmental Services, Pease Field Office at 222 International Drive, Portsmouth, NH at 6:00 PM on Monday, June 30, 2014. All those who wish to comment on the application or attend the public hearing are encouraged to do so.

The NH and Maine Departments of Transportation in cooperation with the Federal Highway Administration have requested a Corps of Engineers (COE) permit under Section 404 of the Clean Water Act to dredge and or fill within approximately 1.71 acres of wetlands and waters within the Piscataqua River watershed, in conjunction with the construction of new bridge to replace the Sara Mildred Long Bridge between Portsmouth, New Hampshire and Kittery, Maine. The Departments of Transportation have also applied for a New Hampshire, Department of Environmental Services, Wetlands Bureau (NHDES) Dredge and Fill Permit under RSA 482-A for the work in New Hampshire and to the Maine DEP for the work in Maine.

The project involves building a new 2,800 foot long bridge approximately 300 feet north of the existing bridge so that the new bridge can be built while the old bridge continues in service. After the new bridge is built the old bridge will be removed in accordance with U.S. Coast Guard requirements.

Because the project will be partially funded by the Federal Highway Administration (FHWA), the lead federal agency for this undertaking, and will require permits pursuant to the Federal Clean Water Act and Rivers and Harbors Act from the Army Corps of Engineers and the US Coast Guard, an environmental document referred to as a Categorical Exclusion (CE) is being prepared for FHWA to comply with the National Environmental Policy Act. The draft CE will discuss the purpose and need for the project, alternatives considered, how various aspects of the human and natural environment would be affected, the environmental consequences of the work and mitigation proposed. Many documents relating to the project including the application to the NH DES should be available at the project website at <http://www.maine.gov/mdot/sml>

Alternatively, for information about the project contact either Jeff Folsom at ME Dot Jeff.Folsom@maine.gov or Robert Landry at NH DOT RLandry@dot.state.nh.us. A Joint Public Hearing involving the Departments of Transportation of Maine and New Hampshire, the FHWA, the New Hampshire Department of Environmental Services, the Maine DEP and the Army Corps of Engineers will be held at the NH Department of Environmental Services Pease Field Office at 222 International Drive, Portsmouth, NH on Monday, June 30, 2014 at 6:00 PM. The hearing provides an opportunity for all interested parties to comment on the permit applications. Plans will be available for public inspection at the above referenced location prior to the Public Hearing from 5:00 PM until the close of the hearing.

Written comments will continue to be accepted after the Public Hearing until July 14, 2014. **The NH DES is the clearing house for comments. Please address them to Gino Infascelli, NH DES Wetlands Bureau, PO Box 95, Concord, NH 03302-0095 and reference file # 2014-01053 or send them to Gino.Infascelli@des.nh.gov** The Maine DEP and Corps will be provided copies of all the submitted comments.

If you have any questions concerning the Corps of Engineers permit decision, please contact Michael Hicks, Regulatory Project Manager, at (978) 318-8157 or (800) 343-4789, or by e-mail to Michael.C.Hicks@usace.army.mil.

This project is located on the USGS Kittery (ME) quadrangle sheet at approximately latitude 43°5' 10 " North and longitude 70°45'38" West.

For more information on the New England District Corps of Engineers programs, visit our website at <http://www.nae.usace.army.mil>.

The decision whether to issue a permit will be based on an evaluation of the probable impact of the proposed activity on the public interest. That decision will reflect the national concern for both protection and utilization of important resources. The benefit which may reasonably accrue from the proposal must be balanced against its reasonably foreseeable detriments. All factors which may be relevant to the proposal will be considered,

including the cumulative effects thereof; among those are: conservation, economics, aesthetics, general environmental concerns, wetlands, cultural value, fish and wildlife values, flood hazards, flood plain value, land use, navigation, shoreline erosion and accretion, recreation, water supply and conservation, water quality, energy needs, safety, food production and, in general, the needs and welfare of the people.

Since the activity involves the discharge of dredged or fill material into waters of the United States, the evaluation of the impact of the activity on the public interest will also include application of the guidelines promulgated by the Administrator, U.S Environmental Protection Agency, under authority of Section 404(b) of the Clean Water Act,

SECTION 106 COORDINATION: Based on his initial review, the District Engineer has determined that the proposed work probably would have some impact properties listed in, or eligible for listing in, the National Register of Historic Places. Additional review and consultation to fulfill requirements under Section 106 of the National Historic Preservation Act of 1966, as amended, will be ongoing as part of the permit review process.

ENDANGERED SPECIES CONSULTATION: The New England District, Army Corps of Engineers has reviewed the list of species protected under the Endangered Species Act of 1973, as amended, which might occur at the proposed project site during the construction and subsequent operation/use period sought by the applicants. It is our determination that the proposed activity for which authorization is being sought is designed, situated or will be operated/used in such a manner that it is not likely to adversely affect any Federally listed endangered or threatened species or their designated critical habitat. By this Public Notice, we are requesting that the appropriate Federal Agency concur with our determination.

ESSENTIAL FISH HABITAT CONSULTATION: The Magnuson-Stevens Fishery Conservation and Management Act, as amended by the Sustainable Fisheries Act of 1996 (Public Law 104-267), requires all federal agencies to consult with the National Marine Fisheries Service on all actions, or proposed actions, permitted, funded, or undertaken by the agency, that may adversely affect Essential Fish Habitat (EFH). This project may affect EFH. An EFH assessment will be prepared and forwarded to NMFS. Consultation regarding EFH affects and any conservation recommendations will be concluded before a final decision is made on the proposed project.

The following authorizations have been applied for, or have been, or will be obtained:

- Permit, License or Assent from both respective States.
- Permit from Local Wetland Agency or Conservation Commission.
- Water Quality Certifications in accordance with Section 401 of the Clean Water Act.

The initial determinations made herein will be reviewed in light of facts submitted in response to this notice. All comments will be considered a matter of public record. Copies of letters of objection will be forwarded to the applicant who will normally be requested to contact objectors directly in an effort to reach an understanding.

THIS NOTICE IS NOT AN AUTHORIZATION TO DO ANY WORK.

Michael C. Hicks
for Frank J. Delgiudice
Chief, Permits and Enforcement Branch
Regulatory Division
U S Army Corps of Engineers

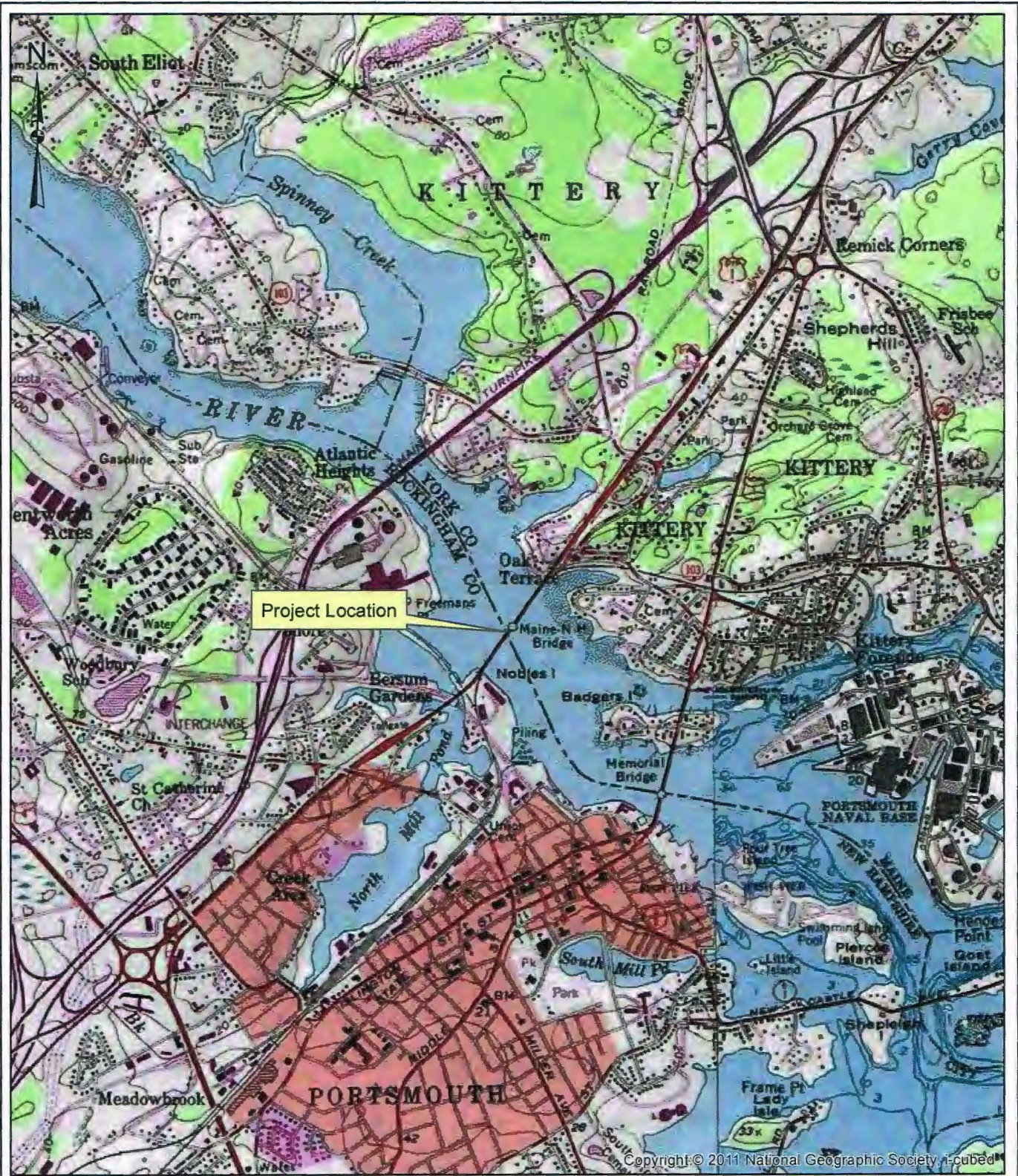

<p>NHDOT PORTSMOUTH, NH</p>		
<p>SARAH MILDRED LONG BRIDGE REPLACEMENT PROJECT LOCATION</p>		
SCALE :	DATE :	FIGURE :
1:24,000	JANUARY 2014	1
 McFarland Johnson		

LEGEND

-  — PERMANENT IMPACT
-  — TEMPORARY IMPACT
-  — HIGHEST OBSERVABLE TIDE LINE

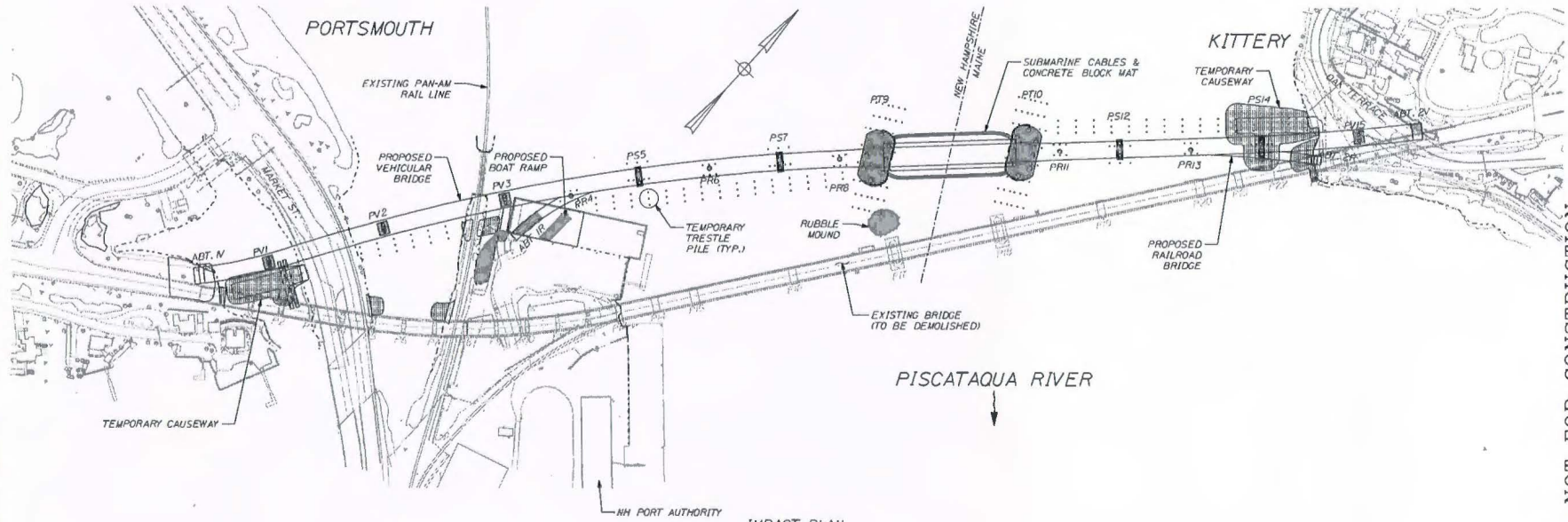

Exhibit 9



IMPACT PLAN

Graphic Scale (In/Feet)
 60 0 60 120

FOUNDATION LEGEND:

-   
 P = PIER
 V = VEHICULAR PIER
 R = RAILROAD PIER
 S = SHARED PIER
 T = LIFT SPAN TOWER
 TP = TRANSITION PIER
 LOCATION

STATE OF MAINE
 DEPARTMENT OF TRANSPORTATION
 16710.00
 PIN
 ME 941 NH 29/108 16710.00
 BRIDGE PLANS

NO.	DATE	SIGNATURE

PRELIMINARY - NOT FOR CONSTRUCTION

SARAH MILDRED LONG BRIDGE
 PISCATAQUA RIVER
 PORTSMOUTH, NH
 KITTERY, ME
 404 WETLAND IMPACT PLAN

NO.	DATE	SIGNATURE



LEGEND

TYPE OF WETLAND IMPACT	SHADING/HATCHING	TEMPORARY BUFFER ZONE IMPACT	
IMPACT 'CREDIT'		WETLAND DESIGNATION NUMBER	#
NEW HAMPSHIRE WETLANDS BUREAU & ARMY CORP OF ENGINEERS (PERMANENT WETLAND)		WETLAND IMPACT LOCATION	#
TEMPORARY IMPACTS		MEAN ORDINARY LOW WATER (M.O.L.W.)	

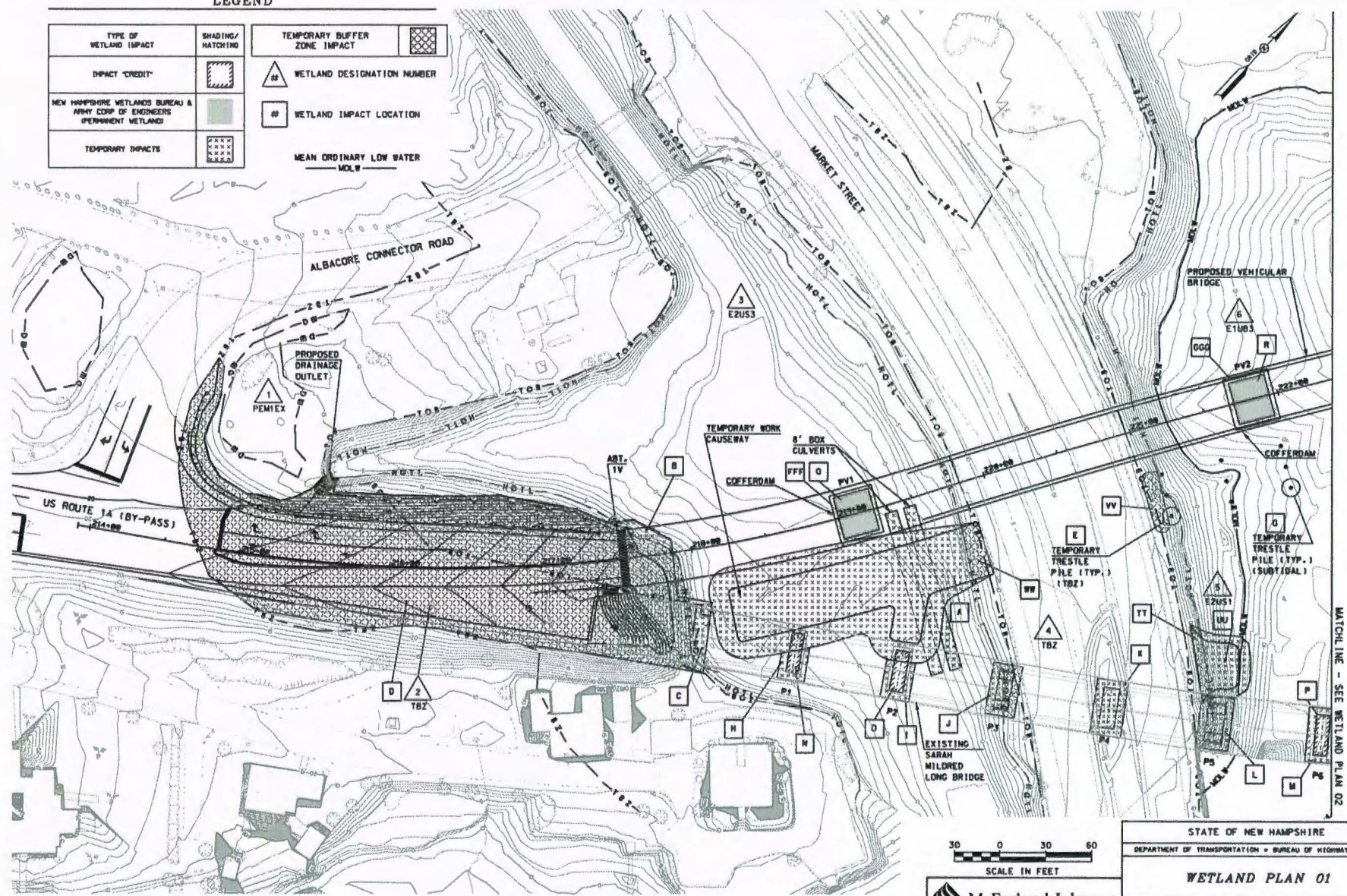

NOV PROCESSED	DATE	DATE	DATE	DATE	DATE	DATE
NEW DESIGN	DATE	DATE	DATE	DATE	DATE	DATE
SHEET CHECKER	DATE	DATE	DATE	DATE	DATE	DATE
AS BUILT DETAILS	DATE	DATE	DATE	DATE	DATE	DATE

30 0 30 60
SCALE IN FEET

McFarland Johnson

STATE OF NEW HAMPSHIRE			
DEPARTMENT OF TRANSPORTATION - BUREAU OF HIGHWAY DESIGN			
WETLAND PLAN 01			
CON	STATE PROJECT NO.	SHEET NO.	TOTAL SHEETS
WBT1and01	15731	5	11

MATCHLINE - SEE WETLAND PLAN 02

REVISED	DATE	BY	DESCRIPTION
DESIGNED	DATE	BY	STATION
CHECKED	DATE	BY	STATION
APPROVED	DATE	BY	STATION

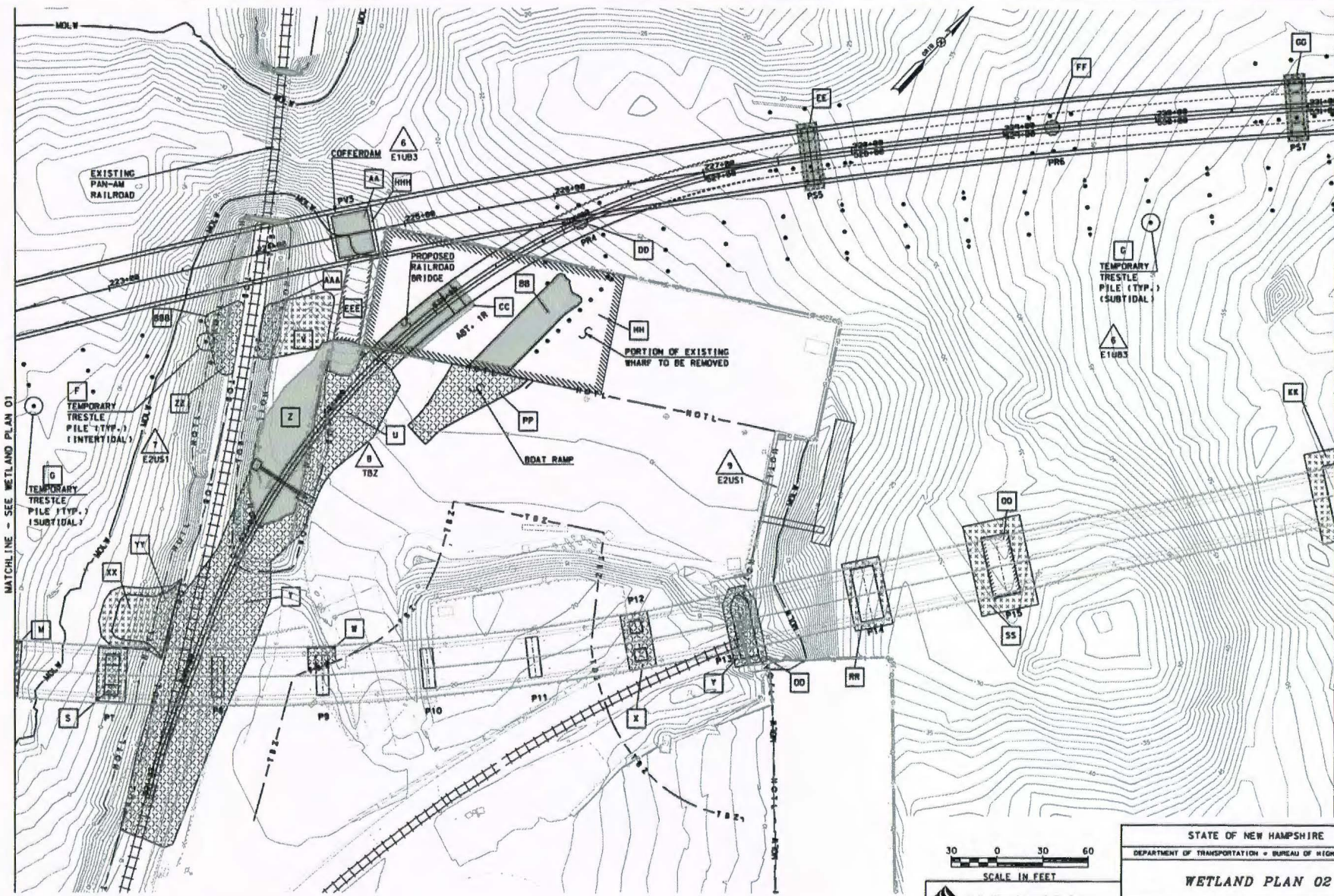

MATCHLINE - SEE WETLAND PLAN 01

MATCHLINE - SEE WETLAND PLAN 03



McFarland Johnson

STATE OF NEW HAMPSHIRE			
DEPARTMENT OF TRANSPORTATION - BUREAU OF HIGHWAY DESIGN			
WETLAND PLAN 02			
DATE	STATE PROJECT NO.	SHEET NO.	TOTAL SHEETS
01/2014	15731	6	11

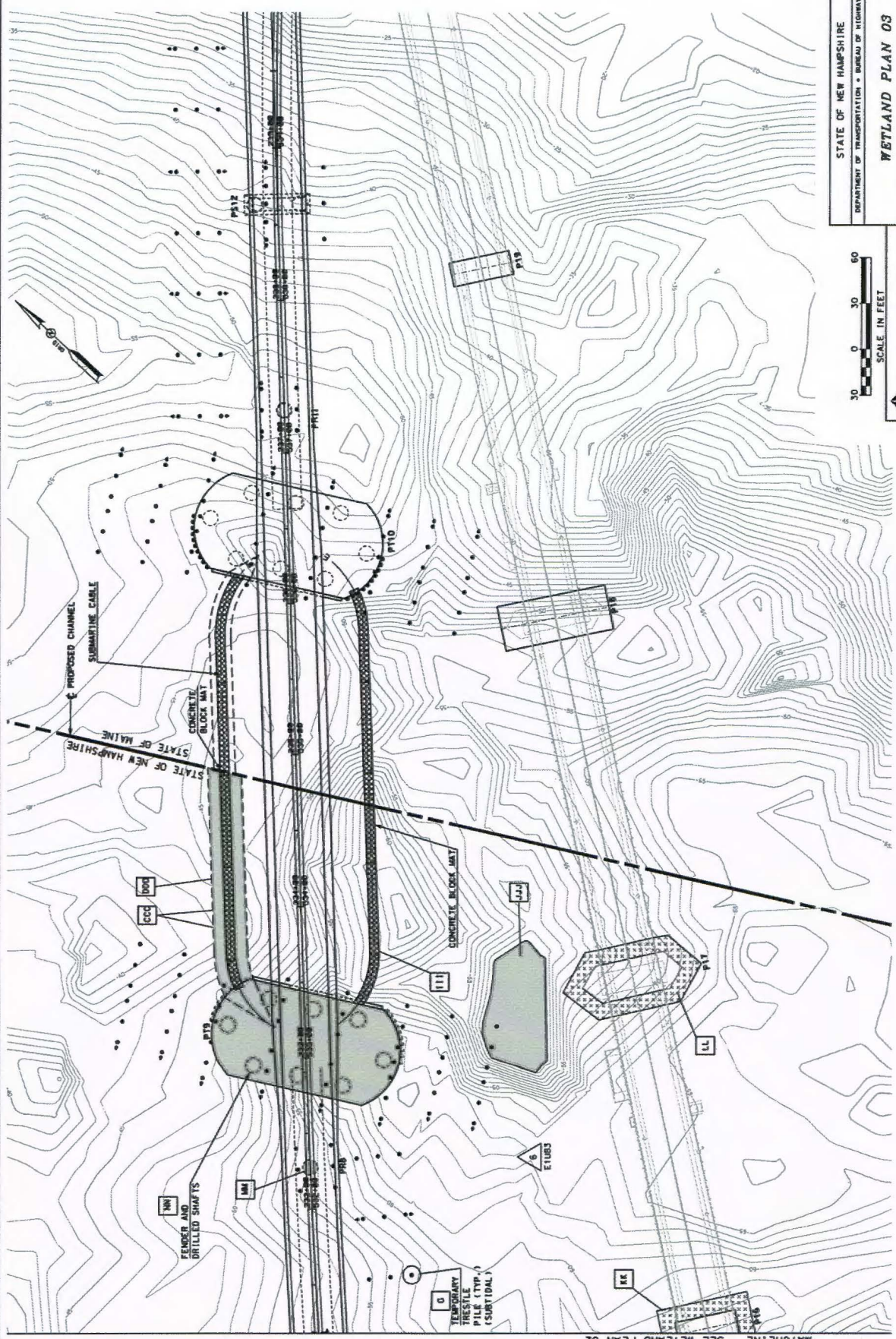

STATE OF NEW HAMPSHIRE
 DEPARTMENT OF TRANSPORTATION - BUREAU OF HIGHWAY DESIGN
WETLAND PLAN 09



McFarland Johnson

CON WETLAND03 STATE PROJECT NO. 15731 SHEET NO. 7 TOTAL SHEETS 11

DATE	DATE	DATE	MEMBER	STATION	DESCRIPTION
AS BUILT DETAILS	DATE				
SHEET CHECKED WPC	DATE 01/2014				
NEW DESIGN	DATE				
DATE DATE	DATE DATE				

MATCH LINE - SEE WETLAND PLAN 02



ACOE IMPACT

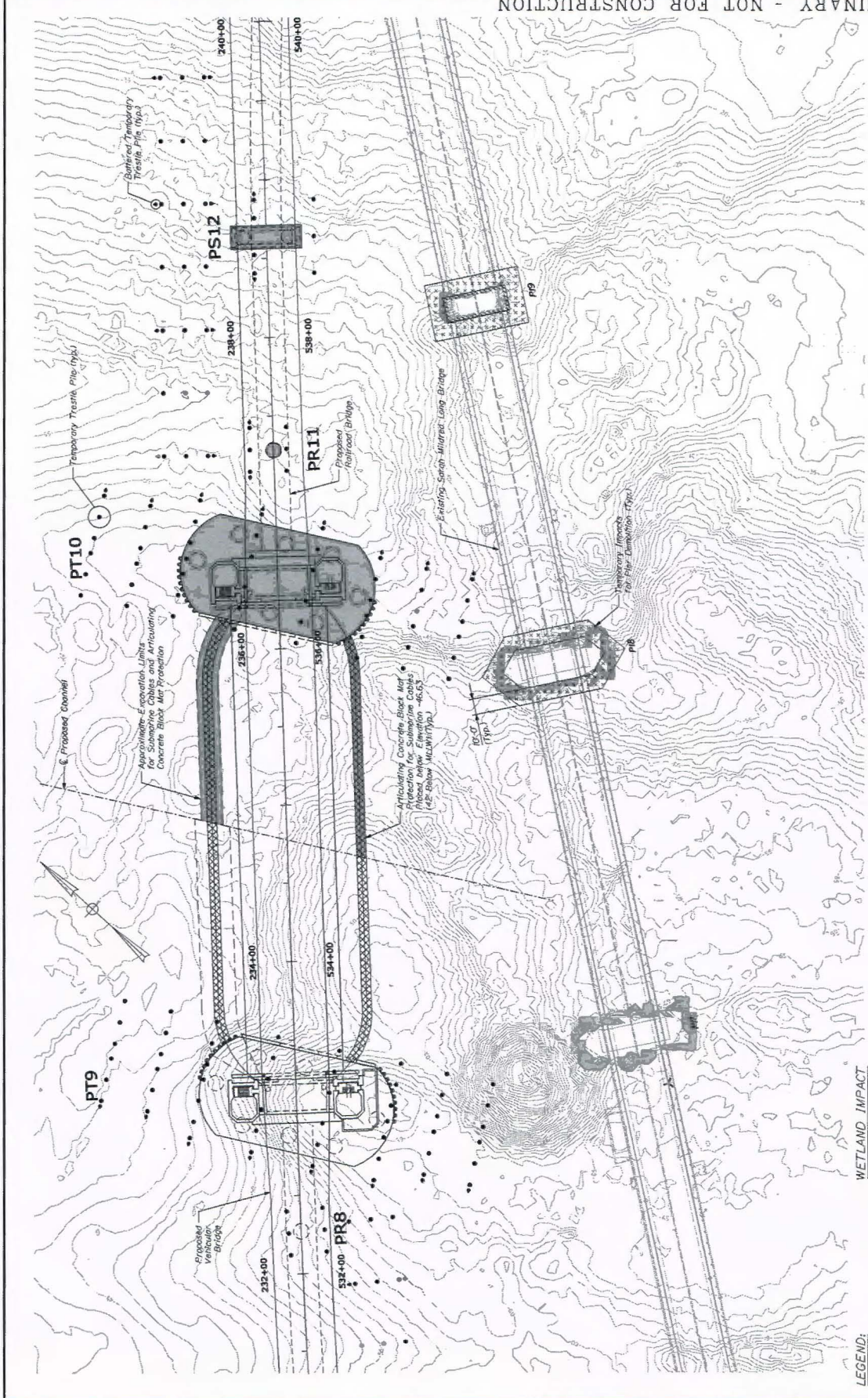

FOUNDATION LEGEND:

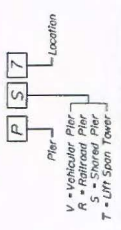

WETLAND IMPACT

- Permanent ACOE Impact
- Permanent ACOE Impact Credit
- Temporary Impact (Access Causeway and Pier Demolition)
- Temporary Impact (Temporary Trestle Piling)

LEGEND:

- Highest Observed Tide Level

Date: 4/30/2014

Username: wjohnson

Division: BRIDGE

Filename: ...MSTA Env_Lmp_2_Maine_ACOE.dgn

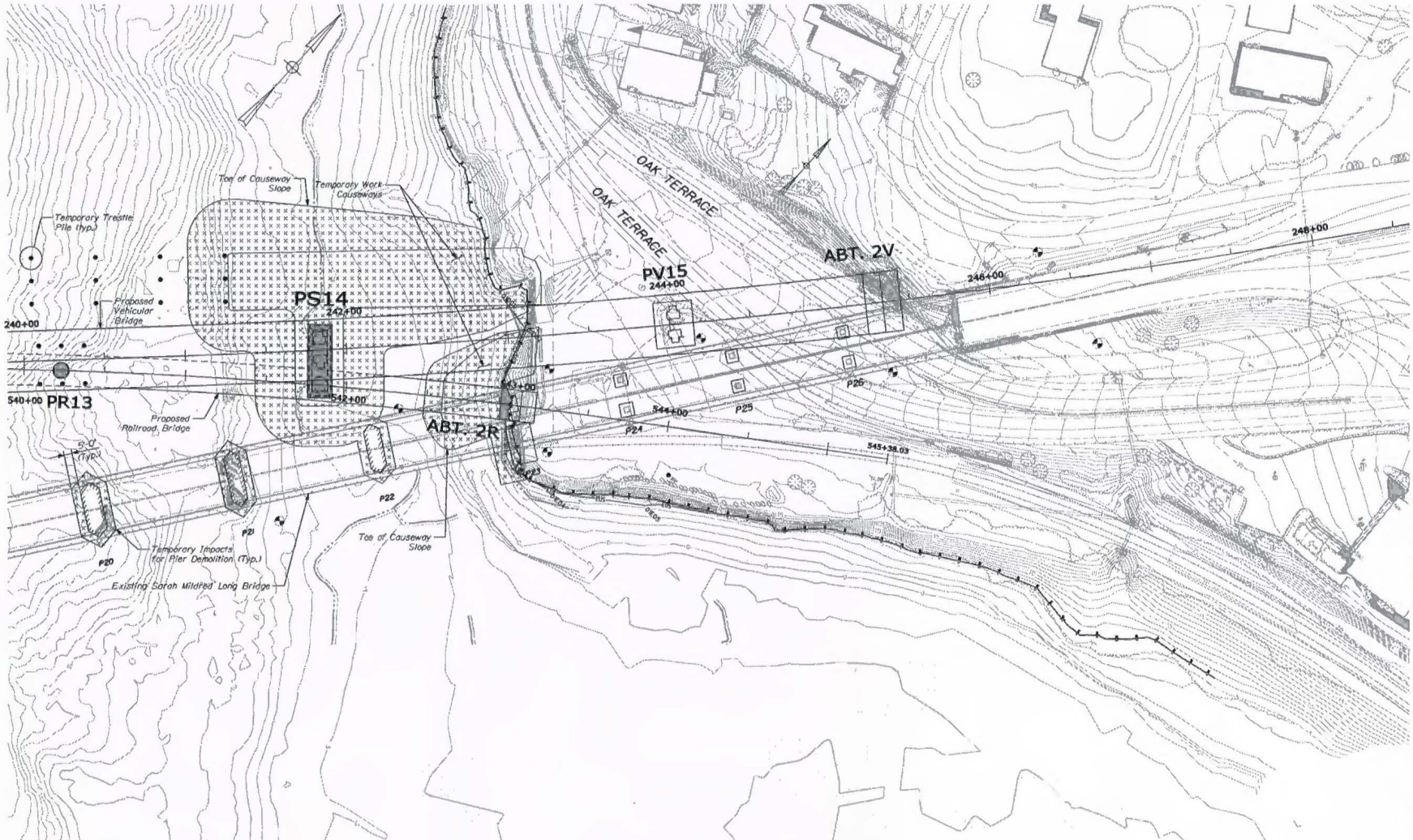

LEGEND:

—+— Highest Observed Tide Level

WETLAND IMPACT

- Permanent ACOE Impact
- Permanent ACOE Impact Credit
- Temporary Impact (Access Causeway and Pier Demolition)
- Temporary Impact (Temporary Trestle Piling)

FOUNDATION LEGEND:

- P Pier
 - R Railroad Pier
 - V Vehicular Pier
 - S Shared Pier
 - T Lift Span Tower
- Location

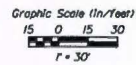

PRELIMINARY - NOT FOR CONSTRUCTION

SARAH MILDRED LONG BRIDGE
 PISCATAQUA RIVER
 KITTERY, ME
WETLAND IMPACT II

STATE OF MAINE
 DEPARTMENT OF TRANSPORTATION
 16710.00
 PIN 16710.00
 ME 3041 INF 25/1/08 16710.00
 BRIDGE PLANS

NO.	DATE	BY	REVISION

SHEET NUMBER

ACOE IMPACT

2

OF 2

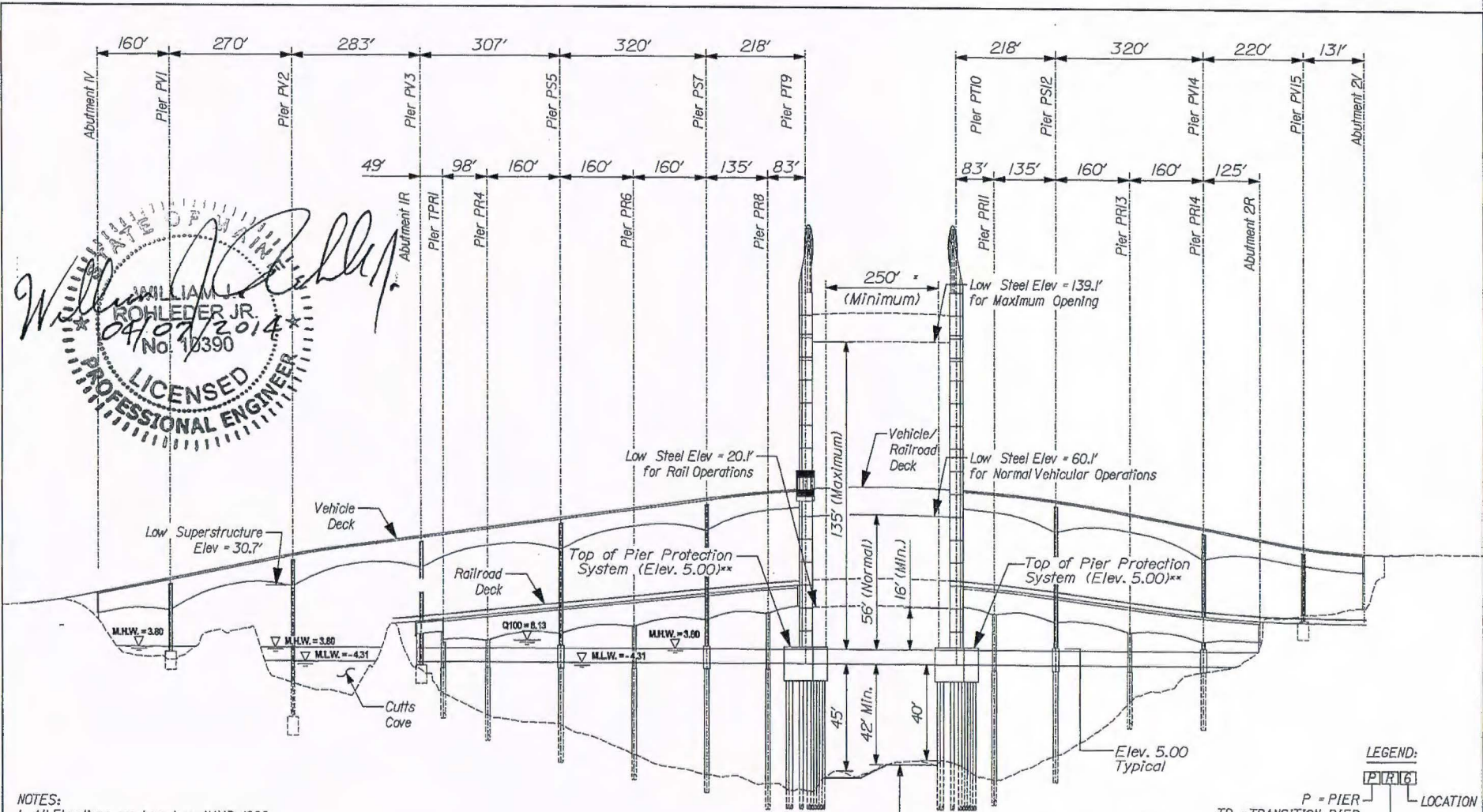

- NOTES:**
1. All Elevations are based on NAVD 1988.
 2. Vertical Clearance is Maintained over Center of Channel.
 3. Vertical Clearance is Based on M.H.W.
 - *4. Horizontal Clearance is Measured Perpendicular to Center Line of Channel.
 - **5. All Bolts Attaching the Protection System to the Pier are to be Countersunk.
 6. No Fill is Required Below Mean High Water.
 7. M.H.W. denotes Mean High Water.
 8. M.L.W. denotes Mean Low Water.
 9. 0100 denotes 100 Year Flood.

ELEVATION VIEW
(PROPOSED STRUCTURE)

- LEGEND:**
- P = PIER
 - TP = TRANSITION PIER
 - V = VEHICULAR PIER
 - R = RAILROAD PIER
 - S = SHARED PIER
 - T = LIFT SPAN TOWER

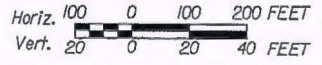

STATE OF MAINE		SARAH MILDRED LONG BRIDGE		SHEET NUMBER
DEPARTMENT OF TRANSPORTATION		PISCATAQUA RIVER (RIVER MILE 2.5)		
16710.00		PORTSMOUTH, NH KITTERY, ME		4
March 20, 2014 PIN		ROCKINGHAM COUNTY YORK COUNTY		
ME 3841 NH 251/108 16710.00		BRIDGE ELEVATION		
BRIDGE PLANS				OF 5

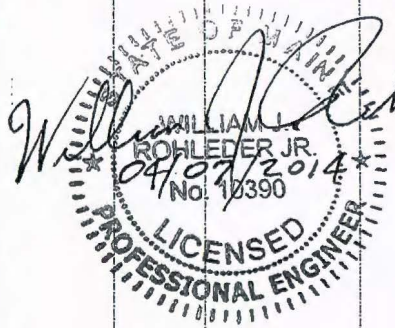

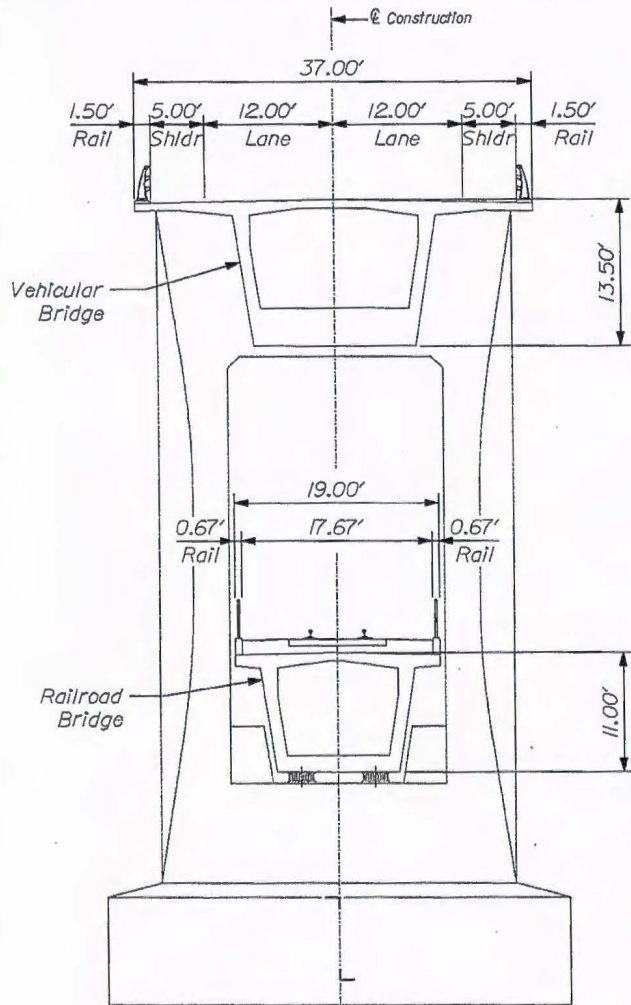

TYPICAL SECTION - APPROACHES

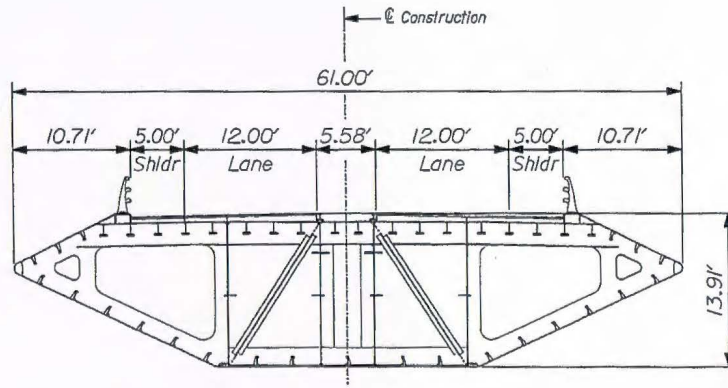

TYPICAL SECTION - LIFT SPAN

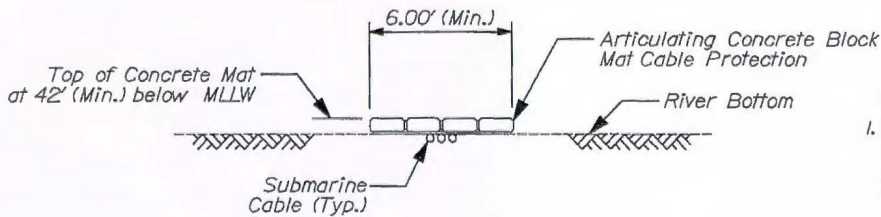

TYPICAL SUBMARINE CABLE TRENCH SECTION

N.T.S.

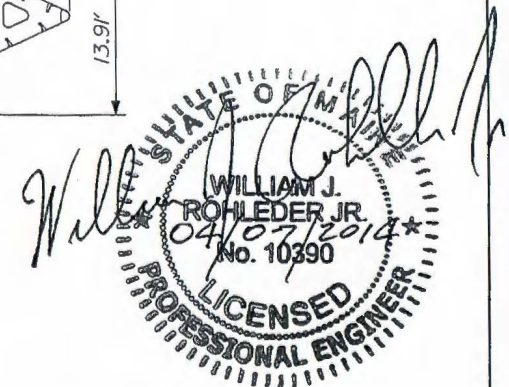

NOTE:

1. Submarine Cable Coordinates are:
 Northerly Cable Location
 From N= 92501.0, E= 880992.5
 To N= 92673.3, E= 881182.9

Southerly Cable Location
 From N= 92425.5, E= 881035.2
 To N= 92600.3, E= 881224.2

Coordinate system is NAD83 (96)
 Maine2000 West Zone State Plane
 Coordinate System, US Survey Feet.



STATE OF MAINE DEPARTMENT OF TRANSPORTATION		SARAH MILDRED LONG BRIDGE PISCATAQUA RIVER (RIVER MILE 2.5) PORTSMOUTH, NH ROCKINGHAM COUNTY	KITTERY, ME YORK COUNTY	SHEET NUMBER 5 OF 5
16710.00				
March 20, 2014 ME 3641 NH 251/108	PIN 16710.00	BRIDGE PLANS		TYPICAL BRIDGE SECTIONS