



**US Army Corps
of Engineers**®
New England District
Maine Project Office
442 Civic Center Drive
Suite 350
Augusta, Maine 04330

PUBLIC NOTICE

Comment Period Begins: 11 AUGUST 2020
Comment Period Ends: 10 SEPTEMBER 2020
File Number: NAE-2019-01231
In Reply Refer To: Jana Jacobson
Phone: (978) 318-8496
E-mail: Jana.L.Jacobson@usace.army.mil

The District Engineer has received a permit application to conduct work in waters of the United States from the **Waste Management Disposal Services of Maine, Incorporated, 357 Mercer Road, Norridgewock, Maine.** This work is proposed in freshwater wetlands adjacent to 357 Mercer Road, Norridgewock, Maine. The site coordinates are: Latitude 44.713386°N, Longitude -69.835344°W.

The work involves the expansion of an existing landfill on the 933 acre property owned by the applicant. The expansion would encompass a 48.6 acre area. Approximately 10.273 acres of wetlands would be permanently impacted by the expansion of the landfill. Temporary impacts are expected to be minor at approximately 0.005 acre. One road crossing would be constructed over an intermittent stream. The anticipated lifetime of the new facility is approximately 17 years.

To compensate for the project's unavoidable impacts to wetlands, the applicant proposes to preserve approximately 822 acres adjacent to the Chesterville Wildlife Management Area in Chesterville, Maine. The mitigation parcels consist of approximately 531 acres of uplands, 291 acres of wetlands, forty-three vernal pools, and four streams. The mitigation parcel would be transferred to the Maine Department of Inland Fisheries and Parks and would be protected in perpetuity prior to the expansion of the existing landfill.

This notice solicits comments on these proposed measures from the interested or affected public as well as those agencies who speak to the public interest. After receipt of the comments, the Corps of Engineers will obtain any necessary additional information from the applicant and determine whether the proposed measures are practicable and serve to help mitigate this project's unavoidable impacts.

The work is shown on the attached plans entitled "Crossroads Site Map," "Wetland and Stream Impact Map," "Chesterville Mitigation Parcels Map," and "Chesterville Parcels Topo Map" in fifteen sheets.

AUTHORITY

Permits are required pursuant to:

- Section 10 of the Rivers and Harbors Act of 1899
- Section 404 of the Clean Water Act
- Section 103 of the Marine Protection, Research and Sanctuaries Act.

The decision whether to issue a permit will be based on an evaluation of the probable impact of the proposed activity on the public interest. That decision will reflect the national concern for both protection and utilization of important resources. The benefit which may reasonably accrue from the proposal must be balanced against its reasonably foreseeable detriments. All factors which may be relevant to the proposal will be considered, including the cumulative effects thereof; among those are: conservation, economics, aesthetics, general environmental concerns, wetlands, cultural value, fish and wildlife values, flood hazards, flood plain value, land use, navigation, shoreline erosion and accretion, recreation, water supply and conservation, water quality, energy needs, safety, food production and, in general, the needs and welfare of the people.

The Corps of Engineers is soliciting comments from the public; Federal, state, and local agencies and officials; Indian Tribes; and other interested parties in order to consider and evaluate the impacts of this proposed activity. Any comments received will be considered by the Corps of Engineers to determine whether to issue, modify, condition or deny a permit for this proposal. To make this decision, comments are used to assess impacts on endangered species, historic properties, water quality, general environmental effects, and the other public interest factors listed above. Comments are used in the preparation of an Environmental Assessment and/or an Environmental Impact Statement pursuant to the National Environmental Policy Act. Comments are also used to determine the need for a public hearing and to determine the overall public interest of the proposed activity.

Where the activity involves the discharge of dredged or fill material into waters of the United States or the transportation of dredged material for the purpose of disposing it in ocean waters, the evaluation of the impact of the activity in the public interest will also include application of the guidelines promulgated by the Administrator, U.S Environmental Protection Agency, under authority of Section 404(b) of the Clean Water Act, and/or Section 103 of the Marine Protection Research and Sanctuaries Act of 1972, as amended.

NATIONAL HISTORIC PRESERVATION ACT

Based on the initial review, the District Engineer has determined that little likelihood exists for the proposed work to impinge upon properties with cultural or Native American significance, or listed in, or eligible for listing in, the National Register of Historic Places. Therefore, no further consideration of the requirements of Section 106 of the National Historic Preservation Act of 1966, as amended, is necessary. This determination is based upon one or more of the following:

- a. The permit area has been extensively modified by previous work.
- b. The permit area has been recently created.
- c. The proposed activity is of limited nature and scope.
- d. Review of the latest published version of the National Register shows that no presence of registered properties listed as being eligible for inclusion therein are in the permit area or general vicinity.
- e. Coordination with the State Historic Preservation Officer and/or Tribal Historic Preservation Officer(s)

ENDANGERED SPECIES CONSULTATION

The New England District, Army Corps of Engineers has reviewed the list of species protected under the Endangered Species Act of 1973, as amended, which might occur at the project site. It is our preliminary determination that the proposed activity for which authorization is being sought is designed, situated or will be operated/used in such a manner that it is not likely to adversely affect any Federally listed endangered or threatened species or their designated critical habitat. By this Public Notice, we are requesting that the appropriate Federal Agency concur with our determination.

The following authorizations have been applied for, or have been, or will be obtained:

- Permit, License or Assent from State.
- Permit from Local Wetland Agency or Conservation Commission.
- Water Quality Certification in accordance with Section 401 of the Clean Water Act.

In order to properly evaluate the proposal, we are seeking public comment. Anyone wishing to comment is encouraged to do so. Comments should be submitted in writing by the above date. If you have any questions, please contact Jana Jacobson at (978) 318-8496 or jana.l.jacobson@usace.army.mil.

Any person may request, in writing, within the comment period specified in this notice, that a public hearing be held to consider the application. Requests for a public hearing shall specifically state the reasons for holding a public hearing. The Corps holds public hearings for the purpose of obtaining public comments when that is the best means for understanding a wide variety of concerns from a diverse segment of the public.

The initial determinations made herein will be reviewed in light of facts submitted in response to this notice. All comments will be considered a matter of public record. Copies of letters of objection will be forwarded to the applicant who will normally be requested to contact objectors directly in an effort to reach an understanding.

THIS NOTICE IS NOT AN AUTHORIZATION TO DO ANY WORK.

DELGIUDICE.FRANK.J.1228 Digitally signed by
916567 DELGIUDICE.FRANK.J.1228916567
Date: 2020.08.04 13:24:50 -0400

Frank J. Del Giudice
Chief, Permits and Enforcement Branch
Regulatory Division

CENAE-R
FILE NO. NAE-2019-01231

If you would prefer not to continue receiving Public Notices by email, please contact Ms. Tina Chaisson at (978) 318-8058 or e-mail her at bettina.m.chaisson@usace.army.mil. You may also check here () and return this portion of the Public Notice to: Bettina Chaisson, Regulatory Division, U.S. Army Corps of Engineers, 696 Virginia Road, Concord, MA 01742-2751.

NAME: _____

ADDRESS: _____

PHONE: _____

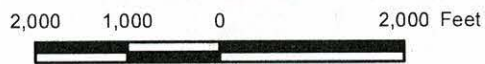
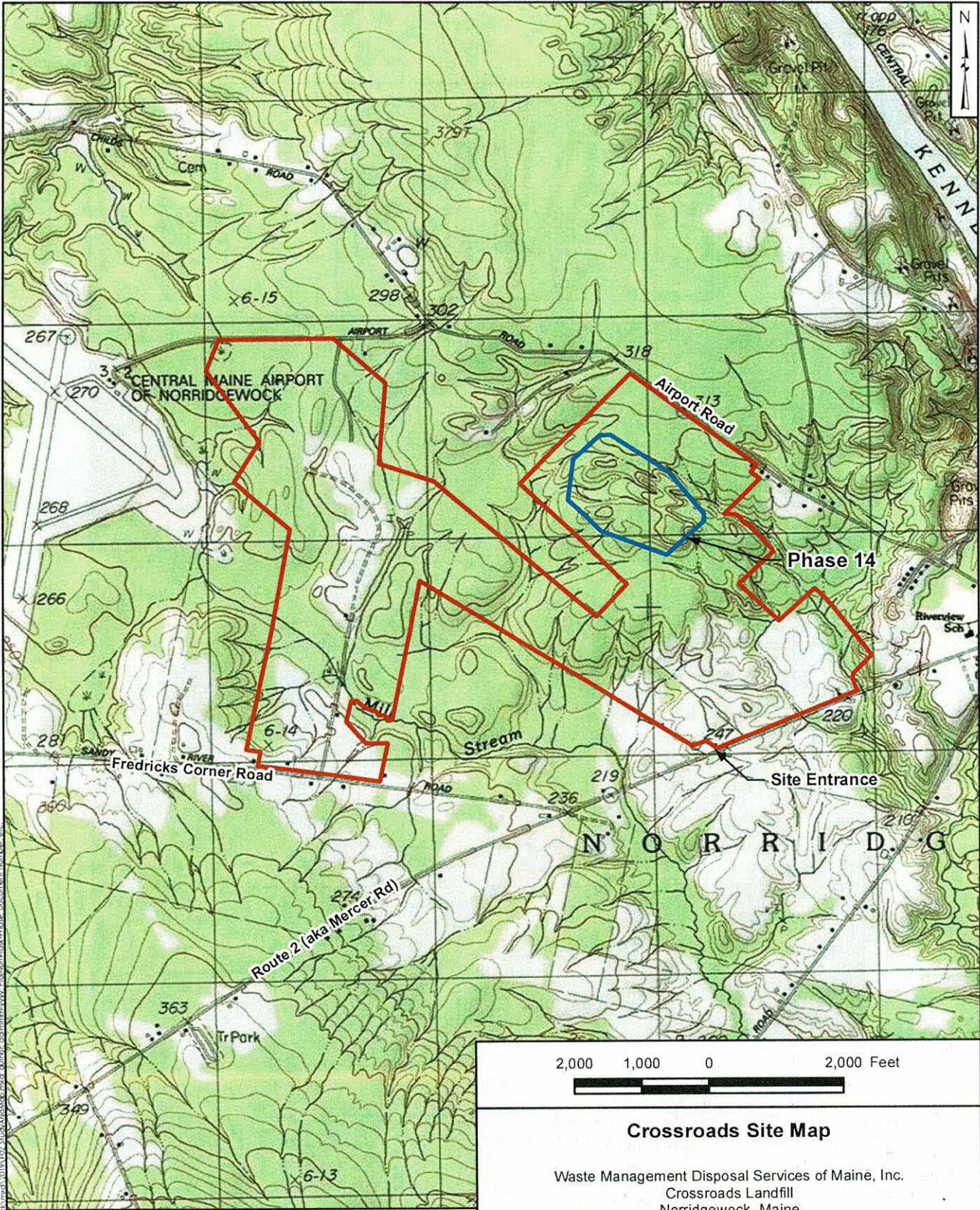

Crossroads Site Map

Waste Management Disposal Services of Maine, Inc.
 Crossroads Landfill
 Norridgewock, Maine



Attachment
3

- Legend**
- WMDSM Facility Site Boundary

Source: USGS Norridgewock 7.5 Minute Quadrangle, 2018.

Acton, Massachusetts

October 2019



Figure 2. Wetlands, streams and vernal pools in proximity to the Phase 14 site.

J:\CAD\JOBS\Crossroads_Norridgewock_ME\WXDCR_WetlandImpacts_letter_overview_061520.mxd

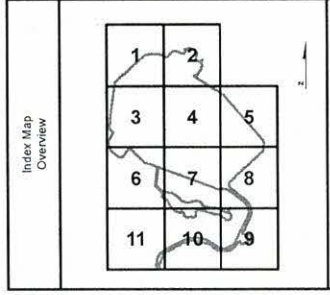
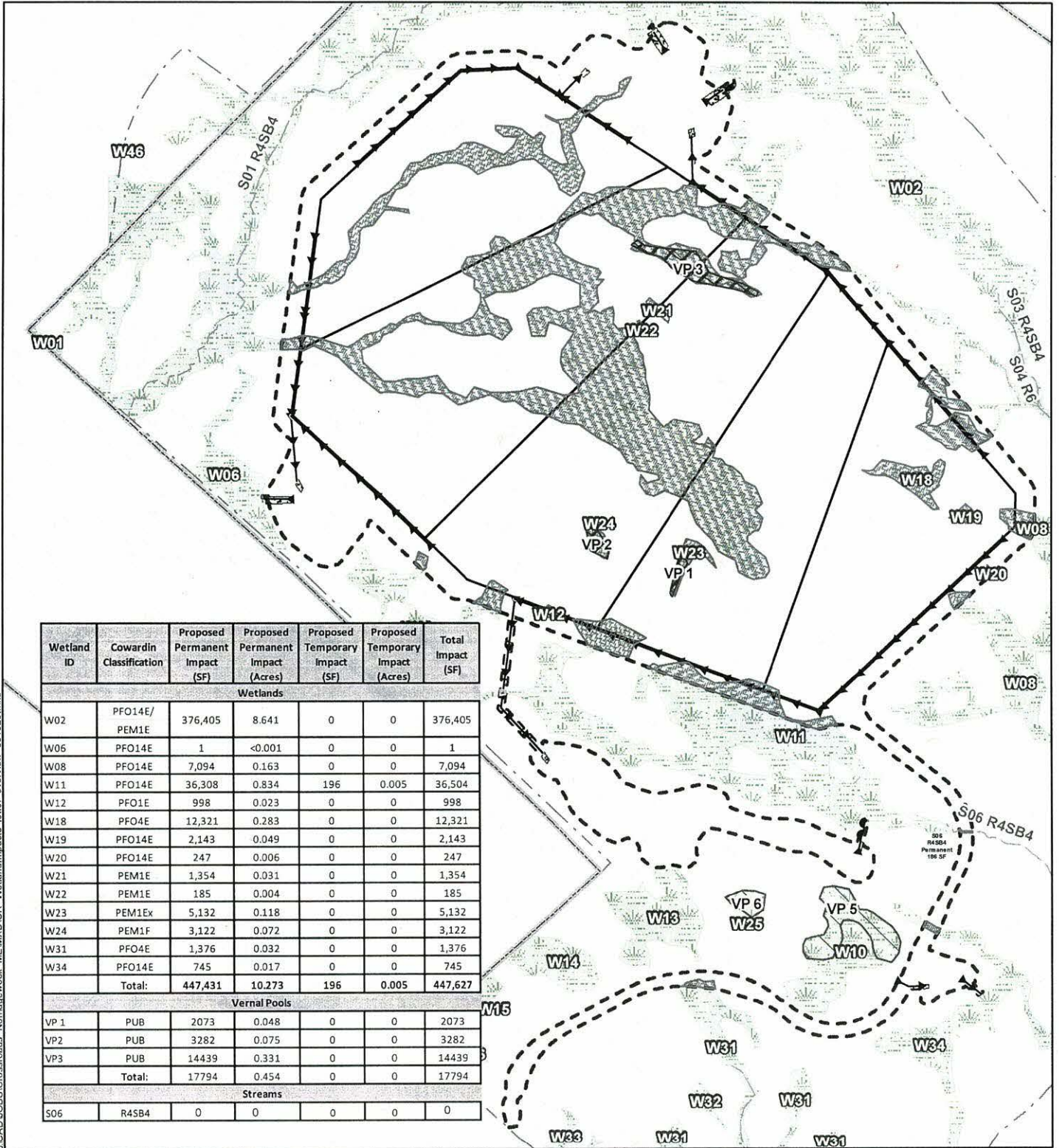

- WMDSM Facility Site Boundary
- Permanent Vernal Pool Impact
- Permanent Wetland Impact
- Temporary Wetland Impact
- 10-12' Bottomless Culvert Intermittent
- Ephemeral
- Field Delineated Vernal Pools
- Limit of Wetland/Stream/VP Survey Area Layer
- Proposed Landfill Area
- Proposed Stormwater Pipe
- Proposed Grasslined Swale
- Limit of Disturbance
- Rip-Rap Pad
- Field Delineated Wetlands

Wetland and Stream Impact Map
 Waste Management Disposal Services of Maine, Inc.
 Phase 14 Project Crossroads Landfill Norridgewock, Maine
 Date: 7/22/2020

1 inch = 375 feet
 0 100 200 400 Feet

Source: Aerial imagery provided by ESRI

J:\CAD\JOBS\Crossroads_Norridgewock_ME\WXD\CR_WetlandImpacts Letter_061520.mxd

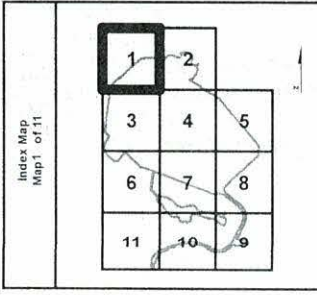
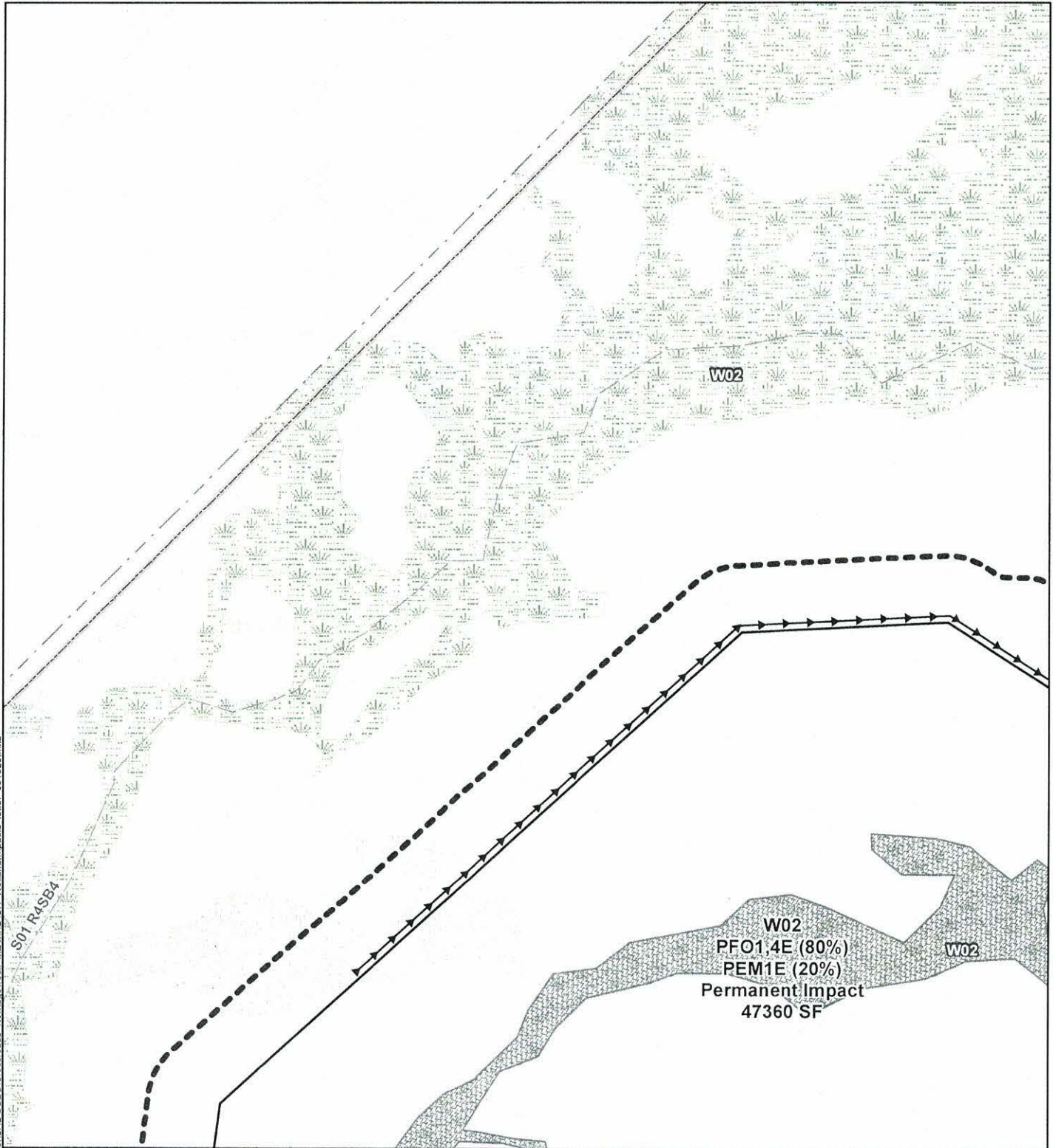

- Proposed Landfill Area
- Proposed Stormwater Pipe
- Proposed Grasslined Swale
- Limit of Disturbance
- WMDSM Facility Site Boundary
- Permanent Vernal Pool Impact
- Permanent Wetland Impact
- Temporary Wetland Impact
- 10-12' Bottomless Culvert (No Impacts)
- Intermittent
- Ephemeral
- Field Delineated Vernal Pools
- Limit of Wetland/Stream/VP Survey
- Rip-Rap Pad
- Field Delineated Wetlands

Wetland and Stream Impact Map

Waste Management
Disposal Services of Maine, Inc.

Phase 14 Project
Crossroads Landfill
Norridgewock, Maine

Date: 7/22/2020

1 inch = 100 feet

0 25 50 100 Feet

Source:
Aerial imagery provided by ESRI

J:\CAD\JOBS\Crossroads_Norridgewock_ME\W\DCR_WetlandImpacts_letter_061520.mxd

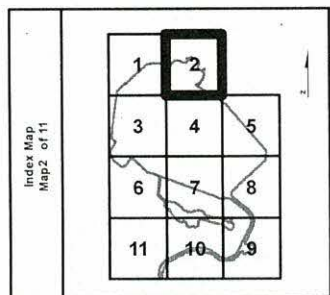
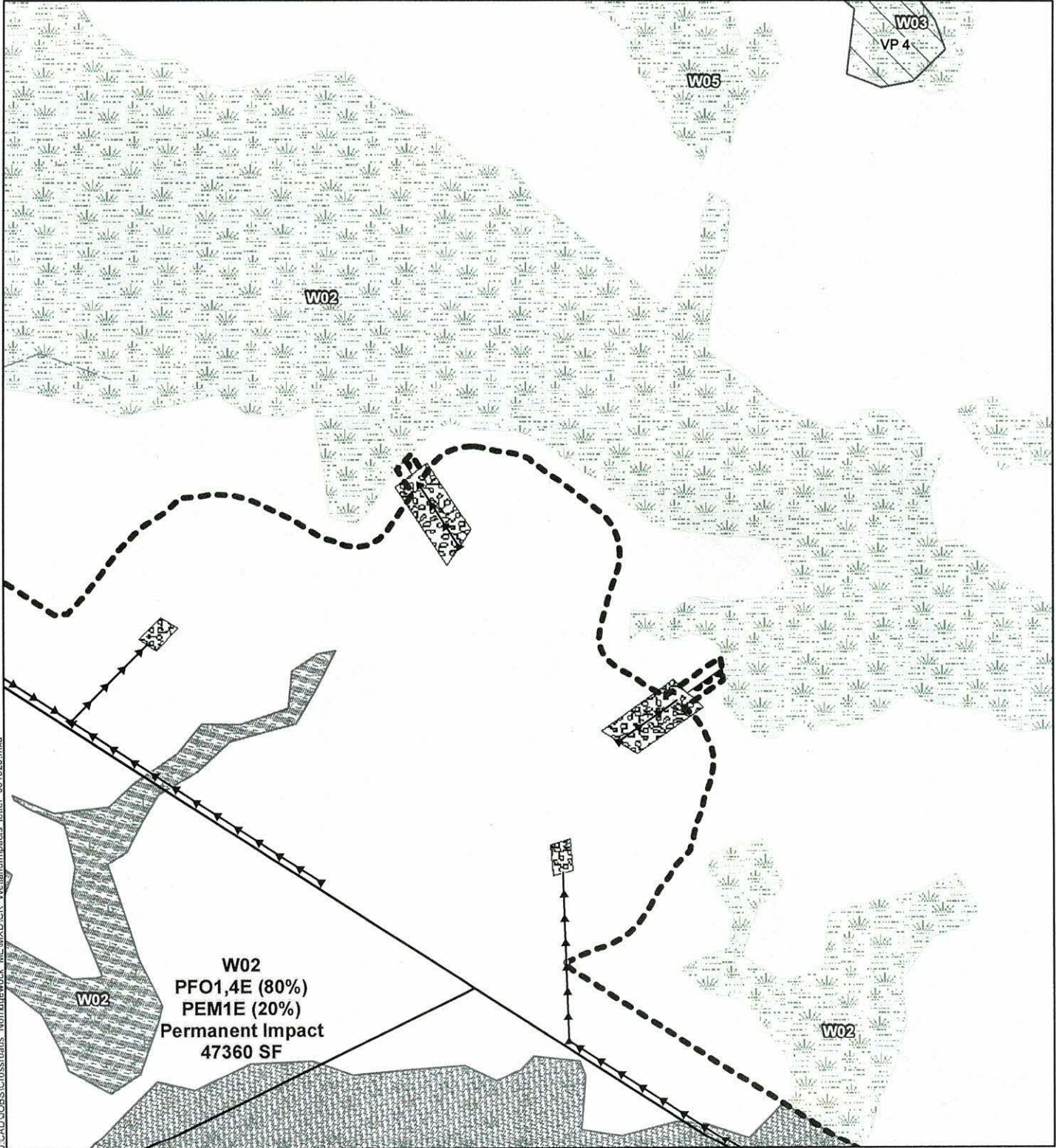

- Proposed Landfill Area
- Proposed Stormwater Pipe
- Proposed Grasslined Swale
- Limit of Disturbance
- WMDSM Facility Site Boundary
- Permanent Vernal Pool Impact
- Permanent Wetland Impact
- Temporary Wetland Impact
- 10-12' Bottomless Culvert (No Impacts)
- Intermittent
- Ephemeral
- Field Delineated Vernal Pools
- Limit of Wetland/Stream/VP Survey
- Rip-Rap Pad
- Field Delineated Wetlands

Wetland and Stream Impact Map

Waste Management
Disposal Services of Maine, Inc.

Phase 14 Project
Crossroads Landfill
Norridgewock, Maine

Date: 7/22/2020

1 inch = 100 feet

0 25 50 100 Feet

Source:
Aerial Imagery provided by ESRI

J:\CAD\JOBS\Crossroads_Norridgewock_ME\MXD\ICR_WetlandImpacts_letter_061520.mxd

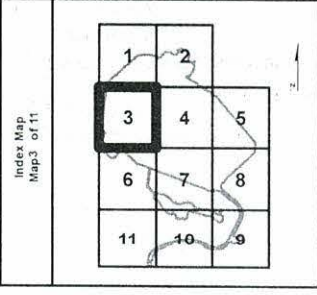
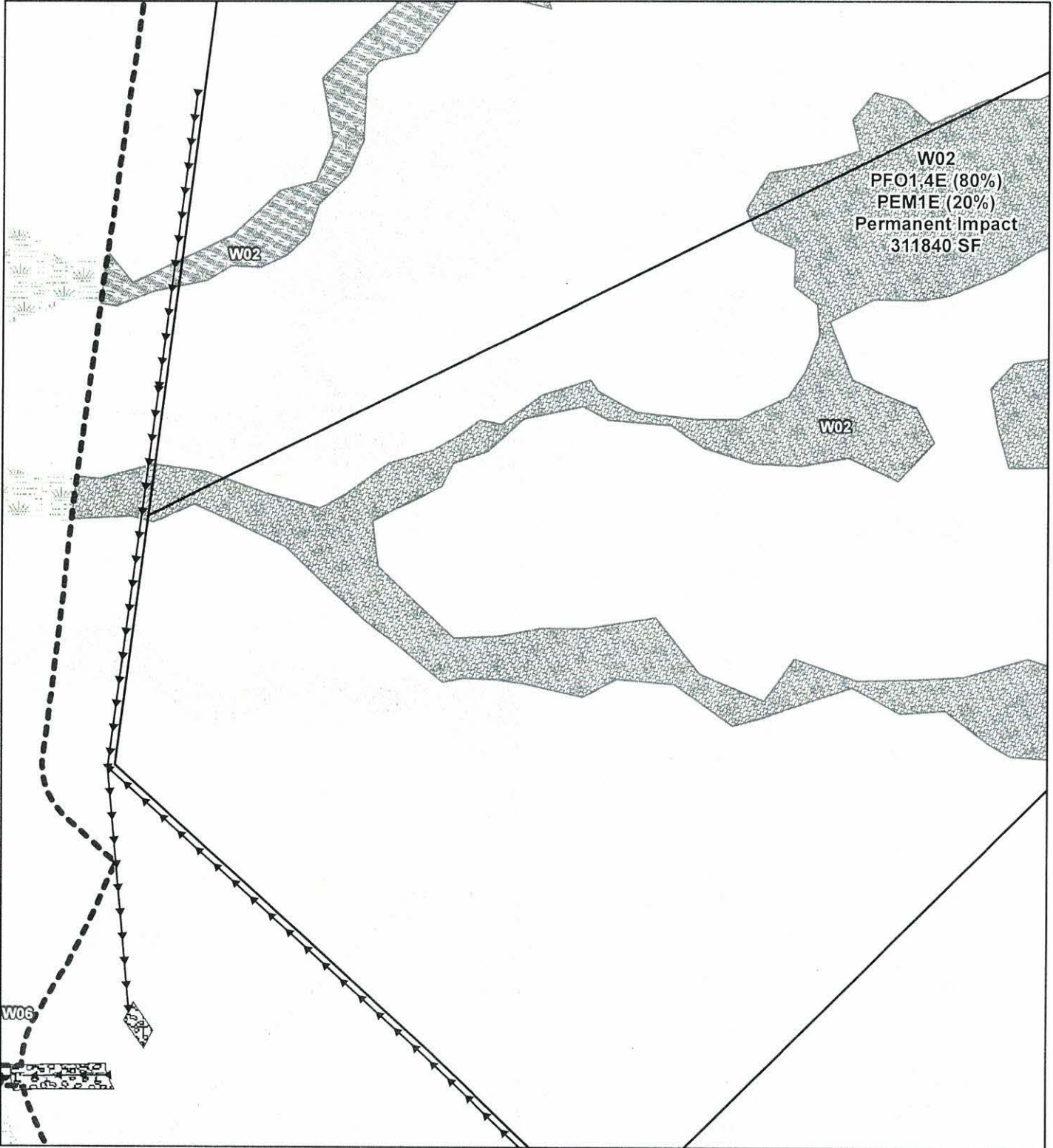

- Proposed Landfill Area
- Proposed Stormwater Pipe
- Proposed Grasslined Swale
- Limit of Disturbance
- WMDSM Facility Site Boundary
- Permanent Vernal Pool Impact
- Permanent Wetland Impact
- Temporary Wetland Impact
- 10-12' Bottomless Culvert (No Impacts)
- Intermittent Ephemeral
- Field Delineated Vernal Pools
- Limit of Wetland/Stream/VP Survey
- Rip-Rap Pad
- Field Delineated Wetlands

Wetland and Stream Impact Map

Waste Management
Disposal Services of Maine, Inc.

Phase 14 Project
Crossroads Landfill
Norridgewock, Maine

Date: 7/22/2020

1 inch = 100 feet

Source
Aerial Imagery provided by ESRI

J:\AD\JOBS\Crossroads_Norridgewock_ME\WXDCR_WetlandImpacts Letter_061520.mxd

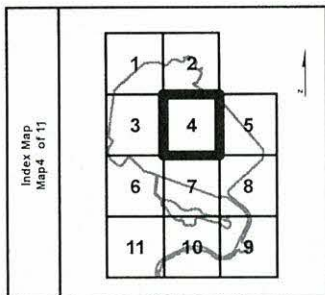
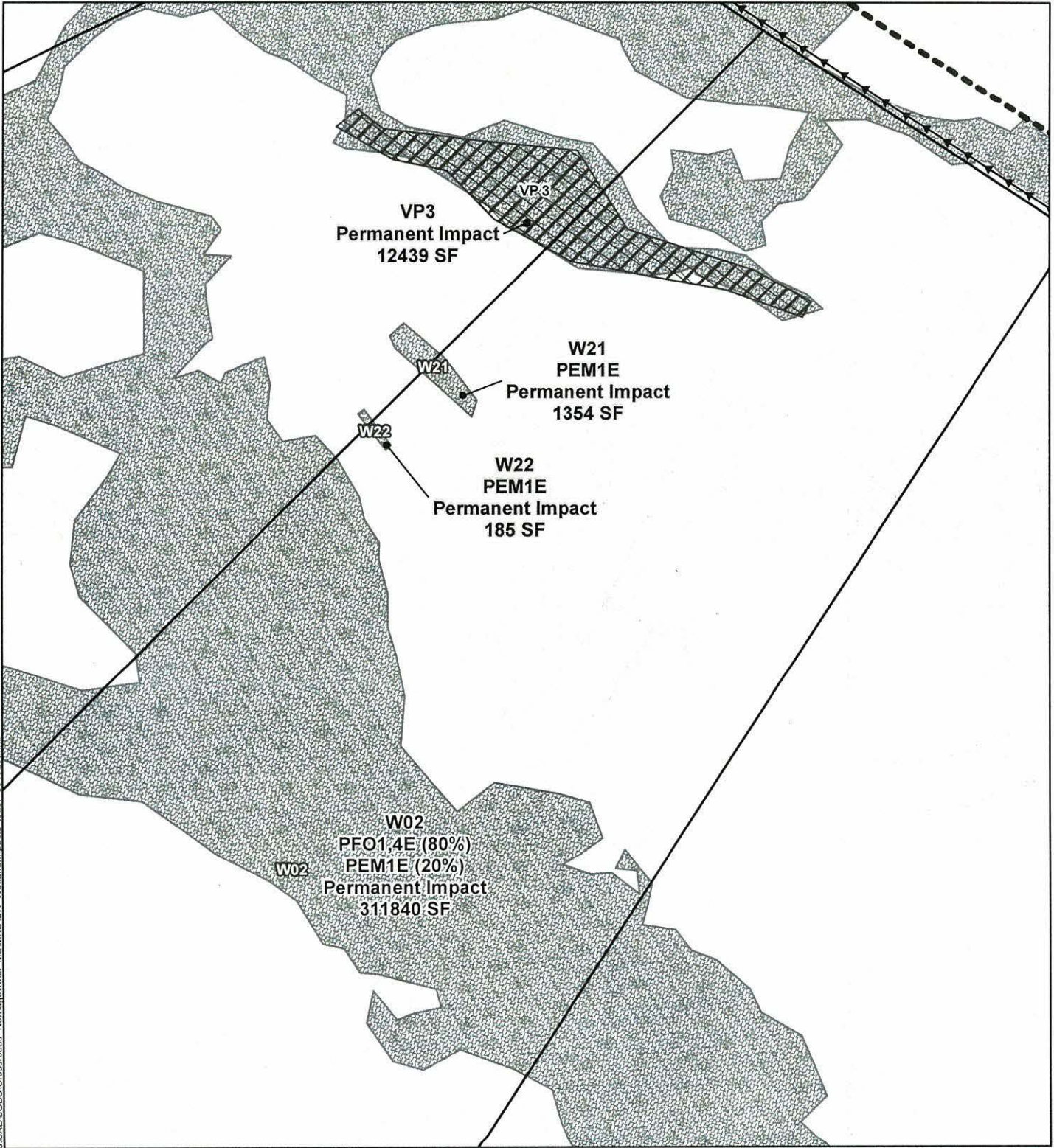

- Proposed Landfill Area
- Proposed Stormwater Pipe
- Proposed Grasslined Swale
- Limit of Disturbance
- WMSM Facility Site Boundary
- Permanent Vernal Pool Impact
- Permanent Wetland Impact
- Temporary Wetland Impact
- 10-12' Bottomless Culvert (No Impacts)
- Intermittent
- Ephemeral
- Field Delineated Vernal Pools
- Limit of Wetland/Stream/VP Survey
- Rip-Rap Pad
- Field Delineated Wetlands

Wetland and Stream Impact Map

Waste Management
Disposal Services of Maine, Inc.

Phase 14 Project
Crossroads Landfill
Norridgewock, Maine
Date: 7/22/2020

1 inch = 100 feet

0 25 50 100 Feet

Source:
Aerial Imagery provided by ESRI

J:\CAD\JOBS\Crossroads_Norridgewock_ME\MXD\ICR_WetlandImpacts_letter_061520.mxd

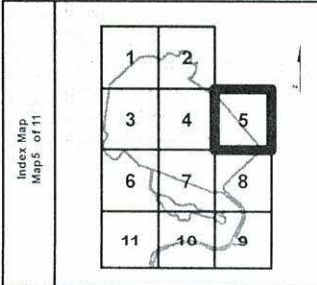
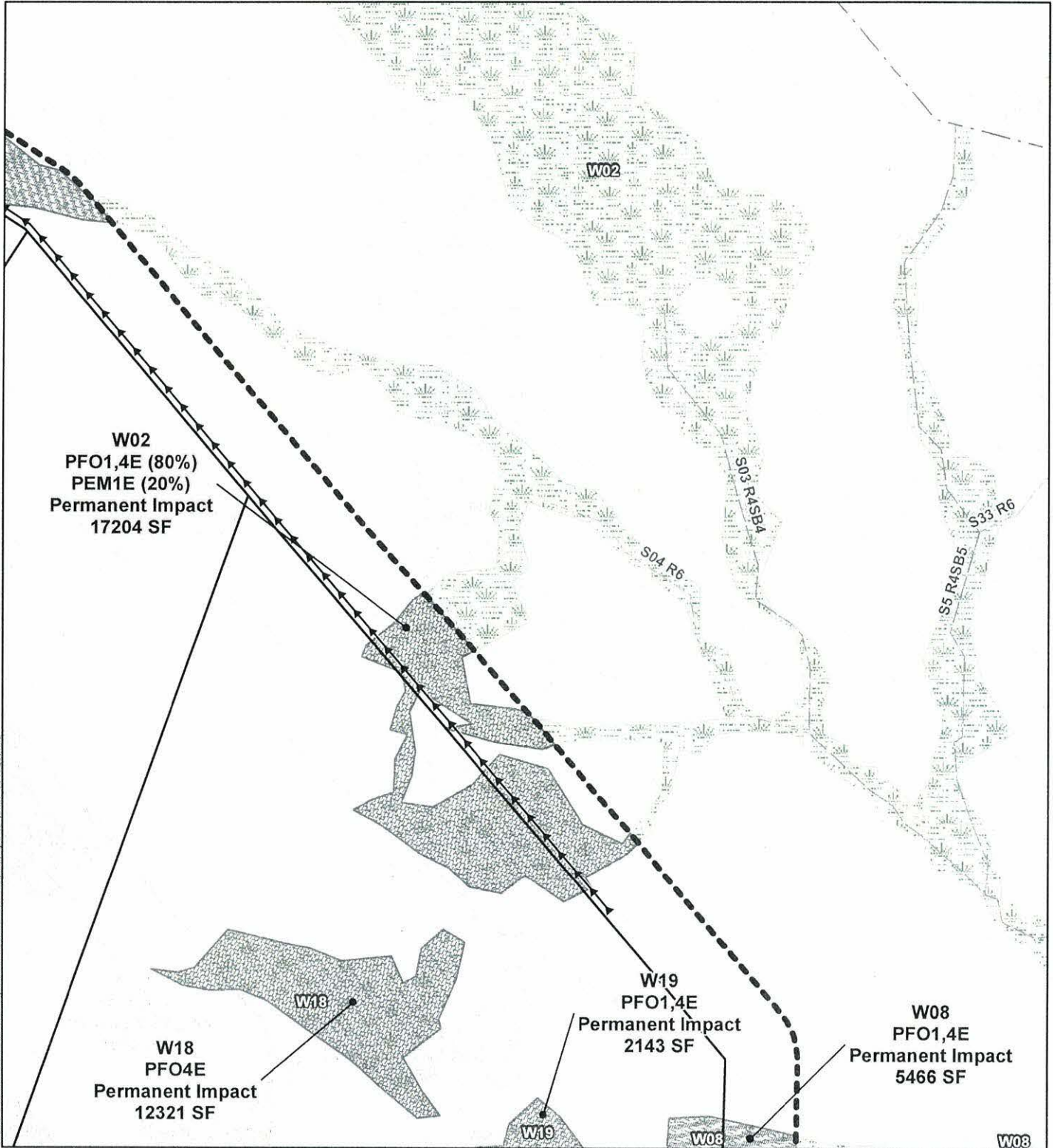

- Proposed Landfill Area
- Proposed Stormwater Pipe
- Proposed Grasslined Swale
- Limit of Disturbance
- WMDSM Facility Site Boundary
- Permanent Vernal Pool Impact
- Permanent Wetland Impact
- Temporary Wetland Impact
- 10-12' Bottomless Culvert (No Impacts)
- Intermittent
- Ephemeral
- Field Delineated Vernal Pools
- Limit of Wetland/Stream/VP Survey
- Rip-Rap Pad
- Field Delineated Wetlands

Wetland and Stream Impact Map

Waste Management
Disposal Services of Maine, Inc.

Phase 14 Project
Crossroads Landfill
Norridgewock, Maine

Date: 7/22/2020

1 inch = 100 feet

0 25 50 100 Feet

Source:
Aerial imagery provided by ESRI

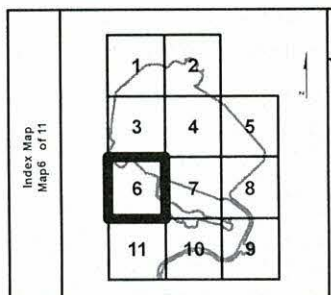
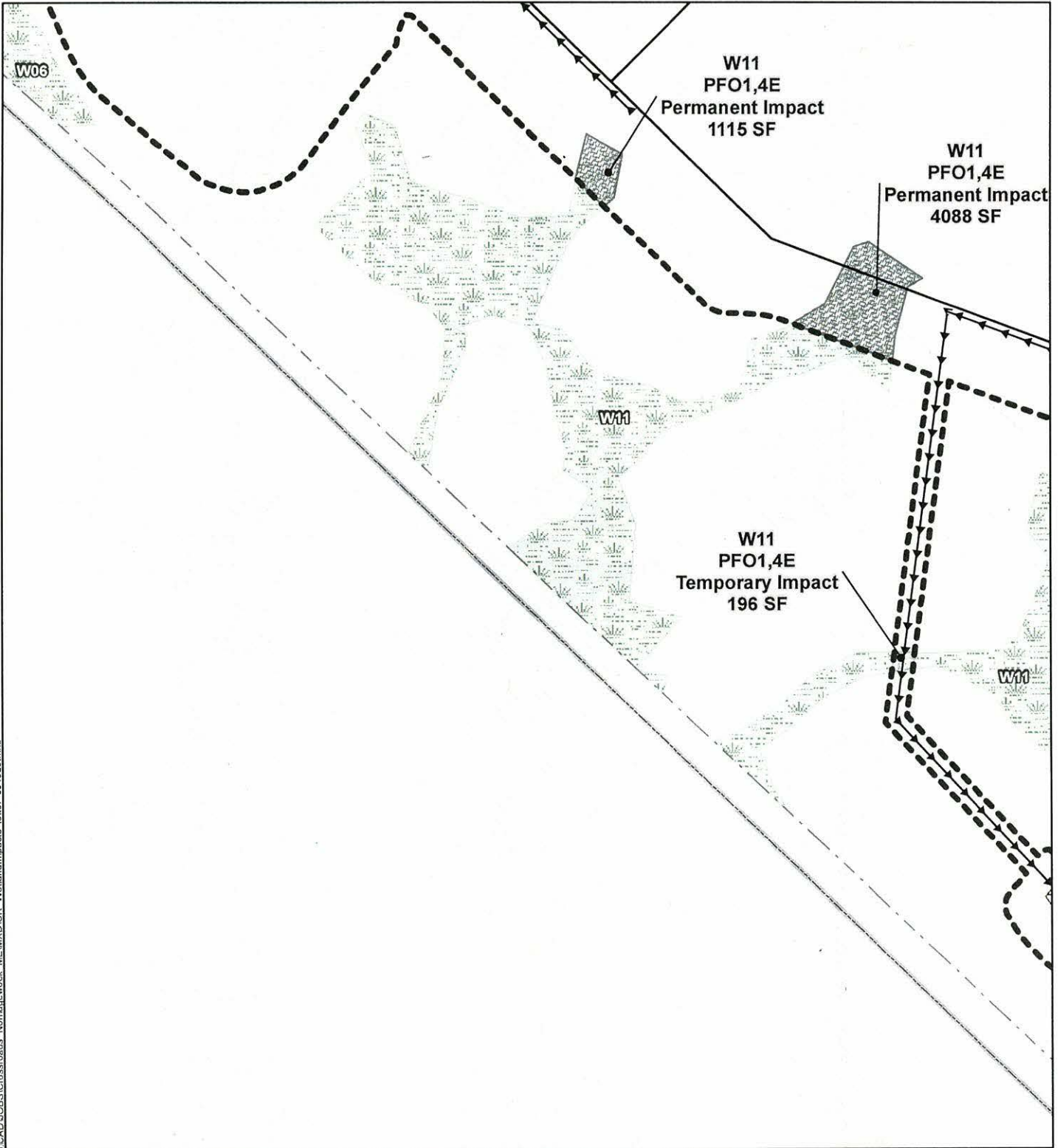

- Proposed Landfill Area
- Proposed Stormwater Pipe
- Proposed Grasslined Swale
- Limit of Disturbance
- WMDSM Facility Site Boundary
- Permanent Vernal Pool Impact
- Permanent Wetland Impact
- Temporary Wetland Impact
- 10-12' Bottomless Culvert (No Impacts)
- Intermittent
- Ephemeral
- Field Delineated Vernal Pools
- Limit of Wetland/Stream/VP Survey
- Rip-Rap Pad
- Field Delineated Wetlands

Wetland and Stream Impact Map

Waste Management
Disposal Services of Maine, Inc.

Phase 14 Project
Crossroads Landfill
Norridgewock, Maine
Date: 7/22/2020

1 inch = 100 feet

0 25 50 100 Feet

Source:
Aerial Imagery provided by ESRI

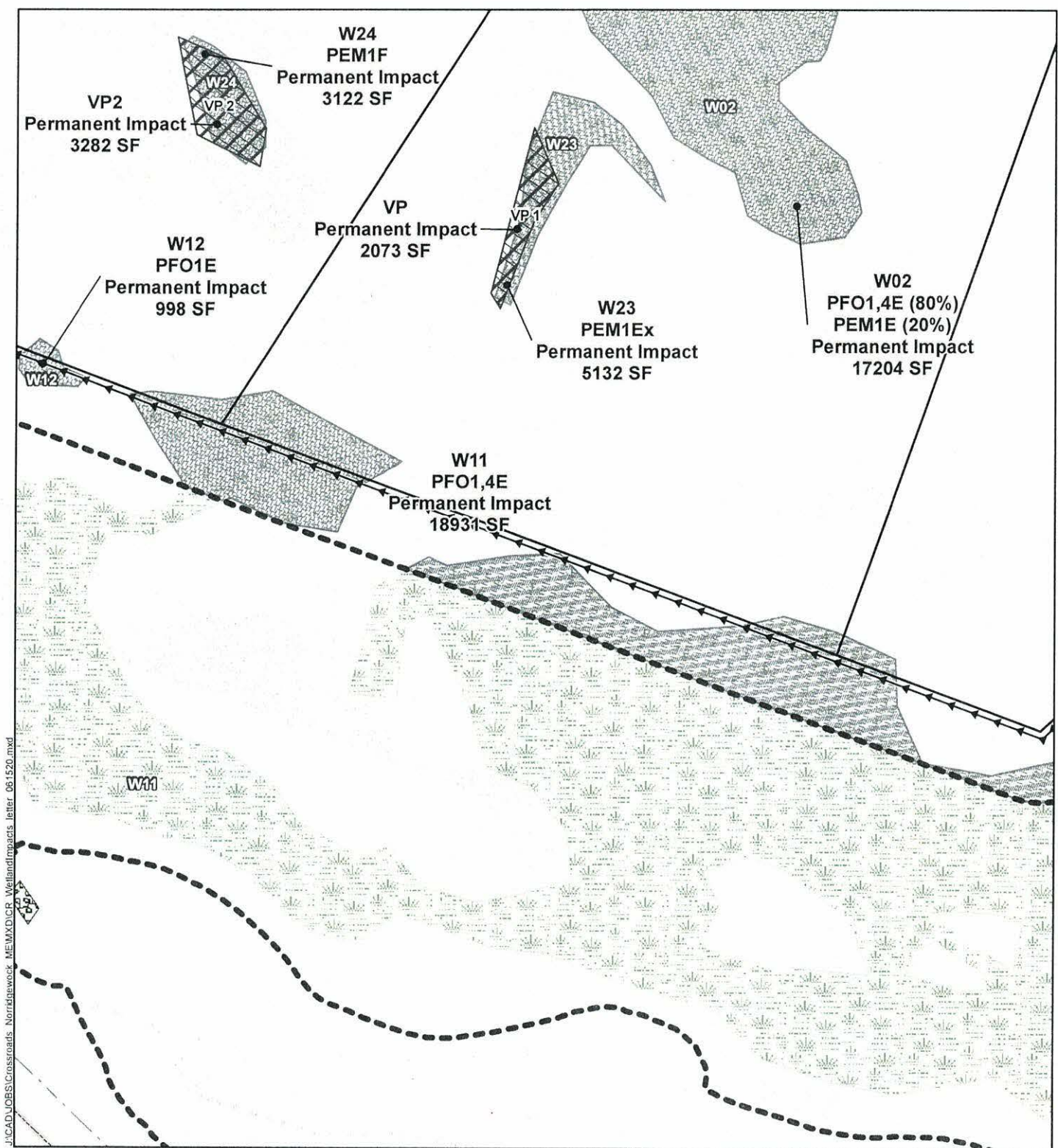

J:\CAD\JOBS\Crossroads_Norridgewock_ME\WXD\ICR_WetlandImpacts_letter_061520.mxd

<p>Index Map Map 7 of 11</p>	Proposed Landfill Area Proposed Stormwater Pipe Proposed Grasslined Swale Limit of Disturbance WMDSM Facility Site Boundary Permanent Vernal Pool Impact Permanent Wetland Impact Temporary Wetland Impact 10-12' Bottomless Culvert (No Impacts)	Intermittent Ephemeral Field Delineated Vernal Pools Limit of Wetland/Stream/VP Survey Rip-Rap Pad Field Delineated Wetlands	<p>Wetland and Stream Impact Map</p> <p>Waste Management Disposal Services of Maine, Inc.</p> <p>Phase 14 Project Crossroads Landfill Norridgewock, Maine</p> <p>Date: 7/22/2020</p> <p>1 inch = 100 feet</p> <p>Source: Aerial imagery provided by ESRI</p>
----------------------------------	---	---	---

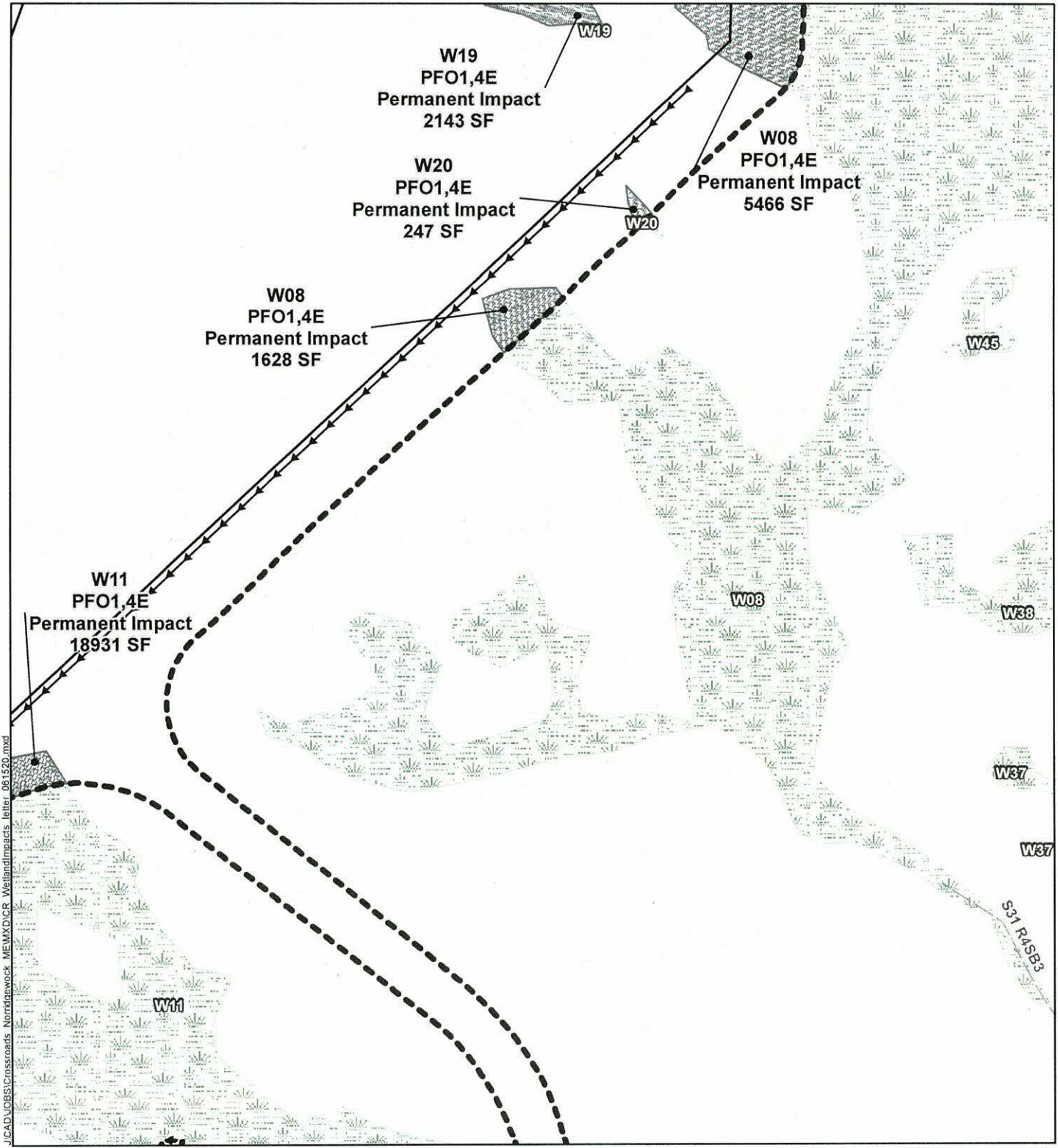

J:\CAD\JOBS\Crossroads_Norridgewock_ME\WXD\DCR_WetlandImpacts_letters_081520.mxd

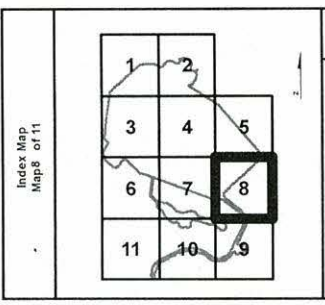

- Proposed Landfill Area
- Proposed Stormwater Pipe
- Proposed Grasslined Swale
- Limit of Disturbance
- WMDSM Facility Site Boundary
- Permanent Vernal Pool Impact
- Permanent Wetland Impact
- Temporary Wetland Impact
- 10-12' Bottomless Culvert (No Impacts)
- Intermittent
- Ephemeral
- Field Delineated Vernal Pools
- Limit of Wetland/Stream/VP Survey
- Rip-Rap Pad
- Field Delineated Wetlands

Wetland and Stream Impact Map

Waste Management
Disposal Services of Maine, Inc.

Phase 14 Project
Crossroads Landfill
Norridgewock, Maine

Date: 7/22/2020

1 inch = 100 feet

0 25 50 100 Feet

Source:
Aerial imagery provided by ESRI

J:\CAD\JOBS\Crossroads_Norridgewock_ME\MXD\ICR_WetlandImpacts Letter_061520.mxd

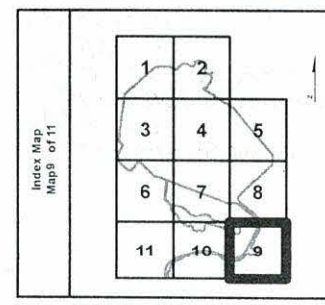
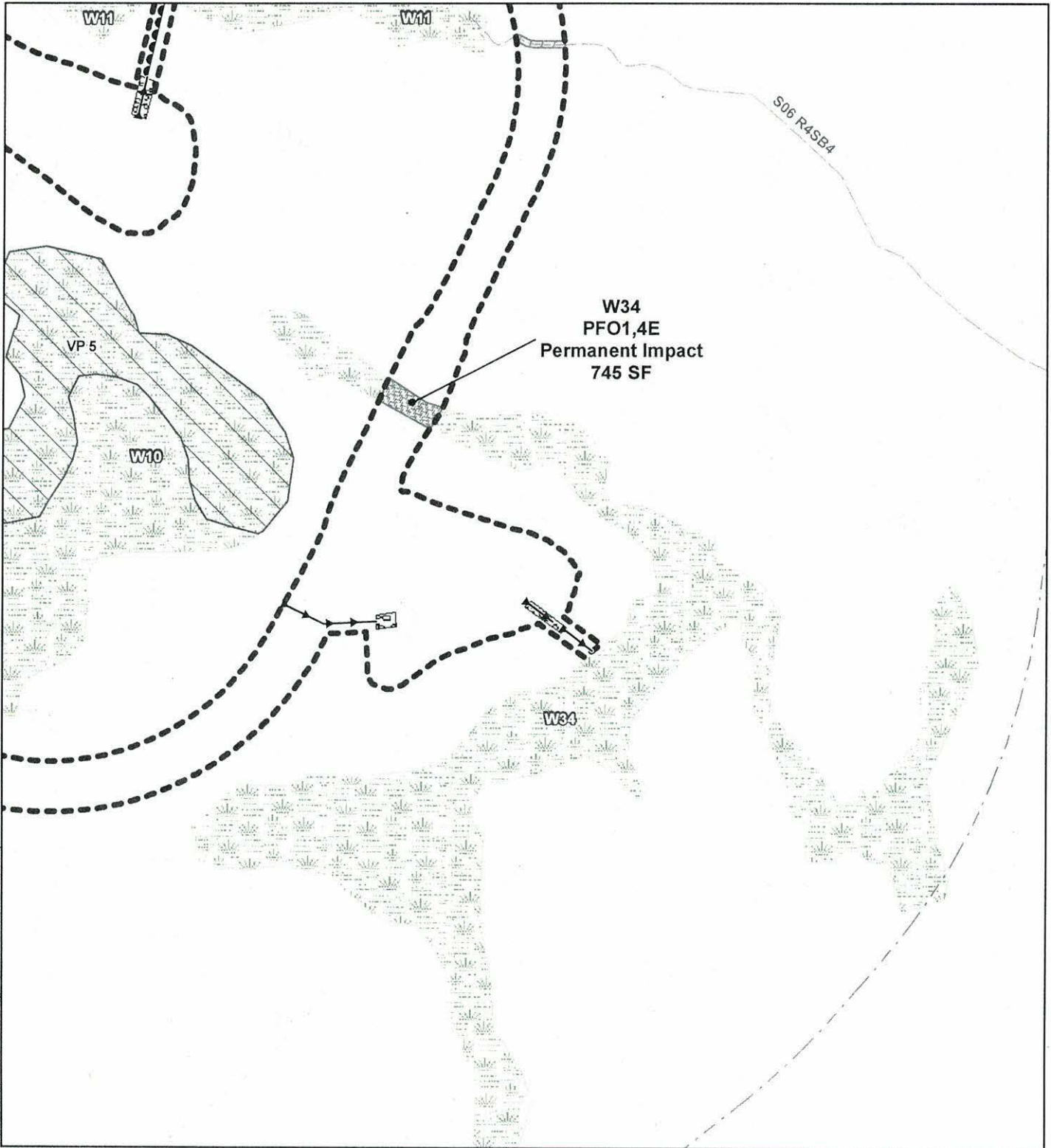

- Proposed Landfill Area
- Proposed Stormwater Pipe
- Proposed Grasslined Swale
- Limit of Disturbance
- WMDSM Facility Site Boundary
- Permanent Vernal Pool Impact
- Permanent Wetland Impact
- Temporary Wetland Impact
- 10-12' Bottomless Culvert (No Impacts)
- Intermittent
- Ephemeral
- Field Delineated Vernal Pools
- Limit of Wetland/Stream/VP Survey
- Rip-Rap Pad
- Field Delineated Wetlands

**Wetland and Stream
Impact Map**

Waste Management
Disposal Services of Maine, Inc.

Phase 14 Project
Crossroads Landfill
Norridgewock, Maine
Date: 7/22/2020

1 inch = 100 feet

Source:
Aerial imagery provided by ESRI

J:\ADU\085\Crossroads_Norridgewock_ME\WXDCR_WetlandImpacts_Letter_081520.mxd

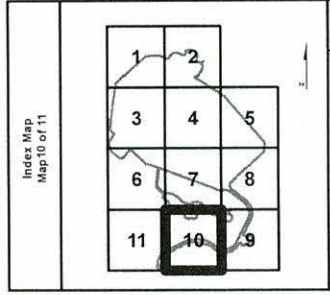
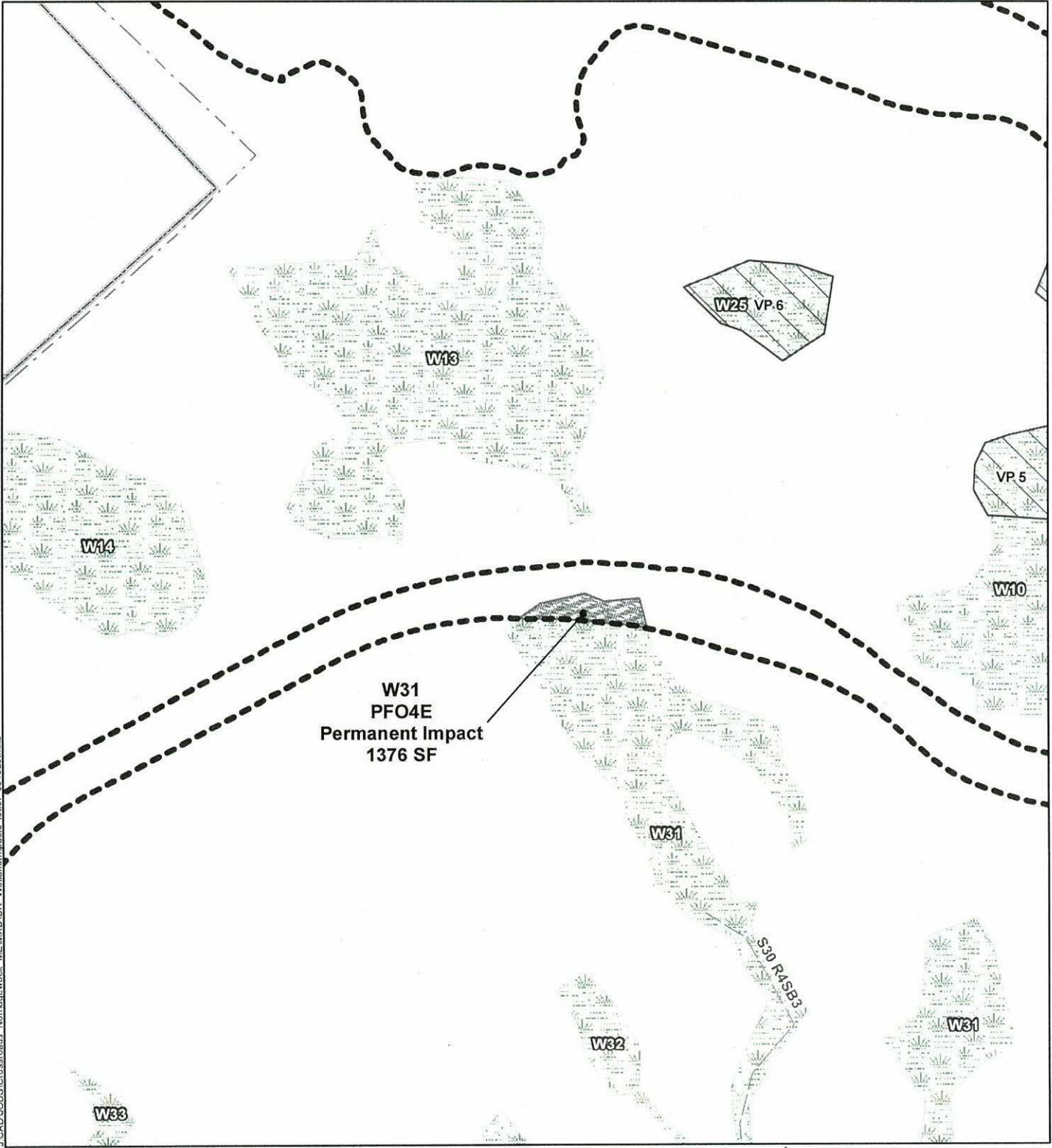

- Proposed Landfill Area
- Proposed Stormwater Pipe
- Proposed Grasslined Swale
- Limit of Disturbance
- WMDSM Facility Site Boundary
- Permanent Vernal Pool Impact
- Permanent Wetland Impact
- Temporary Wetland Impact
- 10-12' Bottomless Culvert (No Impacts)
- Intermittent
- Ephemeral
- Field Delineated Vernal Pools
- Limit of Wetland/Stream/VP Survey
- Rip-Rap Pad
- Field Delineated Wetlands

Wetland and Stream Impact Map

Waste Management
Disposal Services of Maine, Inc.

Phase 14 Project
Crossroads Landfill
Norridgewock, Maine

Date: 7/22/2020

1 inch = 100 feet

Source:
Aerial imagery provided by ESRI

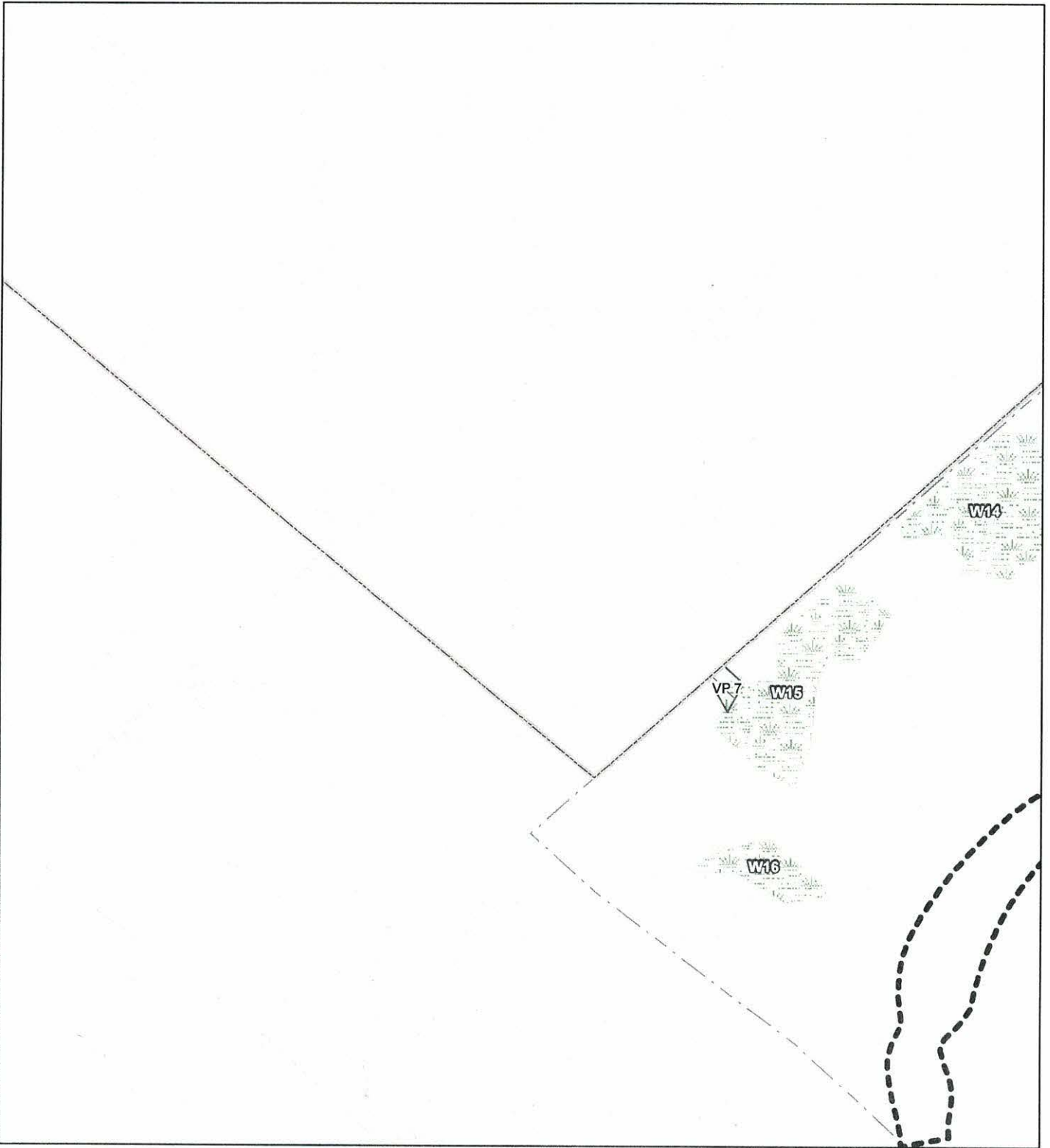

<p>Index Map Map 11 of 11</p>	Proposed Landfill Area Proposed Stormwater Pipe Proposed Grasslined Swale Limit of Disturbance WMDSM Facility Site Boundary Permanent Vernal Pool Impact Permanent Wetland Impact Temporary Wetland Impact 10-12' Bottomless Culvert (No Impacts)	Intermittent Ephemeral Field Delineated Vernal Pools Limit of Wetland/Stream/VP Survey Rip-Rap Pad Field Delineated Wetlands	<p>Wetland and Stream Impact Map Waste Management Disposal Services of Maine, Inc. Phase 14 Project Crossroads Landfill Norridgewock, Maine Date: 7/22/2020</p> <p>1 inch = 100 feet</p> <p>Source Aerial imagery provided by ESRI</p>
-----------------------------------	---	--	--

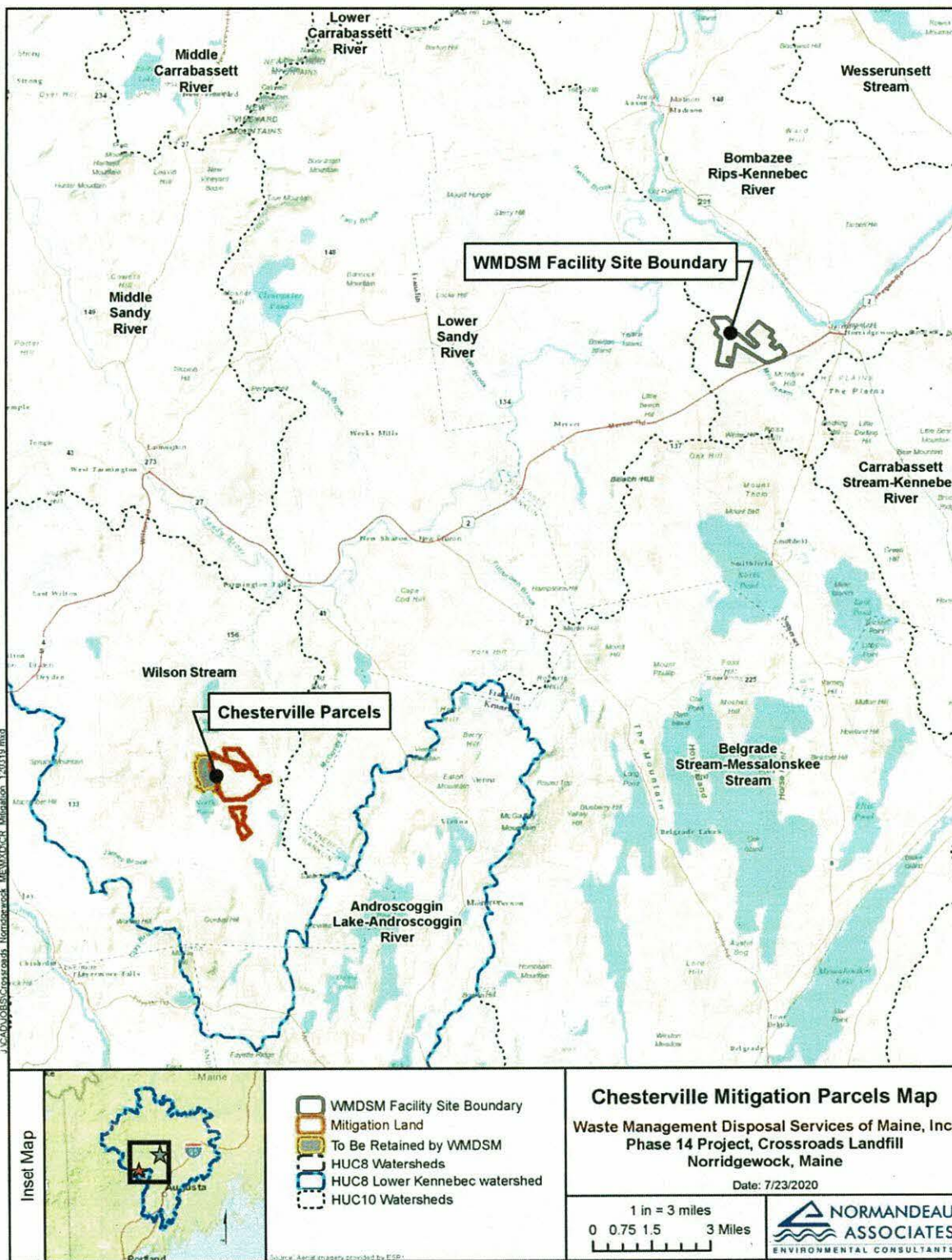

Figure 2-1. Chesterville Mitigation Parcels Map.

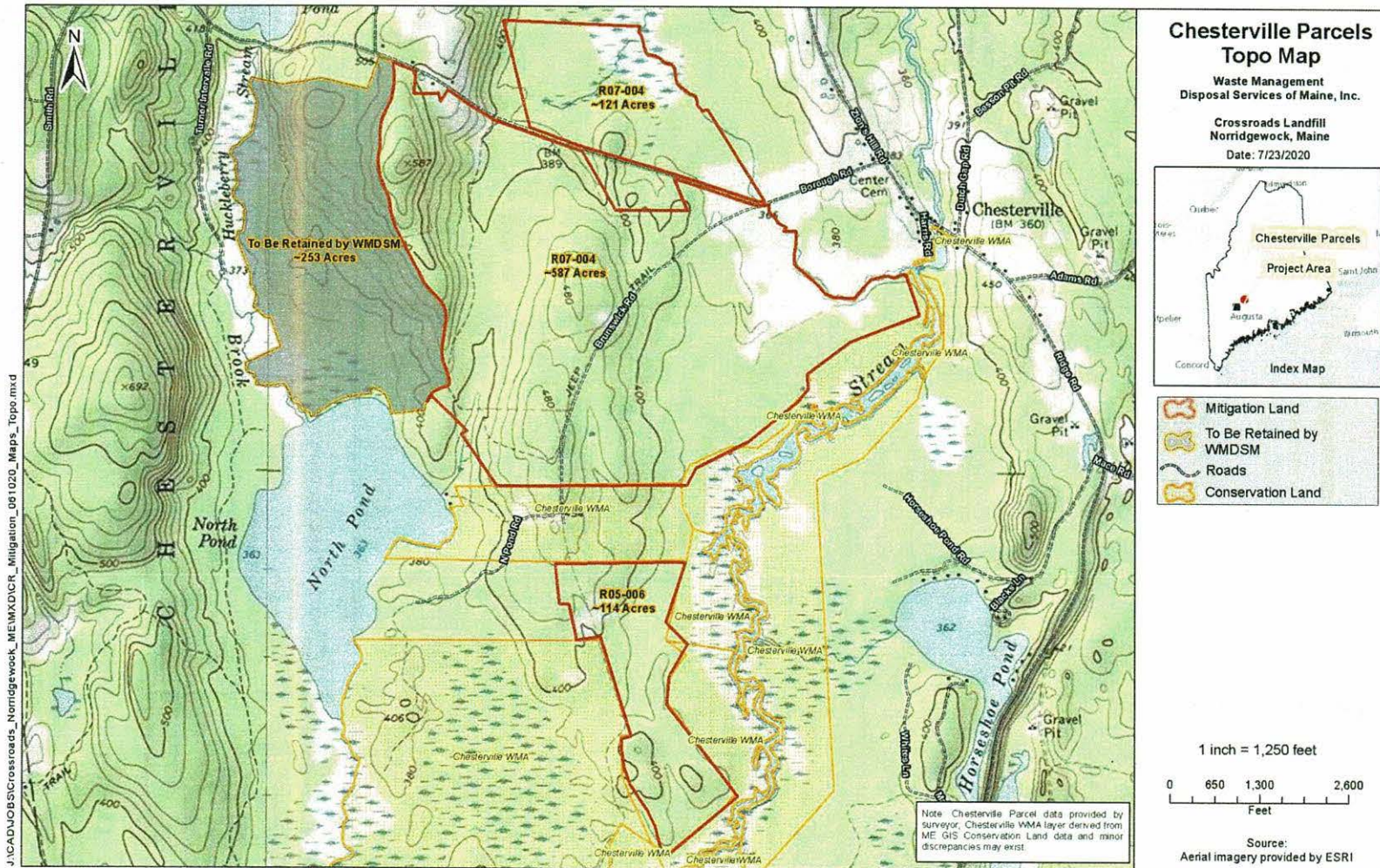

Figure 2-2. Chesterville Parcels Topo Map.