



**US Army Corps  
of Engineers®**  
New England District  
696 Virginia Road  
Concord, MA 01742-2751

# PUBLIC NOTICE

**Comment Period Begins: April 2, 2019**

**Comment Period Ends: May 2, 2019**

**File Number: NAE-2017-01616**

**In Reply Refer To: Mike Wierbonics**

**Phone: (978) 318-8723**

**E-mail:**

michael.s.wierbonics@usace.army.mil

The District Engineer has received a permit application to conduct work in waters of the United States from the Town of Oak Bluffs, Massachusetts, 56 School Street, P.O. Box 1327, Oak Bluffs, Massachusetts. This work is proposed along the northeastern shoreline of Oak Bluffs seaward of East Chop Road in Nantucket Sound, Oak Bluffs, Massachusetts. The site coordinates are: Latitude: 41.46644 Longitude: -70.561225.

The project involves the discharge of approximately 11,158 cubic yards (CY) of rip rap material over an approximately 34,500 square foot area below the high tide line (HTL) for the rehabilitation/expansion of an existing, deteriorated stone revetment to mitigate future erosion of the bluff.

The work is shown on the enclosed plans entitled "PROPOSED EAST CHOP BLUFF REPAIR EAST CHOP BLUFF TOWN OF OAK BLUFFS 56 SCHOOL STREET OAK BLUFFS, MA 02557," on thirteen sheets, and dated "1/10/19".

The applicant has taken measures to reduce impacts to Waters of the United States (WOUS) by limiting seaward encroachment to maximum extent practicable to achieve the project purpose. A majority of the proposed rehabilitation will occur within the historic and existing footprint of the revetment.

## **AUTHORITY**

Permits are required pursuant to:

- Section 10 of the Rivers and Harbors Act of 1899
- Section 404 of the Clean Water Act
- Section 103 of the Marine Protection, Research and Sanctuaries Act.

The decision whether to issue a permit will be based on an evaluation of the probable impact of the proposed activity on the public interest. That decision will reflect the national concern for both protection and utilization of important resources. The benefit which may reasonably accrue from the proposal must be balanced against its reasonably foreseeable detriments. All factors which may be relevant to the proposal will be considered, including the cumulative effects thereof; among those are: conservation, economics, aesthetics, general environmental concerns, wetlands, cultural value, fish and wildlife values, flood hazards, flood plain value, land use, navigation, shoreline erosion and accretion, recreation, water supply and conservation, water quality, energy needs, safety, food production and, in general, the needs and welfare of the people.

The U.S. Army Corps of Engineers, New England District (Corps), is soliciting comments from the public; Federal, state, and local agencies and officials; Indian Tribes; and other interested parties in order to consider and evaluate the impacts of this proposed activity. The Corps will consider all comments received to determine

CENAE-R

FILE NO. NAE-2017-01616

## OTHER GOVERNMENT AUTHORIZATIONS

The states of Connecticut, Maine, Massachusetts, New Hampshire and Rhode Island have approved Coastal Zone Management Programs. Where applicable, the applicant states that any proposed activity will comply with and will be conducted in a manner that is consistent with the approved Coastal Zone Management Program. By this Public Notice, we are requesting the State concurrence or objection to the applicant's consistency statement.

The following authorizations have been applied for, or have been, or will be obtained:

- (X) Permit, license or assent from State.
- (X) Permit from local wetland agency or conservation commission.
- (X) Water Quality Certification in accordance with Section 401 of the Clean Water Act.

## COMMENTS

In order to properly evaluate the proposal, we are seeking public comment. Anyone wishing to comment is encouraged to do so. Comments should be submitted in writing by the above date. If you have any questions, please contact Mike Wierbonics at (978) 318-8723, (800) 343-4789 or (800) 362-4367, if calling from within Massachusetts.

Any person may request, in writing, within the comment period specified in this notice, that a public hearing be held to consider the application. Requests for a public hearing shall specifically state the reasons for holding a public hearing. The Corps holds public hearings for the purpose of obtaining public comments when that is the best means for understanding a wide variety of concerns from a diverse segment of the public.

The initial determinations made herein will be reviewed in light of facts submitted in response to this notice. All comments will be considered a matter of public record. Copies of letters of objection will be forwarded to the applicant who will normally be requested to contact objectors directly in an effort to reach an understanding.

**THIS NOTICE IS NOT AN AUTHORIZATION TO DO ANY WORK.**

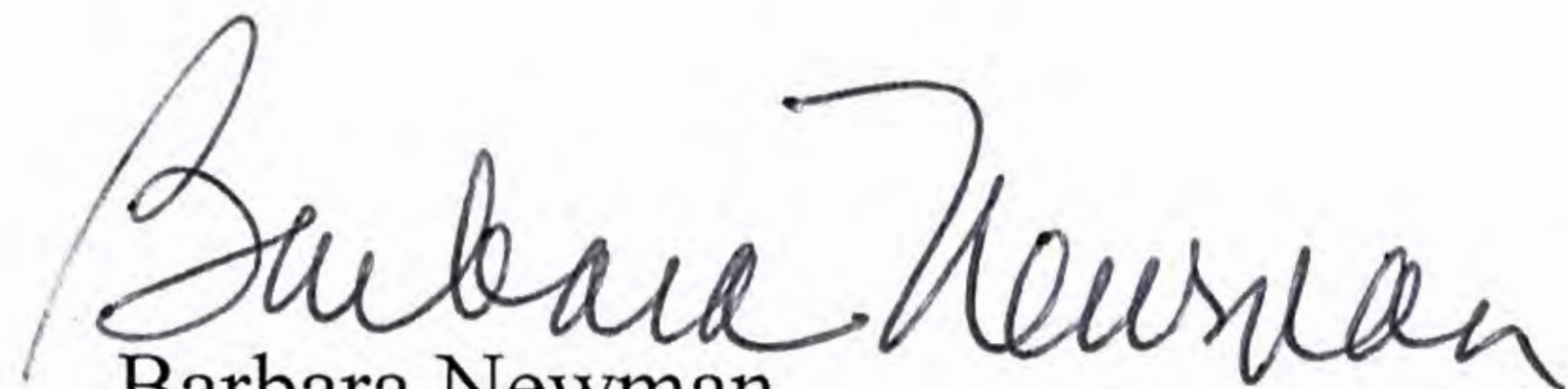

Barbara Newman  
Chief, Permits and Enforcement Branch  
Regulatory Division

**CENAE-R**  
**FILE NO. NAE-2017-01616**

If you would prefer not to continue receiving Public Notices by email, please contact Ms. Tina Chaisson at (978) 318-8058 or e-mail her at [bettina.m.chaisson@usace.army.mil](mailto:bettina.m.chaisson@usace.army.mil). You may also check here ( ) and return this portion of the Public Notice to: Bettina Chaisson, Regulatory Division, U.S. Army Corps of Engineers, 696 Virginia Road, Concord, MA 01742-2751.

NAME: \_\_\_\_\_

ADDRESS: \_\_\_\_\_

PHONE: \_\_\_\_\_

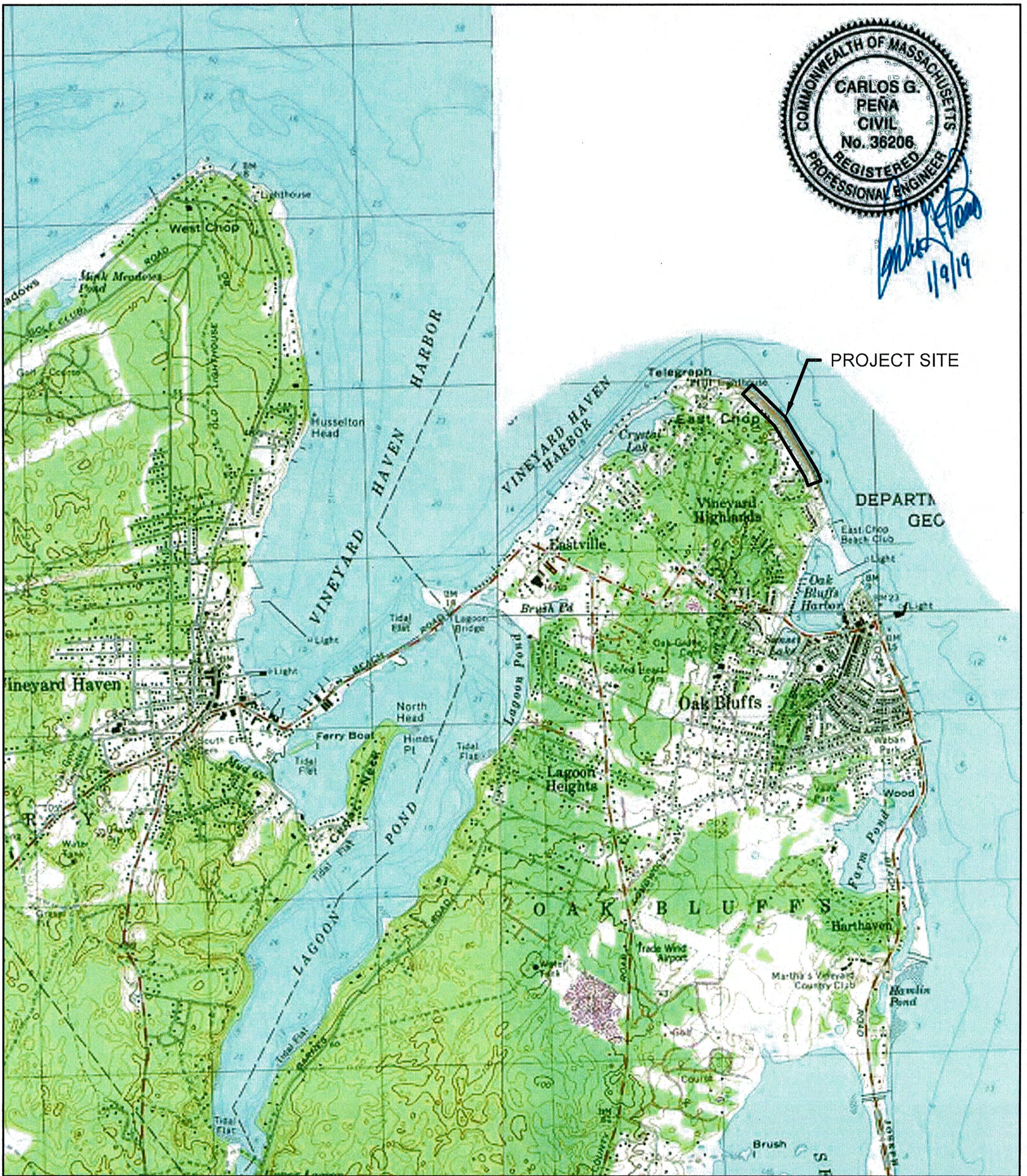
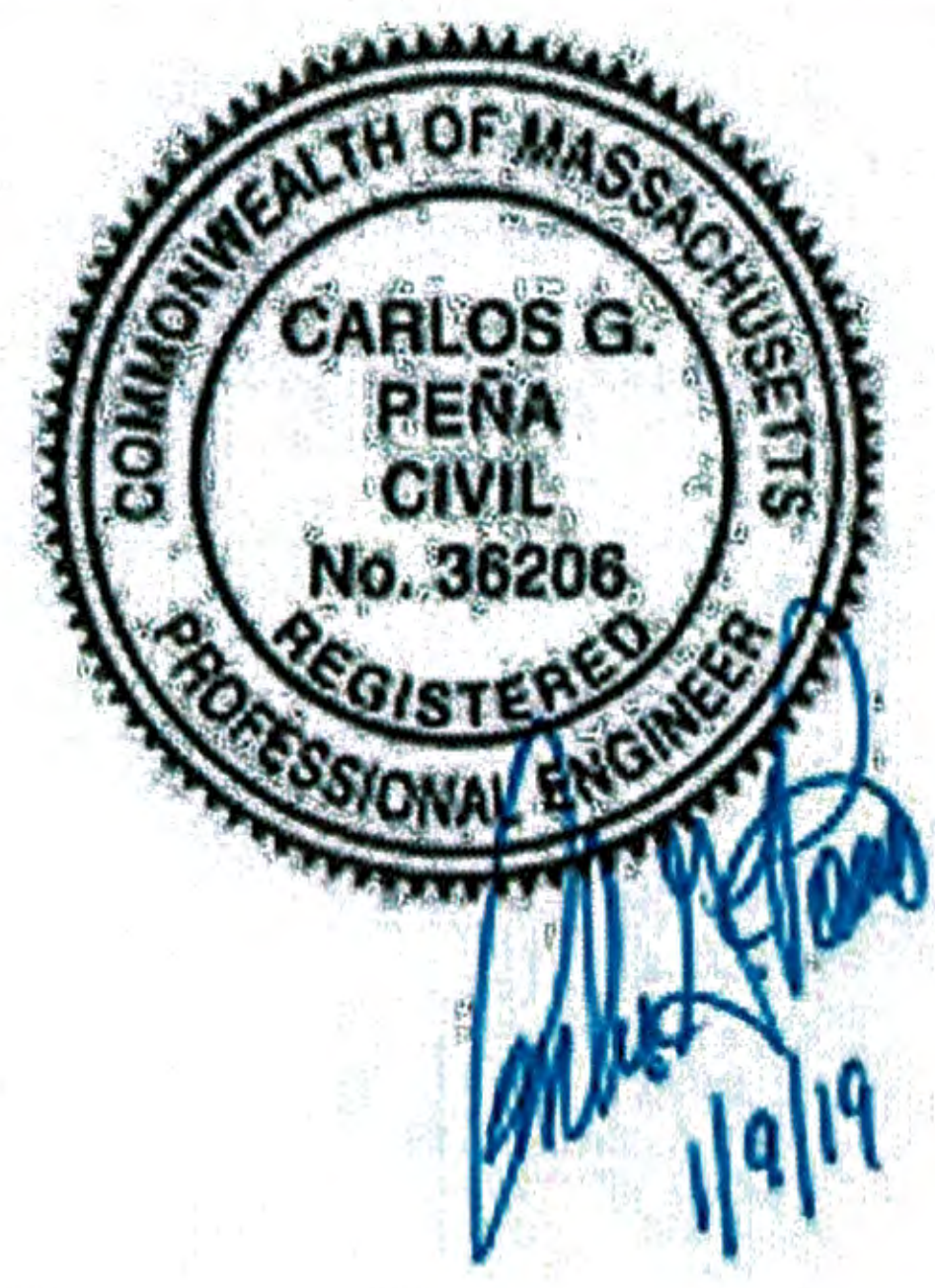

DATUM: NGVD29  
 MLW = -0.56'  
 MHW = +1.14'  
 NGVD29 = 0.00'  
 AHTL = +1.54'

FOTH-CLE ENGINEERING GROUP  
 15 CREEK ROAD  
 MARION MA, 02738

LOCUS MAP  
 NOT TO SCALE

PROPOSED EAST CHOP BLUFF REPAIR

EAST CHOP BLUFF

TOWN OF OAK BLUFFS  
 56 SCHOOL STREET  
 OAK BLUFFS, MA 02557

DATE: 1/10/19

SHEET 1 OF 13

NANTUCKET SOUND

EXISTING RIP-RAP

EXISTING VEGETATED COASTAL BANK

EAST CHOP DRIVE

EXISTING JETTY



*Handwritten signature and date 1/9/19*

DATUM: NGVD29  
MLW = -0.56'  
MHW = +1.14'  
NGVD29 = 0.00'  
AHTL = +1.54'

FOTH-CLE ENGINEERING GROUP  
15 CREEK ROAD  
MARION MA, 02738

**SITE OVERVIEW**

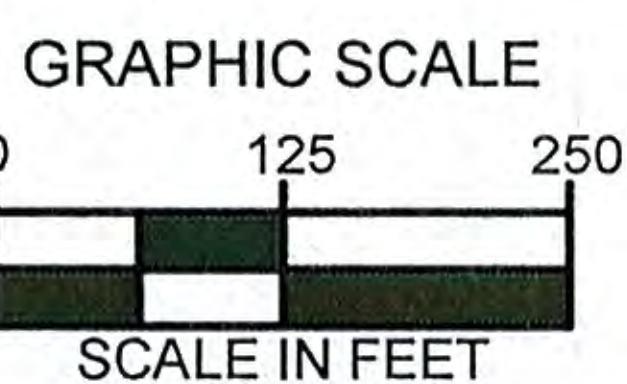

PROPOSED EAST CHOP BLUFF REPAIR

EAST CHOP BLUFF

TOWN OF OAK BLUFFS  
56 SCHOOL STREET  
OAK BLUFFS, MA 02557

DATE: 1/10/19

SHEET 2 OF 13

c:\pw\_work\kai\pw\_le\lvd\_cff1\0259288106027\_east\_chop\_design\_plan\_ch91

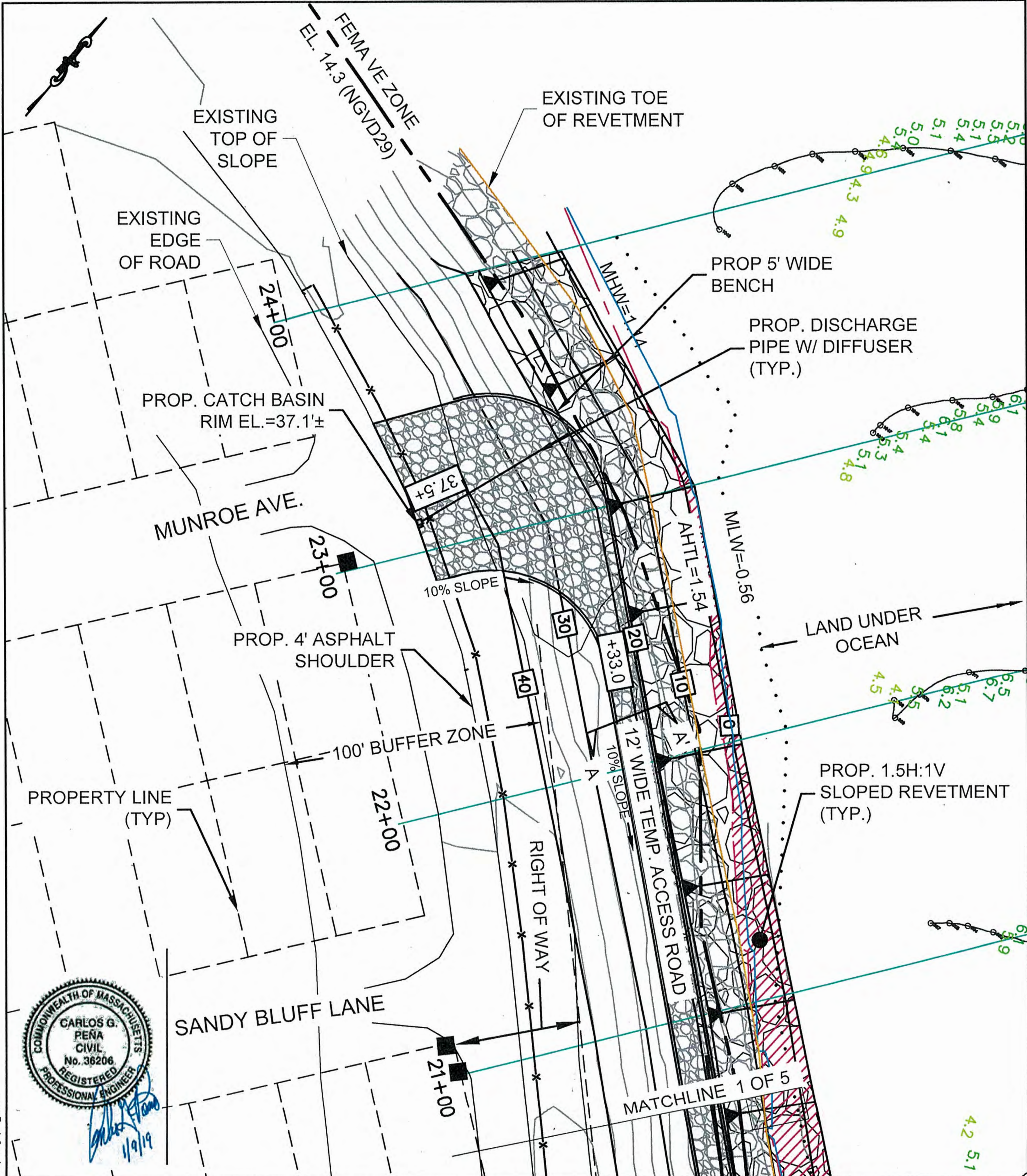

DATUM: NGVD29  
 MLW = -0.56'  
 MHW = +1.14'  
 NGVD29 = 0.00'  
 AHTL = +1.54'

Foth Infrastructure and Environment, LLC  
 15 CREEK ROAD  
 MARION MA, 02738

**SITE PLAN  
 PLAN VIEW**

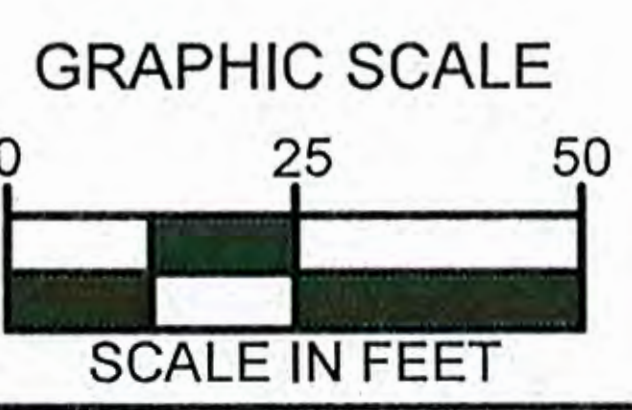

**PROPOSED EAST CHOP BLUFF REPAIR**

EAST CHOP BLUFF  
 TOWNS OF OAK BLUFFS  
 56 SCHOOL STREET  
 OAK BLUFFS, MA 02557

DATE: OCTOBER 3, 2018

SHEET 3 OF 13

c:\pwworking\foth\meca\30029288\05027\_east\_chop\_design\_plan\_acor1

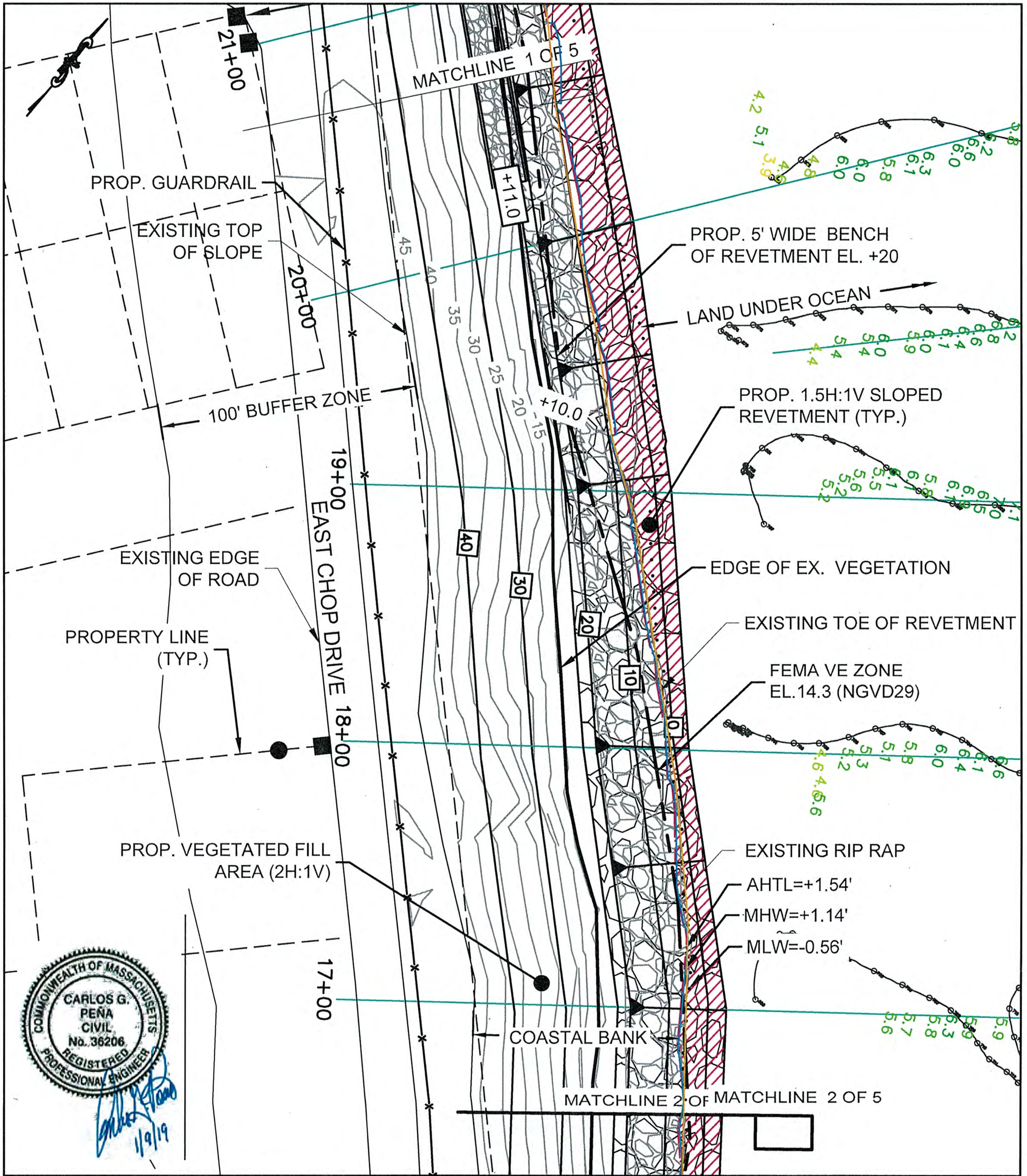

DATUM: NGVD29  
 MLW = -0.56'  
 MHW = +1.14'  
 NGVD29 = 0.00'  
 AHTL = +1.54'

Foth Infrastructure and Environment, LLC  
 15 CREEK ROAD  
 MARION MA, 02738

**SITE PLAN  
 PLAN VIEW**

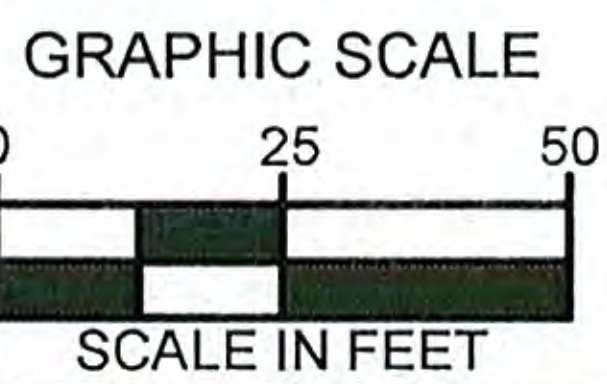

**PROPOSED EAST CHOP BLUFF REPAIR**

EAST CHOP BLUFF

TOWNS OF OAK BLUFFS  
 56 SCHOOL STREET  
 OAK BLUFFS, MA 02557

DATE: OCTOBER 3, 2018

SHEET 4 OF 13

c:\pwworkdir\pwworkdir\1014\fd\_mec3\0259288\09027\_east\_chop\_design\_plan\_acoe.r1

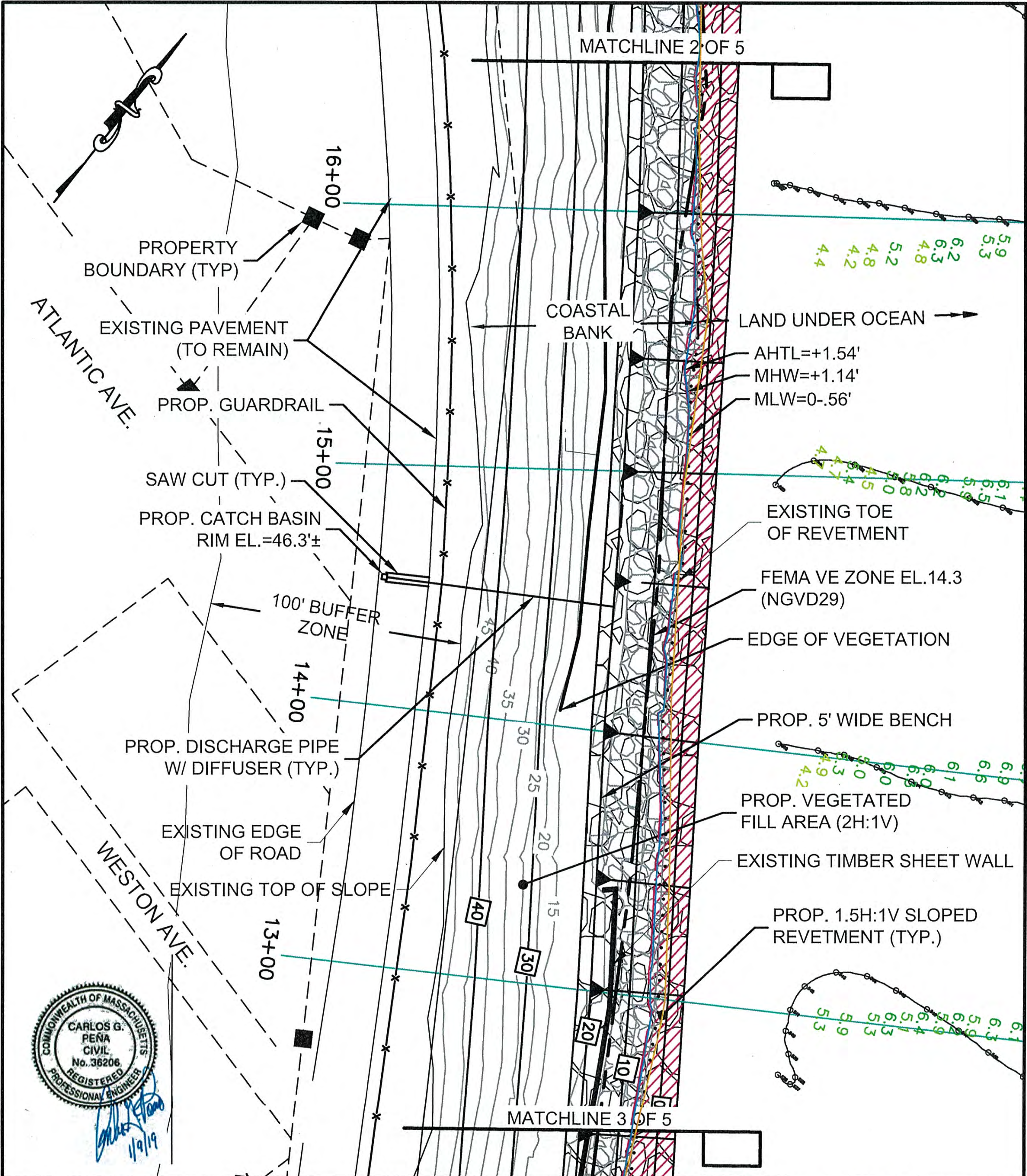

DATUM: NGVD29  
 MLW = -0.56'  
 MHW = +1.14'  
 NGVD29 = 0.00'  
 AHTL = +1.54'

Foth Infrastructure and Environment, LLC  
 15 CREEK ROAD  
 MARION MA, 02738

**SITE PLAN  
 PLAN VIEW**

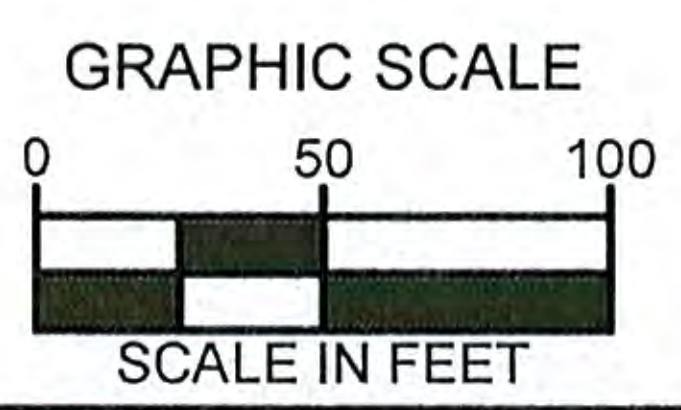

**PROPOSED EAST CHOP BLUFF REPAIR**

EAST CHOP BLUFF  
 TOWNS OF OAK BLUFFS  
 56 SCHOOL STREET  
 OAK BLUFFS, MA 02557

DATE: OCTOBER 3, 2018

SHEET 5 OF 13

c:\pwworkdir\pwworkdir\infv\mec3\0256288\09027\_east\_chop\_design\_plan\_accor1



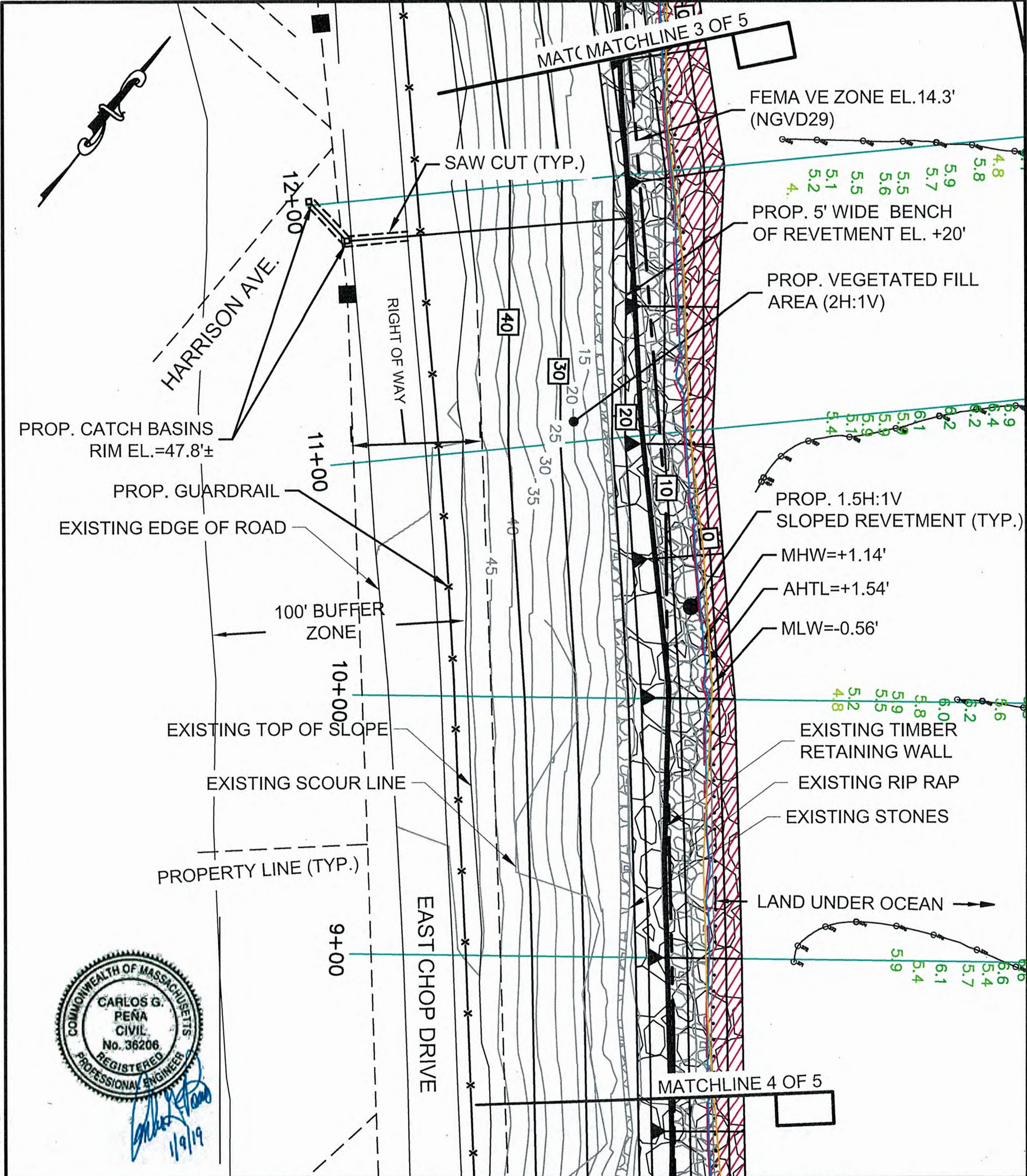

DATUM: NGVD29  
 MLW = -0.56'  
 MHW = +1.14'  
 NGVD29 = 0.00'  
 AHTL = +1.54'

Foth Infrastructure and Environment, LLC  
 15 CREEK ROAD  
 MARION MA, 02738

**SITE PLAN**

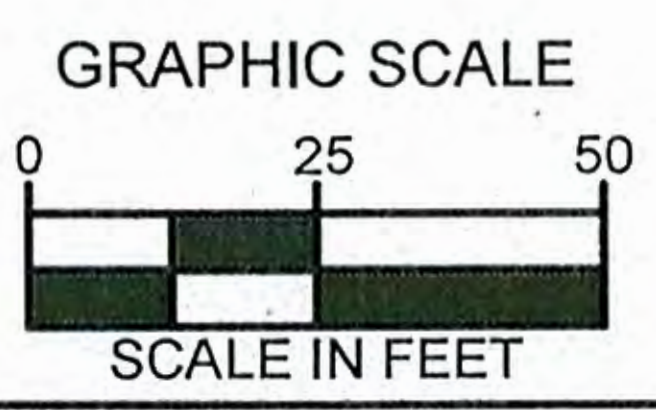

**PROPOSED EAST CHOP BLUFF REPAIR**

EAST CHOP BLUFF  
 TOWNS OF OAK BLUFFS  
 56 SCHOOL STREET  
 OAK BLUFFS, MA 02557

DATE: OCTOBER 3, 2018

SHEET 6 OF 13

c:\pwworkdir\fw\_101\fd\_mec3\02525288\05027\_east chop design plan\_ace.r1



*Signature*  
1/9/19

DRIVE

MATCHLINE 4 OF 5

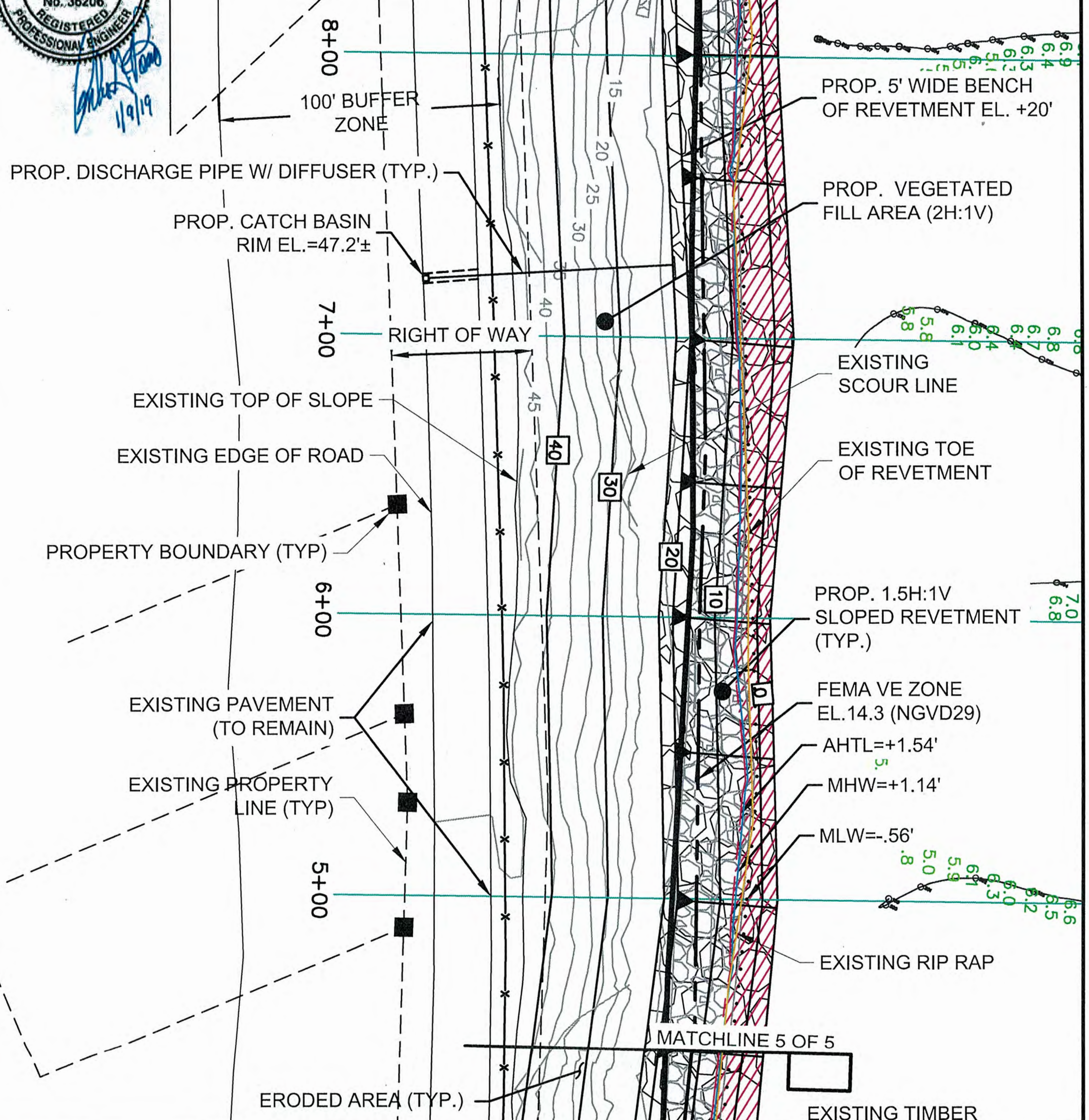

DATUM: NGVD29  
MLW = -0.56'  
MHW = +1.14'  
NGVD29 = 0.00'  
AHTL = +1.54'

Foth Infrastructure and Environment, LLC  
15 CREEK ROAD  
MARION MA, 02738

**SITE PLAN**

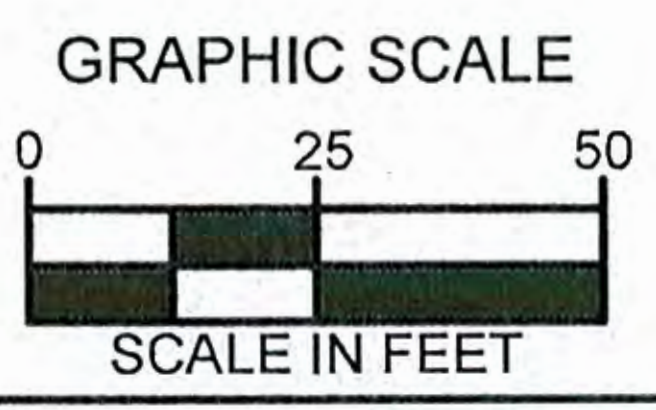

PROPOSED EAST CHOP BLUFF REPAIR

EAST CHOP BLUFF  
TOWNS OF OAK BLUFFS  
56 SCHOOL STREET  
OAK BLUFFS, MA 02557

DATE: OCTOBER 3, 2018

SHEET 7 OF 13

c:\pw\_workdir\pw\_elfvd\_mec3\025288\09027\_east chop design plan\_aace.r1

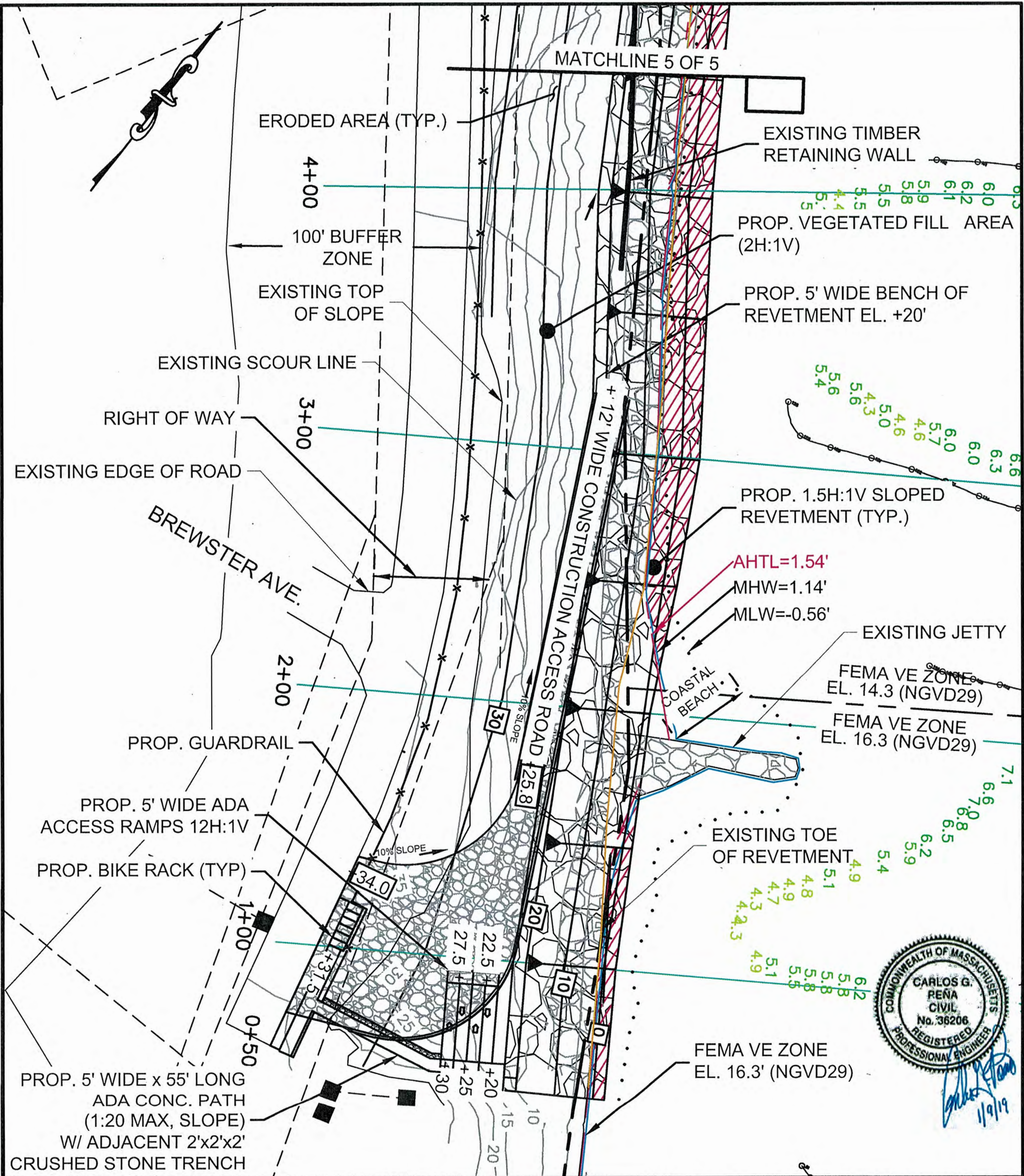

*Handwritten signature and date: 11/19*

DATUM: NGVD29  
 MLW = -0.56'  
 MHW = +1.14'  
 NGVD29 = 0.00'  
 AHTL = +1.54'

Foth Infrastructure and Environment, LLC  
 15 CREEK ROAD  
 MARION MA, 02738

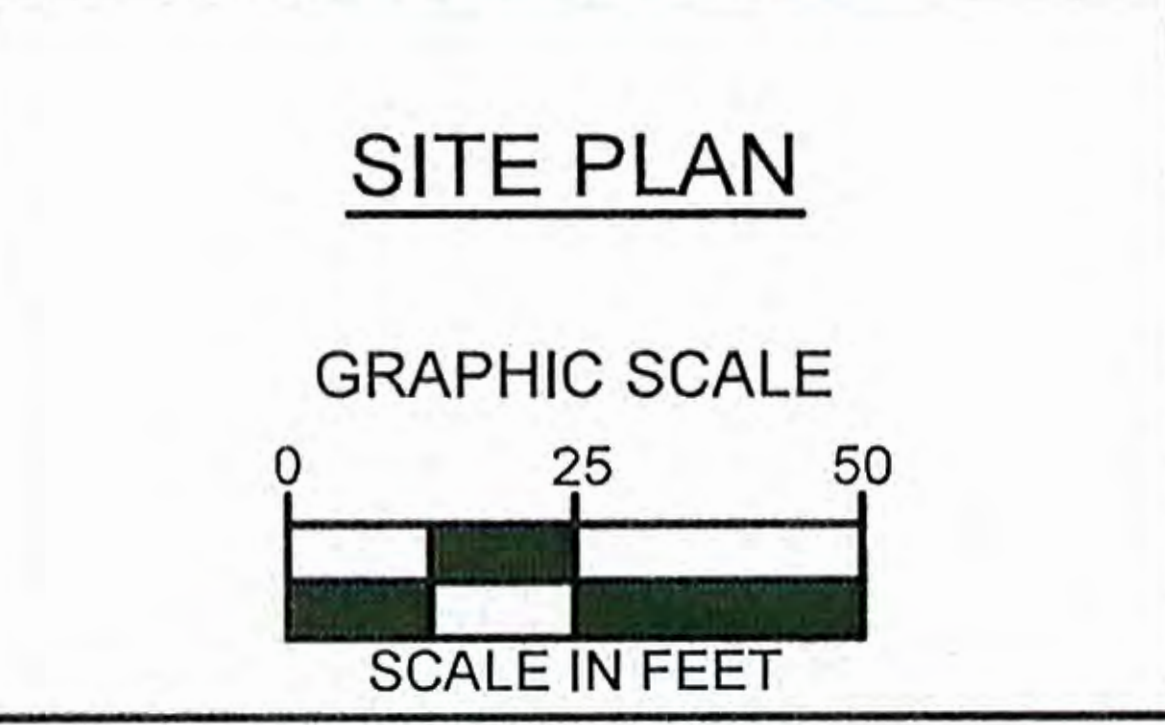

PROPOSED EAST CHOP BLUFF REPAIR

EAST CHOP BLUFF

TOWNS OF OAK BLUFFS  
 56 SCHOOL STREET  
 OAK BLUFFS, MA 02557

DATE: OCTOBER 3, 2018

SHEET 8 OF 13

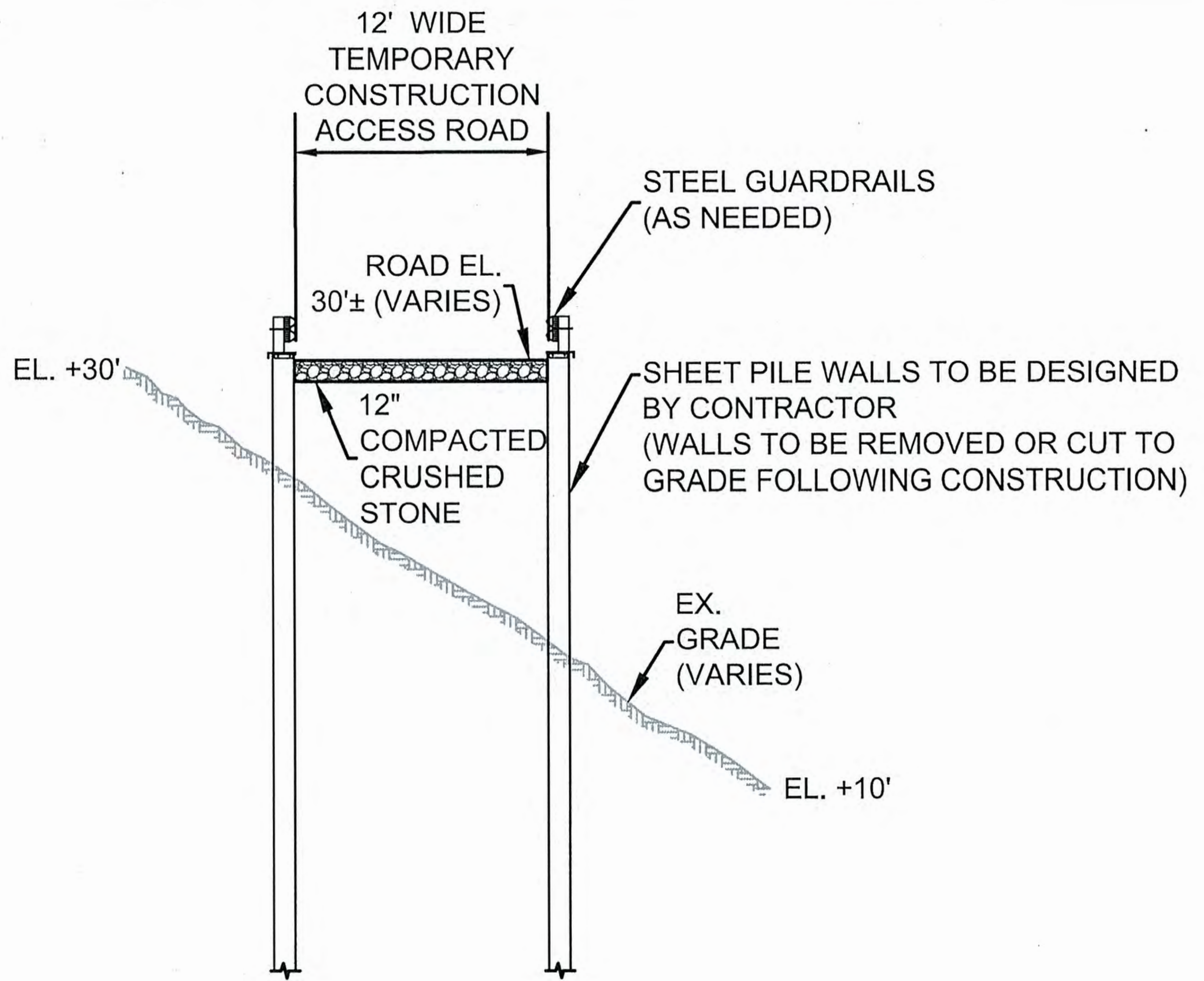

**SECTION A-A'**

SCALE: 1"=10'

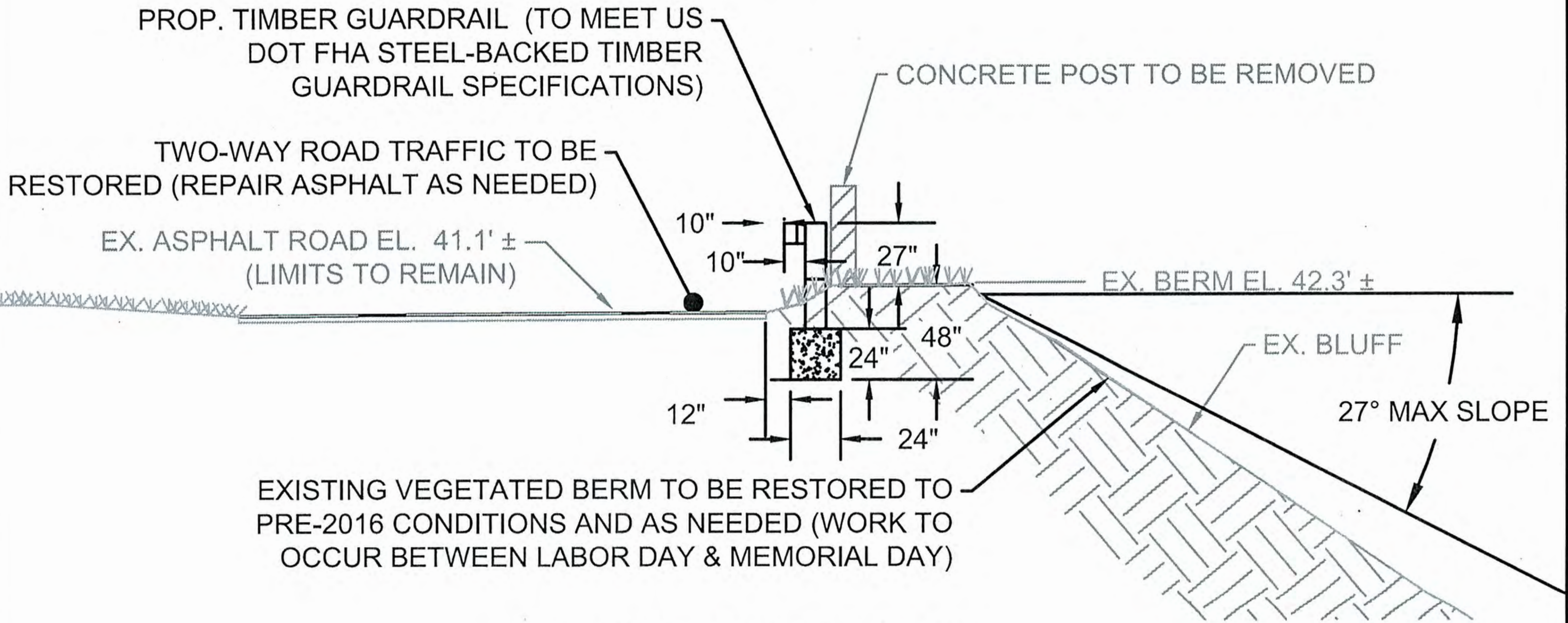

**ASPHALT ROAD DETAIL**

SCALE: 1"=8'

DATUM: NGVD29  
 MLW = -0.56'  
 MHW = +1.14'  
 NGVD29 = 0.00'  
 AHTL = +1.54'

FOTH-CLE ENGINEERING GROUP  
 15 CREEK ROAD  
 MARION MA, 02738

**SECTION & DETAILS**

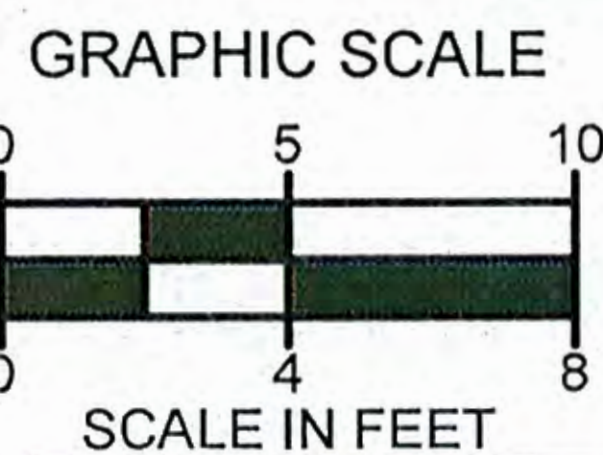

PROPOSED EAST CHOP BLUFF REPAIR

EAST CHOP BLUFF

TOWN OF OAK BLUFFS  
 56 SCHOOL STREET  
 OAK BLUFFS, MA 02557

DATE: 1/10/19

SHEET 9 OF 13

c:\pw\_workdir\pw\_ie\lvd\_cff1\02929280\05027\_east\_chop\_design\_plan\_ch91\_

PROPOSED EAST CHOP BLUFF REPAIR

EAST CHOP BLUFF  
TOWNS OF OAK BLUFFS  
56 SCHOOL STREET  
OAK BLUFFS, MA 02557

SECTION & DETAILS

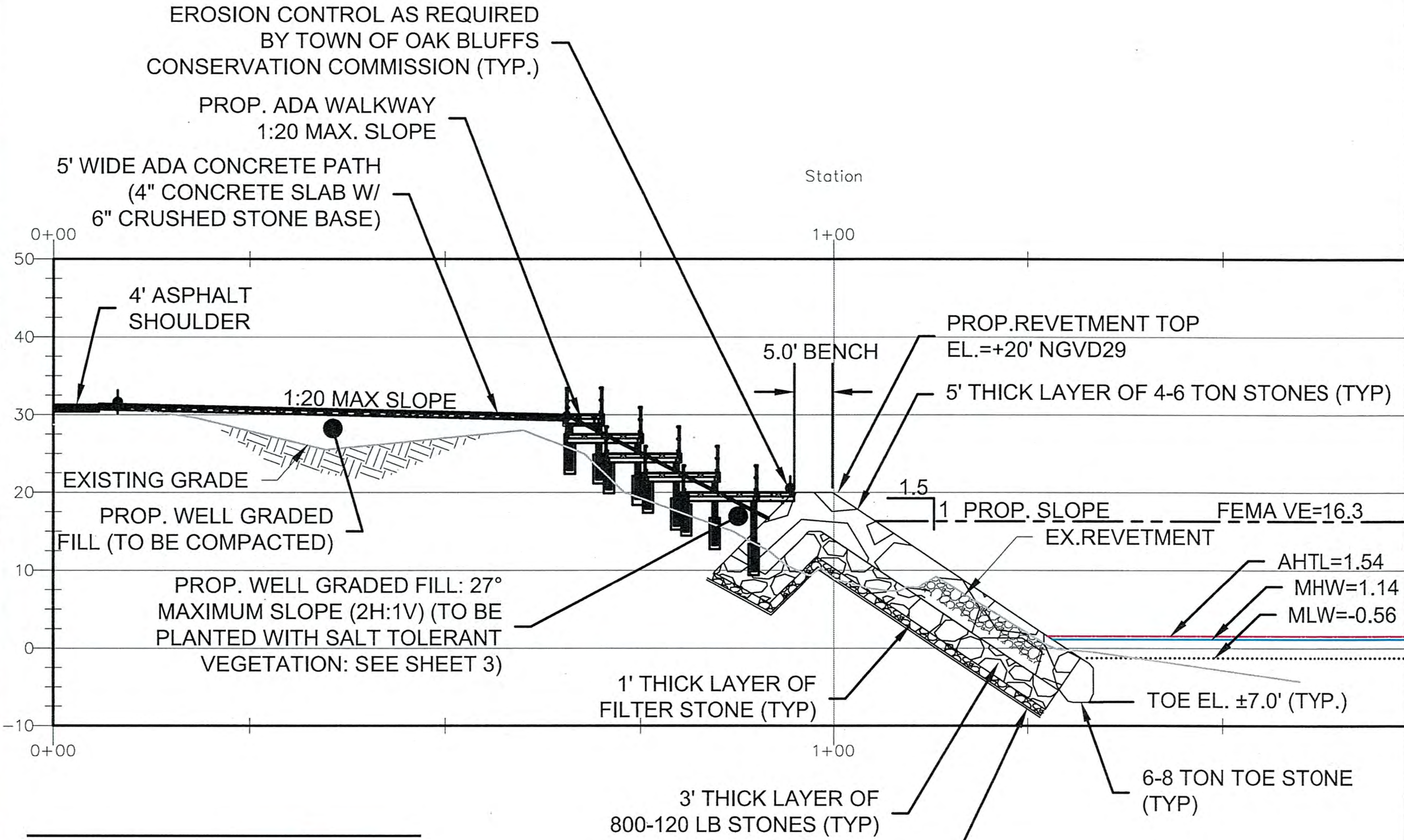

ACCESS RAMP DETAIL

SCALE: 1"=20'

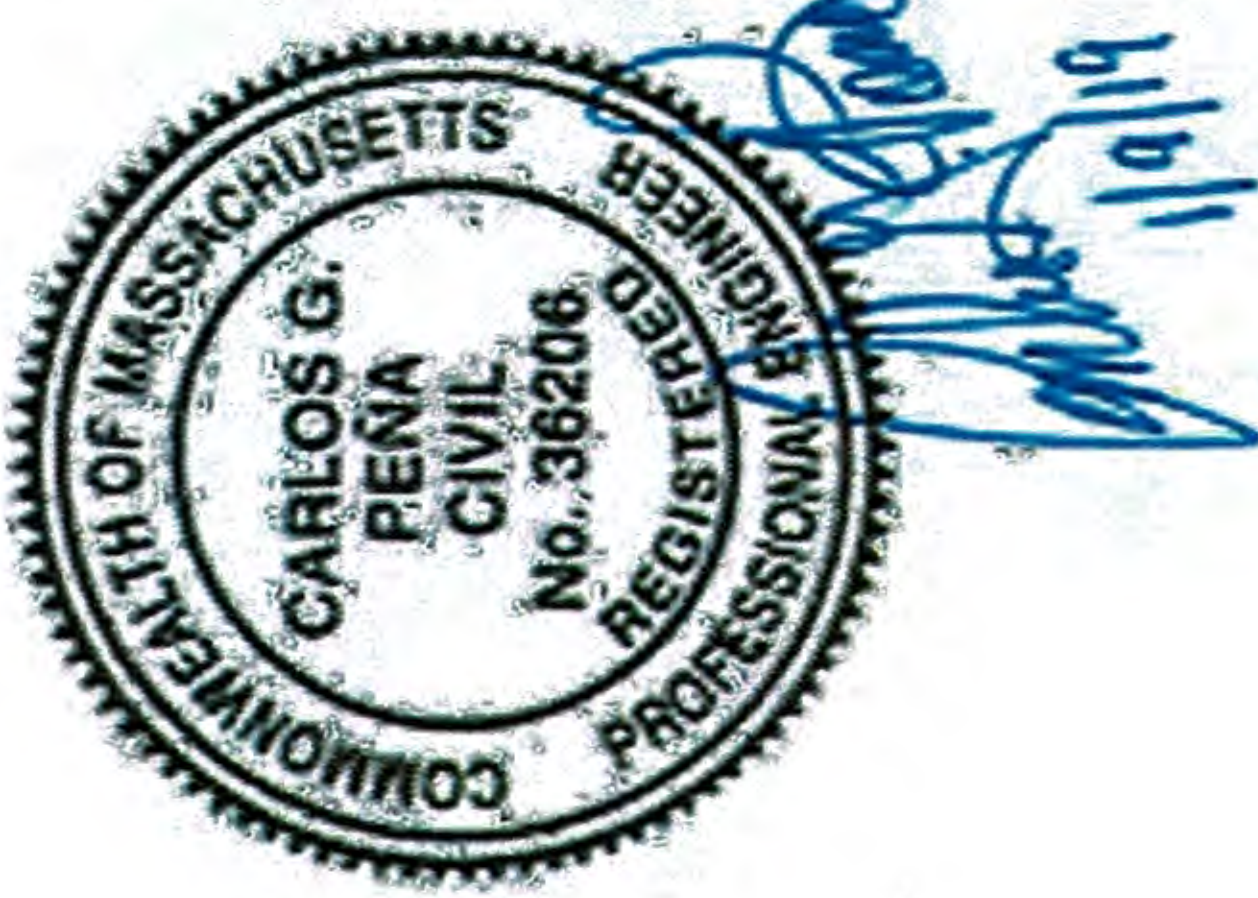

DATUM: NGVD29  
 MLW = -0.56'  
 MHW = +1.14'  
 NGVD29 = 0.00'  
 AHTL = +1.54'

Foth Infrastructure and Environment, LLC  
 15 CREEK ROAD  
 MARION MA, 02738

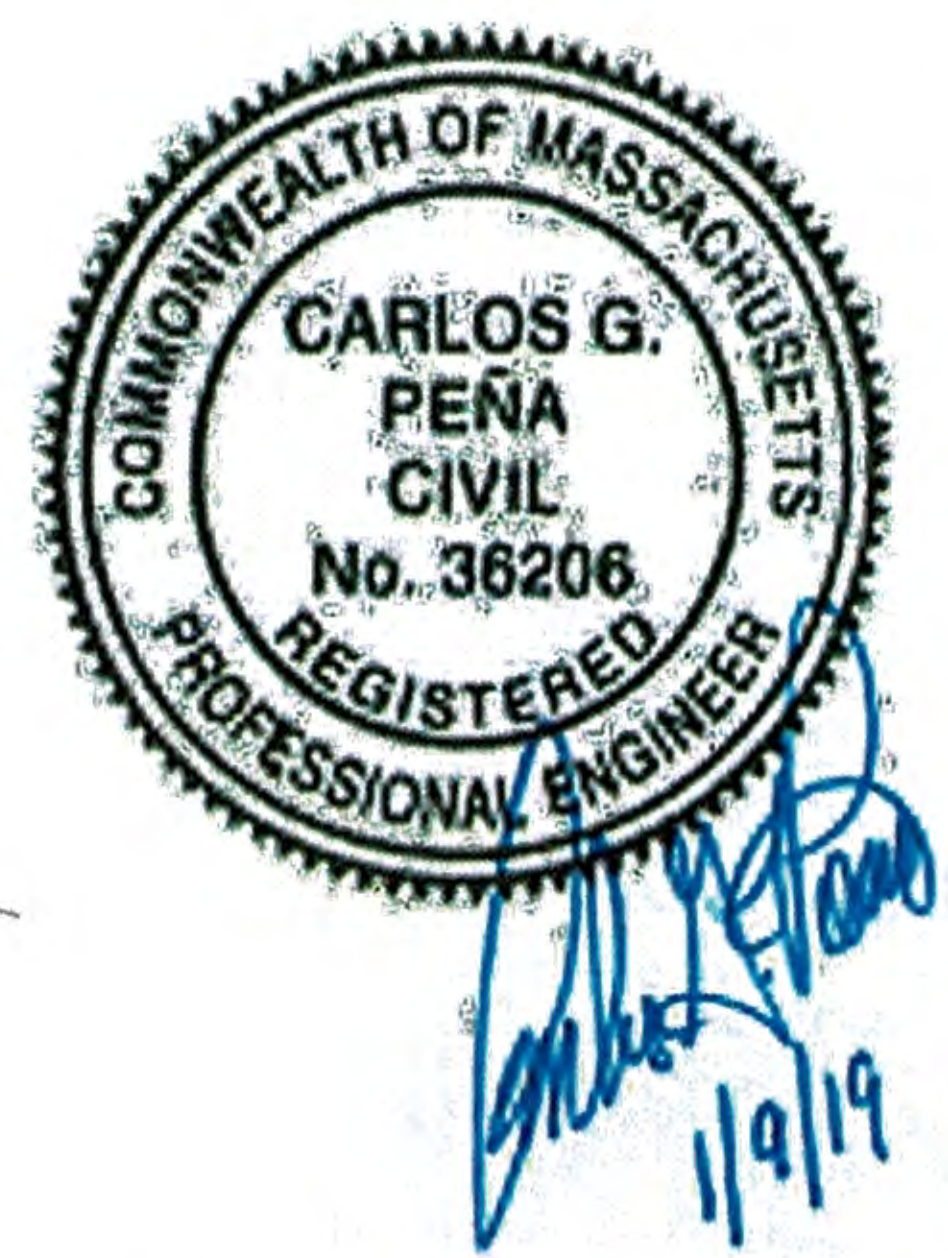
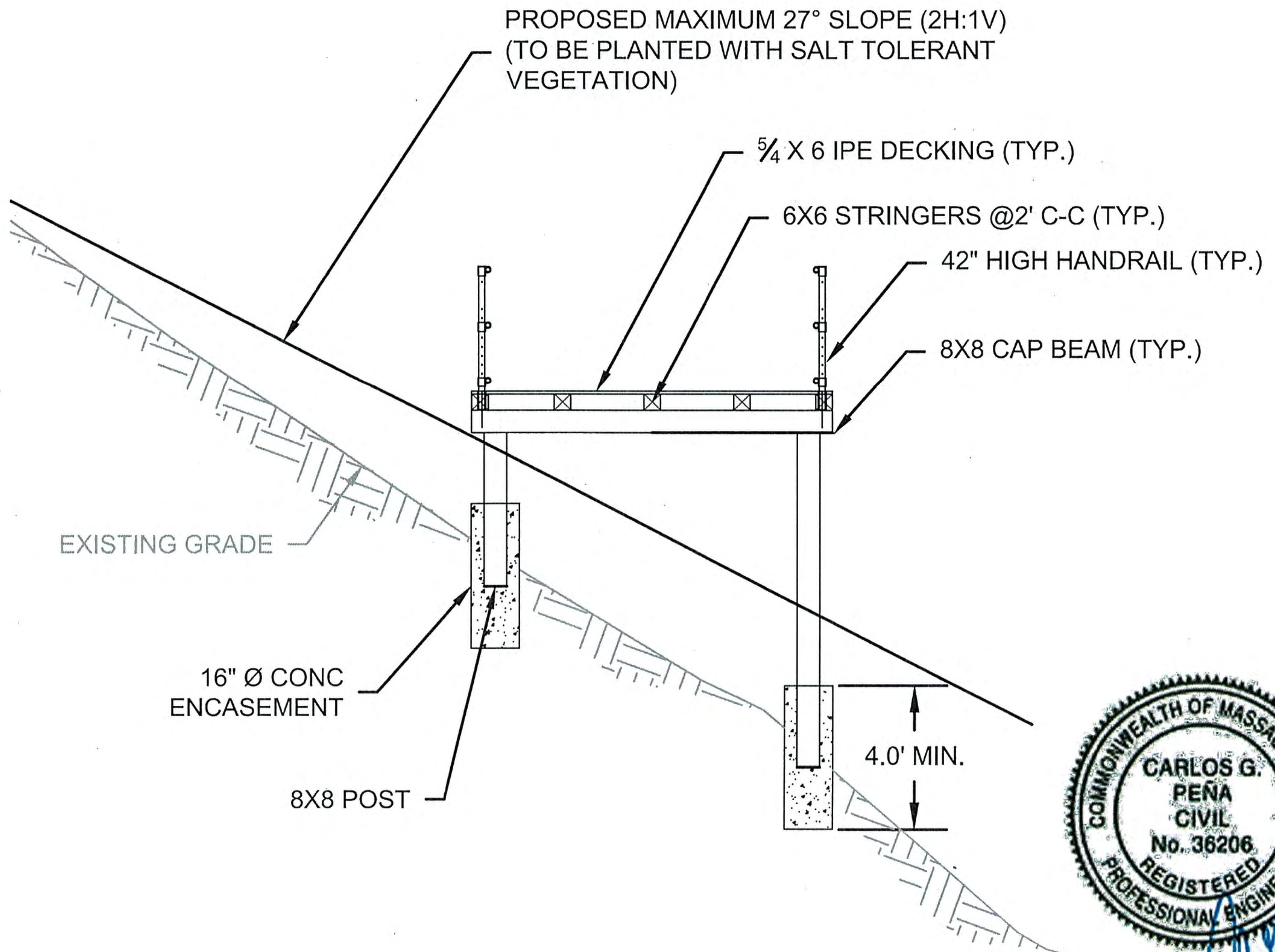

**TYPICAL HORIZONTAL LANDING DETAIL**

SCALE: 1"=5'

DATUM: NGVD29  
 MLW = -0.56'  
 MHW = +1.14'  
 NGVD29 = 0.00'  
 AHTL = +1.54'

FOTH-CLE ENGINEERING GROUP  
 15 CREEK ROAD  
 MARION MA, 02738

**SECTIONS & DETAILS**

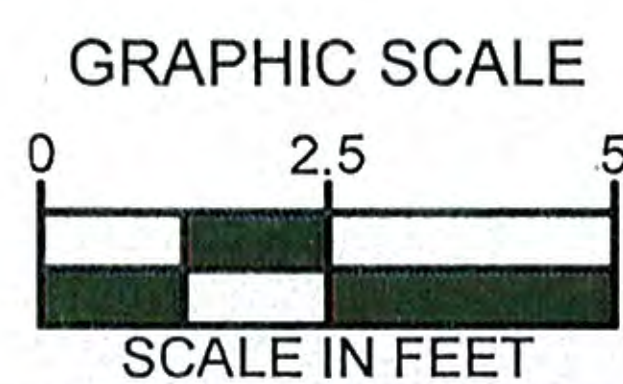

PROPOSED EAST CHOP BLUFF REPAIR

EAST CHOP BLUFF

TOWN OF OAK BLUFFS  
 56 SCHOOL STREET  
 OAK BLUFFS, MA 02557

DATE: 1/10/19

SHEET 11 OF 13

c:\pw\_work\air\pw\_ie\svd\_cff1\02592860\027\_east\_chop\_design\_plan\_ch91

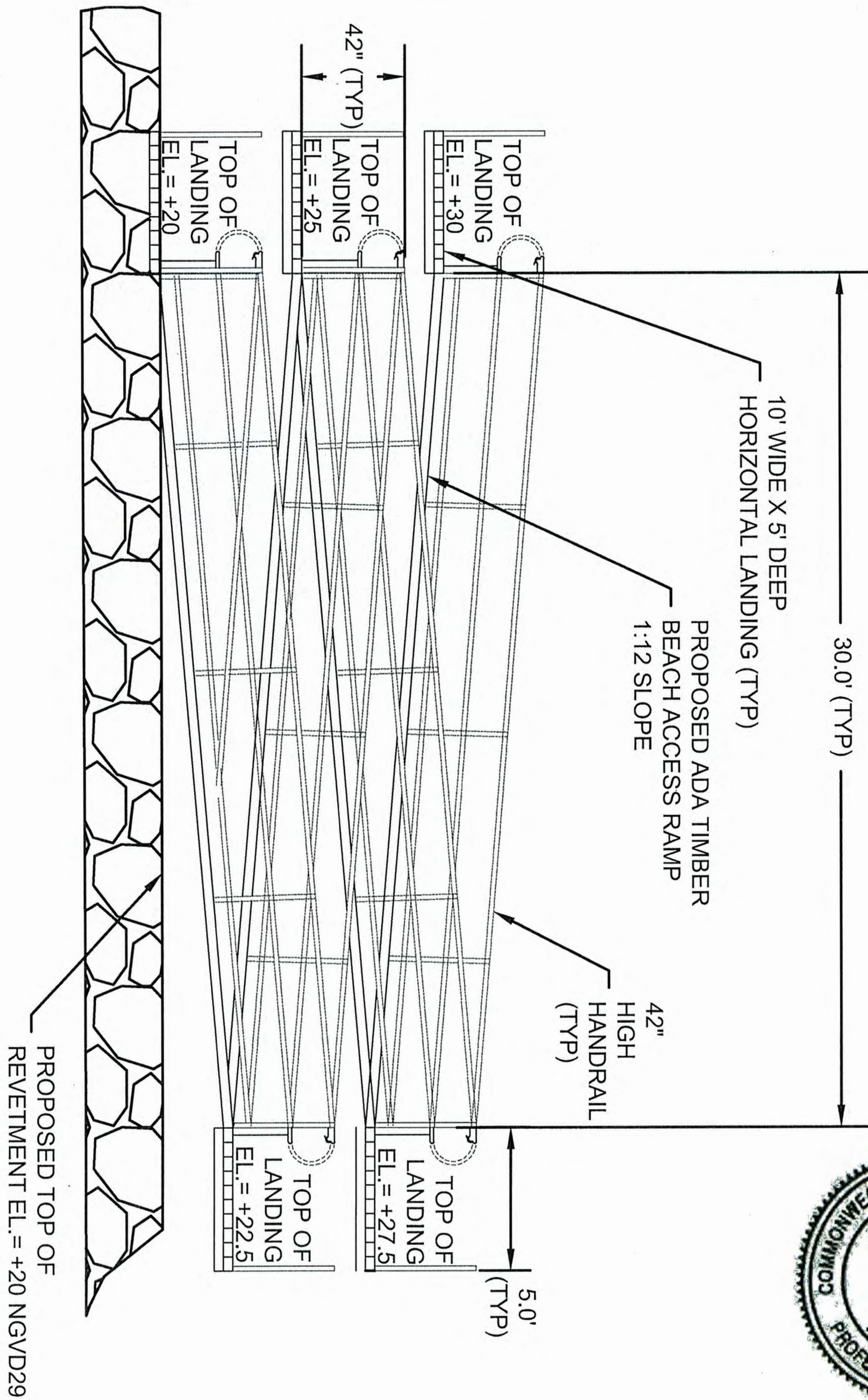

**TYPICAL HORIZONTAL LANDING DETAIL**

SCALE: 1"=5'

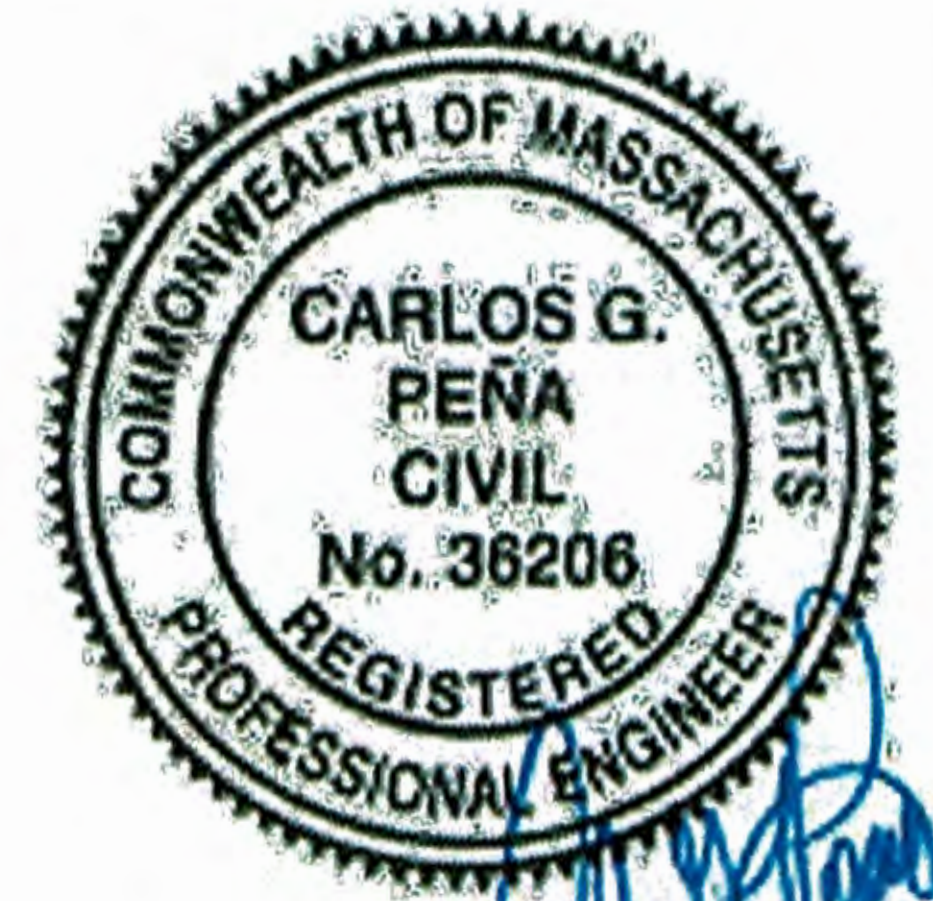

DATUM: NGVD29  
 MLW = -0.56'  
 MHW = +1.14'  
 NGVD29 = 0.00'  
 AHTL = +1.54'

FOTH-CLE ENGINEERING GROUP  
 15 CREEK ROAD  
 MARION MA, 02738

**SECTION & DETAILS**

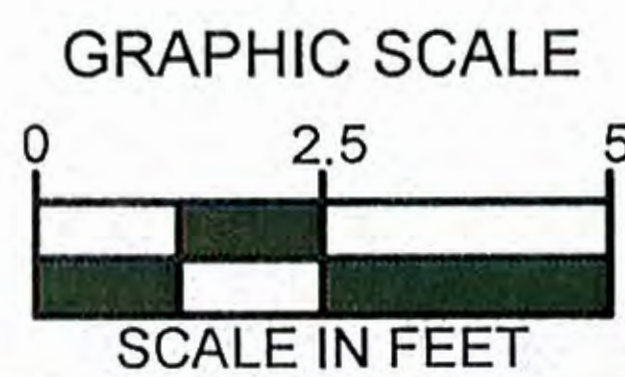

PROPOSED EAST CHOP BLUFF REPAIR

EAST CHOP BLUFF

TOWN OF OAK BLUFFS  
 56 SCHOOL STREET  
 OAK BLUFFS, MA 02557

DATE: 1/10/19

SHEET 12 OF 13

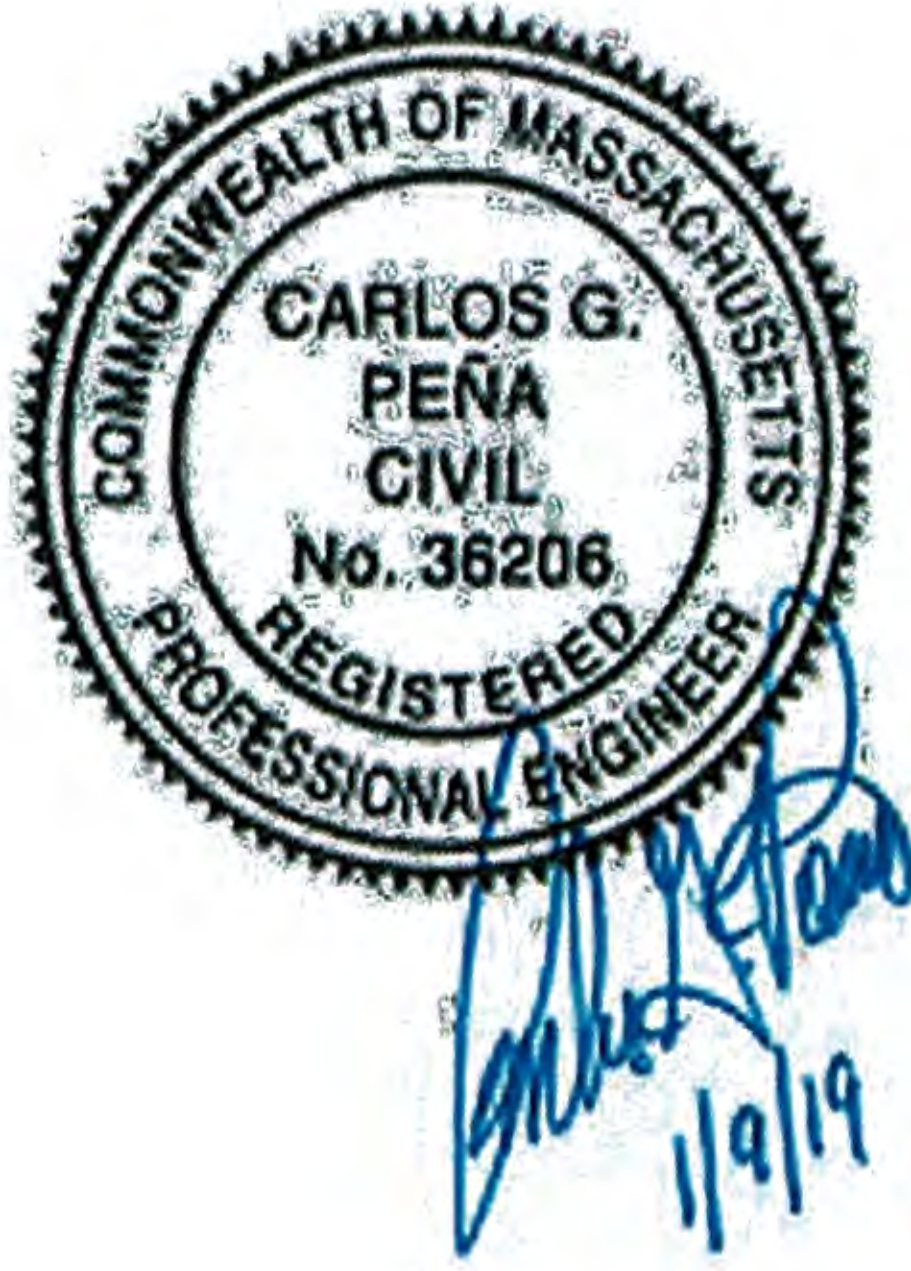

TIDAL DATUM

NGVD29

MLW

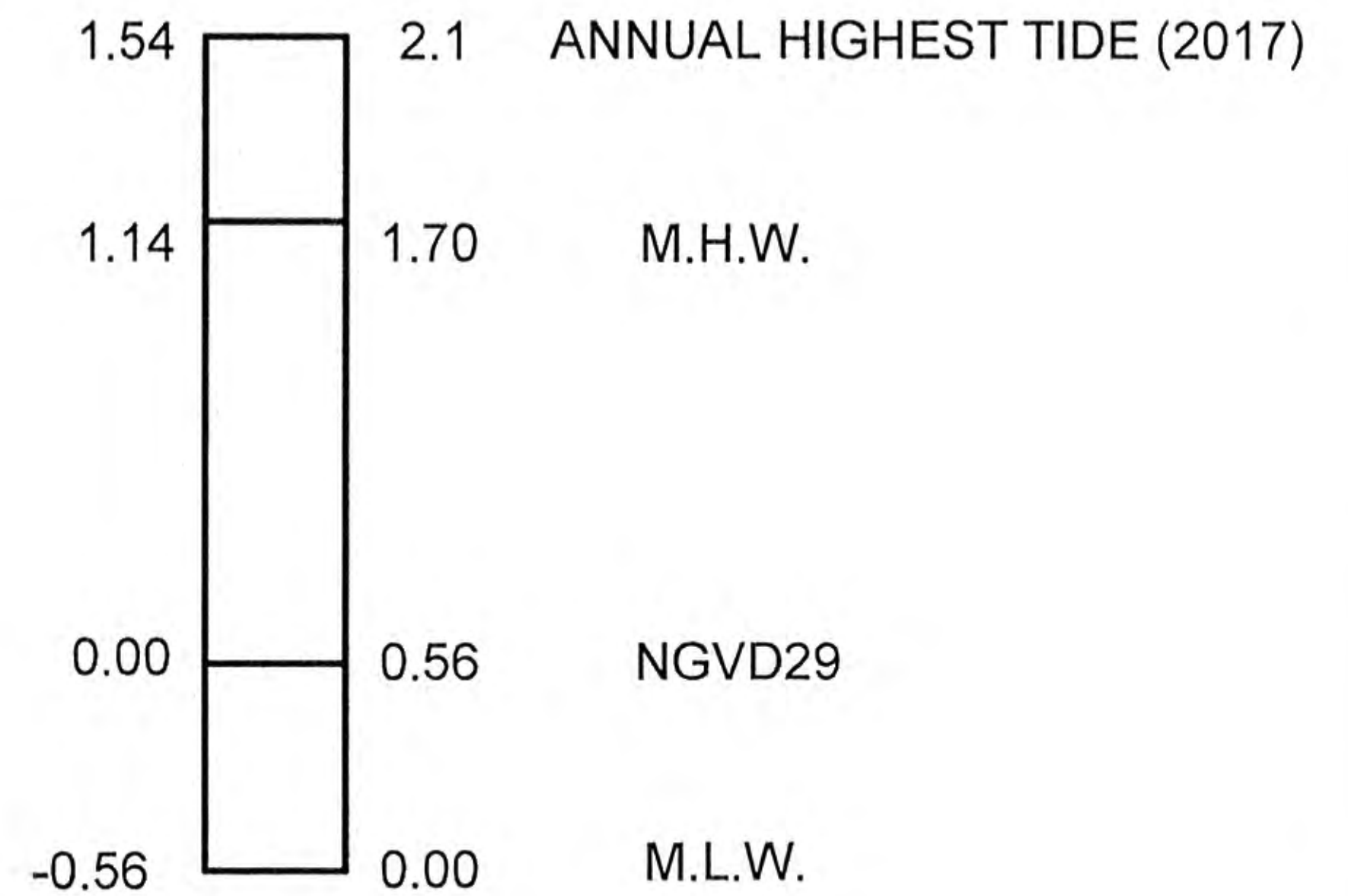

TIDAL OFFSETS FROM  
NOAA TIDE STATION  
OAK BLUFFS #8448208  
AND VDATUM V3.5

**SURVEY NOTES:**

1. PROJECT NAME: HYDROGRAPHIC SURVEY
2. PROJECT NUMBER: 09027.300 & 13021.300
3. PLOT SCALE: 1"=40'
4. SURVEY DATE: SEPTEMBER 14, 2016
5. SURVEYOR: M.COUNT, J. BARANELLO
6. VESSEL: "OLAF"
7. TRANS./FATH.: 200KHZ, 4 DEGREE ODOM CVM
8. WEATHER COND: SUNNY, 60 DEGREES, WIND LIGHT, SEAS CALM
9. PROJECT DATUM: NGVD29
10. COOR. SYSTEM: NAD-83, MA-2001 MASS ISLAND
11. DATA REDUCTION: DATA SORTED WITH 10' RADIUS
12. BENCHMARK: BENCHMARK NO. 1 EL. +14.85' NGVD29

NOTES:

1. RESULTS OF TOPOGRAPHIC SURVEY BY FOTH-CLE ENGINEERING (FOTH) ON 9/9, 9/15, 9/21, 11/10, AND 11/11/2016.
  2. RESULTS OF HYDROGRAPHIC SURVEY BY FOTH ON 9/14/2016.
  3. EEL GRASS INSPECTION BY FOTH ON 9/16/2016.
  4. EEL GRASS INSPECTION CONFIRMED THERE IS NO EEL GRASS IN THE SCOPE OF WORK.
  5. ELEVATIONS AND SOUNDINGS ARE IN FEET AND TENTHS, AND REFER TO THE NGVD29 DATUM. AHTL=+1.54'.
  6. DATUM CONVERSIONS PERFORMED USING NOAA BM DISK NO. 1 SET IN ROCK AT BUS STATION.
  7. COORDINATES ARE BASED ON NAD83 MASSACHUSETTS ISLAND STATE PLANE GRID SYSTEM.
  8. SOUNDINGS ARE BASED ON THE 5' MINIMUM VALUE DATA SET FOR MAPPING.
  9. PROJECT BENCHMARK IS NOAA DISK "BM NO.1". BENCHMARK ELEVATION IS +14.85' NGVD29 SET IN ROCK AT BUS STATION NEAR OAK BLUFFS FERRY TERMINAL.
  10. PROPERTY LINES FOR EAST CHOP PROVIDED BY REID & SILVA ON PLAN DATED 5/29/13.
  11. FERRY TERMINAL LIMITS ARE APPROXIMATE AND WERE SCALED FROM GOOGLE EARTH AERIAL IMAGERY.
  12. PROJECT SITE IS IN FEMA ZONE VE EL. +13 NAVD88 (EL. +14.3 NGVD29) & VE EL. 15' NAVD88 (EL. +16.3 NGVD29) IN ACCORDANCE TO MOST RECENT FEMA FIRM #25007C0108J, EFFECTIVE DATE JULY 20, 2016.
- POSSESSION AND USE OF THE MATERIAL CONTAINED ON THESE DRAWINGS IS GRANTED ONLY IN CONNECTION WITH ITS USE AS IT RELATES TO THE TITLED PROJECT, ANY OTHER USE, REPRODUCTION OR DISCLOSURE OF THE INFORMATION CONTAINED HEREON IS EXPRESSLY PROHIBITED WITHOUT THE WRITTEN CONSENT OF FOTH-CLE ENGINEERING GROUP.

• COPYRIGHT 2019, FOTH-CLE ENGINEERING GROUP.

DATUM: NGVD29  
MLW = -0.56'  
MHW = +1.14'  
NGVD29 = 0.00'  
AHTL = +1.54'

FOTH-CLE ENGINEERING GROUP  
15 CREEK ROAD  
MARION MA, 02738

NOTES

PROPOSED EAST CHOP BLUFF REPAIR

EAST CHOP BLUFF

TOWN OF OAK BLUFFS  
56 SCHOOL STREET  
OAK BLUFFS, MA 02557

DATE: 1/10/19

SHEET 13 OF 13